

UNCONTROLLED DOCUMENT

PART NUMBER		REV.
OED-CL0805C-150		A
REV.	E.C.N. NUMBER AND REVISION COMMENTS	DATE
A	E.C.N. #11148.	5.16.07

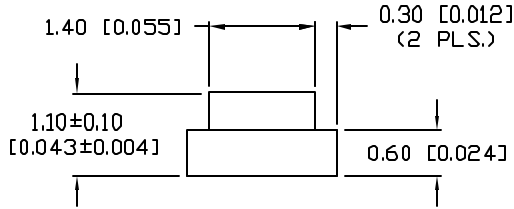

LEAD FREE REFLOW PROFILE

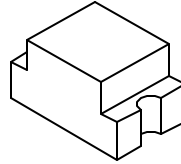
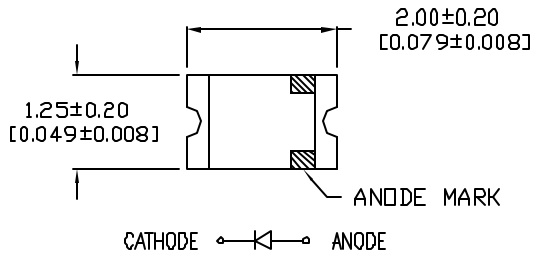
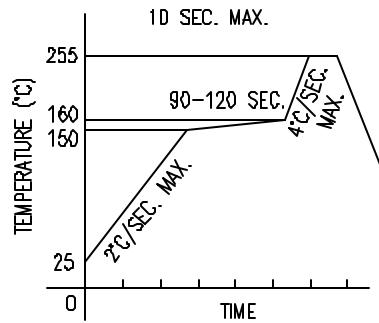

TOTAL TIME ABOVE 220°C IS 60 SECONDS MAX.

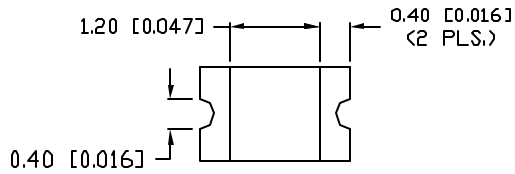

ELECTRO-OPTICAL CHARACTERISTICS				T <sub>o</sub> =25°C	
PARAMETER	MIN	TYP	MAX	UNITS	TEST UNITS
FORWARD VOLTAGE		1.4	1.8	V	I <sub>f</sub> =50mA
REVERSE CURRENT			10.0	μA	V <sub>r</sub> =6V
POWER OUTPUT	0.5	1.2		mW/sr	I <sub>f</sub> =20mA
CAPACITANCE		30		pF	f=1MHz
BEAM HALF ANGLE		150		DEG.	
PEAK WAVELENGTH		875		nm	I <sub>f</sub> =20mA
SPECTRAL BANDWIDTH		80		nm	I <sub>f</sub> =20mA

LIMITS OF SAFE OPERATION AT 25°C

PARAMETER	MAX	UNITS
PEAK FORWARD CURRENT*	160	mA
STEADY CURRENT	65	mA
POWER DISSIPATION	110	mW
DERATE FROM 25°C	-1.2	mW/°C
OPERATING TEMP.	-40 TO +85	°C
STORAGE TEMP.	-40 TO +85	°C

\* t < 10μS

NOTES:

- 3,000 PCS. PER REEL.
- MOISTURE SENSITIVE LABEL ON REEL AND BAG.
- ANTISTATIC HEATSEALED BAG.
- CATODE TOWARDS TAPE SPROCKET HOLES.

CAUTION: STATIC SENSITIVE DEVICE  
FOLLOW PROPER E.S.D. HANDLING PROCEDURES  
WHEN WORKING WITH THIS PART.

CAUTION: MOISTURE SENSITIVE DEVICE  
PER JEDEC LEVEL 4 STANDARDS

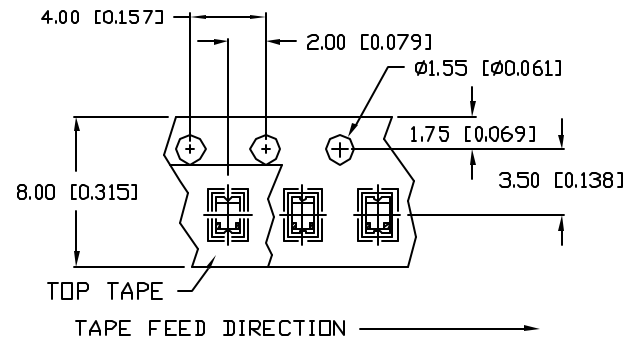

RECOMMENDED SOLDER PAD LAYOUT

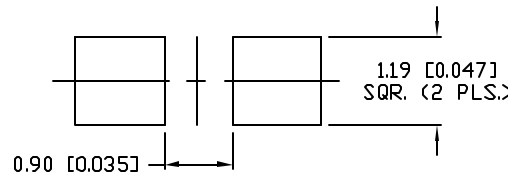

\*UNLESS OTHERWISE SPECIFIED TOLERANCES PER DECIMAL PRECISION ARE: X=±1 (±0.038), XX=±0.5 (±0.020), XXX=±0.25 (±0.010), XXXX=±0.127 (±0.005). LEAD SIZE=±0.05 (0.002), LEAD LENGTH=±0.75 (±0.030). MIN= +DECIMAL PRECISION -0.00 MAX= +0.00 -DECIMAL PRECISION

UNCONTROLLED DOCUMENT

REV.	PART NUMBER
A	OED-CL0805C-150
2.0mm X 1.25mm PCB SURFACE MOUNT IR EMITTER, WATER CLEAR LENS, TAPE AND REEL.	

**CONFIDENTIAL INFORMATION**  
THE INFORMATION CONTAINED IN THIS DOCUMENT IS THE PROPERTY OF LUMEX INC. EXCEPT AS SPECIFICALLY AUTHORIZED IN WRITING BY LUMEX INC., THE HOLDER OF THIS DOCUMENT SHALL KEEP ALL INFORMATION CONTAINED HEREIN CONFIDENTIAL AND SHALL PROTECT SAME IN WHOLE OR IN PART FROM DISCLOSURE AND DISSEMINATION TO ALL THIRD PARTIES.

**RELIABILITY NOTE**  
OUR MANY YEARS OF EXPERIENCE DATA ACCUMULATION INDICATE THAT SOLDER HEAT IS A MAJOR CAUSE OF EARLY AND FUTURE FAILURE. PLEASE PAY ATTENTION TO YOUR SOLDERING PROCESS.

<b>LUMEX</b> 290 E. HELEN ROAD PALATINE, IL 60067-6976 PHONE: +1.847.359.2790 US WEB: www.lumex.com TW WEB: www.lumex.com.tw	
DRAWN BY: jc	CHECKED BY: APPROVED BY: DATE: 2.17.06 PAGE: 1 OF 1 SCALE: N/A