

Customer Information Sheet

DRAWING No.: SOX-46

SHEET 2 OF 2

IF IN DOUBT - ASK

Ⓢ

NOT TO SCALE

THIRD ANGLE PROJECTION

ALL DIMENSIONS IN mm

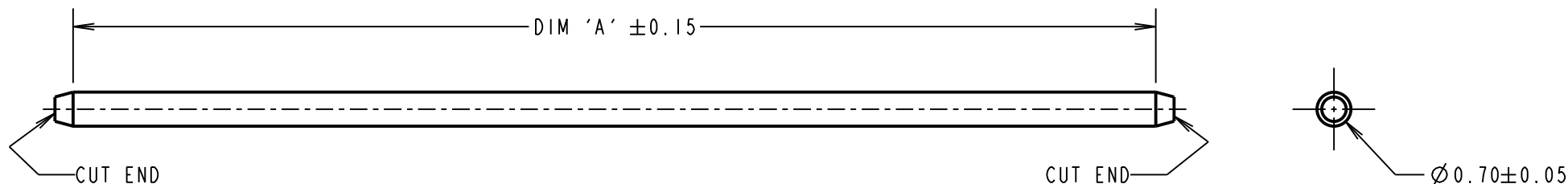

NOTES:

1. THIS PRODUCT IS RECOMMENDED FOR USE WITH S8071-46R AND S8081-46R SMT CLIPS.
3. MAXIMUM BURR ON CUTTING AREA = 0.05mm.
4. ALL PRODUCT IS RoHS AND REACH COMPLIANT.
5. PACKAGING = 100 COMPONENTS PER BAG.
6. CURRENT RATING IS DEPENDANT ON USAGE. SEE TEST REPORT HT055XX (LATEST ISSUE) FOR MORE INFORMATION ON CURRENT RATING.

SPECIFICATIONS:

MATERIAL = PHOSPHOR BRONZE
 FINISH = 2-6 μ TIN OVER 1-4 μ NICKEL

ELECTRICAL:
 CURRENT RATING = 3A - 13A
 (SEE NOTE 6)

VOLTAGE RATING = 250V AC/DC
 CONTACT RESISTANCE = 20m Ω MAX

ENVIRONMENTAL:
 OPERATING TEMPERATURE = -40°C TO +85°C

PART No.	DIM 'A'
S07-46	23.00
S08-46	15.00

ORDER CODE:

SOX-46

PIN LENGTH:

7 = 23.00
 8 = 15.00

FINISH:

46 = 2-6 μ TIN OVER
 1-4 μ NICKEL

MSP	4	19.04.17	20428
NAME	ISS.	DATE	C/NOTE
APPROVED: M.PERREN			
CHECKED: S.BENNETT			
DRAWN: S.BENNETT			
CUSTOMER REF.:			
ASSEMBLY DRG:			

HARWIN

www.harwin.com
 technical@harwin.com

THIS DRAWING AND ANY INFORMATION OR DESCRIPTIVE MATTER SET OUT HEREON ARE CONFIDENTIAL AND COPYRIGHT PROPERTY OF THE HARWIN GROUP AND MUST NOT BE DISCLOSED, LOANED, COPIED OR USED FOR MANUFACTURING, TENDERING OR FOR ANY OTHER PURPOSE WITHOUT THEIR WRITTEN PERMISSION.

TOLERANCES
 X. = ± 1 mm
 X.X = ± 0.50 mm
 X.XX = ± 0.10 mm
 X.XXX = ± 0.01 mm
 ANGLES = $\pm 5^\circ$
 UNLESS STATED

MATERIAL:
 SEE ABOVE
FINISH: SEE ABOVE
S/AREA: mm²

TITLE:
 BRIDGE PIN
DRAWING NUMBER:
 SOX-46

SHT
 2 OF 2