

TOLERANCE UNLESS SPECIFIED = .XXX = +/- .005 .XX = +/- .015 FRACTIONS = +/- .032

FS10-600.DC2

YYWW = YEAR, WEEK
XXX = SITECODE

M MagneTek - Triad
FS10-600
CLASS B **cRU** US

EIA-17-YYWW
XXX B10

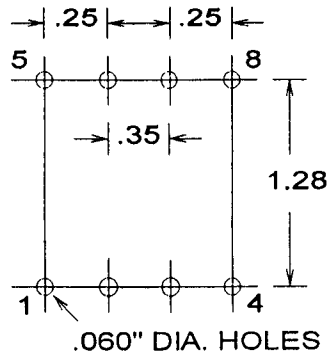
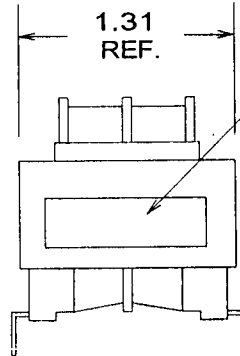
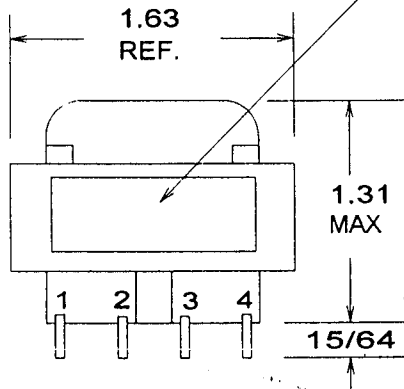

PRODUCTION TESTS

TURNS RATIO = 100%	
DC	(1-2) 230 TO 283
RESISTANCE IN OHMS	(3-4) 287 TO 350
	(5-6) .55 TO .82
	(7-8) .65 TO .98

MAX EXCITATION CURRENT = .015 AMPS
APPLY = 230V, 60Hz PINS 1-4
CONNECT PINS 2-3

OPEN CIRCUIT VOLTAGE TEST:
APPLY 230V/60HZ PINS 1-4, CON. 2-3
READ 5.3 TO 6.2 EACH SECONDARY

HIPOT = 2500V P-S, P-C, S-C
500V S-S, P-P

CONTINUITY = 100% PRIMARY
IMPREGNATION NOTES = 2 HOUR PREHEAT
PINS MUST BE FREE OF IMPREG.

FINAL ASSEMBLY NOTES

M MagneTek

PART NO. FS10-600

METHOD

1 X 1

MARKING

SEE LABEL DETAIL ABOVE