

DETAILS

Product Number	C14020_STRADA-SQ-ME
Family	Strada
Type	Lens
Color	clear
Diameter	25 x 25 mm
Height	8,6 mm
Style	square
Optic Material	PMMA
Holder Material	
Fastening	pin, screw
Status	production ready
ROHS Compliant	Yes
Date Updated	11/11/2015



OPTICAL PROPERTIES

LED	Viewing	Light	Effi-		Connector
	Angle	Beam	ciency	cd/lm	
PSL440	Asymmetric deg	Streetligh...	91 %	0.710	-
PSL445	Asymmetric deg	Streetligh...	94 %	0.420	-
MK-R	sim: Asymmetri	Streetligh...	sim: 91 %	-	-
MHB-A/B	sim: Asymmetri	Streetligh...	-	-	-
XHP50	Asymmetric deg	Streetligh...	94 %	0.560	-
XP-G3	sim: Asymmetri	Streetligh...	sim: 94 %	sim: 0.860	-
LUXEON M/MX	sim: Asymmetri	Streetligh...	sim: 90 %	-	-
LUXEON MZ	Asymmetric deg	Streetligh...	93 %	0.960	-
NVSxx19B/NVSxx19C	sim: Asymmetri	Streetligh...	sim: 94 %	sim: 0.950	-
Duris S8	sim: Asymmetri	Streetligh...	sim: 93 %	-	-
OSCONIQ P 7070	sim: Asymmetri	Streetligh...	sim: 92 %	sim: 0.654	-

D

C

B

A

4

4

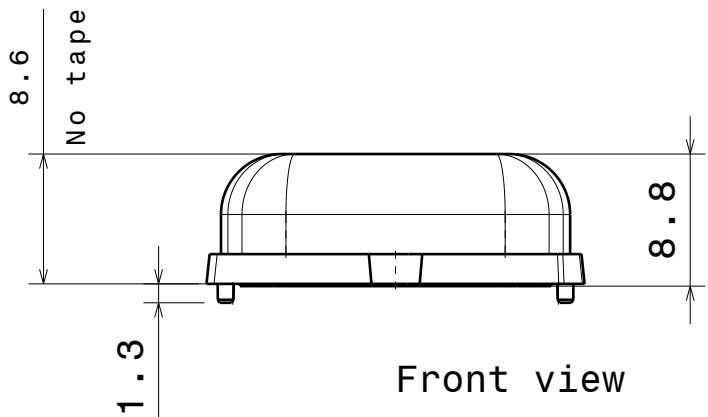

Front view

3

3

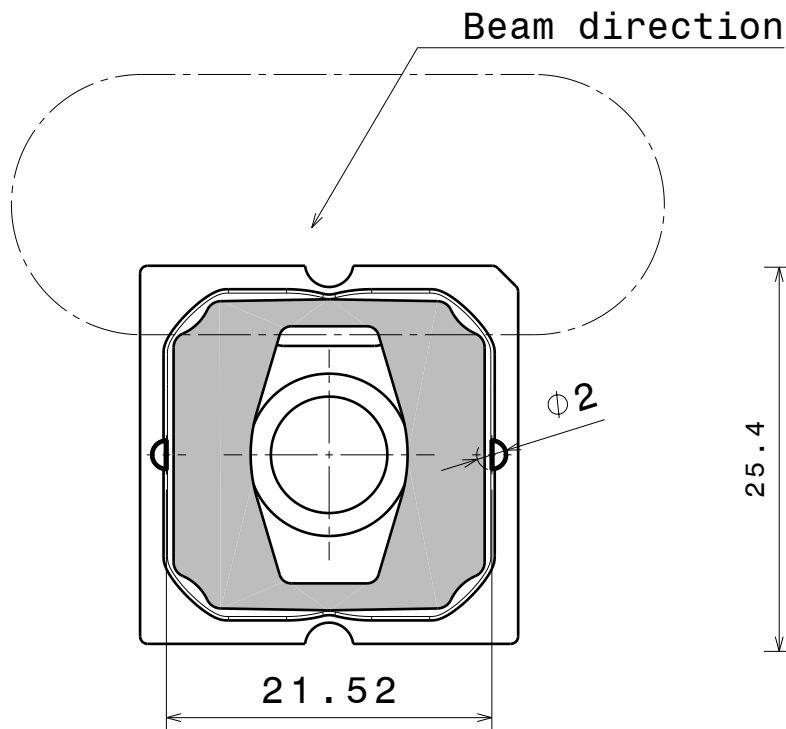

Bottom view

2

2

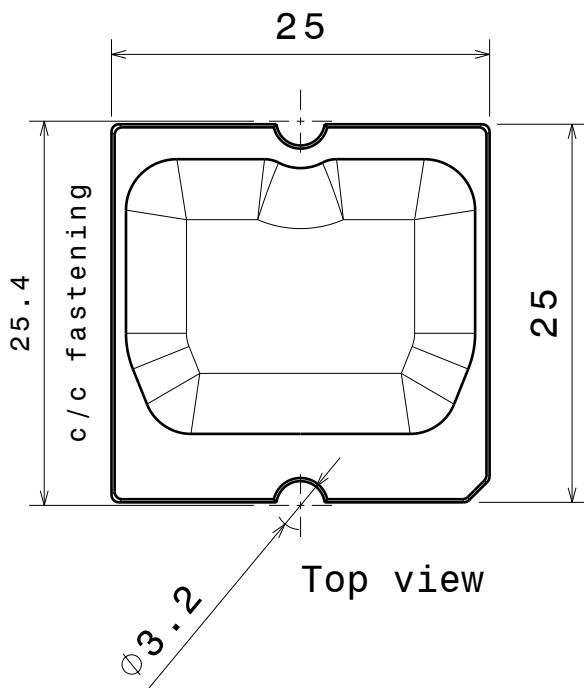

Top view

Tolerances if not otherwise shown
According to DIN ISO 2768-1
Linear measures:
Up to 30mm class M, otherwise class C.
According to DIN ISO 2768-2
Form and position: class L



Ledil Oy
Salorankatu 10
FIN 24240 SALO
Finland

THIRD ANGLE PROJECTION:

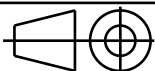

DRAWING TITLE

STRADA-SQ-ME_Mechanicaldrawing

This drawing is the property
of LEDiL Oy. It may not be
reproduced, copied or
communicated without a written
agreement with LEDiL Oy."

SIZE

A4

PART NUMBER

-

SCALE

2:1

WEIGHT

-

SHEET

1/1

D

A

1

1

Luminaire: LEDiL Oy C14020_STRADA-SQ-ME_(PSL440)
Lamps: 1 x Citizen_PSL440_256.951lm@250mA_P=2.8697W_I=0.250A

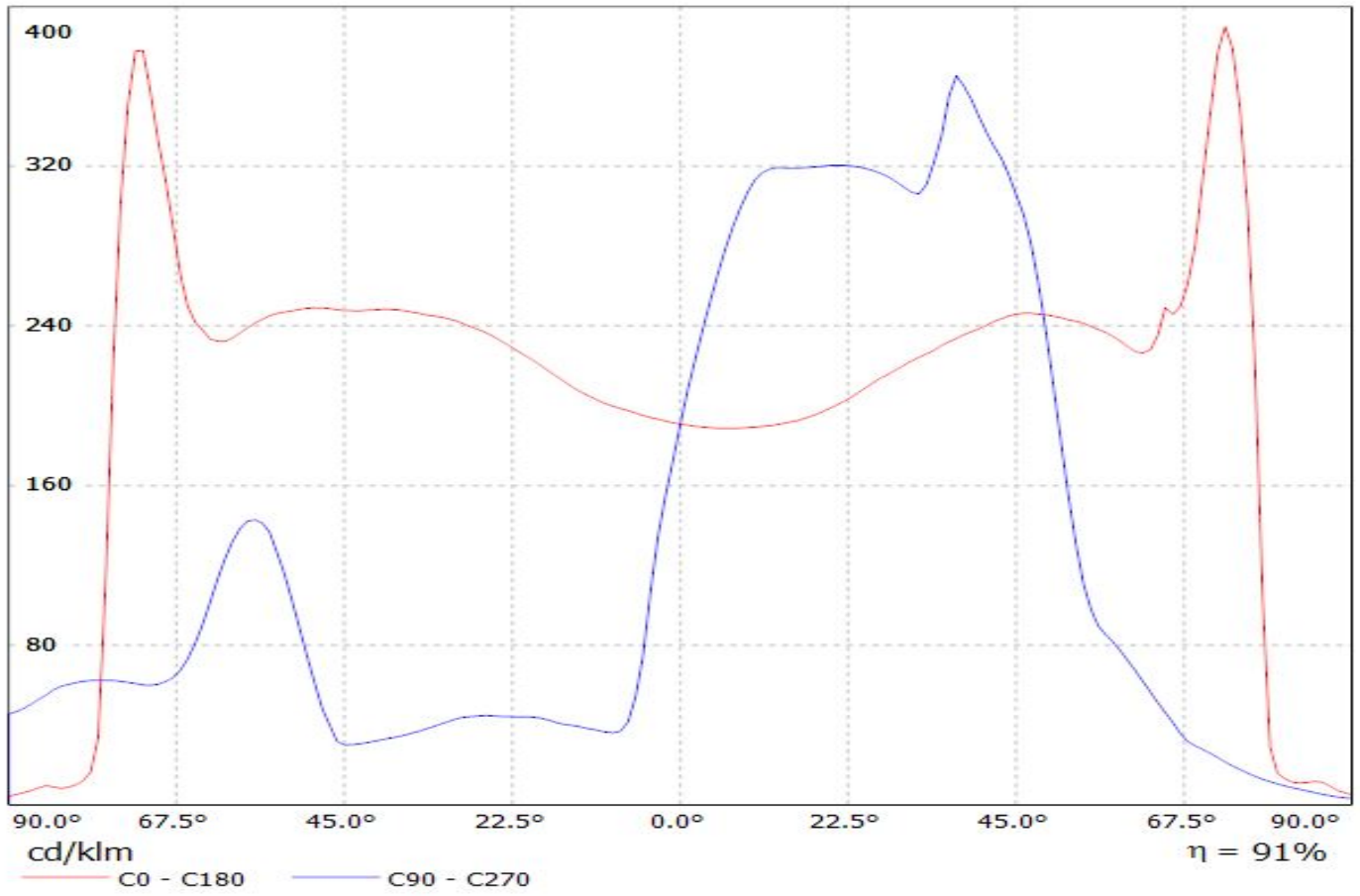

Luminaire: LEDiL Oy C14020_STRADA-SQ-ME_(PSL445)

Lamps: 1 x Citizen_PSL445_425.848lm@250mA_P=2.8155W_I=0.250A_CCT=2700K

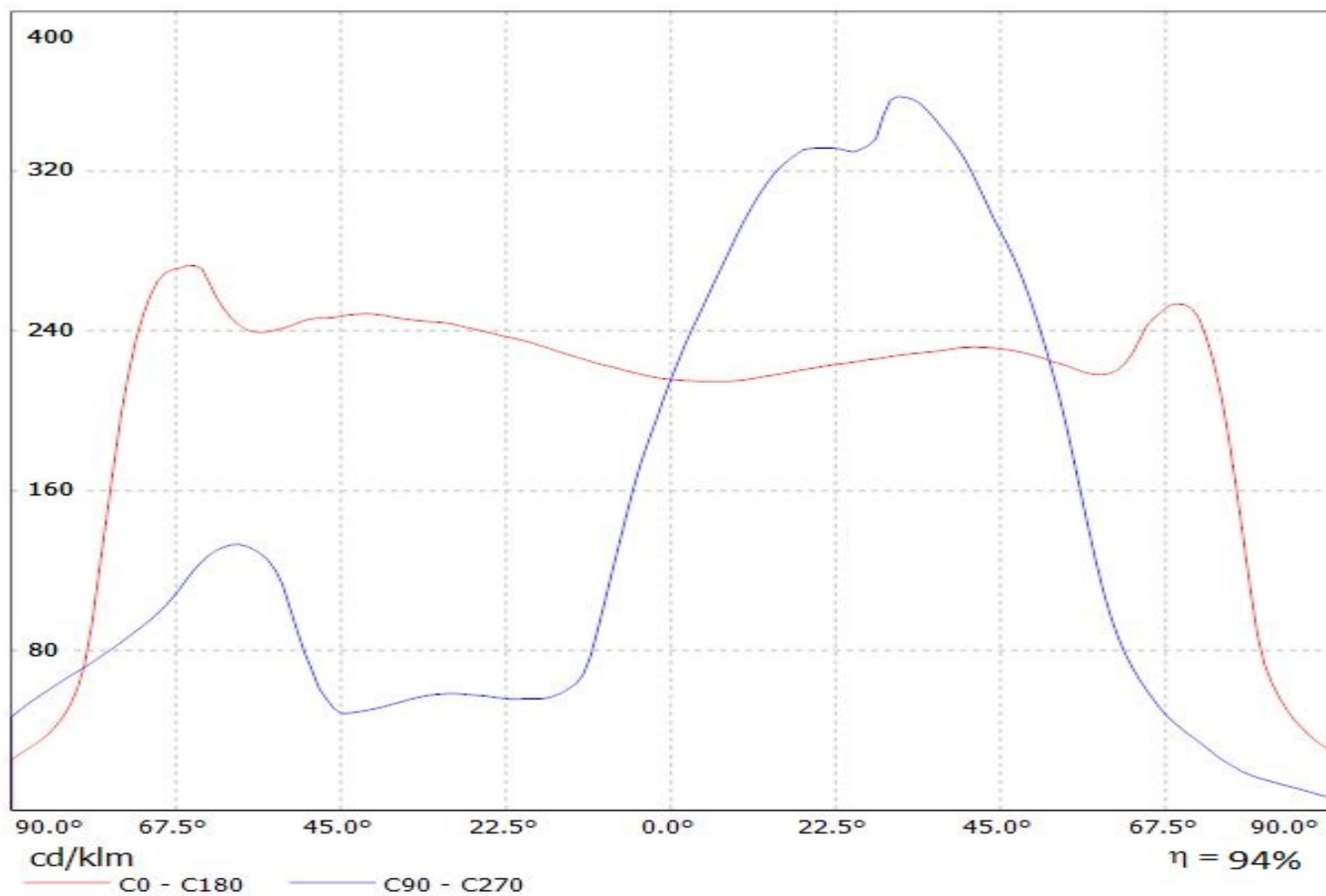

Luminaire: LEDiL Oy C14020_STRADA-SQ-ME_(XHP50 Cool white)
Lamps: 1 x XHP50 Cool white_244.744lm@250mA_P=1.42773W_I=0.2499A

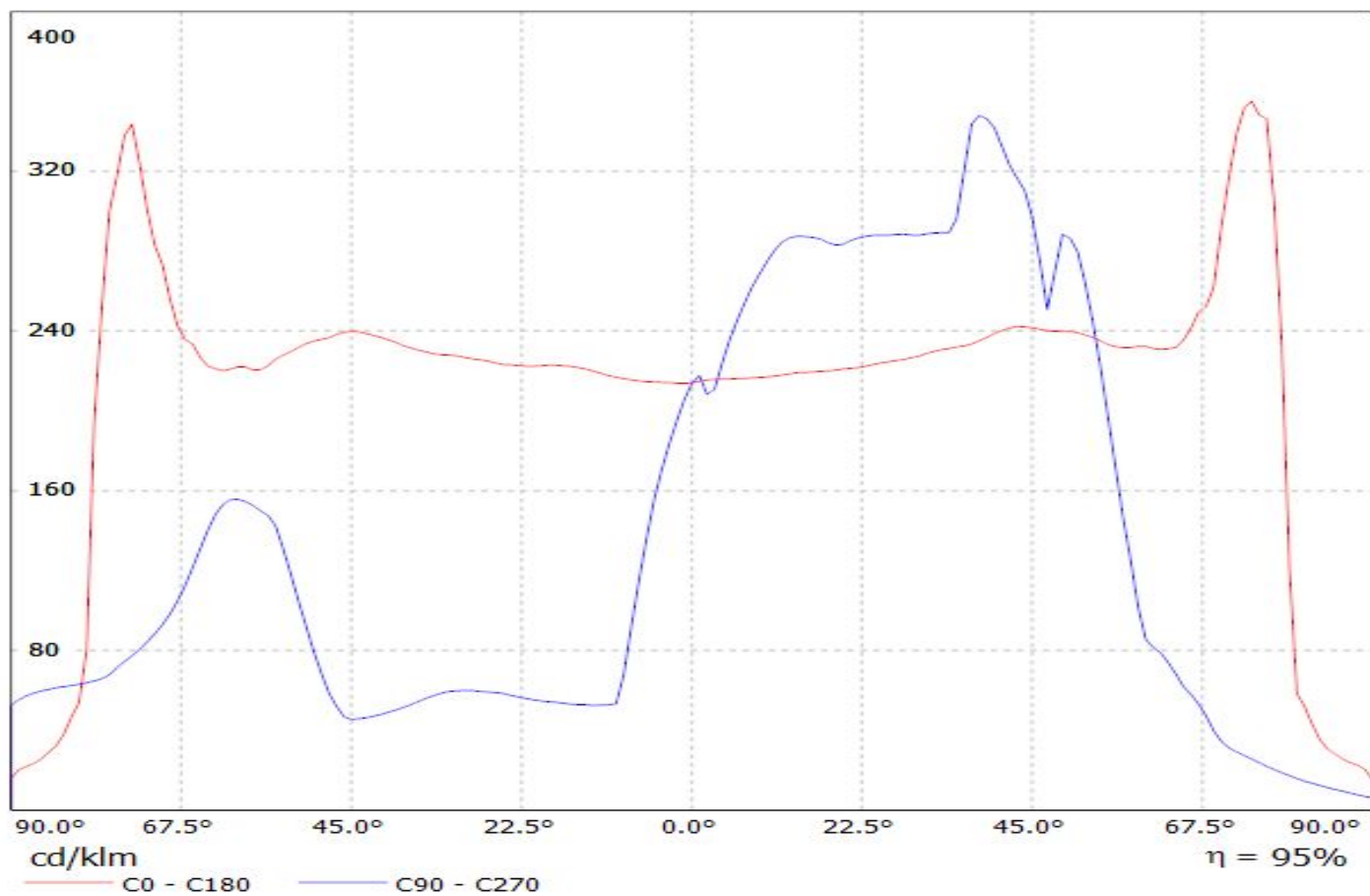

Luminaire: Ledil Oy C14020_STRADA-SQ-ME_(XP-G3)_SIMULATED
Lamps: 1 x Cree XP-G3

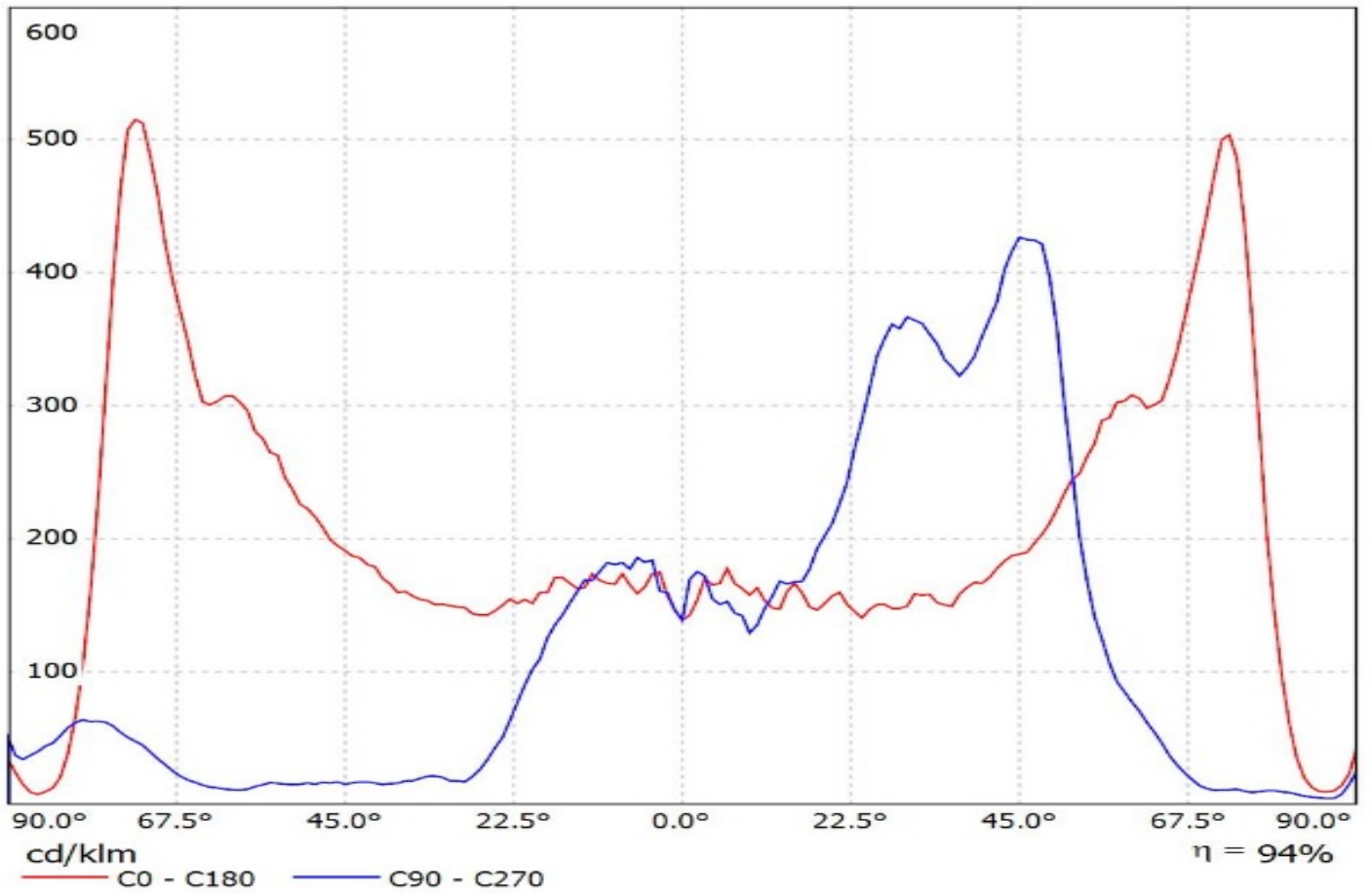

Luminaire: LEDiL Oy C14020_STRADA-SQ-ME_(Luxeon_MZ) Eff: 93%
Lamps: 1 x LUXEON-MZ_263.073lm@250mA_P=2.7399W_I=249.9mA

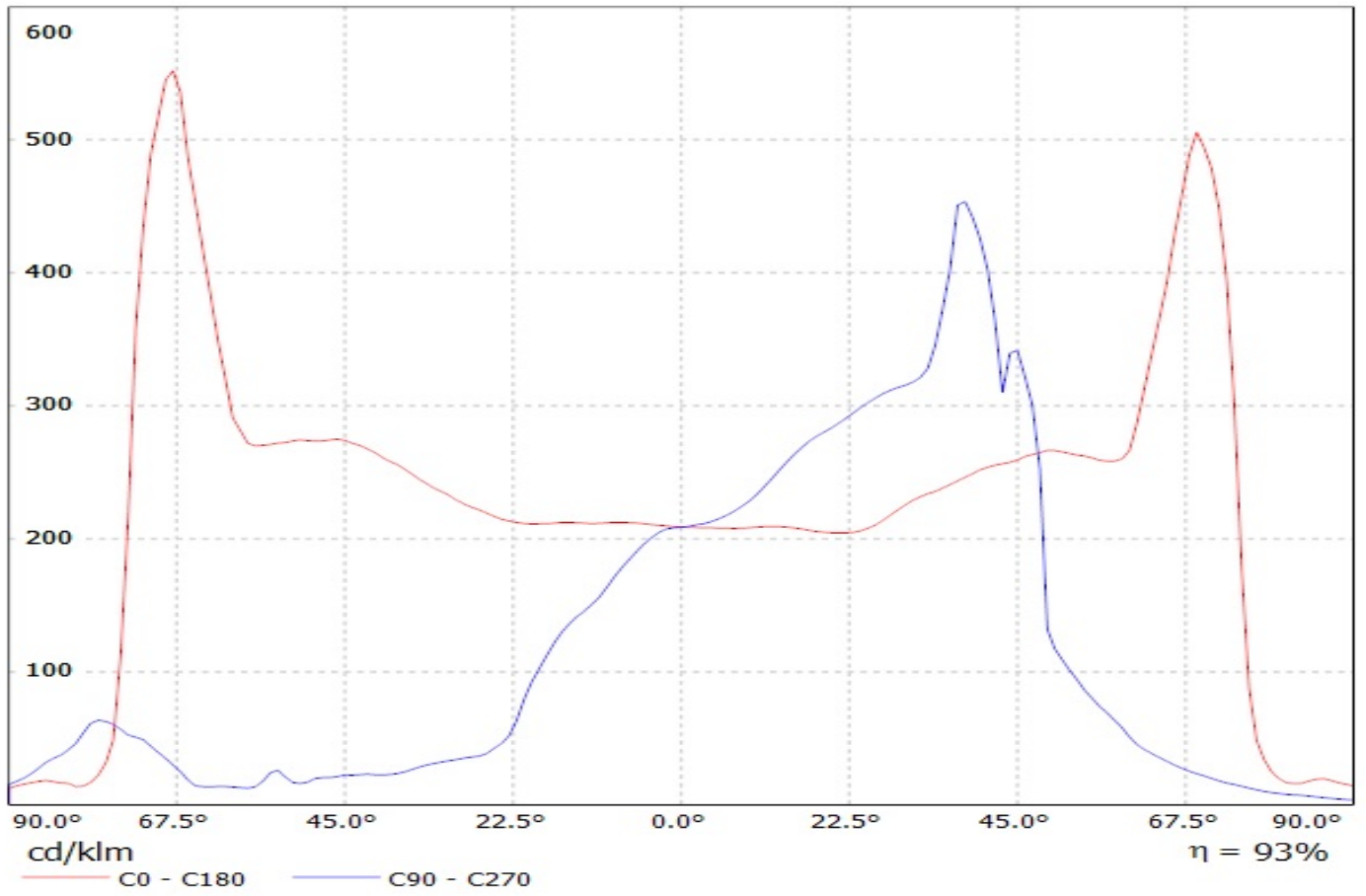

Luminaire: Ledil Oy C14020_STRADA-SQ-ME_(NVSxx19C)_SIMULATED
Lamps: 1 x Nichia NVSL219C

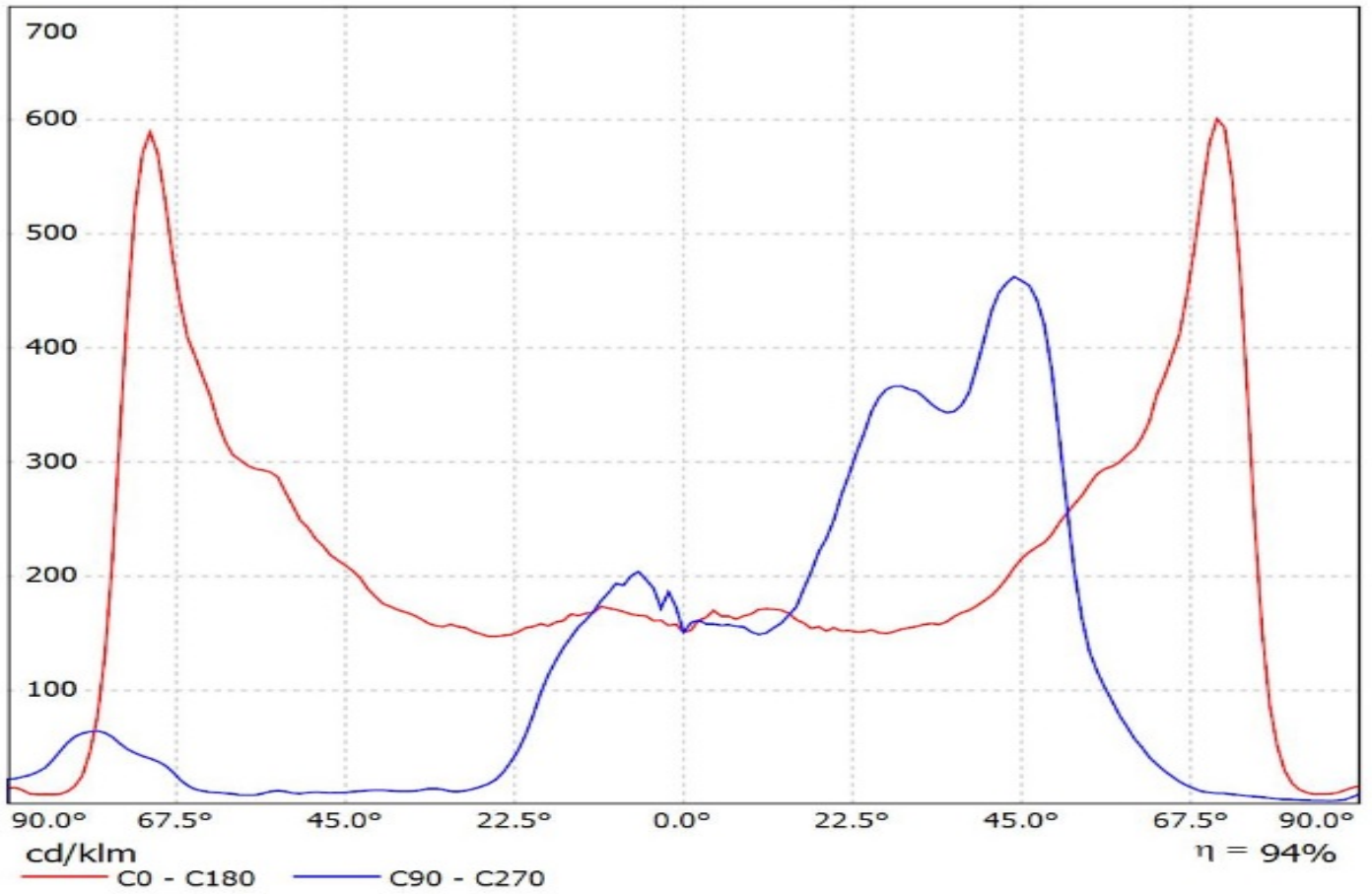

Luminaire: LEDiL Oy C14020_STRADA-SQ-ME_(PSL440)

Lamps: 1 x Citizen_PSL440_256.951lm@250mA_P=2.8697W_I=0.250A

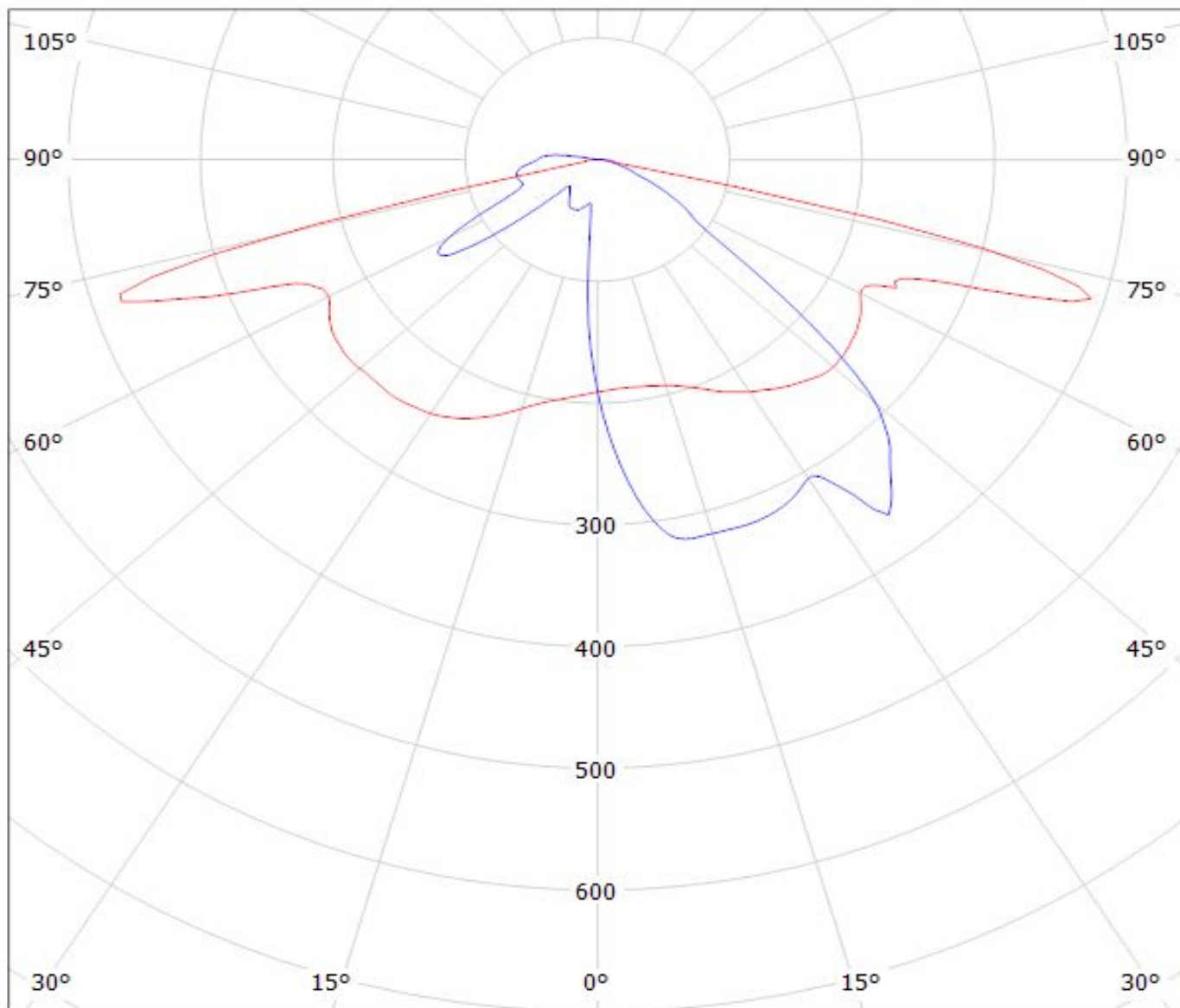

cd/klm

— C0 - C180

— C90 - C270

$\eta = 91\%$

Luminaire: LEDiL Oy C14020_STRADA-SQ-ME_(PSL445)

Lamps: 1 x Citizen_PSL445_425.848lm@250mA_P=2.8155W_I=0.250A_CCT=2700K

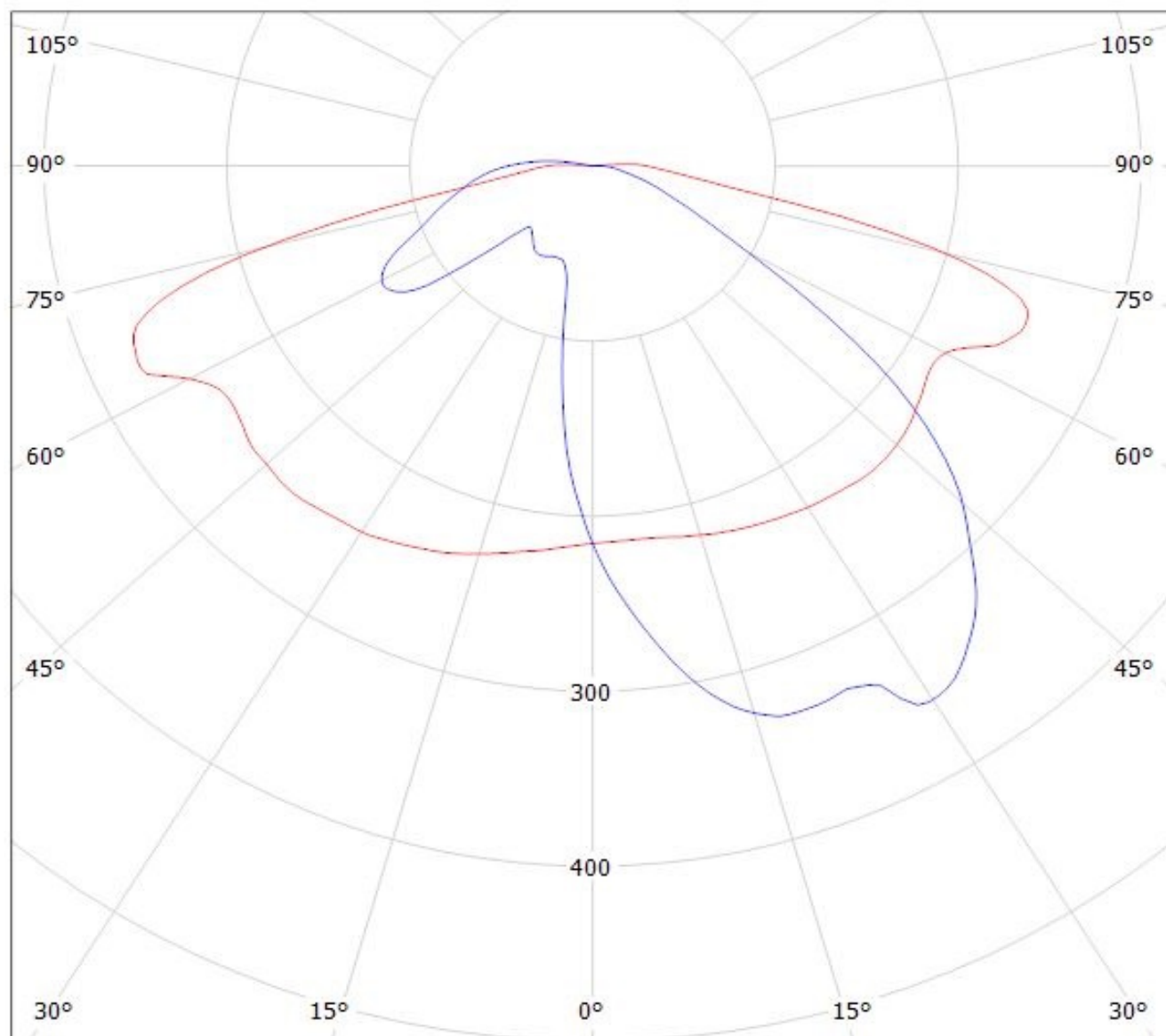

cd/klm

— C0 - C180

— C90 - C270

$\eta = 94\%$

Luminaire: LEDiL Oy C14020_STRADA-SQ-ME_(XHP50 Cool white)

Lamps: 1 x XHP50 Cool white_244.744lm@250mA_P=1.42773W_η=0.2499A

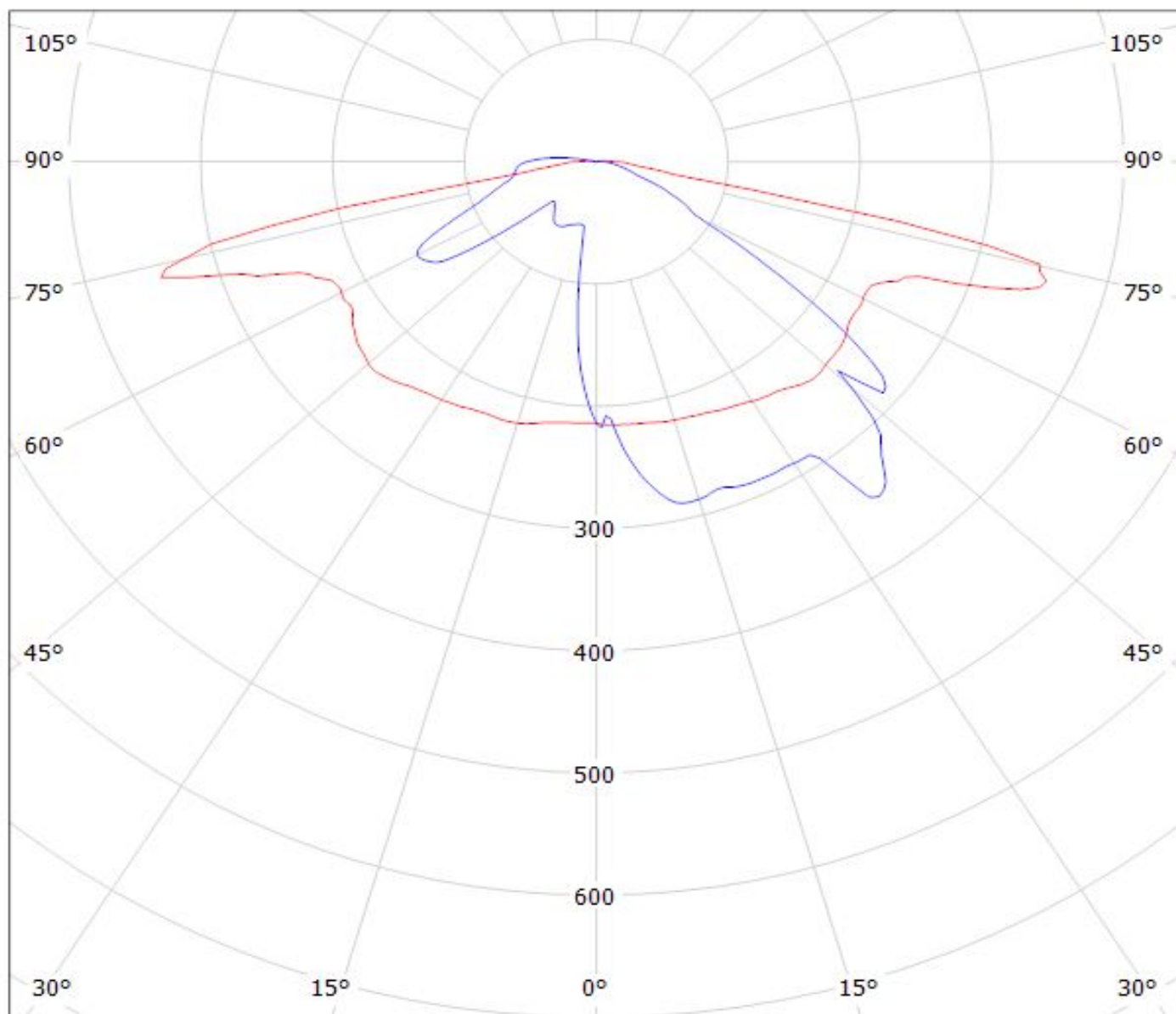

cd/klm

— C0 - C180 — C90 - C270

η = 95%

Luminaire: Ledil Oy C14020_STRADA-SQ-ME_(XP-G3)_SIMULATED
Lamps: 1 x Cree XP-G3

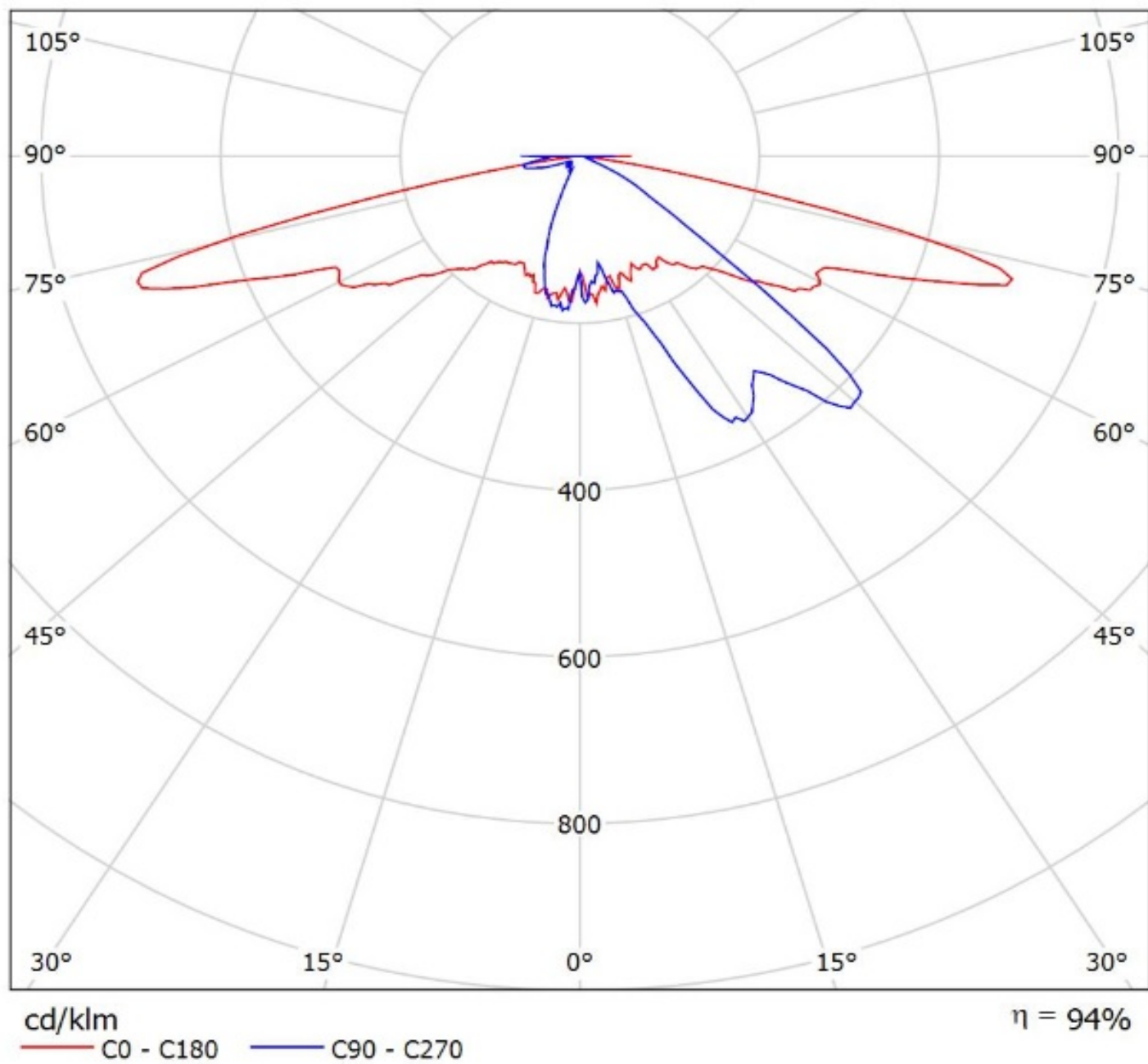

Luminaire: LEDiL Oy C14020_STRADA-SQ-ME_(Luxeon_MZ) Eff: 93%
Lamps: 1 x LUXEON-MZ_263.073lm@250mA_P=2.7399W_I=249.9mA

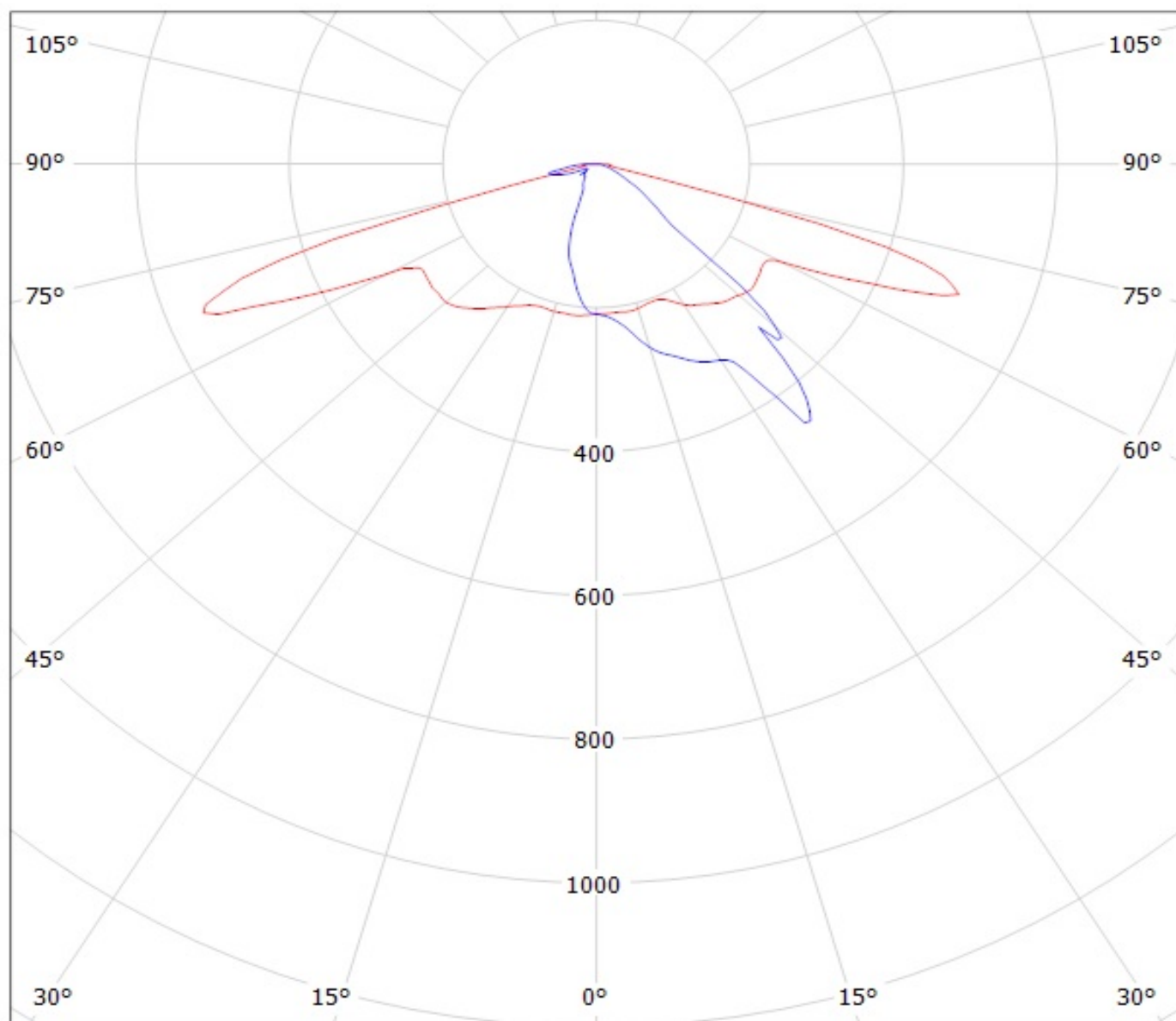

cd/klm

— C0 - C180

— C90 - C270

$\eta = 93\%$

Luminaire: Ledil Oy C14020_STRADA-SQ-ME_(NVSxx19C)_SIMULATED
Lamps: 1 x Nichia NVSL219C

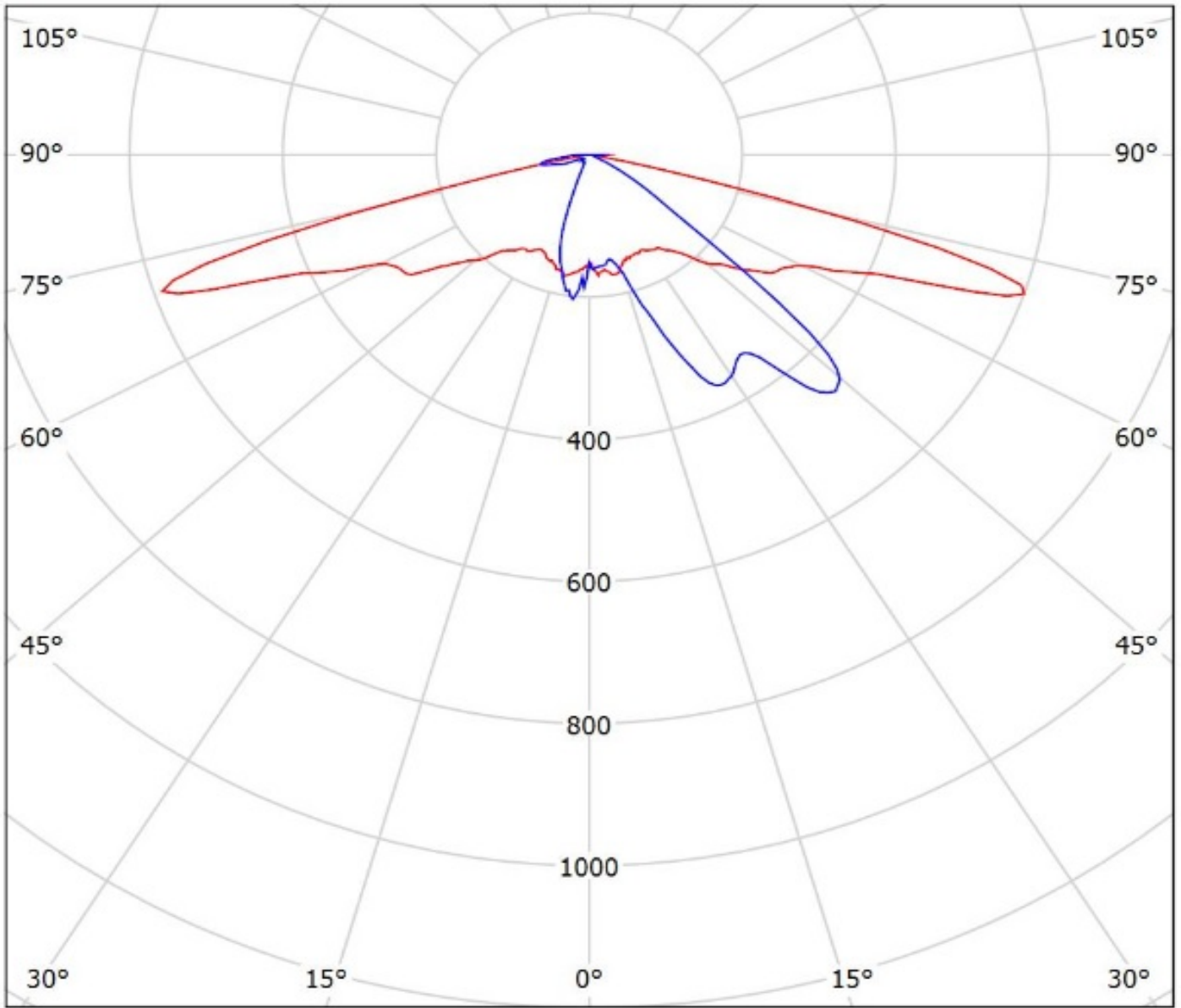

cd/klm

— C0 - C180 — C90 - C270

$\eta = 94\%$

NOTE: The typical divergence will be changed by different color, chip size and chip position tolerance. The typical total divergence is the full angle measured where the luminous intensity is half of the peak value.