

General Specifications

Electrical Capacity

| | |
|------------------------|--|
| Resistive Load: | 10A @ 125V AC or 6A @ 250V AC |
| Motor Load: | 400W @ 125V AC |
| Lamp Load: | 2A @ 125V AC for On-Off-On circuit & 3A @ 125V AC for other circuits |

Other Ratings

| | |
|-------------------------------|--|
| Contact Resistance: | 10 milliohms maximum |
| Insulation Resistance: | 1,000 megohms minimum @ 500V DC |
| Dielectric Strength: | 2,000V AC minimum between contacts for 1 minute minimum; 4,000V AC minimum between contacts & case for 1 minute minimum |
| Mechanical Life: | 100,000 operations minimum |
| Electrical Life: | 25,000 operations minimum |
| Angle of Throw: | 25° |

Materials & Finishes

| | |
|-----------------------------|-----------------------------------|
| Toggle Cap: | Brass with nickel plating |
| Lever: | Brass with chrome plating |
| Bushing: | Brass with nickel plating |
| Frame: | Stainless steel |
| Case/Base: | Diallyl phthalate resin (UL94V-0) |
| Movable Contacts: | Silver alloy with silver plating |
| Stationary Contacts: | Pure silver with silver plating |
| Terminals: | Copper with silver plating |

Environmental Data

| | |
|------------------------------|--|
| Operating Temp Range: | -10°C through +85°C (+14°F through +185°F) |
| Humidity: | 90 ~ 95% humidity for 96 hours @ 40°C (104°F) |
| Vibration: | 10 ~ 55Hz with peak-to-peak amplitude of 1.5mm traversing the frequency range & returning in 1 minute; 3 right angled directions for 2 hours |
| Shock: | 50G (490m/s ²) acceleration (tested in 6 right angled directions, with 5 shocks in each direction) |

Installation

| | |
|-----------------------------------|--|
| Soldering Time & Temp: | Wave Soldering Recommended (Straight PC): See Profile A in Supplement section. Manual Soldering: See Profile A in Supplement section. |
| Cleaning: | These devices are not process sealed. Hand clean locally using alcohol based solution. |

Standards & Certifications

| | |
|--------------------------------|--|
| Flammability Standards: | UL94V-0 rated case/base |
| UL: | File No. E44145 - Recognized only when ordered with marking on switch. Add "/U" or "/CUL" to end of part number to order UL recognized switch. All models recognized at 10A @ 125V AC & 6A @ 250V AC. |
| CSA: | File No. 023535_0_000 - Certified only when ordered with marking on switch. Add "/C" to end of part number to order CSA certified switch. All models certified at 10A @ 125V AC & 6A @ 250V AC. |
| VDE: | License No. 119174 All models approved at 10A @ 125V AC & 6A @ 250V AC. Marking on switch is standard. All models meet EN 61058-1 standard. |

Distinctive Characteristics

Meets EN 61058-1 standard.

High torque bushing construction prevents rotation or separation from frame during installation.

Stainless steel frame resists corrosion and increases environmental safety.

Case/base of heat resistant resin meets UL94V-0 flammability standard.

Contacts of special silver alloy resist arcing and guarantee stable electrical contact and long life.

High insulating barriers increase isolation of circuits in double pole devices and provide added protection to contact points.

Prominent external insulating barriers increase insulation resistance and dielectric strength.

Epoxy sealed terminals prevent entry of flux, solvents, and other contaminants.

Clinching of the frame to the case well above the base and terminals provides 4,000V dielectric strength.

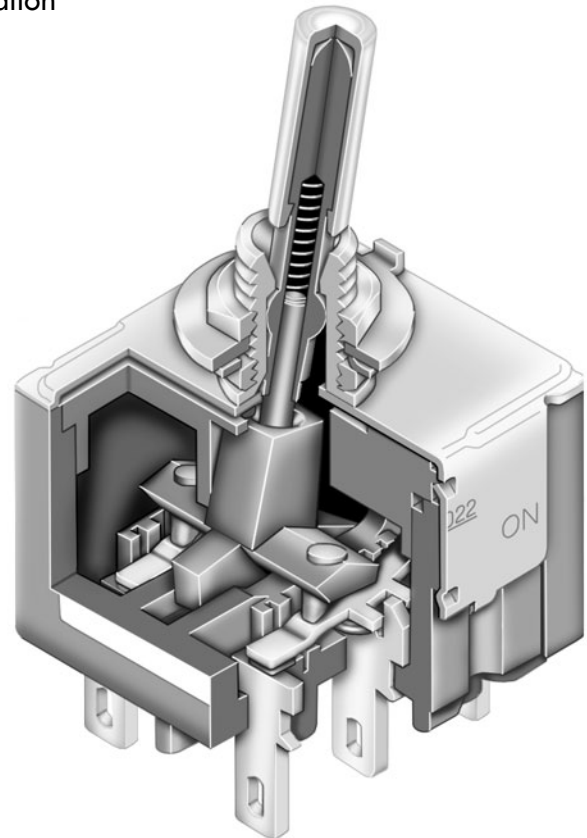

Actual Size

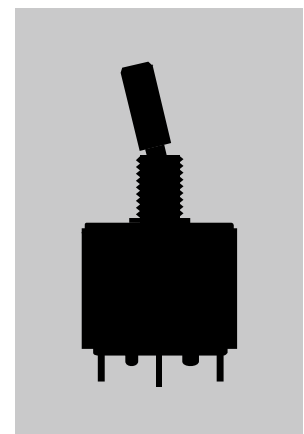

- A Toggles
- Rockers
- Pushbuttons
- Illuminated PB
- Programmable
- Keylocks
- Rotaries
- Slides
- Tactiles
- Tilt
- Touch
- Indicators
- Accessories
- Supplement

TYPICAL SWITCH ORDERING EXAMPLE

P20

22

B



| Poles & Circuits | | | | |
|------------------|------|----|------|-----|
| 11 | SPST | ON | NONE | OFF |
| 12 | SPDT | ON | NONE | ON |
| 13 | SPDT | ON | OFF | ON |
| 21 | DPST | ON | NONE | OFF |
| 22 | DPDT | ON | NONE | ON |
| 23 | DPDT | ON | OFF | ON |

| Toggles & Bushings | |
|--------------------|--|
| No Code | .512" (13.0mm) White Cap with 6mm Bushing |
| E | .450" (11.4mm) Flatted with 6mm Bushing |
| B | .689" (17.5mm) Large Bat with 12mm Bushing |
| D | .748" (19.0mm) White Capped Column with 12mm Bushing |

| Terminals | |
|-----------|------------------------------|
| No Code | Solder Lug* |
| P | Straight PC |
| Z | .187" (4.75mm) Quick Connect |

* Wire harness & cable assemblies offered only in Americas

DESCRIPTION FOR TYPICAL ORDERING EXAMPLE

P2022B

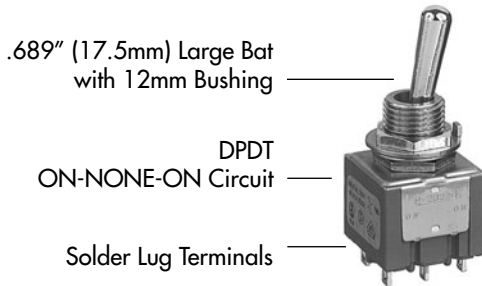

IMPORTANT:



VDE is marked on all models. Switches are supplied without UL, cULus & CSA marking unless specified. **UL, cULus & CSA recognized only when ordered with marking on the switch.** Specific models, ratings, & ordering instructions are noted on General Specifications page.

POLES & CIRCUITS

| | | Toggle Position | | | Connected Terminals | | | Throw & Schematics |
|------|----------------|-------------------------------|-------------|----------|-------------------------------|--------|-----------|--------------------|
| Pole | Model | Down <small>Keyway</small> | Center | Up | Down <small>Keyway</small> | Center | Up | |
| SP | P2011 | ON | NONE | OFF | 1-1b | OPEN | OPEN | SPST |
| SP | P2012 P2013 | ON ON | NONE OFF | ON ON | 1-1b | OPEN | 1-1a | SPDT |
| DP | P2021 | ON | NONE | OFF | 1-1b 2-2b | OPEN | OPEN | DPST |
| DP | P2022 P2023 | ON ON | NONE OFF | ON ON | 1-1b 2-2b | OPEN | 1-1a 2-2a | DPDT |

TOGGLES & BUSHINGS

No Code

.512" (13.0mm)
White Cap with
6mm Bushing

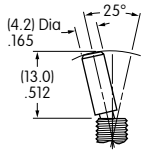

Panel Thickness
with Keyway
.134" (3.4mm)
maximum

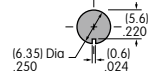

E

.450" (11.4mm)
Flatted with
6mm Bushing

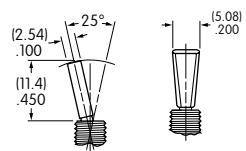

Panel Thickness
with Locking Ring
.102" (2.6mm)
maximum

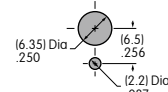

B

.689" (17.5mm)
Large Bat with
12mm Bushing

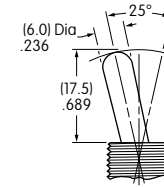

Panel Thickness
with Keyway
.256" (6.5mm)
maximum

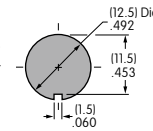

D

.748" (19.0mm)
White Capped Column
with 12mm Bushing

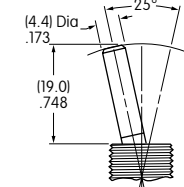

Panel Thickness
with Locking Ring
.217" (5.5mm)
maximum

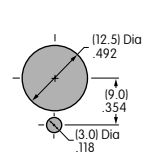

Panel Cutouts

Standard Hardware

For 6mm Bushing: 1 Locking Ring AT507M, 1 Internal Tooth Lockwasher AT509, 2 Hex Nuts AT513M

For 12mm Bushing: 1 Hex Face Nut AT503M, 1 Locking Ring AT506M, 1 Internal Tooth Lockwasher AT508, 1 Hex Mounting Nut AT527M

Optional Splashproof Boot Assemblies (for code B): AT401 & AT4181 boots plus hex nut & o-ring; see Accessories & Hardware section.

TERMINALS

No Code

Solder Lug

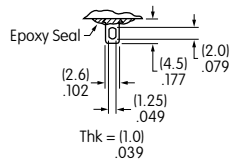

Z

.187" (4.75mm)
Quick Connect

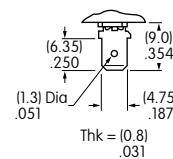

P

Straight PC

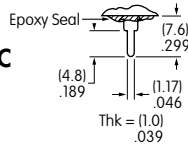

SPST

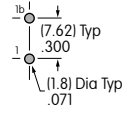

SPDT

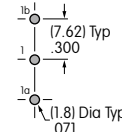

DPST

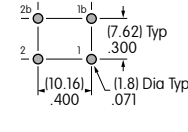

DPDT

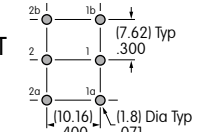

TYPICAL SWITCH DIMENSIONS

P2011, P2012, P2013

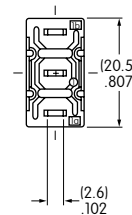
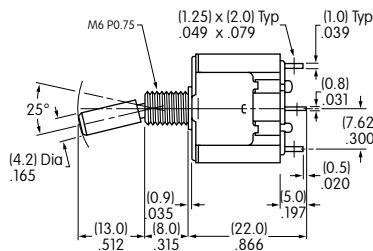
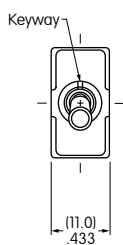

6mm Bushing



P2011 models do not have terminal 1a.

P2012

P2021B, P2022B, P2023B

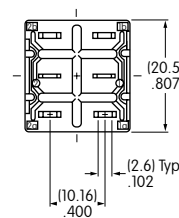
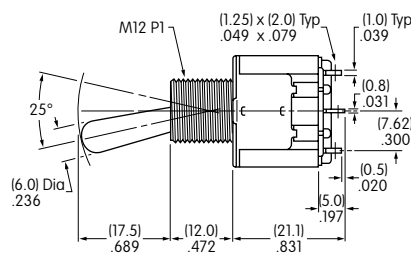
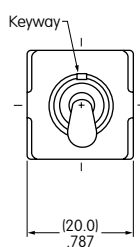

12mm Bushing



P2021 models do not have terminals 1a & 2a.

P2022B