



TAI-SAW TECHNOLOGY CO., LTD.

No. 3, Industrial 2nd Rd., Ping-Chen Industrial District,
Taoyuan, 324, Taiwan, R.O.C.

TEL: 886-3-4690038 FAX: 886-3-4697532

E-mail: tstsales@mail.taisaw.com Web: www.taisaw.com

Product Specifications Approval Sheet

Product Description: SAW Filter 2017.5 MHz 15 MHz BW SMD 1.4X1.1 mm

TST Part No.: TA1126A

Customer Part No.: _____

Customer signature required
Company: _____
Division: _____
Approved by : _____
Date: _____

Checked by: _____ Bob Chau 

Approved by: _____ Bob Chau 

Date: _____ 03, 25, 2013

1. Customer signed back is required before TST can proceed with sample build and receive orders.
2. Orders received without customer signed back will be regarded as agreement on the specifications.
3. Any specifications changes must be approved upon by both parties and a new revision of specifications shall be released to reflect the changes.



TAI-SAW TECHNOLOGY CO., LTD.

No. 3, Industrial 2nd Rd., Ping-Chen Industrial District,
Taoyuan, 324, Taiwan, R.O.C.

TEL: 886-3-4690038 FAX: 886-3-4697532

E-mail: tstsales@mail.taisaw.com Web: www.taisaw.com

SAW Filter 2017.5MHz 15 MHz BW SMD 1.4X1.1 mm

MODEL NO.:TA1126A

REV. NO.:2

A. MAXIMUM RATING:

1. Input Power Level: 10 dBm
2. DC Voltage : 3V
3. Operating Temperature: -30°C to +85°C
4. Storage Temperature: -40°C to +95°C

RoHS Compliant
Lead free
Lead-free soldering

Electrostatic Sensitive Device (ESD)

B. ELECTRICAL CHARACTERISTICS:

Terminating source impedance (single-ended) : $Z_s = 50$

Terminating load impedance (single-ended) : $Z_L = 50$

Item	Unit	Min.	Type.	Max.	Note
Center Frequency	Fc MHz	-	2017.5	-	-
Insertion Loss (2010~2025 MHz)	IL dB	-	1.3	2.1	-
Amplitude ripple (2010~2025 MHz)	dB	-	0.2	1	-
VSWR (2010~2025 MHz)		-	1.2	1.9	-
Attenuation					
1~1020 MHz	dB	26	29	-	-
1220~1570 MHz	dB	20	30	-	-
1570~1590 MHz	dB	30	32	-	-
1590~1820 MHz	dB	20	34	-	-
1820~1850 MHz	dB	31	36	-	-
1850~1950 MHz	dB	20	28	-	-
2085~2400 MHz	dB	19	27	-	-
2400~2430 MHz	dB	29	32	-	-
2430~2790 MHz	dB	25	32	-	-
2790~2820 MHz	dB	30	36	-	-
2820~3000 MHz	dB	25	38	-	-
3000~4010 MHz	dB	20	36	-	-
4010~4060 MHz	dB	25	35	-	-
4060~6000 MHz	dB	10	25	-	-

C.OUTLINE DRAWING:

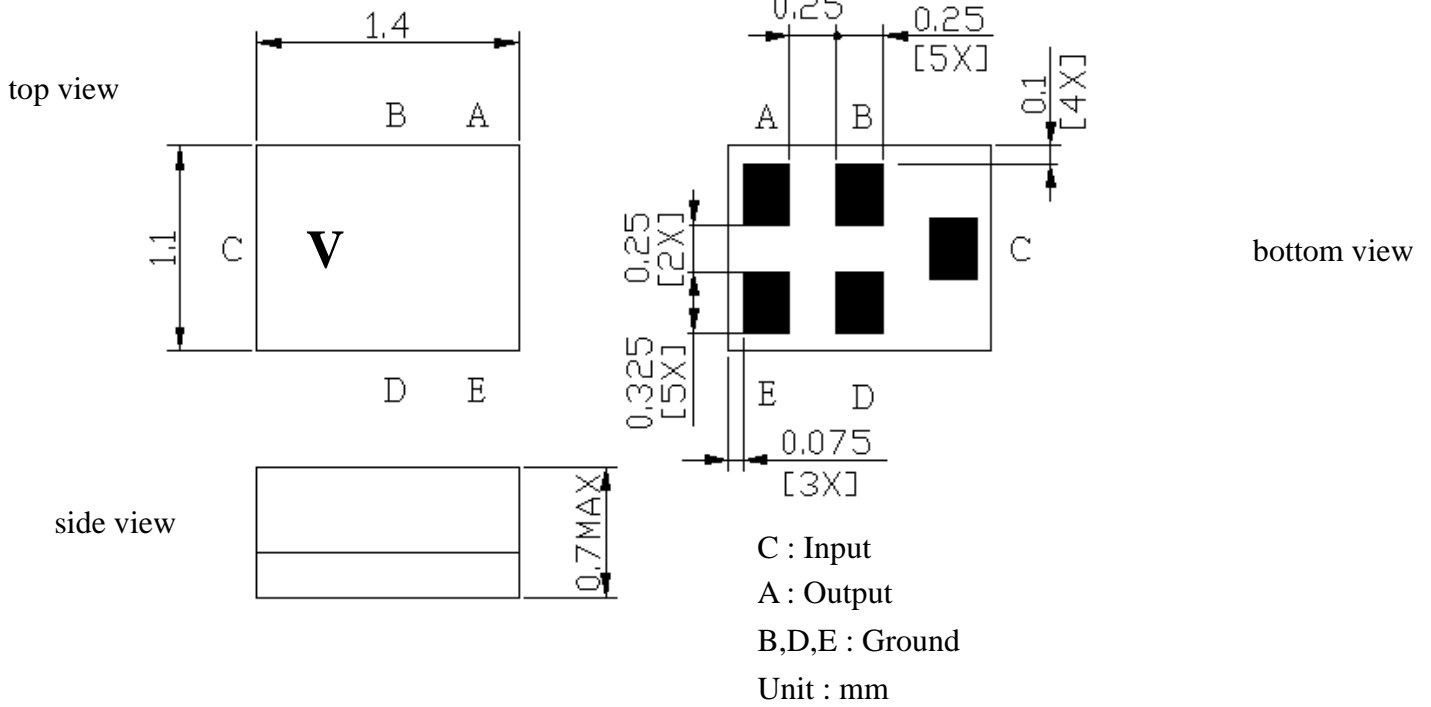

: Year/Month Code (Follow the table)

YEAR/Month	1	2	3	4	5	6	7	8	9	10	11	12
2013	A	B	C	D	E	F	G	H	J	K	L	M
2014	N	P	Q	R	S	T	U	V	W	X	Y	Z
2015	a	b	c	d	e	f	g	h	j	k	l	m
2016	n	p	q	r	s	t	u	v	w	x	y	z
2017	<u>A</u>	<u>B</u>	<u>C</u>	<u>D</u>	<u>E</u>	<u>F</u>	<u>G</u>	<u>H</u>	<u>J</u>	<u>K</u>	<u>L</u>	<u>M</u>
2018	<u>N</u>	<u>P</u>	<u>Q</u>	<u>R</u>	<u>S</u>	<u>T</u>	<u>U</u>	<u>V</u>	<u>W</u>	<u>X</u>	<u>Y</u>	<u>Z</u>
2019	<u>a</u>	<u>b</u>	<u>c</u>	<u>d</u>	<u>e</u>	<u>f</u>	<u>g</u>	<u>h</u>	<u>j</u>	<u>k</u>	<u>l</u>	<u>m</u>
2020	<u>n</u>	<u>p</u>	<u>q</u>	<u>r</u>	<u>s</u>	<u>t</u>	<u>u</u>	<u>v</u>	<u>w</u>	<u>x</u>	<u>y</u>	<u>z</u>

D. MEASUREMENT CIRCUIT:

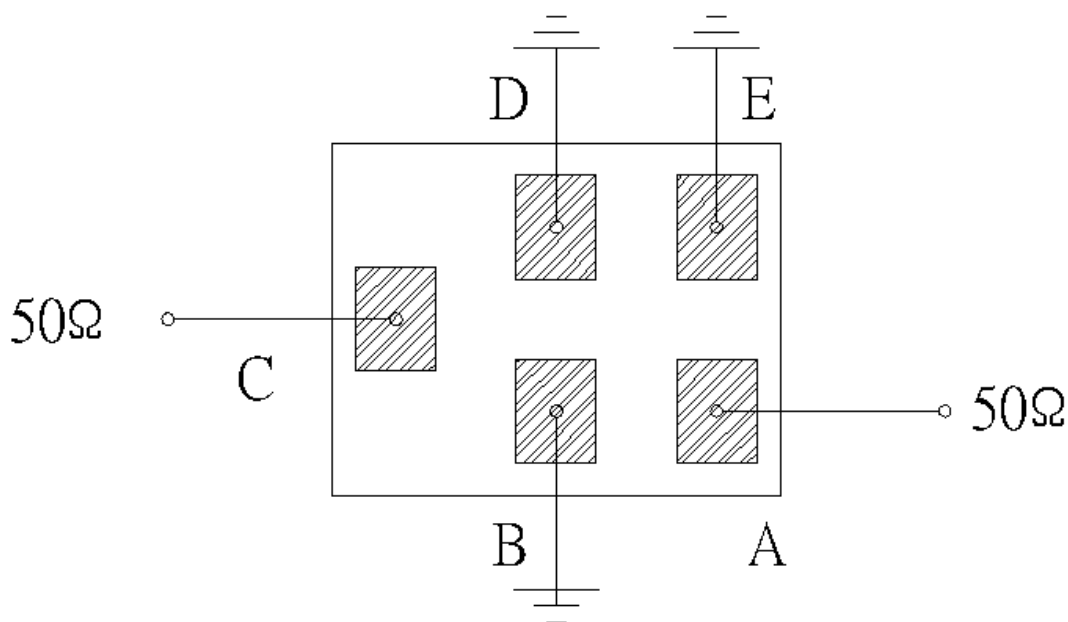

E. Frequency Characteristics :

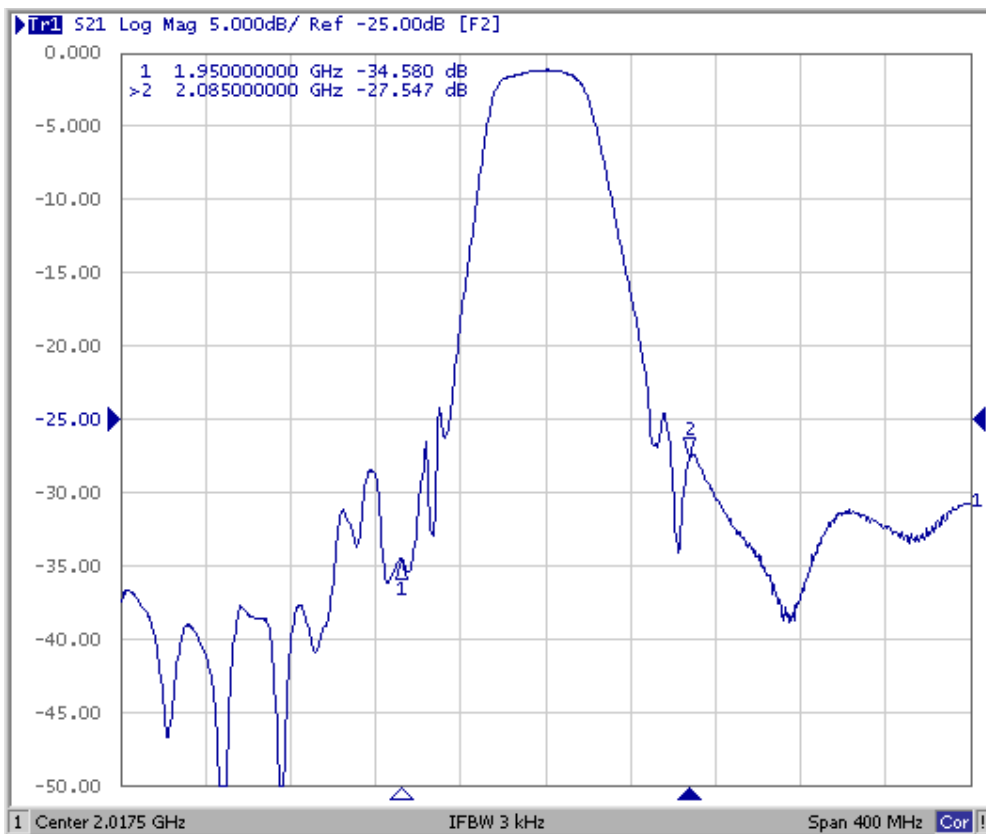
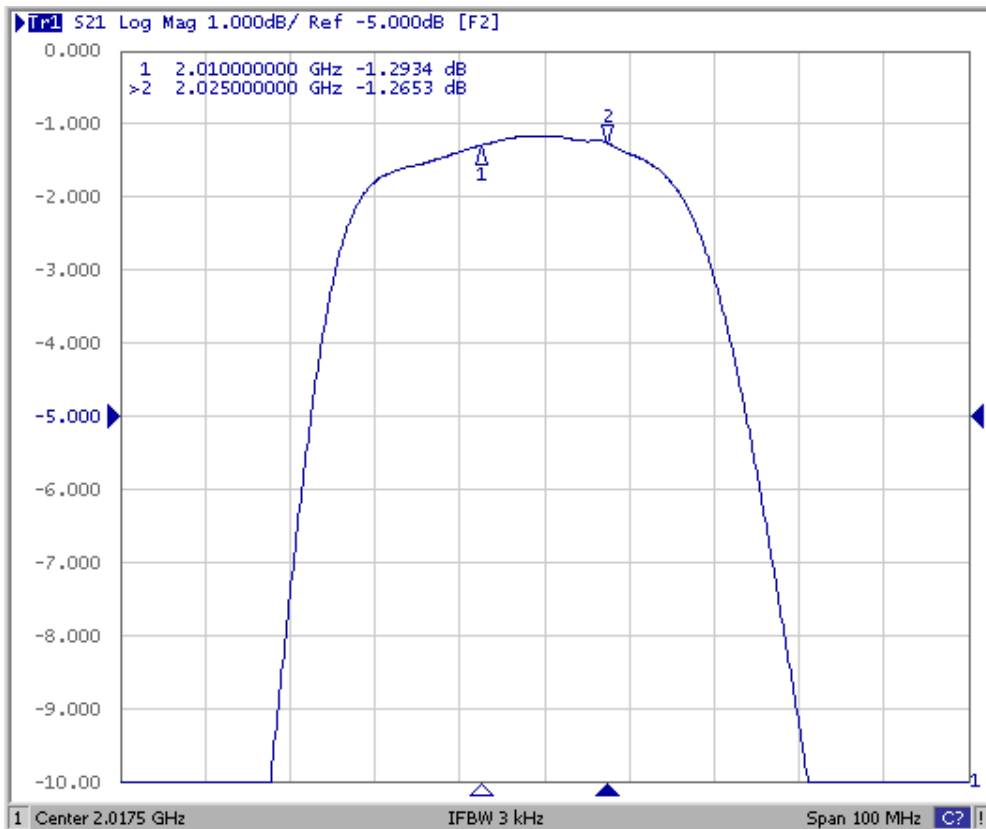

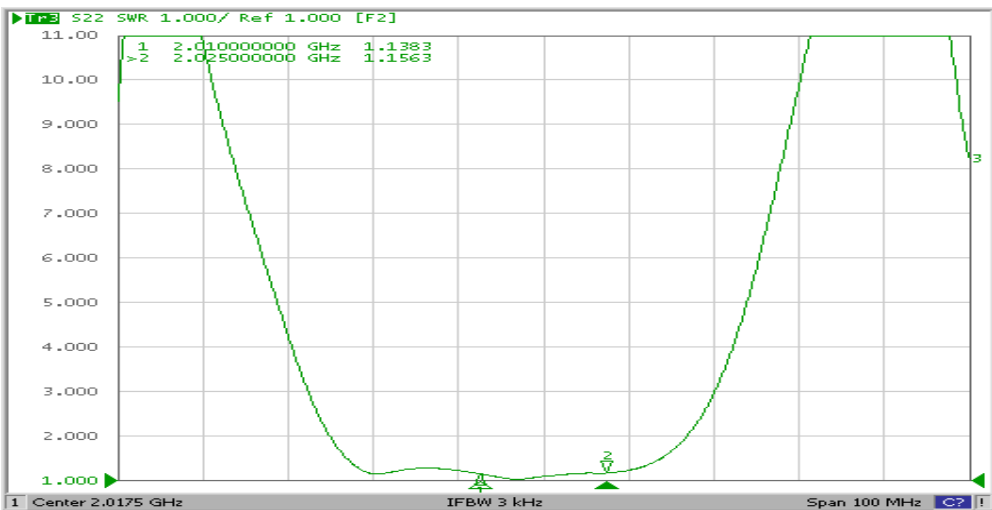
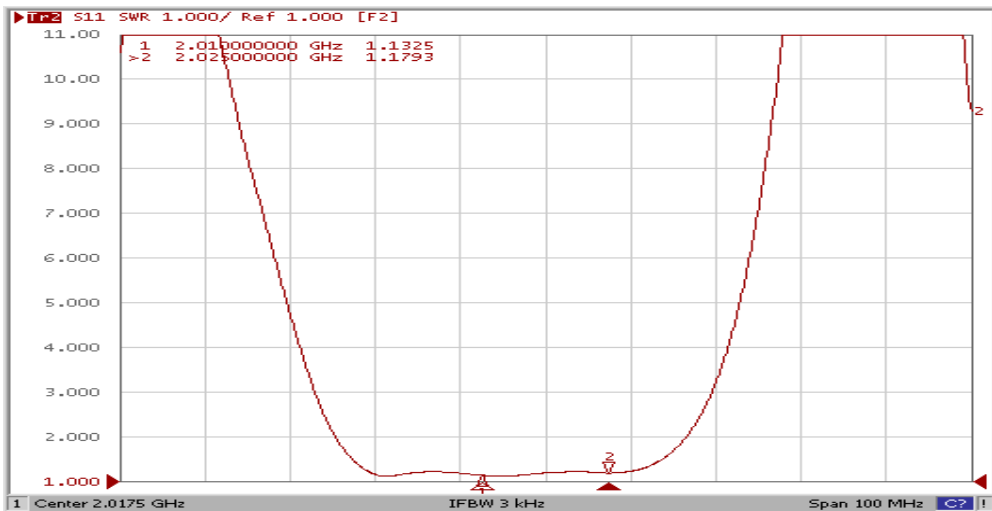
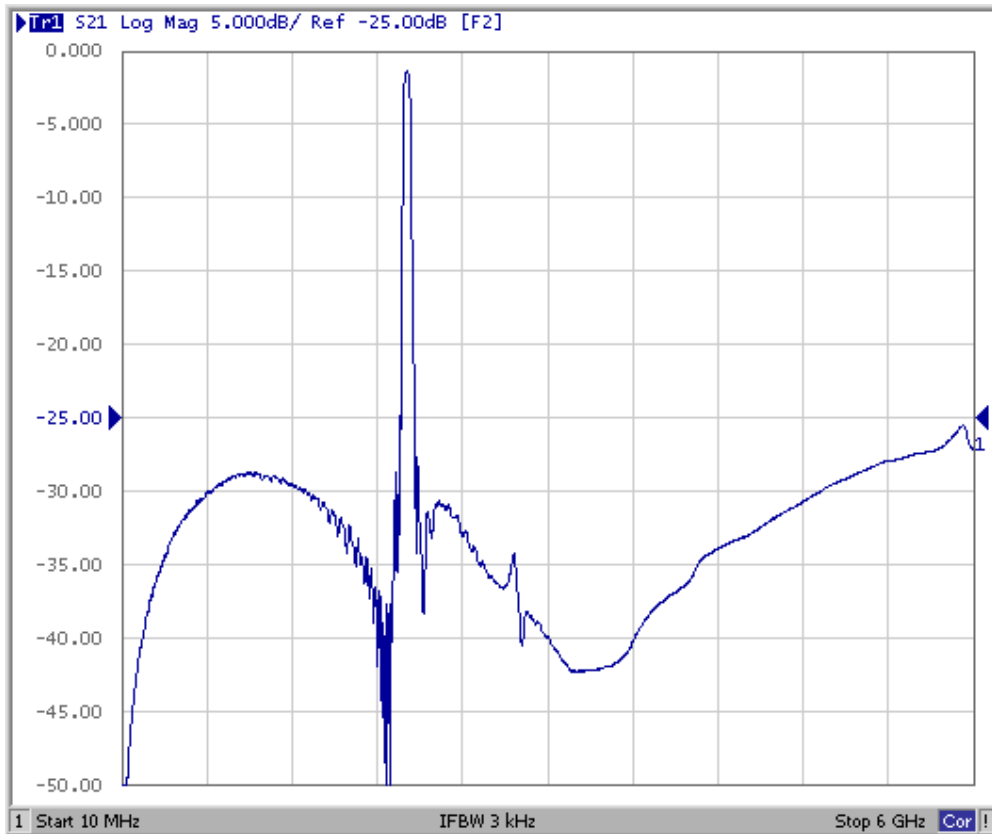

F. PACKING:

1. REEL DIMENSION

(Reel Count : 7"=3000)

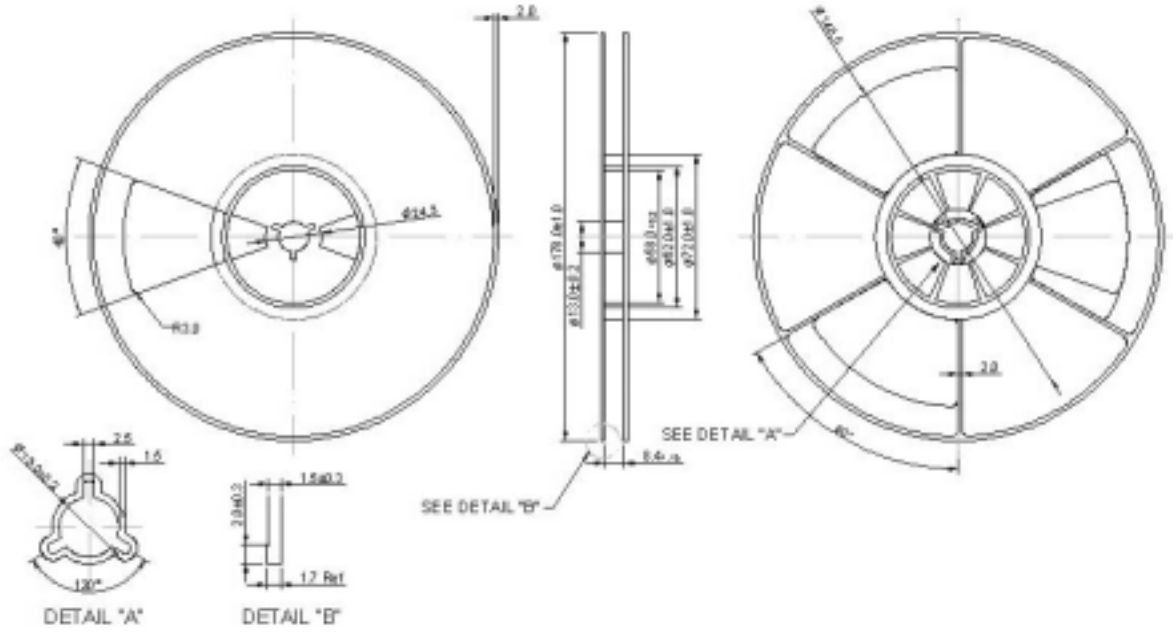

2.TAPE DIMENSION

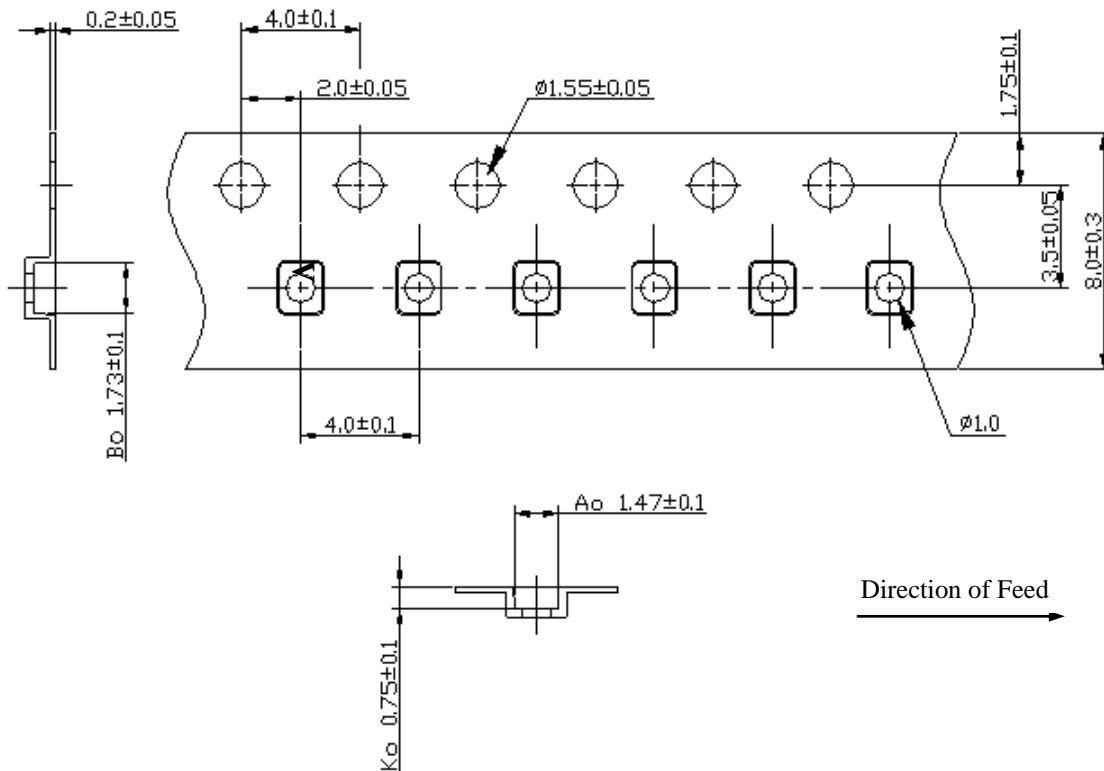

G. RECOMMENDED REFLOW PROFILE :

1. Preheating shall be fixed at 150~180 for 60~90 seconds.
2. Ascending time to preheating temperature 150 shall be 30 seconds min.
3. Heating shall be fixed at 220 for 50~80 seconds and at 245~260 peak (min. 10sec).
4. Time : 2 times.

