

VI TELEFILTER

Filter specification

TFS 434E

1/5

Measurement condition

Ambient temperature: 25 °C
 Input power level: 0 dBm
 Terminating impedance: *
 Input: 466 Ω || -4,3 pF
 Output: 388 Ω || -4,7 pF

Characteristics

Remark:

The reference level for the relative attenuation a_{rel} of the TFS 434E is the minimum of the pass band attenuation. This value is defined as the insertion loss a_e . The nominal frequency f_N is fixed at 434,0 MHz without any tolerance.

Data		typ. value		tolerance / limit	
Insertion loss (reference level)	a_e	7,2	dB	max.	9,0 dB
Nominal frequency	f_N	-			434,0 MHz
Passband	PB			f_N ±	0,625 MHz
Pass band ripple	p-p	0,15	dB	max.	1,0 dB
Pass band ripple in $f_N \pm 0,3125$ MHz		0,15	dB	max.	0,5 dB
Relative attenuation	a_{rel}				
f_N	$f_N \pm 0,625$ MHz	0,40	dB	max.	1,0 dB
$f_N - 20,00$ MHz	$f_N - 2,00$ MHz	45	dB	min.	40,0 dB
$f_N \pm 1,875$ MHz	$f_N \pm 2,00$ MHz	39	dB	min.	35,0 dB
$f_N + 2,00$ MHz	$f_N + 4,00$ MHz	41	dB	min.	37,0 dB
$f_N + 4,00$ MHz	$f_N + 20,00$ MHz	44	dB	min.	40,0 dB
Group delay ripple within PB		84	ns	max.	100 ns
Return loss within PB		18	dB	min.	10 dB
Operating temperature range	OTR	-			- 40 °C ... + 85°C
Storage temperature range		-			- 45 °C ... + 85°C
Frequency inversion temperature		30	°C		
Temperature coefficient of frequency	TC_f **	-0,036	ppm/K ²		

*) The terminating impedances depend on parasitics and q-values of matching elements and the board used, and are to be understood as reference values only. Should there be additional questions do not hesitate to ask for an application note or contact our design team.

***) $\Delta f(\text{Hz}) = TC_f(\text{ppm/K}^2) \times (T - T_0)^2 \times f_{cat}(\text{MHz})$.

Generated:

Checked / Approved:

Tele Filter GmbH
 Potsdamer Straße 18
 D 14 513 TELTOW / Germany
 Tel: (+49) 3328 4784-0 / Fax: (+49) 3328 4784-30
 E-Mail: tft@telefilter.com

VI TELEFILTER reserves the right to make changes to the product(s) and/or information contained herein without notice. No liability is assumed as a result of their use or application. No rights under any patent accompany the sale of any such product(s) or information.

Filter characteristic

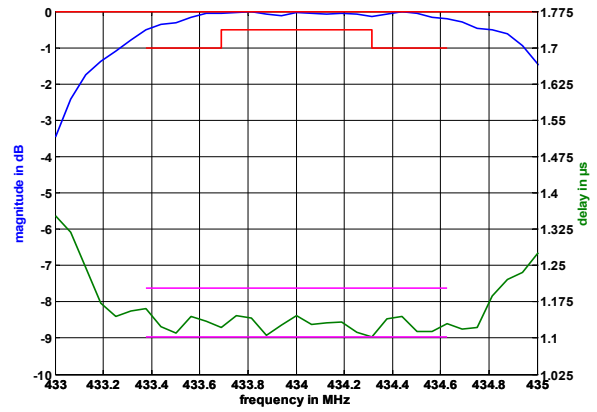
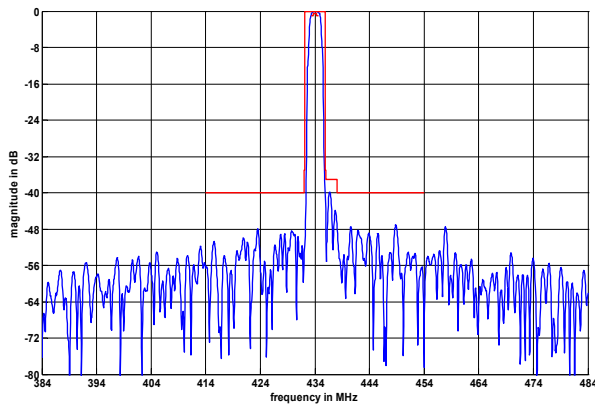

Construction and pin connection

(All dimensions in mm)

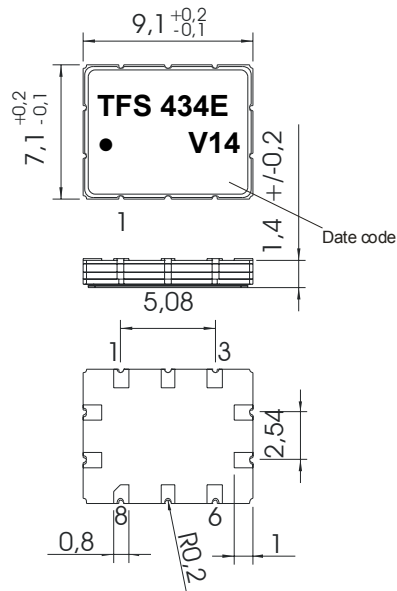

1	Input
2	Input RF Return
3	Ground
4	Ground
5	Ground
6	Output
7	Output RF Return
8	Ground
9	Ground
10	Ground

Date code: Year + week
 V 2007
 W 2008
 X 2009
 ...

50 Ω Test circuit

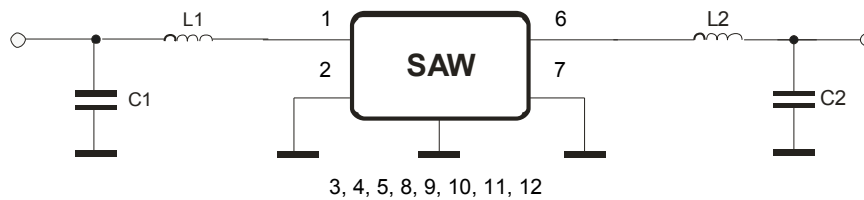

Tele Filter GmbH
 Potsdamer Straße 18
 D 14 513 TELTOW / Germany
 Tel: (+49) 3328 4784-0 / Fax: (+49) 3328 4784-30
 E-Mail: tft@telefilter.com

VI TELEFILTER reserves the right to make changes to the product(s) and/or information contained herein without notice. No liability is assumed as a result of their use or application. No rights under any patent accompany the sale of any such product(s) or information.

Stability characteristics, reliability

After the following tests the filter shall meet the whole specification:

1. Shock: 500g, 1 ms, half sine wave, 3 shocks each plane;
DIN IEC 68 T2 - 27
2. Vibration: 10 Hz to 500 Hz, 0,35 mm or 5 g respectively, 1 octave per min, 10 cycles per plan, 3 plans;
DIN IEC 68 T2 - 6
3. Change of temperature: -55 °C to 125°C / 30 min. each / 10 cycles
DIN IEC 68 part 2 – 14 Test N
4. Resistance to solder heat (reflow): reflow possible: three times max.;
for temperature conditions refer to the attached "Air reflow temperature conditions" on page 4;

This filter is RoHS compliant (2002/95/EG, 2005/618/EG)

Packing

Tape & Reel: IEC 286 – 3, with exception of value for N and minimum bending radius;
tape type II, embossed carrier tape with top cover tape on the upper side;

max. pieces of filters per reel:	2000
reel of empty components at start:	min. 300 mm
reel of empty components at start including leader:	min. 500 mm
trailer:	min. 300 mm

Tape (all dimensions in mm)

- W : 16,00 ± 0,3
- Po : 4,00 ± 0,1
- Do : 1,50 +0,1/-0
- E : 1,75 ± 0,10
- F : 7,50 ± 0,10
- G(min) : 0,60
- P2 : 2,00 ± 0,1
- P1 : 12,00 ± 0,1
- D1(min) : 1,50 +0,1/-0
- Ao : 7,60 ± 0,10
- Bo : 9,60 ± 0,10
- Ct : 13,5

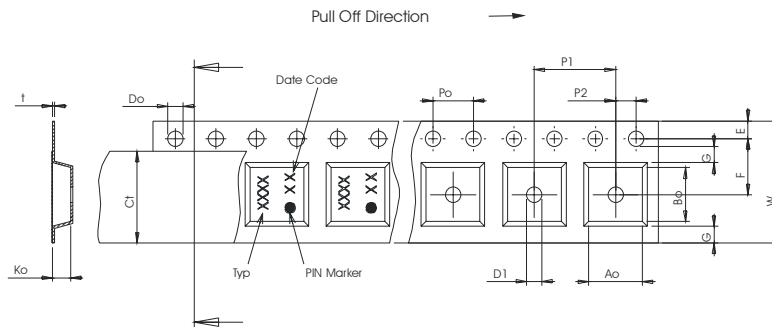

Reel (all dimensions in mm)

- A : 330
- W1 : 16,4
- W2(max) : 22,4
- N(min) : 50
- C : 13,0

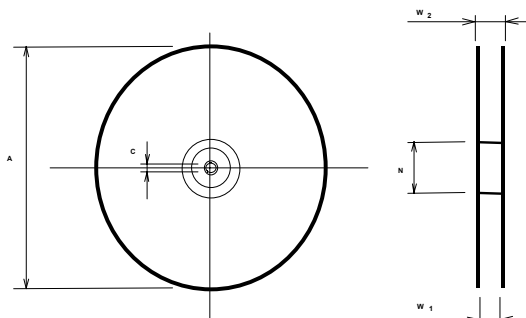

The minimum bending radius is 45 mm.

Tele Filter GmbH
Potsdamer Straße 18
D 14 513 TELTOW / Germany
Tel: (+49) 3328 4784-0 / Fax: (+49) 3328 4784-30
E-Mail: tft@telefilter.com

VI TELEFILTER reserves the right to make changes to the product(s) and/or information contained herein without notice. No liability is assumed as a result of their use or application. No rights under any patent accompany the sale of any such product(s) or information.

Air reflow temperature conditions

Conditions	Exposure
Average ramp-up rate (30°C to 217°C)	less than 3°C/second
> 100°C	between 300 and 600 seconds
> 150°C	between 240 and 500 seconds
> 217°C	between 30 and 150 seconds
Peak temperature	max. 260°C
Time within 5°C of actual peak temperature	between 10 and 30 seconds
Cool-down rate (Peak to 50°C)	less than 6°C/second
Time from 30°C to Peak temperature	no greater than 300 seconds

Chip-mount air reflow profile

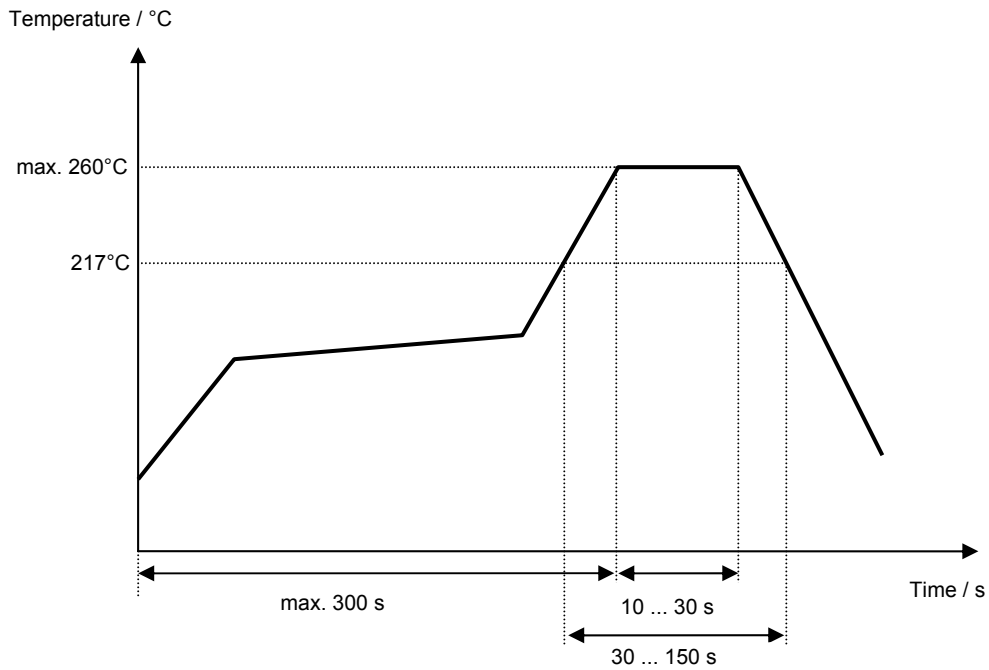

Tele Filter GmbH
 Potsdamer Straße 18
 D 14 513 TELTOW / Germany
 Tel: (+49) 3328 4784-0 / Fax: (+49) 3328 4784-30
 E-Mail: tft@telefilter.com

VI TELEFILTER reserves the right to make changes to the product(s) and/or information contained herein without notice. No liability is assumed as a result of their use or application. No rights under any patent accompany the sale of any such product(s) or information.

VI TELEFILTER**Filter specification****TFS 434E****5/5****History**

Version	Reason of Changes	Name	Date
1.0	- Generation of development specification	Strehl	12.05.2006
1.1	- Add pass band ripple in $f_N \pm 0,3125\text{MHz}$ and change relative attenuation	Strehl	26.07.2006
1.2	- Change group delay ripple within PB	Alawneh	26.02.2007
1.3	- Change from development specification to filter specification - Change relative attenuation - Change group delay ripple within PB - Add terminating impedances - Add typical values - Add filter characteristics - Add matching circuit	Alawneh	05.04.2007

Tele Filter GmbH
Potsdamer Straße 18
D 14 513 TELTOW / Germany
Tel: (+49) 3328 4784-0 / Fax: (+49) 3328 4784-30
E-Mail: tft@telefilter.com

VI TELEFILTER reserves the right to make changes to the product(s) and/or information contained herein without notice. No liability is assumed as a result of their use or application. No rights under any patent accompany the sale of any such product(s) or information.