

Recommended Panel Cut-Out

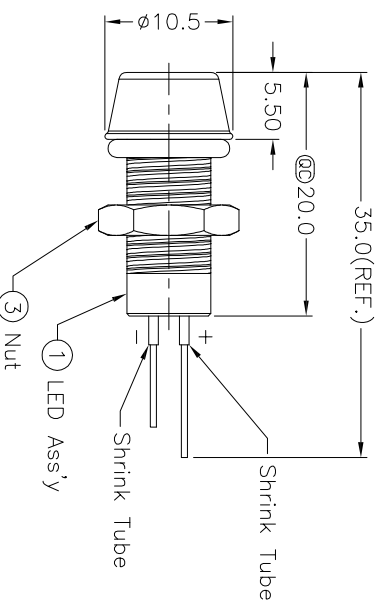

Notes:  
 @@ Important Dimension To Check  
 Waterproof Rate: IP67  
 LED Holder: Brass, Nickel Plating  
 LED:  $\varnothing$  3 mm, Green  
 Gasket: EPDM, Black  
 Screw Nut: Brass, Nickel Plating  
 Operating Voltage: DC 4V  
 Operating Temperature:  $-40 \sim +80^{\circ}\text{C}$   
 For Panel Thickness 6.5mm Max.  
 ① Nut Torque:  $2.5 \sim 3.5 \text{ kgf}\cdot\text{cm}$

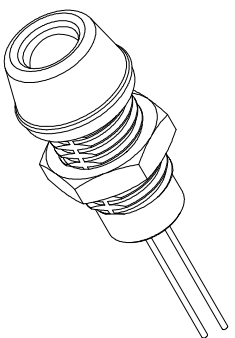
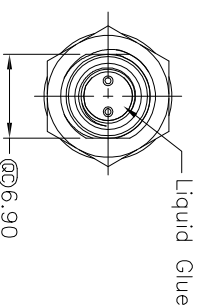
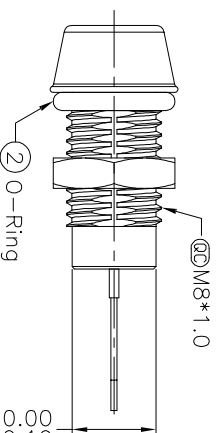
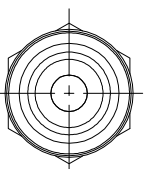

**RoHS compliant**

Scale	Free	Customer-No.	
TOLERANCE		ASSMANN WSW-No.	A-LED8-1GAAS-MR7-1
.X	$\pm 0.25$	Drawn	11.03.2014 Winnie
.XX	$\pm 0.10$	Approved	07.05.2014 Winnie
.XXX	$\pm 0.05$		
Angle	$\pm 1^{\circ}$		
		① Add the nut torque	07.05.2014 Winnie
		② Drawn	11.03.2014 Winnie
		③ Id.	
		Modification	
		Date	
		Name	

**ASSMANN**  
 WSW components

Drawing-No. ASS 6228 CO rev01  
 Replace Sheet

1	2	3	4	5	6	7
A	B	C	D	E	F	G