

Ansaughaube
hood

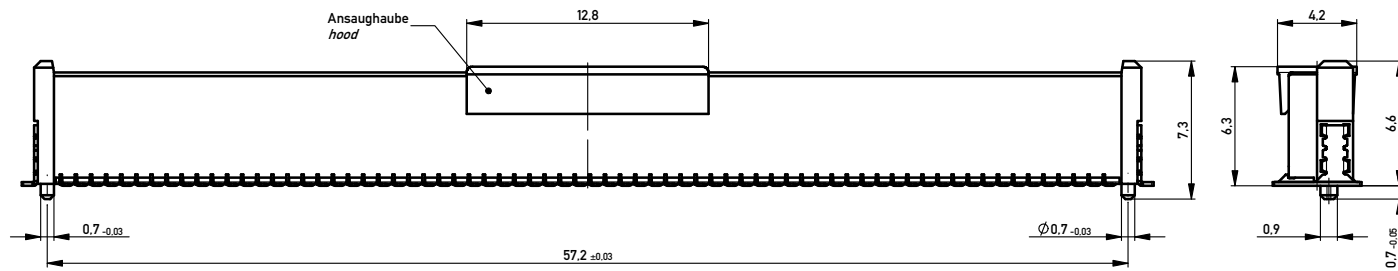

Verpackt in Gurtverpackung - *Tape on Reel Packaging*
Verpackungseinheit: 670 Stück - *Packaging unit: 670 pcs*

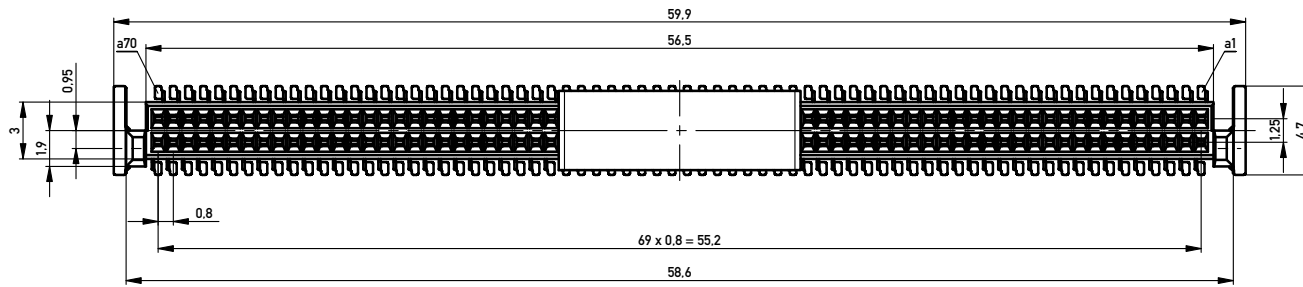
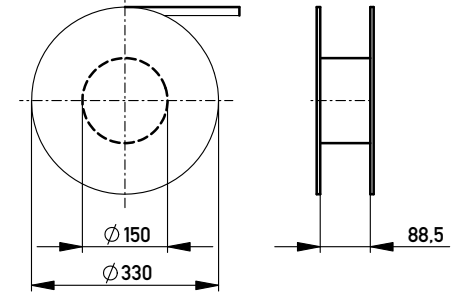

ohne Ansaughaube - *without hood*

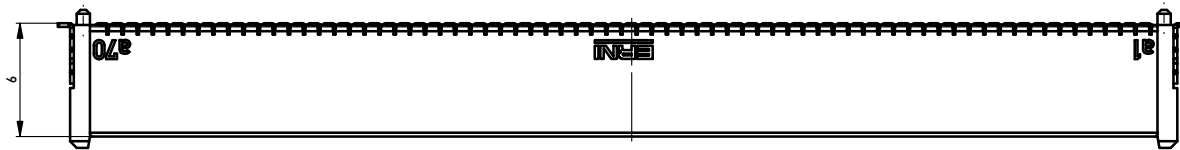

Anforderungsstufe 2
Performance Level 2

Kontaktbereich vergoldet
Mating Area gold plating

Anschlussbereich verzinkt 4-6 µm
Terminal Area 4-6 µm tin plating

Koplanarität der Anschlüsse ≤ 0.1 mm
Coplanarity Area of Termination ≤ 0.1 mm

Leiterplatten-Layout Vorschlag für SMT
PCB-Layout Proposal for SMT

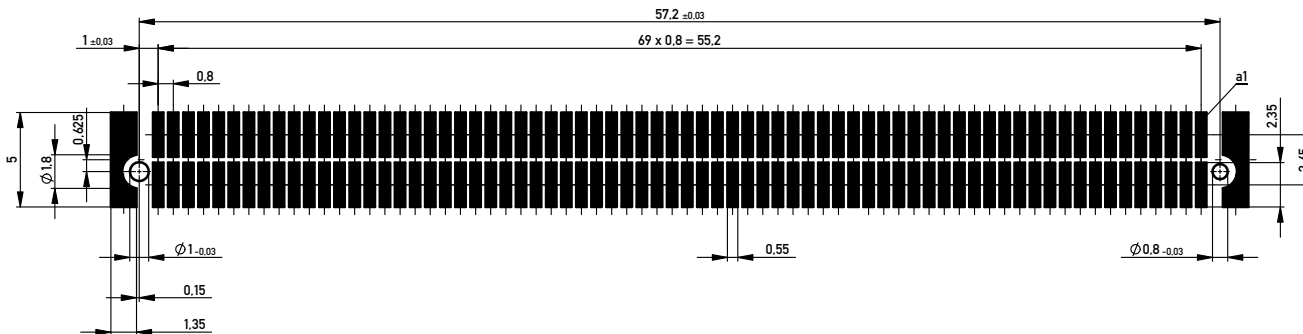

Abspulrichtung - *Reel off Direction*

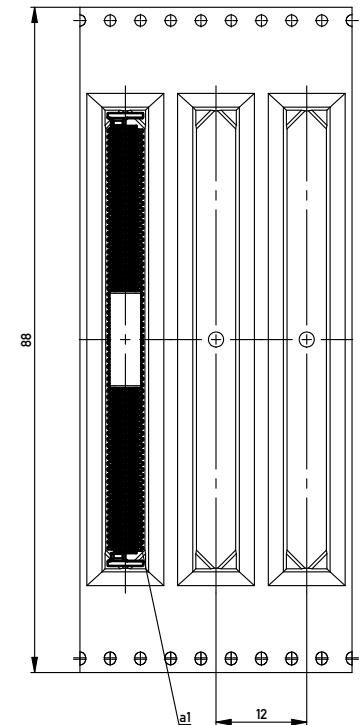

Information:	Tolerances	Scale	5:1
All rights reserved. Only for Information. To ensure that this is the latest version of this drawing, please contact one of the ERNI companies before using.	Subject to modification without prior notice. Drawing will not be updated.	 All Dimensions in mm	Designation
			0.8 DRC-B, F 6mm, 140 polig 0.8 DRC-B, F 6mm, 140 pin
<small>Copyright by ERNI GmbH Proprietary notice pursuant to ISO 16093 to be observed</small>	 www.ERNI.com	294023	I A2
Index	Date	Class	DRCB