

REV	DESCRIPTION	BY	DATE	APPD
C	ECN 2295	66/02/01	1/01	JMC

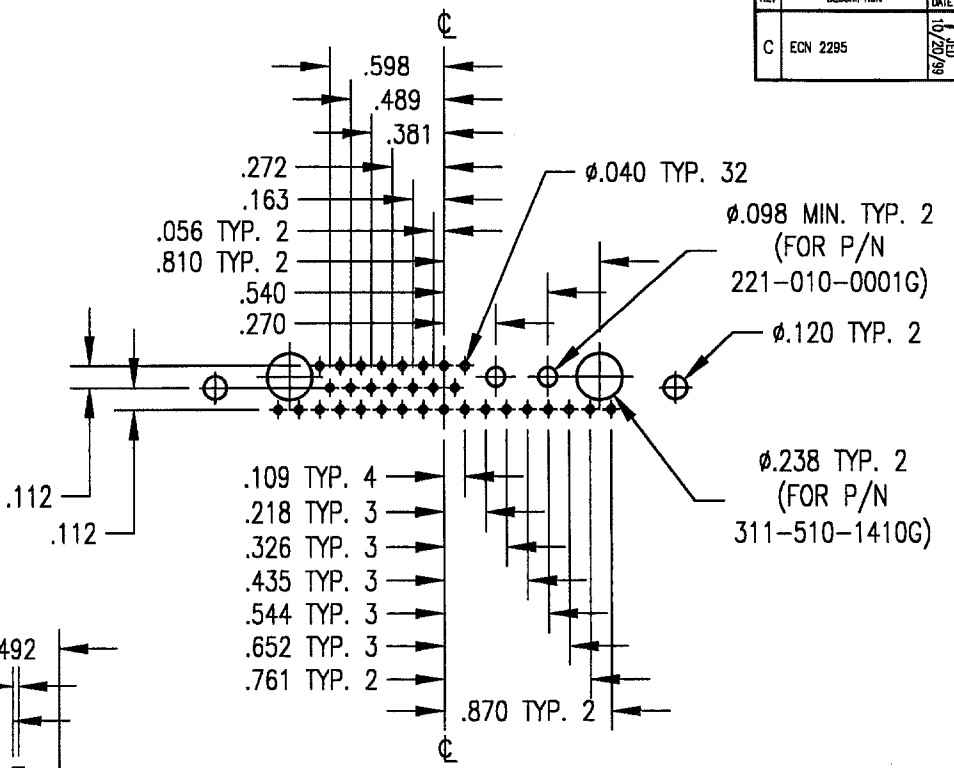
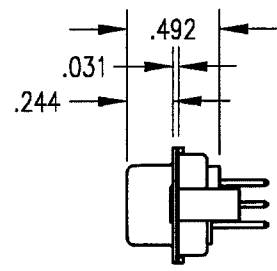
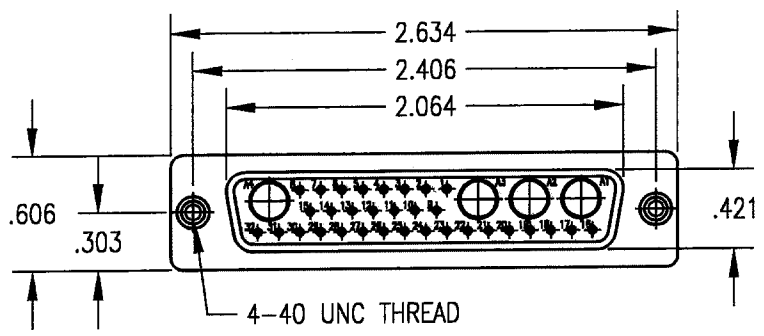
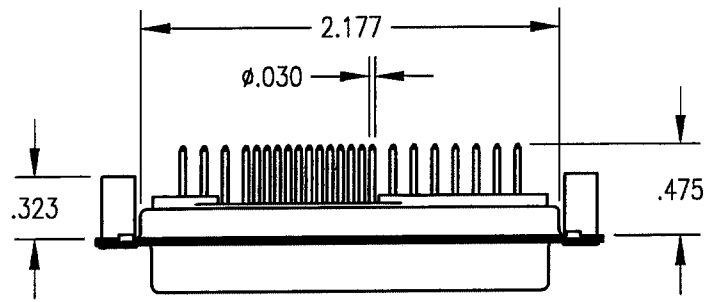

FOOTPRINT
VIEWED FROM COMPONENT SIDE OF P.C.B.

NOTES:

- MATERIALS:
SHELL: STEEL PER ASTM A568
INSULATOR: GLASS FILLED POLYESTER
SIGNAL CONTACTS: BERYLLIUM COPPER PER ASTM B196
STAND OFFS: BRASS PER ASTM B16
- FINISH:
SHELL AND STAND OFFS: YELLOW CHROMATE OVER ZINC PER ASTM B633
INSULATOR: GREEN
SIGNAL CONTACTS: .000030 MIN. GOLD PER MIL-G-45204 OVER
.000050 MIN. NICKEL PER QQ-N-290

PER ASME Y14.5M-1994 UNLESS OTHERWISE SPECIFIED: DIMENSIONS ARE IN INCHES OR INCHES/MM TOLERANCES: DECIMALS .XX ± .01/0.254 XXX ± .005/0.127 ANGLES ± 2° SCALE: 1:1		Litton Winchester Electronics/RETCONN <small>400 Park Road Waterbury, Connecticut 06705</small>	
CUSTOMER DRAWING		TITLE D-SUB MIXED LAYOUT 36W4S	
DRAWN E. WEST	DATE 9/20/99	CHECKED JED	DATE 9/21/99
APPROVED JMC	DATE 9/21/99	APPROVED JC	DATE 9/21/99
A		RM36W4S-1014	SHT. OF REV. 1 1 C