

CIRCUIT: SPDT
CONTACT CONFIGURATION

SWITCH FUNCTION		
PDS: 1	PDS: 2	PDS: 3
<DN>	OFF	<DN>
2-3	OPEN	2-1

<DN> = MOMENTARY

- NOTES:
1. ALL DIMENSIONS IN MM [INCH]
 2. GENERAL TOLERANCE: X.X=±0.4
X.XX=±0.25
 3. TERM. NO'S. FOR REF. ONLY
 4. CONTACT RATING: 3A @120 VAC OR 28VDC, 1A @250VAC
 5. ELECTRIC LIFE: 30,000 make-and-break cycles
at full load.
 6. INSULATION RESISTANCE: 1,000 M ohm min.
 7. DIELECTRIC STRENGTH: 1,000 V RMS @sea level.
 8. OPERATING TEMP.: -30°C to 85°C
 9. ▲ DENOTES CRITICAL PARAMETER.
 10. 2002/95/EC (ROHS) COMPLIANT

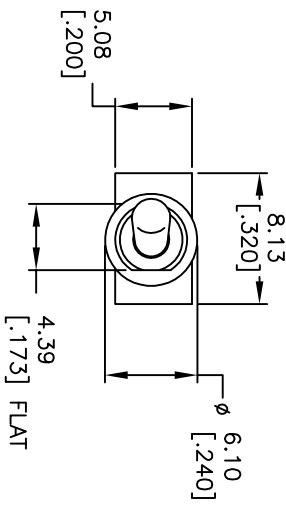
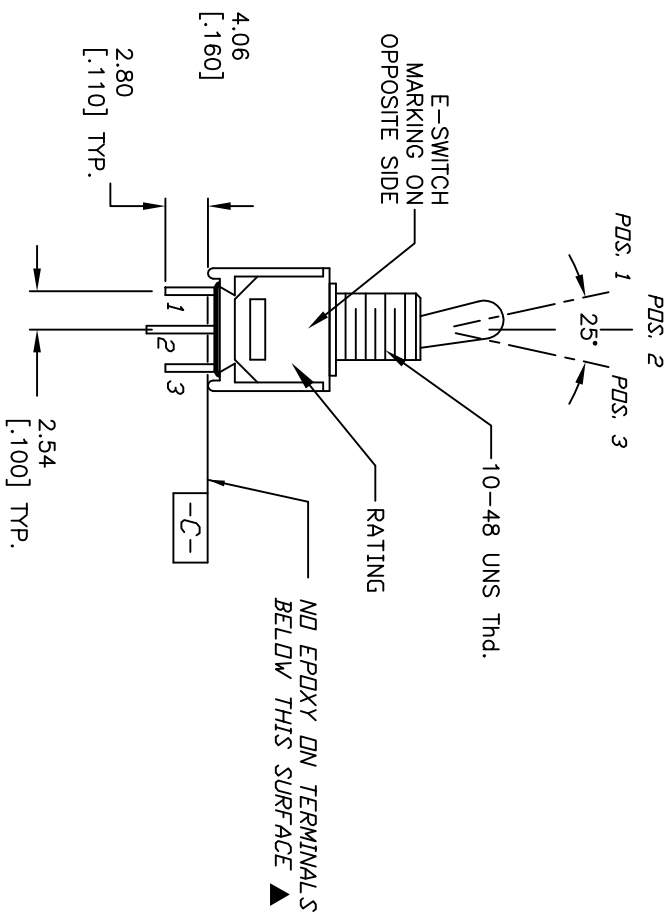
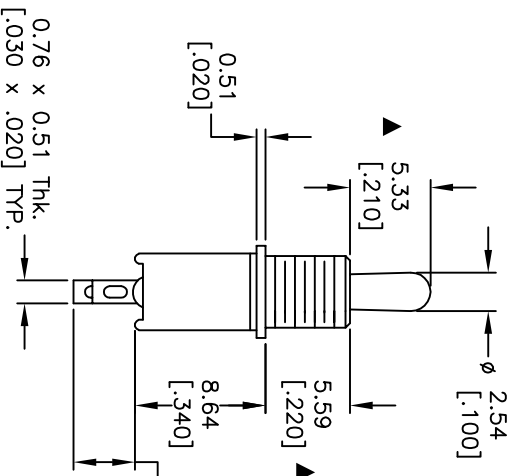

REV.	PCR No.	DESCRIPTION	DATE	CHKD
B	19387	TERMINALS DRAWN AS M1, UPDATES	10/27/10	BLR
A	13118	RELEASED FOR PRODUCTION	5/8/03	AR

TITLE	SCALE	DATE	DR	DWG	REV
200MSP4T2B1M1QE	2:1	5/8/03	AR	T221002	B



THE INFORMATION CONTAINED IN THIS DOCUMENT IS PROPRIETARY TO E-SWITCH AND IS NOT TO BE COPIED OR TRANSFERRED