

## CMATVS3V3 CMATVS5V0

### 3.3V and 5.0V Transient Voltage Suppressors in ultra miniature SOD-923 package

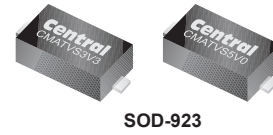

Central Semiconductor's CMATVS3V3 and CMATVS5V0 are low leakage, fast response Transient Voltage Suppressors packaged in the space saving SOD-923 surface mount case. These devices are designed to protect the most size constrained static sensitive electronic equipment from ESD damage.

#### Features:

- Miniature package (1.0 x 0.6 x 0.4mm)
- Logic level compatible
- Low leakage current
- ESD protection IEC 61000-4-2:Level 4 (15kV)

#### Applications:

- Data line / User interface protection
- DC power rail clamping
- ESD protection of logic level ICs

#### Benefits:

- Low idle power consumption
- Industry standard SOD-923 outline
- Low profile
- Space saving

#### Literature:



New  
SMD  
SELECTION  
GUIDE

Order your selection guide today.  
Visit: [web.centrasemi.com/search/sample.php](http://web.centrasemi.com/search/sample.php)

#### Typical Electrical Characteristics

8 x 20  $\mu$ s Pulse Waveform

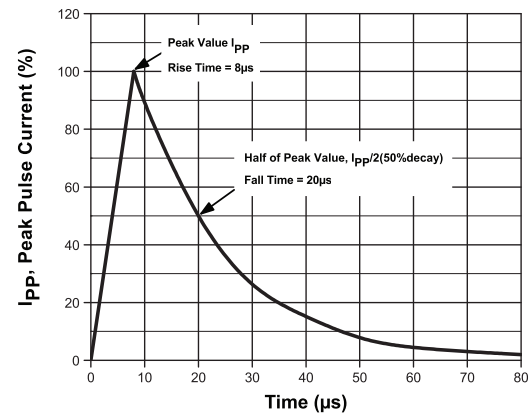

#### Samples:



To order samples of this device visit:  
[www.centrasemi.com/info/CMATVS](http://www.centrasemi.com/info/CMATVS)

weblink scan

Use QR reader  
for direct link to  
product web page.



Electrical Characteristics: ( $T_A = 25^\circ\text{C}$ )  $V_F = 0.9\text{V MAX @ } I_F = 10\text{mA}$  (for all types)

Type	Maximum Reverse Stand-off Voltage $V_{RWM}$	Minimum Breakdown Voltage $V_{BR @ I_T}$	Test Current $I_T$	Maximum Reverse Leakage Current $I_R @ V_{RWM}$	Maximum Clamping Voltage $V_C @ I_{PP}$	Peak Pulse Current $I_{PP}$	Typical Capacitance @ 0V Bias $C$
	V	V	mA	$\mu$ A	V	A	pF
CMATVS3V3	3.3	5.0	1.0	2.5	11	7.0	45
CMATVS5V0	5.0	6.2	1.0	1.0	12.3	7.0	40

# CMATVS3V3 CMATVS5V0

## 3.3V and 5.0V Transient Voltage Suppressors in ultra miniature SOD-923 package

### Mechanical Drawing - SOD-923

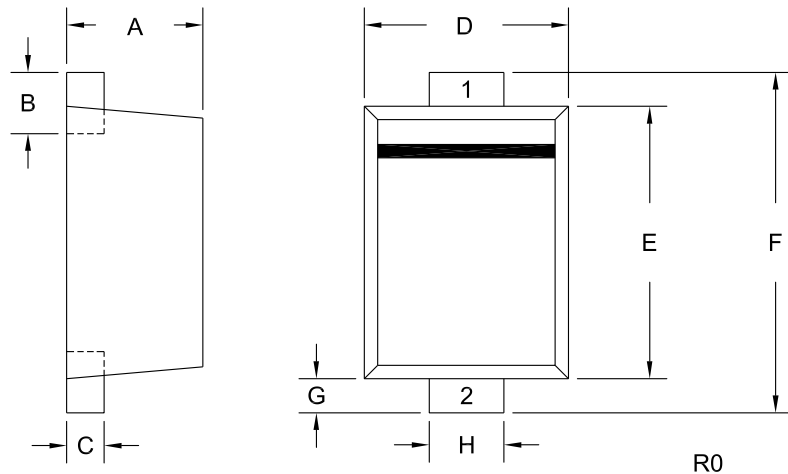

SYMBOL	DIMENSIONS			
	INCHES		MILLIMETERS	
	MIN	MAX	MIN	MAX
A	0.015	0.016	0.39	0.41
B	0.004	0.010	0.10	0.26
C	0.003	0.006	0.08	0.14
D	0.022	0.026	0.55	0.65
E	0.030	0.033	0.75	0.85
F	0.035	0.043	0.90	1.10
G	0.002	0.006	0.05	0.15
H	0.007	0.011	0.17	0.27

SOD-923 (REV: R0)

### Lead Code

- 1) Cathode
- 2) Anode

### Part Marking

DEVICE	MARKING CODE
CMATVS3V3	E
CMATVS5V0	F

### Tape Dimensions and Orientation (Dimensions in mm)

Tape Width: 8mm

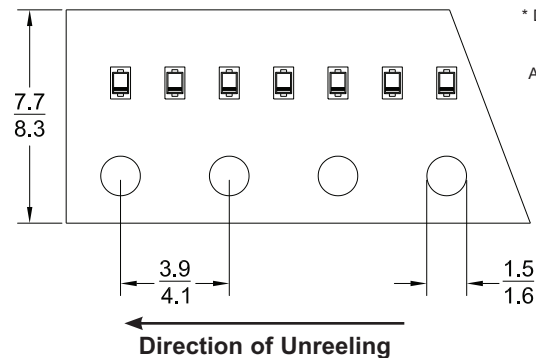

\* Devices are taped in accordance with Electronic Industries Association Standard EIA-481-1-A

### Packaging Base / Ordering Information

Reel Size	Quantity	Central Item No.
7"	8,000	CMATVS3V3 TR
		CMATVS5V0 TR

### Reel Packing Information

Reel Size	Reels per Box (Maximum)	Parts per Box (Maximum)	Box Dimensions		Shipping Weight (Max.)	
			INCH	CM	LB	KG
7"	9	72,000	9x9x5	23x23x13	3	2
	18	144,000	9x9x9	23x23x23	6	3
	40	320,000	21x9x9	53x23x23	13	6
	108	864,000	27x9x17	69x23x43	34	16

Sample devices available upon request. To order samples of this device visit: [www.centrasemi.com/info/CMATVS](http://www.centrasemi.com/info/CMATVS)



**Innovative Discrete  
Semiconductors**

For further information contact:  
Sales at Central Semiconductor Corp.  
(631) 435-1110 or visit our website at:  
[www.centrasemi.com](http://www.centrasemi.com)