

RMS4096-S24/L2A

Encoders

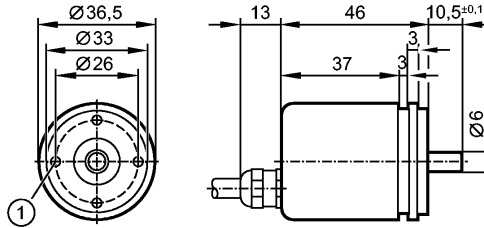

M3 6 mm deep

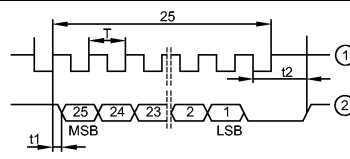

Product characteristics

Multiturn	
SSI data interface	
Cable	
SSI data interface	
8192 revolutions	
Resolution 4096	
Electrical data	
Operating voltage [V]	4.5...30 DC
Current consumption [mA]	< 30
Code	Gray code; increasing code values when turned clockwise (seen on the shaft)
Code signal	Clock input: TTL compatible signals, clock and clock (inv.) from driver to RS 422 Data output: synchronous serial, TTL compatible signals data and data (inv.)
Pulse diagram	 <p>1 clock 2 data</p>
Inputs	
Inputs	reversal of direction of rotation, reset to zero
Outputs	
Output function	SSI data interface
Measuring / setting range	
Resolution	25 bits
Mechanical data	
Max. permissible rpm / mech. [1/min]	12000
Starting torque [Ncm]	< 3 (25 °C)
Max. shaft load (at the shaft end) [N]	axial 40; radial 110
Shaft, material [mm]	Ø 6, steel
Vibration resistance	30 g (10...1000 Hz)
Shock resistance	< 300 g (6 ms)
Housing materials	flange: aluminium; housing: steel powder coated
Weight [kg]	0.38
Environment	
Max. relative air humidity [%]	98
Ambient temperature [°C]	-40...85, -40 °C for firmly laid cable / -30 °C for flexibly laid cable
Protection	IP 65; IP 65 (housing); IP 64 (shaft)
Electrical connection	
Connection	PUR cable / 2 m; axial
Max. cable length [m]	100

# RM8001 - Multiturn - eclass: 27270590 / 27-27-05-90

## Wiring

white: sensor 0 V  
brown: sensor Ub  
green: clock  
yellow: clock (inv.)  
grey: data  
pink: data (inv.)  
blue: reset to zero  
red: reversal of direction of rotation

Screen: housing

Remarks

Remarks

Wires/pins not connected (n.c.) must not be used!

Pack quantity

[piece]

1

ifm electronic gmbh • Friedrichstraße 1 • 45128 Essen — We reserve the right to make technical alterations without prior notice. — GB — RM8001 — 19.10.2012