

SPECIFICATIONS

ISA Connector

Mechanical

Contact Retention Force: 1.80kgf min.
Mating Force: 340gf max. per Contact Pair
Unmating Force: 28gf min. per Contact Pair
Durability: 500 Cycles

ES Series

Vertical Type, Outer Kink
2.54mm [.100"] Pitch
44 Pos.

Electrical

Current Rating: 3A max.
Current Voltage: 250V AC
Contact Resistance: 15mW max. initial
Dielectric Withstanding Voltage: 1000V
Insulation Resistance: 5000MW min.

Physical

Housing: Thermoplastic, UL 94V-0 rated, in Black Color
Contact: Copper alloy
Plating: See "ORDERING INFORMATION"
Operating Temperature: -55 to +85

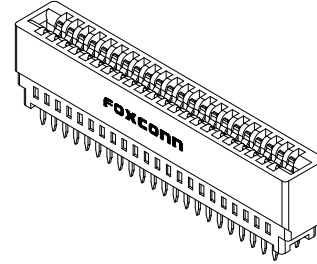

DRAWING

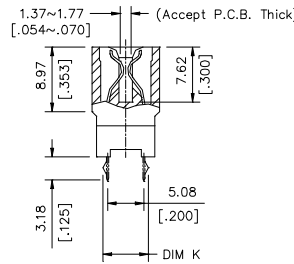
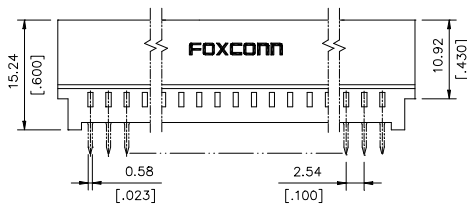
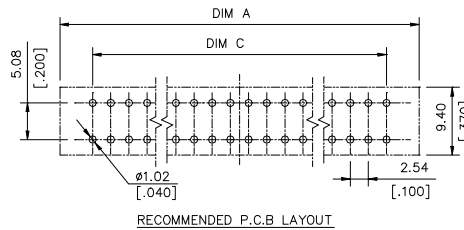
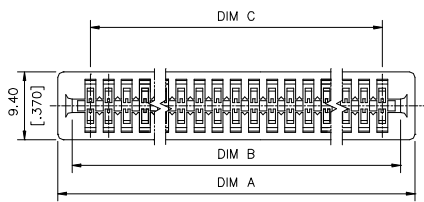

ORDERING INFORMATION

PRODUCT NO.: ES 0 2 2 0 * - K1

Series Prefix
 2.54 [.100] Pitch
 Edge Card Conn.

Termination Type
 0=Straight

No. of Pos.
 22=44 Pos.

Extension Code
 K1=Outer Kink

Contact Area Plating
 1=Gold Flash
 2=20u" Gold
 3=30u" Gold
 6=10u" Gold
 7=15u" Gold

Tail Length Type
 0=3.18 [.125]

ES0220*-K1	62.49 [2.460]	58.41 [2.300]	53.34 [2.100]	6.35 [.250]
P/N	DIM. A	DIM. B	DIM. C	DIM. K

All specification & dimensions are subject to change, please call your nearest Foxconn sales representative for update information.