

iC-SD85 BLCC SD1C

Infrared LED

FEATURES

Emission peak at 850 nm matched to silicon detectors and opto ICs
 Narrow irradiance pattern
 High temperature range -40 to 125 °C
 High switching speed
 Packages suitable for SMT mounting

APPLICATIONS

Illumination for high resolution optical encoder
 Modulated light barriers

PACKAGE

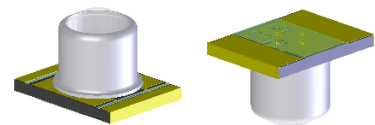

BLCC SD1C

DIMENSIONS

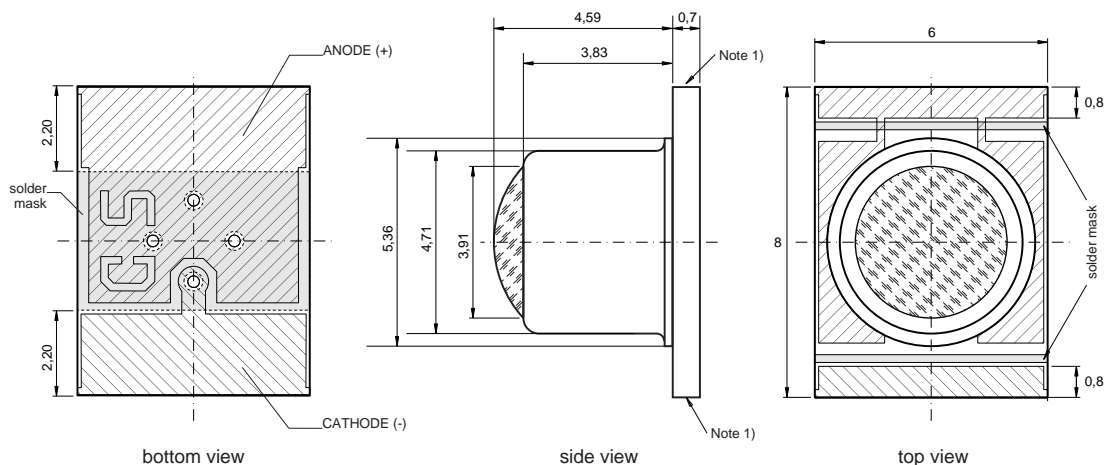

All dimensions in mm

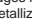
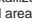
Notes:
 1) Edges metallized
 2) Metallized areas indicated with  or 



iC-SD85 BLCC SD1C

Infrared LED

PACKAGES

PIN CONFIGURATION SD1C

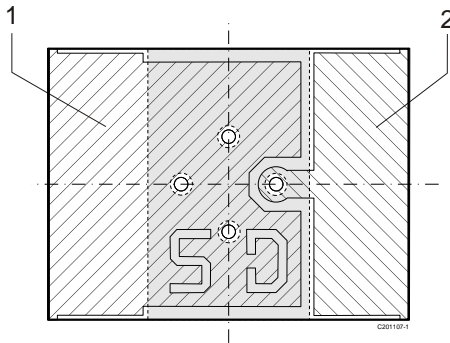

bottom view

PIN FUNCTIONS

No. Name Function

1	A	Anode
2	C	Cathode

ABSOLUTE MAXIMUM RATINGS

Beyond these values damage may occur (Ta = 25°C, unless otherwise noted)

Item No.	Symbol	Parameter	Conditions	Min.		Max.		Unit
G001	IF	Forward current (DC)				50		mA
G002	IFM	Peak forward current	tp ≤ 50μs, tp/T=0,5			100		mA
G003	IFSM	Surge forward current	tp ≤ 10μs			1000		mA
G004	VR	Reverse voltage				5		V
G005	P	Power dissipation	Case temperature 25°C			150		mW

All voltages are referenced to ground unless otherwise stated.

All currents flowing into the device pins are positive; all currents flowing out of the device pins are negative.

iC-SD85 BLCC SD1C

Infrared LED



Rev A1, Page 3/4

THERMAL DATA

Item No.	Symbol	Parameter	Conditions				Unit
				Min.	Typ.	Max.	
T01	Ta	Operating Ambient Temperature Range		-40		125	°C
T02	Ts	Storage Temperature Range		-40		125	°C
T03	Tpk	Reflow Soldering Peak Temperature	Convection reflow: tpk < 20 s, TOL (time on label) 8 h Please refer to customer information file No. 7 for details. Not suitable for vapor phase soldering.			260	°C
T04	Rthja	Thermal resistance junction to ambient			270		K/W

ELECTRICAL CHARACTERISTICS

Ta = 25 °C, unless otherwise noted

Item No.	Symbol	Parameter	Conditions				Unit
				Min.	Typ.	Max.	
Electrical and Optical Characteristics							
001	V _F	Forward Voltage	IF = 10 mA		1.65	1.9	V
002	V _F	Forward Voltage	IF = 20 mA		1.75	2.0	V
003	V _R	Reverse Voltage	IR = 100 µA	5			V
004	φ _e	Radiant Power	IF = 10 mA	0.5	0.9		mW
005	φ _e	Radiant Power	IF = 20 mA	1.0	1.8		mW
006	TK(φ _e)	Temperature Coefficient of Radiant Power	IF = 5 mA, Ta = 25 °C...125 °C		-0.6		%/K
007	λ _p	Peak Wavelength	IF = 10 mA	830	850	870	nm
008	Δλ	Spectral Half Width	IF = 10 mA		26		nm
009	2φ	Divergence	IF = 10 mA		8		deg.
010	tr, tf	Switching Time	IF = 10 mA		50		ns

iC-Haus expressly reserves the right to change its products and/or specifications. An info letter gives details as to any amendments and additions made to the relevant current specifications on our internet website www.ichaus.de/infoletter; this letter is generated automatically and shall be sent to registered users by email.

Copying – even as an excerpt – is only permitted with iC-Haus' approval in writing and precise reference to source.

iC-Haus does not warrant the accuracy, completeness or timeliness of the specification and does not assume liability for any errors or omissions in these materials.

The data specified is intended solely for the purpose of product description. No representations or warranties, either express or implied, of merchantability, fitness for a particular purpose or of any other nature are made hereunder with respect to information/specification or the products to which information refers and no guarantee with respect to compliance to the intended use is given. In particular, this also applies to the stated possible applications or areas of applications of the product.

iC-Haus conveys no patent, copyright, mask work right or other trade mark right to this product. iC-Haus assumes no liability for any patent and/or other trade mark rights of a third party resulting from processing or handling of the product and/or any other use of the product.

As a general rule our developments, IPs, principle circuitry and range of Integrated Circuits are suitable and specifically designed for appropriate use in technical applications, such as in devices, systems and any kind of technical equipment, in so far as they do not infringe existing patent rights. In principle the range of use is limitless in a technical sense and refers to the products listed in the inventory of goods compiled for the 2008 and following export trade statistics issued annually by the Bureau of Statistics in Wiesbaden, for example, or to any product in the product catalogue published for the 2007 and following exhibitions in Hanover (Hannover-Messe).

We understand suitable application of our published designs to be state-of-the-art technology which can no longer be classed as inventive under the stipulations of patent law. Our explicit application notes are to be treated only as mere examples of the many possible and extremely advantageous uses our products can be put to.

iC-SD85 BLCC SD1C

Infrared LED

preliminary



Rev A1, Page 4/4

ORDERING INFORMATION

Type	Package	Options	Order Designation
iC-SD85	SD1C		iC-SD85 BLCC SD1C

For technical support, information about prices and terms of delivery please contact:

iC-Haus GmbH
Am Kuemmerling 18
D-55294 Bodenheim
GERMANY

Tel.: +49 (61 35) 92 92-0
Fax: +49 (61 35) 92 92-192
Web: <http://www.ichaus.com>
E-Mail: sales@ichaus.com

Appointed local distributors: http://www.ichaus.com/sales_partners