

PCB Mountable Test Point Terminals

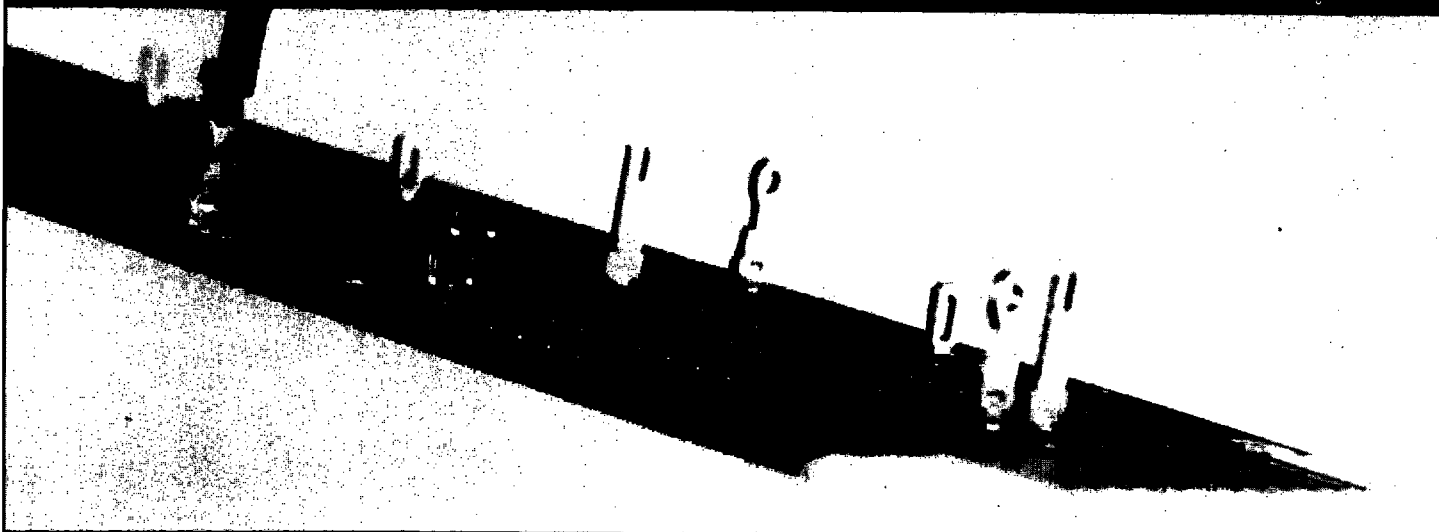

Zierick PCB test point terminals are available for either Accu-Lok™ or press-fit mounting. They come in both high or low profile configurations. Test engineers can easily attach J hooks, EZ hooks, lead grabbers, clips and other test probes. Zierick PCB test points offer exceptional flexibility, even in blind situations.

Zierick Accu-Lok™ test point terminals offer a unique method of assuring reliable PCB mounting. Developed for easy PCB assembly, Accu-Lok™'s retentive mounting feature produces exceptional PCB assembly and interconnection characteristics. Accu-Lok™'s will outperform all other interference fit, press fit and compliant fit type PCB terminals.

Accu-Lok™ terminals end the need for the tight mounting hole tolerance required with traditional press and compliant fit terminals. With the Accu-Lok™ mounting leg design, the terminal leg enters freely within the PCB mounting hole. It mounts without producing stress, deformation, cracks or warpage to the PCB. PCB retention is accomplished by a controlled splitting and forming of the terminal leg. With a mounting hole tolerance as great as $\pm 0.004"$ ($\pm 0.10\text{mm}$) this produces superior retentive strength, perpendicularity and solder joint integrity.

With Accu-Lok™ mounting, test points will withstand forces applied to the terminal. Forces due to mating, withdrawal, vibration, shock, temperature cycles, etc., are not transferred to the PCB solder joint. Positive terminal retention assures mounting reliability. PCB quality improves. The instances of fractured, loose, or misaligned terminals and damaged solder joints disappear.

Accu-Lok™ Test Points are available in loose and reeled format, in high and low profiles. PCB assembly can be done manually with Zierick hand tools and fixtures and automatically with Zierick semi and fully automated applicator systems.

- Accu-Lok™ Test Points mount accurately and securely to provide maximum PCB retention.
- Accu-Lok™ mounting permits the use of mounting holes with a diameter tolerance as great as $\pm 0.004"$ (0.10mm)
- Terminal Application Systems assure exceptional PCB assembly performance and repeatability in either semi-automatic or fully automated operations.
- Accu-Lok™ and standard press-fit test points offer exceptional flexibility for the test engineer.
- Accu-Lok™ mounting assures terminal reliability and mounting repeatability, improves PCB quality as the instances of fractured, missing or misaligned terminals and damaged solder joints disappear.
- Accu-Lok™ and press-fit test points are available in loose and reeled format, in high and low configurations.

Accu-Lok™ is a trademark of Zierick Manufacturing Corporation and a patented product of Zierick Manufacturing Corporation. U.S. Patent No. 5,017,159. Additional U.S. and international patents have been applied for.

PCB Mountable Test Point Terminals

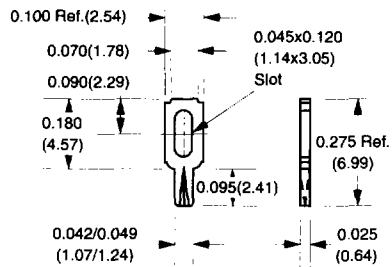

A

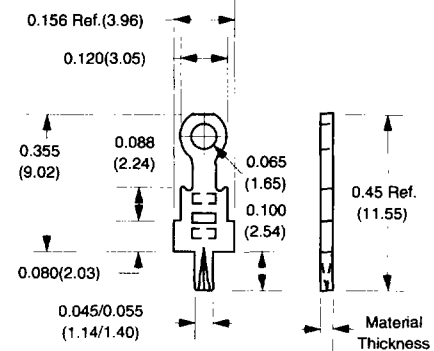

B

Detail	Loose Part Number	Reeled Part Number	Mounting Type	Material Thickness	Mounting Hole Diameter	Applicator System
A	1069/1069-□□	6069-□□	Accu-Lok™ Splay	0.025" (0.64mm)	±0.049" (1.24mm)	Loose: ZPT81-TP Reeled: Model 9500,9500CNC
B	1058/1058-□□	6058-□□	Accu-Lok™ Splay	0.020" (0.51mm)	±0.046" (1.17mm)	Loose: ZPT81-TP Reeled: Model 9500,9500CNC
B	1059/1059-□□	6059-□□	Accu-Lok™ Splay	0.032" (0.81mm)	±0.052" (1.32mm)	Loose: ZPT81-TP Reeled: Model 9500,9500CNC

†Non-Plated Through Hole w/±0.004" Tolerance. Please Consult Factory For Information Regarding Plated Through Holes.

PCB Mountable Test Point Terminals

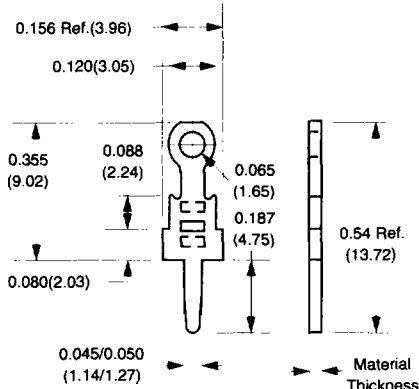

C

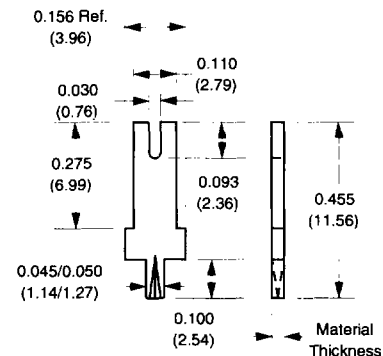

D

Detail	Loose Part Number	Reeled Part Number	Mounting Type	Material Thickness	Mounting Hole Diameter	Applicator System
C	1032/1032-□□	6032-□□	Press-Fit	0.020" (0.51mm)	0.046" (1.17mm)	Loose: ZPT81-TP Reeled: Model 9500,9500CNC
C	1033/1033-□□	6033-□□	Press-Fit	0.032" (0.81mm)	0.052" (1.32mm)	Loose: ZPT81-TP Reeled: Model 9500,9500CNC
D	1050-030-□□	6050-030-□□	Accu-Lok™ Splay	0.020" (0.51mm)	±0.046" (1.17mm)	Loose: ZPT81-TP Reeled: Model 7000,9500,9500CNC
D	1049-030-□□	6049-030-□□	Accu-Lok™ Splay	0.032" (0.81mm)	±0.052" (1.32mm)	Loose: ZPT81-TP Reeled: Model 7000,9500,9500CNC

†Non-Plated Through Hole w/±0.004" Tolerance. Please Consult Factory For Information Regarding Plated Through Holes.

Stable-Lok™, Accu-Lok™ and Standard PCB Mountable Quick Disconnect Terminals

