

LOADED CONNECTOR ASSEMBLY (FOR EXAMPLE)

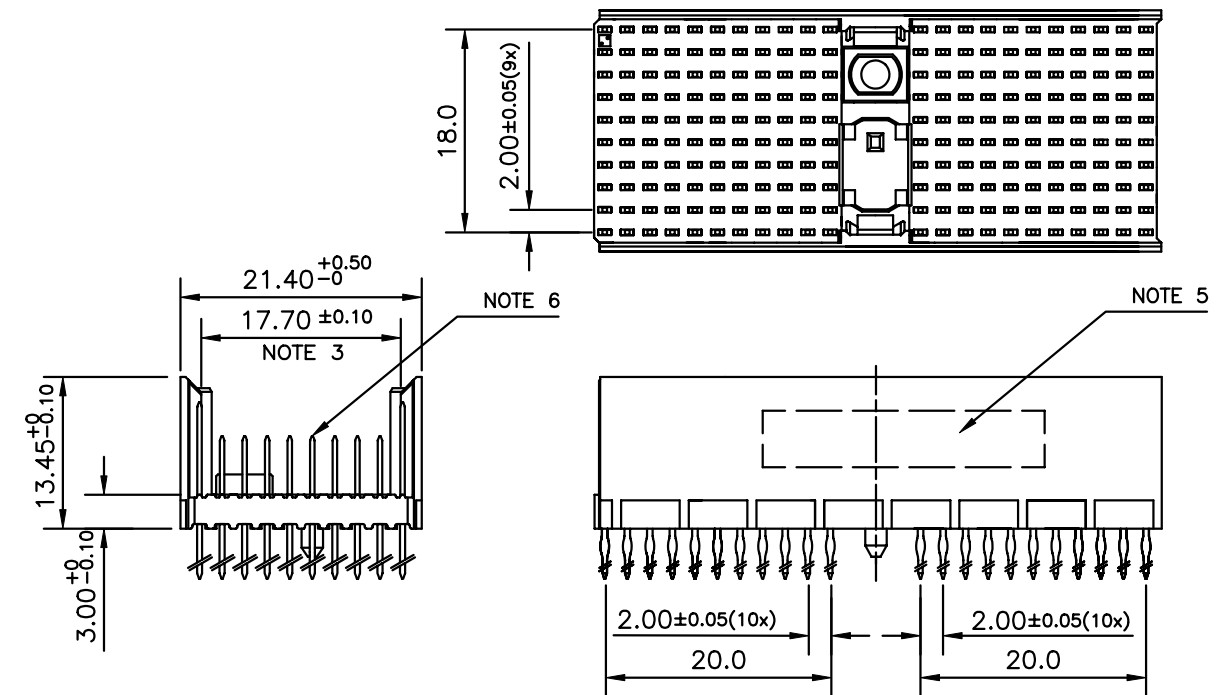

CONTACT OVERVIEW

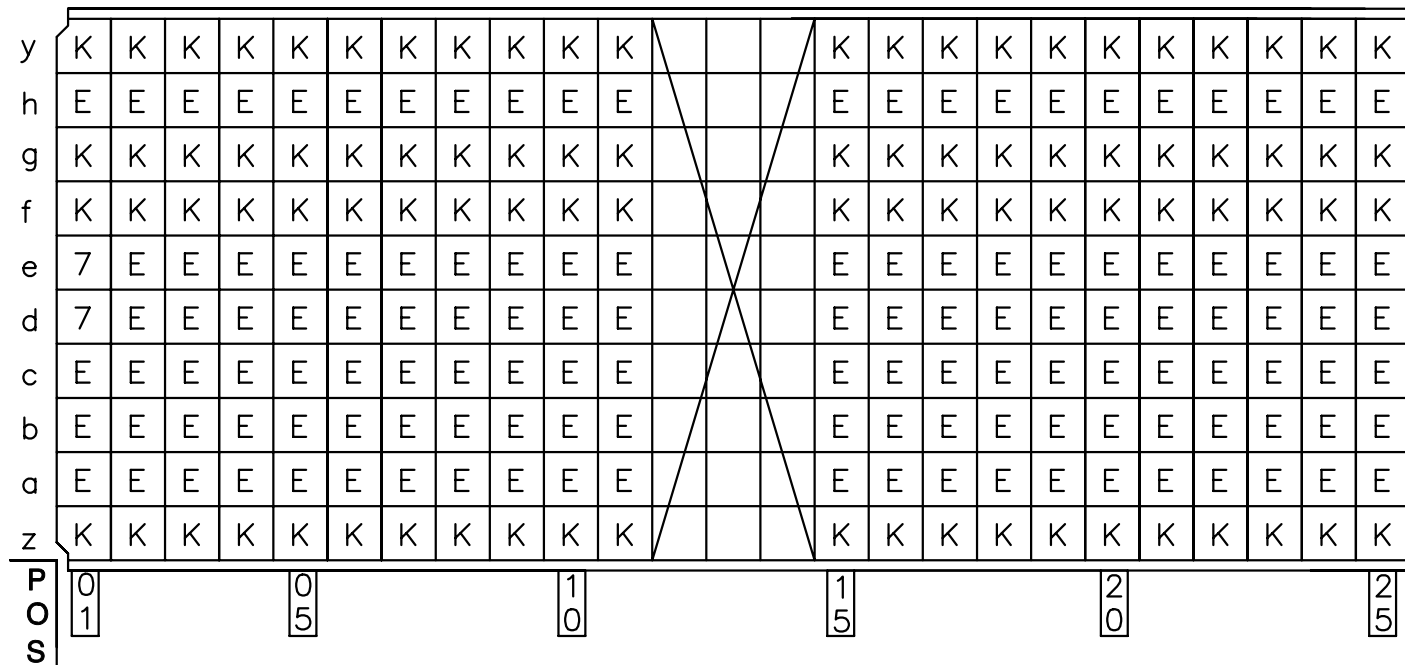
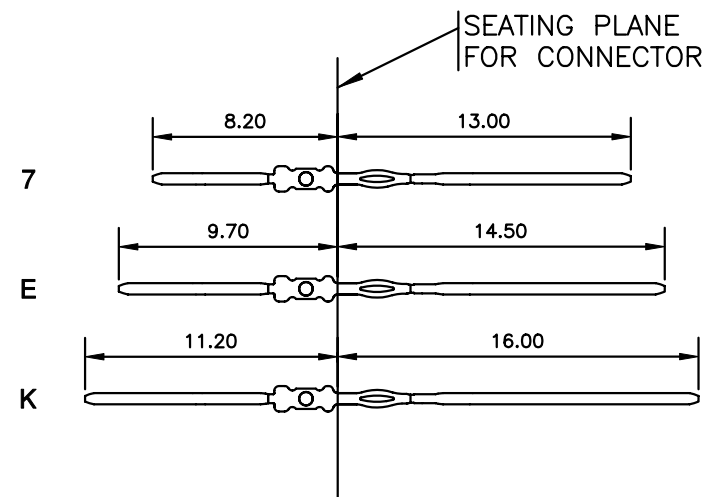

LAY-OUT P.C.B.-HOLE

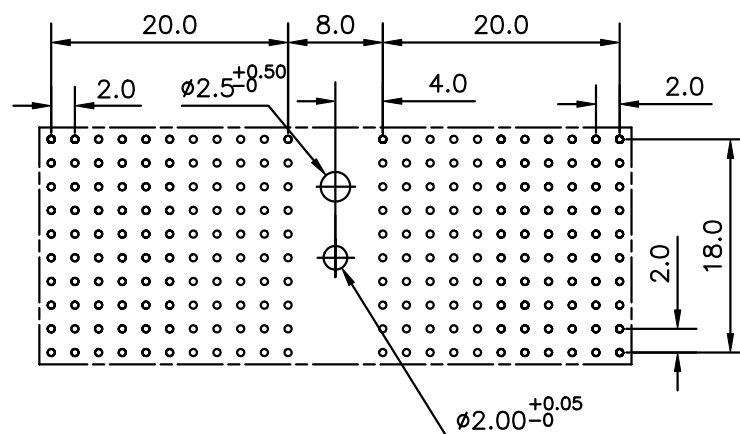

PLATING TABLE	HM2P87PNA1N4--	PLATING CODE (DIGIT 13 AND 14/15)
----------------------	-----------------------	--

CODE	CONTACT AREA	TYPE OF TERMINAL	TERMINAL PLATING	PERFORMANCE LEVEL
E9	1.00μ Au min over 1.3μ Ni min.	SHORT TERMINAL EON PRESSFIT CONTACTS	TIN LEAD	IEC PERFORMANCE LEVEL 1 (500 mating cycles)
N9	0.76μ Au min over 1.3μ Ni min.	SHORT TERMINAL EON PRESSFIT CONTACTS	TIN LEAD	IEC PERFORMANCE LEVEL 2 (250 mating cycles)
Z1	0.40μ Au min over 1.3μ Ni min.	SHORT TERMINAL EON PRESSFIT CONTACTS	TIN LEAD	IEC PERFORMANCE LEVEL 3 (50 mating cycles)
NN	0.15μ Au Avg over 1.02μ NiP Avg.	SHORT TERMINAL EON PRESSFIT CONTACTS	TIN LEAD	TELECORDIA CO (NXT)
NEN	0.38μ Au Avg over 1.02μ NiP Avg.	SHORT TERMINAL EON PRESSFIT CONTACTS	TIN LEAD	TELECORDIA UE (NXT)
GL	1.00μ Au min over 1.3μ Ni min.	REAR PLUG-UP EON PRESSFIT CONTACTS	TIN LEAD	IEC PERFORMANCE LEVEL 1 (500 mating cycles)
GF	0.76μ Au min over 1.3μ Ni min.	REAR PLUG-UP EON PRESSFIT CONTACTS	TIN LEAD	IEC PERFORMANCE LEVEL 2 (250 mating cycles)
GC	0.40μ Au min over 1.3μ Ni min.	REAR PLUG-UP EON PRESSFIT CONTACTS	TIN LEAD	IEC PERFORMANCE LEVEL 3 (50 mating cycles)
GN	0.15μ Au Avg over 1.02μ NiP Avg.	REAR PLUG-UP EON PRESSFIT CONTACTS	TIN LEAD	TELECORDIA CO (NXT)
GEN	0.38μ Au Avg over 1.02μ NiP Avg.	REAR PLUG-UP EON PRESSFIT CONTACTS	TIN LEAD	TELECORDIA UE (NXT)

RECOMMENDED PLATED THROUGH HOLE DIMENSIONS

- * DIAM.DRILLED HOLE : 0.675/0.725
- * DIAM.FINISHED HOLE : 0.55/0.65
- * Cu THICKNESS : 25/50 μ m.
- * SnPb THICKNESS : 4/10 μ m.

NOTES

1. THIS PRODUCT IS CSA APPROVED.
2. THIS PRODUCT IS UL RECOGNIZED.
3. MEASURED AT THE BOTTOM.
4. MATERIAL CONTACT: PHOSPHORBRONZE
HOUSING: CREAM WHITE GLASS FILLED POLYESTER UL-94V0
5. CONNECTOR PRINTED WITH P/N AND DATE CODE.
6. FOR ACTUAL CONTACT LOADINGS, SEE LOADING PATTERN MATNG SIDE.
7. SHAPE OF CONNECTOR HOUSING CAN ALTER DEPENDING ON
PRODUCTION LOCATION
8. THE PRODUCT IS "RoHS 5" (RoHS COMPLIANT TO EXCEPT IT CONTAINS LEAD)

						Tolerance LINEAR ± 0.1 ANGULAR $\pm 1^\circ$		Projection 			
Dr	Mini K Vandanath	23/12/2005		Product Family MILLIPACS				Size A3	Scale _____		
Eng	Biju K Paul	23/12/2005		Spec ref							
Chr	Biju K Paul	23/12/2005		Material SEE NOTE-4				ECN			
Appr	K Somasundaram	23/12/2005									
		Title MPACS 8+ 2R STR HDR PF CONN TYPE D (SPECIAL DRAWING FOR CISCO)				Dwg no BS, C , 203030, 069				Rev. A	
C:\Engineering\Millipacs		Catalog no HM2P87PNA1N4--				CUSTOMER COPY				Sheet 1 of 1	