

## Carrier Type Low Profile

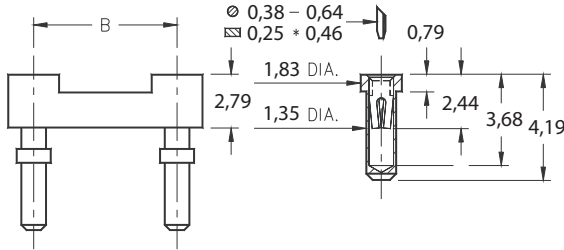

- Convenient way to load loose receptacles on PC board. See page 32 for application details.
- Removable plastic carriers can be returned for reloading.
- Hi-Rel, 4-finger BeCu #30 clip rated at 3 amps. See page 208 for details.
- Uses M-M#1401 pin. See page 139 for details.

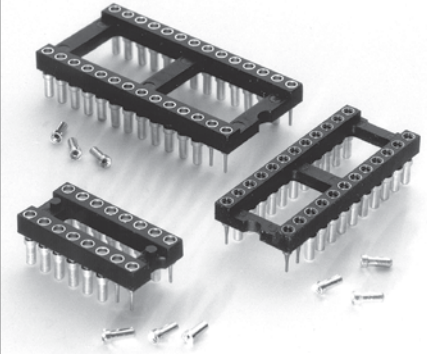

Total number of pins	Pin Pitch			Quantity per tube	Ordering Information
	A	B	C		
	2,54 (TYP)				

10	12,6	5,08	7,6	40
4	5,0	7,62	10,1	102
6	7,6	7,62	10,1	67
8	10,1	7,62	10,1	50
10	12,6	7,62	10,1	40
14	17,7	7,62	10,1	28
16	20,3	7,62	10,1	25
18	22,8	7,62	10,1	22
20	25,3	7,62	10,1	20
22	27,8	7,62	10,1	18
24	30,4	7,62	10,1	16
28	35,5	7,62	10,1	14
20	25,4	10,16	12,7	20
22	27,8	10,16	12,7	18
24	30,4	10,16	12,7	16
28	35,5	10,16	12,7	14
32	40,6	10,16	12,7	12
24	30,5	15,24	17,7	16
28	35,5	15,24	17,7	14
32	40,6	15,24	17,7	12
36	45,7	15,24	17,7	11
40	50,8	15,24	17,7	10
42	53,3	15,24	17,7	9
48	60,9	15,24	17,7	8
50	63,5	15,24	17,7	8
52	66,0	15,24	17,7	7
50	63,5	22,86	25,3	8
52	66,0	22,86	25,3	7
64	81,2	22,86	25,3	6

**XX=Plating Code  
See Below**

**For RoHS compliance, select  $\diamond$  plating code. For the all gold option (XX=13) also change part number from 614-XX-XXX-41-001000 to 614-13-XXX-41-001100**

**RoHS  
2002/95/EC**

- 614-XX-210-41-001000
- 614-XX-304-41-001000
- 614-XX-306-41-001000
- 614-XX-308-41-001000
- 614-XX-310-41-001000
- 614-XX-314-41-001000
- 614-XX-316-41-001000
- 614-XX-318-41-001000
- 614-XX-320-41-001000
- 614-XX-322-41-001000
- 614-XX-324-41-001000
- 614-XX-328-41-001000
- 614-XX-420-41-001000
- 614-XX-422-41-001000
- 614-XX-424-41-001000
- 614-XX-428-41-001000
- 614-XX-432-41-001000
- 614-XX-624-41-001000
- 614-XX-628-41-001000
- 614-XX-632-41-001000
- 614-XX-636-41-001000
- 614-XX-640-41-001000
- 614-XX-642-41-001000
- 614-XX-648-41-001000
- 614-XX-650-41-001000
- 614-XX-652-41-001000
- 614-XX-950-41-001000
- 614-XX-952-41-001000
- 614-XX-964-41-001000

SPECIFY PLATING CODE XX=	13 $\diamond$	93	99	43 $\diamond$	44 $\diamond$
Sleeve (Pin)	0,25 $\mu$ m Au	5,08 $\mu$ m Sn/Pb	5,08 $\mu$ m Sn/Pb	5,08 $\mu$ m Sn	5,08 $\mu$ m Sn
Contact (Clip)	0,76 $\mu$ m Au	0,76 $\mu$ m Au	5,08 $\mu$ m Sn/Pb	0,76 $\mu$ m Au	5,08 $\mu$ m Sn