

1SS353

■ Features

- Small surface mount type
- High switching speed. ($t_{rr}=2\text{ns Typ.}$)
- Good mountability, high surge resistance and reliability.

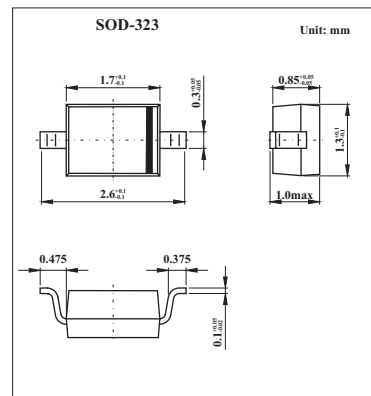

■ Absolute Maximum Ratings $T_a = 25^\circ\text{C}$

Parameter	Symbol	Rating	Unit
Peak reverse voltage	V_{RM}	90	V
DC reverse voltage	V_R	80	V
Average forward current	I_O	100	mA
Peak forward current	I_{FM}	255	mA
Surge current (1s)	I_{surge}	400	mA
Junction temperature	T_j	125	$^\circ\text{C}$
Storage temperature	T_{stg}	-55 to 125	$^\circ\text{C}$

■ Electrical Characteristics $T_a = 25^\circ\text{C}$

Parameter	Symbol	Test conditions	Min	Typ.	Max	Unit
Forward voltage	V_F	$I_F=100\text{mA}$		0.94	1.2	V
Reverse current	I_R	$V_R=80\text{V}$		0.03	0.5	μA
Total Capacitance	C_T	$V_R=0.5\text{V}, f=1\text{MHz}$		0.72	3.0	pF
Reverse recovery time	t_{rr}	$V_R=6\text{V}, I_F=10\text{mA}, R_L=100\ \Omega$		1.1	4	ns

■ Marking

Marking	C
---------	---