

3.96mm CENTERS CR8 SERIES CRIMPING CONNECTORS

General

CR8 series are 3.96mm centers dual line connectors featuring bellows type crimping contacts which can accommodate stranded AWG24 to AWG18 wires. 36, 44, 56, and 72 pin are line-uped with a polarizing key for

protection of coupling errors. CR8 series connectors are typically used in the areas like computer and peripherals, copying machine, control equipments, POS, office computers and so on.

Material and Finish

Molding : UL94V-0 Glass-reinforced Polyester, Black

Contact : Phosphor Bronze, Selective gold plating over nickel

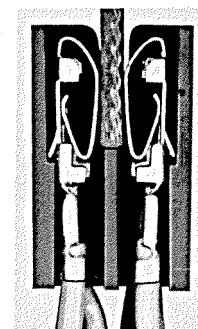
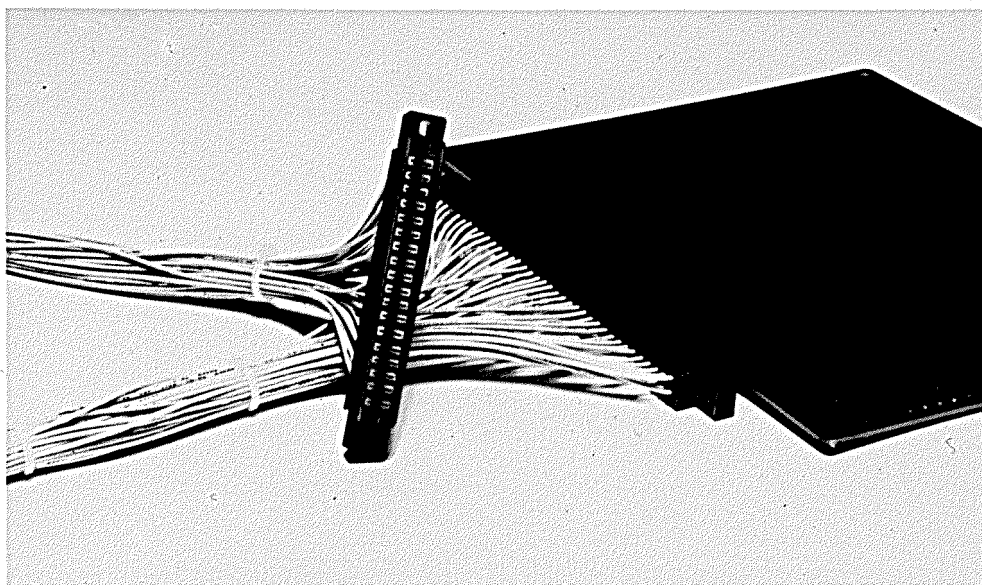

Electrical and Environmental Performance

Current Rating	: 5A
Voltage Rating	: AC600V, DC850V
Insulation Resistance	: 5000M Ω MIN at DC500V
Contact Resistance	: 10m Ω MAX at DC1A
Voltage Withstanding	: AC1800V MIN for a minute
Insertion and	
Extraction Force	: 57grs to 450grs/contact at 1.575 \pm 0.002mm steel gauge
Humidity	: MIL-STD-202, Insulation Resistance 1000M Ω MIN at 40 \pm 2 $^{\circ}$ C, 90–95%, and 96 hours
Vibration	: MIL-STD-202, No visual damage nor looseness of parts at 10–55Hz with 1.5mm amplitude
Shock	: MIL-STD-202, No visual damage nor looseness of parts at 50G in 3 directions
Temperature Cycling	: MIL-STD-202, No visual damage at –55 to +85 $^{\circ}$ C
Durability	: Contact Resistance 10m Ω MAX at DC1A after 500 times consecutive coupling operation
Salt Spray	: MIL-STD-202, No heavy corrosion at 5%, 35 $^{\circ}$ C, Salt Water spray for 48 hours

mm

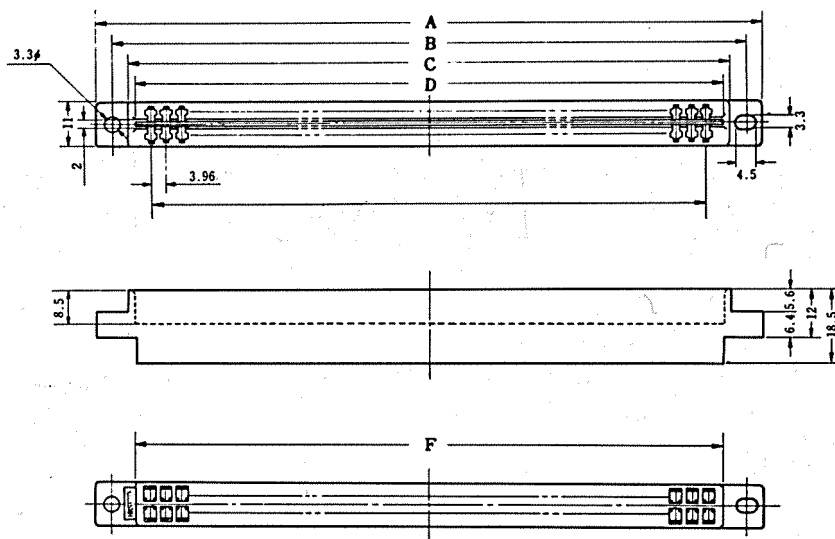
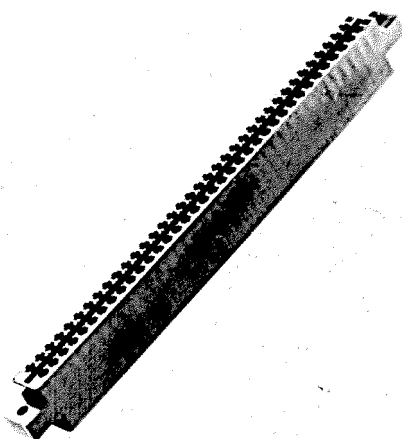

CR8-72D-3.96C

mm

No. of pin	Part No.	A	B	C	D	E	F
36	CR8-36D-3.96C	94.4	86.6	79.1	75.5	67.32	75.2
56	CR8-56D-3.96C	134	126.2	118.7	115.1	106.935	114.8
72	CR8-72D-3.96C	166	158	150	146.8	138.684	146

Polarizing Key

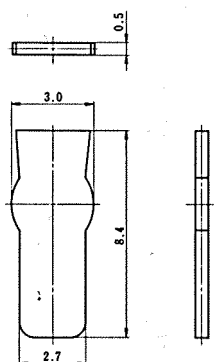

Part No.	Material
CR1E-GPIN	Polyacetal, White

Mounting Cutout

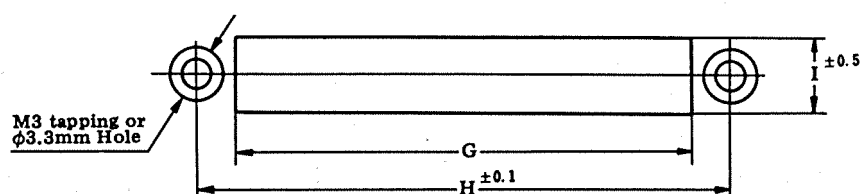

mm

No. of pin	G	H	I
36	80	86.5	10
56	119.1	126.0	12
72	151	158.0	

Crimping Contact

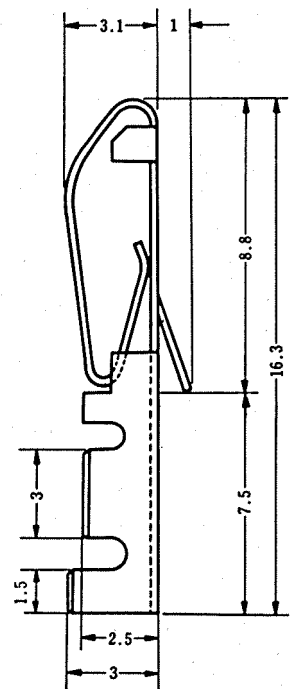
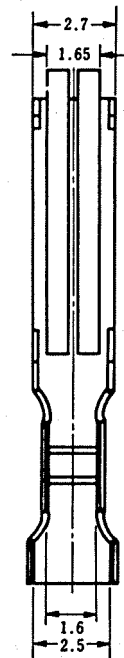
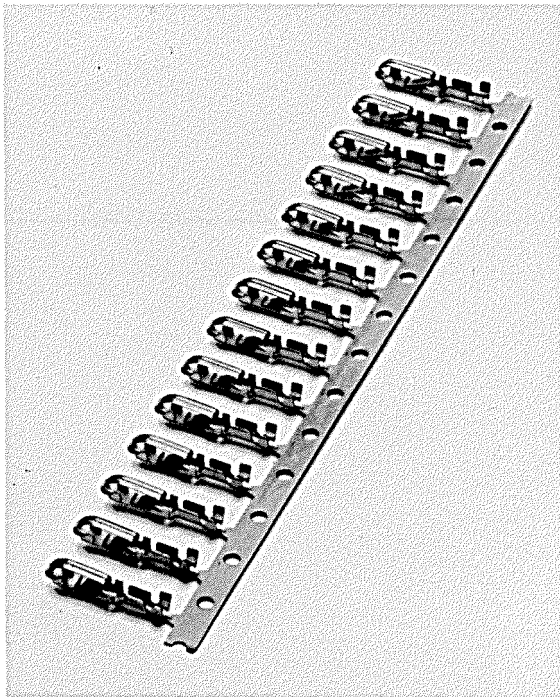

mm

Part No.	Plating	Type	Applicable cable	Packing
CR8-1824SC	Whole Gold	Loose Contacts	AWG24	100 pins per bag
CR8-1824SCF	Whole Gold	Chain Contacts	AWG18	5,000 pins per roll
CR8-1824SCFA	Selective Gold	Chain Contacts		

Tools

Crimping tool

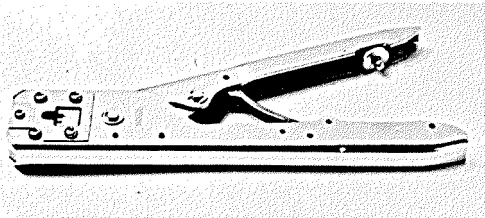

Applicable cable	Part No.
AWG22-26	CR8-T2226HC
AWG24-28	CR8-T2428HC

Autocrimping machine (model CM-105)

