

Plugs, Jacks and Receptacles

Straight Plug

Part Number	Cable Numbers	A
051-424-3188220	RG174/U, RG316/U	20,01 (.790)
A51-424-3196220	RG178/U, RG196/U	19,33 (.761)
A51-424-3875220	RD316	20,01 (.790)

Assembly Instructions

051-424-3188220	AI-663 (Page 114)
A51-424-3196220	AI-128 (Page 114)
A51-424-3875220	AI-663 (Page 114)

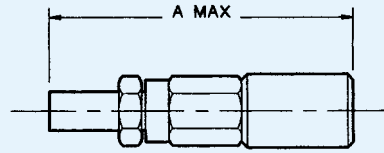

Right Angle Plug

Part Number	Cable Numbers	A
A51-428-3188220	RG174/U, RG316/U	9,55 (.376)
A51-428-3196220	RG178/U, RG196/U	9,55 (.376)
A51-428-3875220	RD316	10,16 (.400)

Assembly Instructions

A51-428-3188220	AI-129 (Page 115)
A51-428-3196220	AI-696 (Page 115)
A51-428-3875220	AI- 286 (Page 115)

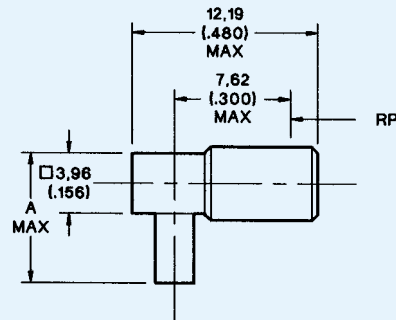

Bulkhead Jack

Part Number	Cable Numbers	A
A51-427-3188220	RG174/U, RG316/U	9,93 (.391)
A51-427-3196220	RG178/U, RG196/U	10,41 (.410)

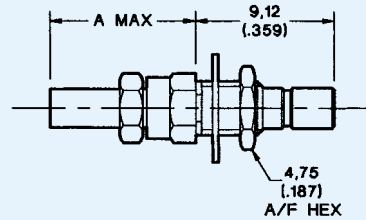

Mounting Plan U (Page 109). Assembly Instruction AI-128 (Page 114)

Bulkhead Receptacle - Rear Mount

Part Number
051-443-0000220

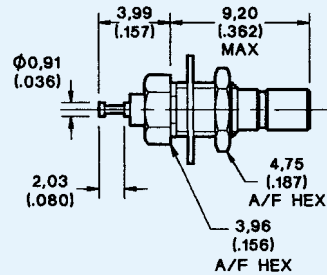

Mounting Plan U (Page 109)

SSMB/C