

SPECIFICATIONS

Electrical

Ratings: 300mA max. 10V DC max.
Contact Resistance: Initial 50mΩ max., Final 100mΩ max.
Insulation Resistance: 100MΩ min at 100V DC

Mechanical

Operating Force: 100gf ~300gf.
Stroke: 2.5±0.5mm
Durability: 10000 Cycles min.

Physical

Operating Temperatures: -5°C to +35°C at 45% to 85% RH max.
Package: 900PCS/Reel, 14 Reel/Box

Slide Switch

Slide Series
Vertical, T/H Type
SWITCH

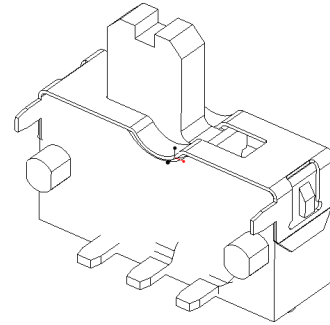

DRAWING

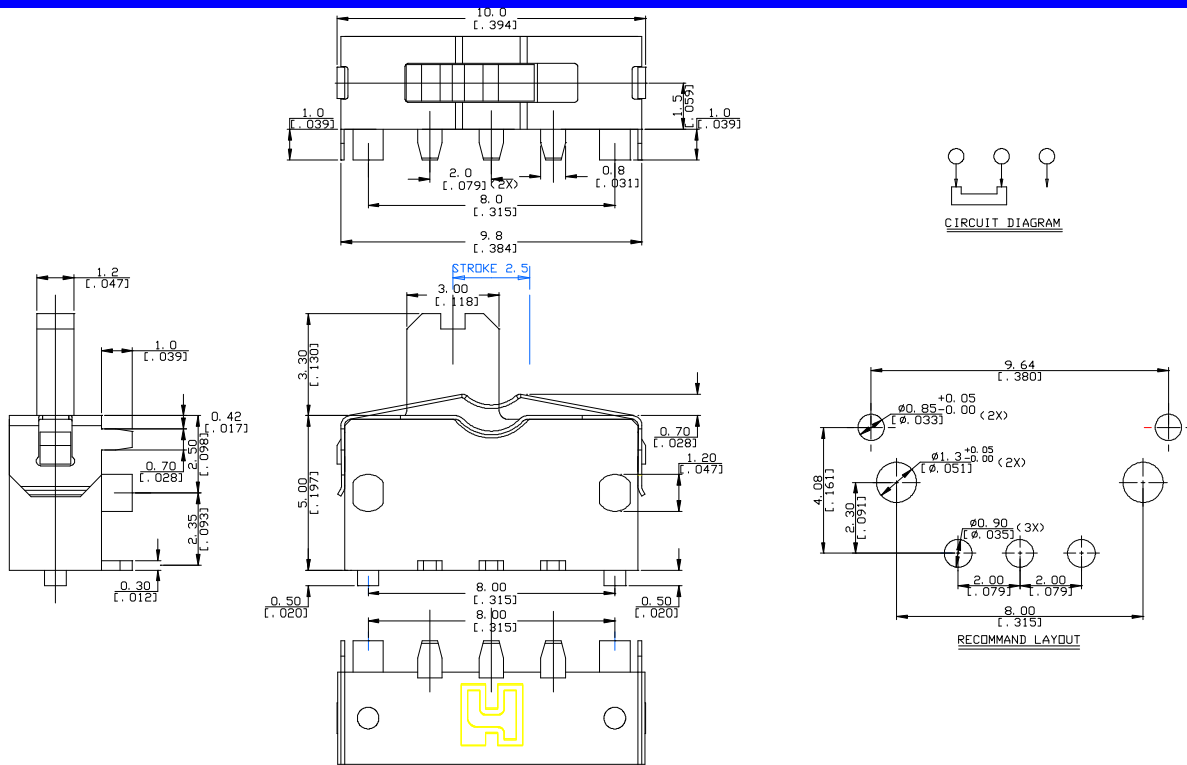

ORDERING INFORMATION

PRODUCT NO: 1B S 0 0 3 - 1 * * * * - * * *

<p>產品系列代碼: 1B : Switch series</p> <p>Switch category D = Detect Switch P = Push Switch S = Slide Switch T = Tact Switch M = Metal Dome</p> <p>Product series 001 002</p>	<p>Number of Circuits 1 = 1 2 = 2</p> <p>Number of Contacts 2 = 2 3 = 3</p> <p>Position 1 = Horizontal 2 = Vertical</p>	<p>Plating 0 = Standard L = lead free</p> <p>Travel 2 = 2.5 mm</p>	<p>Modification code None = w/o ground 001 = w/ground</p>
--	---	--	---