

# TNC SERIES



**SPECIALTY  
CONNECTOR CO., INC.**

The TNC series connectors are the same as the improved BNC series except they incorporate a threaded coupling sleeve in place of the bayonet sleeve of the BNC series. The treaded coupling sleeve improves the vibration characteristics and the resistance to RF leakage over the BNC series.

They are made to MIL-C-39012 and many styles and variations are available. The plugs incorporate safety wiring holes in the coupling sleeve so that they may be wired in place in severe vibration conditions. The series incorporates designs to fit all popular size coaxial cables. The various styles are designed to be weatherproof.

## MATERIALS:

Body parts: Brass per QQ-B-626, 1/2 HD.  
Contacts: Male: Brass  
Female: Beryllium Copper per QQ-C-530  
Insulator: TFE Fluorocarbon per L-P-403  
Gaskets: Silicone rubber per ZZ-R-765

## FINISH:

All parts plated to meet finish and corrosion requirements of MIL-C-39012.  
Gold plating per MIL-G-45204.  
Proprietary bright nickel (IP23).  
Silver plating per QQ-S-365.

## MECHANICAL:

Force to Engage and Disengage: Torque 2 in. lb. max.  
Coupling nut Retention Force: 100 lb. min.  
Coupling Proof Torque: 30 in. lb. min.  
Connector Durability: 500 cycles min.

## ELECTRICAL:

Impedance: 50 ohms nominal  
Frequency Range: DC to 18 GHz  
Insulation Resistance: 5,000 Megohms min.  
Voltage Rating: 500 VRMS  
Dielectric Withstanding Voltage:  
1,500 VRMS at sea level  
R.F. leakage: - (90 - FGHZ) dB max.  
R.F. High Potential Withstanding Voltage:  
1,000 VRMS at 5 MHz  
Voltage standing wave ratio (VSWR):  
1.07 + .007 F(GHZ) max.  
Insertion loss:  $0.5 \sqrt{FGHZ}$  dB max.  
Contact Resistance:  
Outer contact: .2 Milliohms max.  
Center contact: 1.5 Milliohms max.

## ENVIRONMENTAL:

Temperature rating: -65°C to +165°C  
Vibration: MIL-STD-202, method 204, cond. D 20G's)  
Shock: MIL-STD-202, method 213, cond. I (100G's)  
Thermal shock: MIL-STD-202, method 107, cond. B  
(-65°C to +115°C)  
Corrosion (salt spray): MIL-STD-202, method 101,  
cond. B  
Moisture Resistance: MIL-STD-202, method 106

## INTERFACE DIMENSIONS PER MIL-C-39012

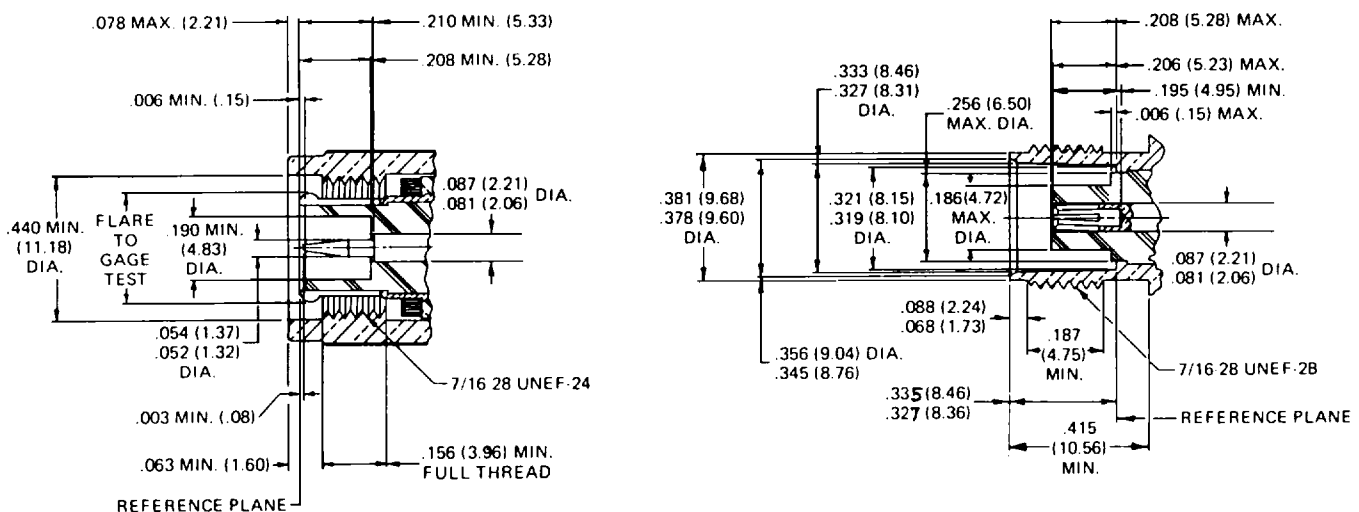

# TNC SERIES



**SPECIALTY  
CONNECTOR CO., INC.**

## TNC PLUG — STRAIGHT

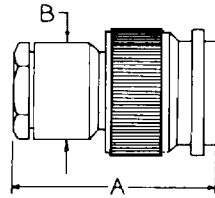

S/C Part No.	Cable RG-/U	Dimension		Engr. Data	Assy. Inst.
		A	B		
24P100-1	58	1-3/64	1/2	Straight Cut Style Hardware	AI-12
24P100-2	59	1-3/64	1/2	Straight Cut Style Hardware	AI-12
24P100-3	174	1-3/64	1/2	Straight Cut Style Hardware	AI-12
24P100-4	223	1-3/64	1/2	Straight Cut Style Hardware	AI-12
24P100-5	180,195	1-1/16	1/2	Straight Cut Style	AI-12
24P100-7	303	1-1/16	1/2	Straight Cut Style	AI-12
24P101-1	55,58,141 142,223	1-3/64	1/2	Improved Hdwe. W/O Washer	AI-14
24P101-2	174,179A 187,188	1-3/64	1/2	Improved Hdwe. W/O Washer	AI-14
24P101-3	180,185	1-3/64	1/2	Improved Hdwe. W/O Washer	AI-14
24P101-4	179	1-3/64	1/2	Improved Hdwe. W/O Washer	AI-14
24P104-1	.141 OD	1-3/64	1/2	Plug-in Semi-Rigid Cable	AI-21
24P104-2	.085 OD	1-3/64	1/2	Plug-in Semi-Rigid Cable	AI-21
24P104-3	.250 OD	1-3/64	1/2	Plug-in Semi-Rigid Cable	AI-21
24P104-4	.215 OD	1-3/64	1/2	Plug-in Semi-Rigid Cable	AI-21
24P105-1	55,58,141 142,223	1-3/64	1/2	Captive Contact Improved Hdwe.	AI-20
24P107-1	59,62,71	1-3/64	1/2	Captive Contact Improved Hdwe.	AI-20
24P113-1	55,58,141 142,223	1-3/64	1/2	Improved Hdwe.	AI-14
24P114-1	59,62,71 210	1-3/64	1/2	Improved Hdwe.	AI-14
24P116-1	8,9,213 214	1-5/8	3/4	Improved Hdwe.	AI-87
24P140-1	8,213	1-9/16	3/4	Straight Cut Style	AI-81
24P140-2	9,214	1-9/16	3/4	Straight Cut Style	AI-81
24P146-1	.141 S.R.	49/64		Solder on Style	
24P153-1	8,9,213 214	1-5/8	3/4	Captive Contact	AI-50
24P158-1	179,316	1-1/16	1/2	Straight Cut Style	

## TNC PLUG — STRAIGHT — LONG CRIMP

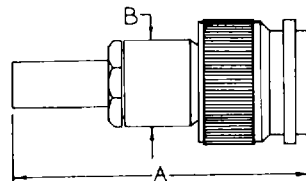

S/C Part No.	Cable RG-/U	Dimension		Crimp Tool	Engr. Data	Assy. Inst.
		A	B			
24P102-1	58,141	1-1/2	1/2	.213 HEX	Captive Contact	AI-37
24P102-2	59,62,140	1-1/2	1/2	.255 HEX	Captive Contact	AI-37
24P102-3	55,142	1-1/2	1/2	.213 HEX	Captive Contact	AI-37
24P102-4	71	1-1/2	1/2	.268 HEX	Captive Contact	AI-37
24P102-5	122	1-1/2	1/2	.178 HEX	Captive Contact	AI-37

## TNC PLUG — STRAIGHT — SHORT CRIMP

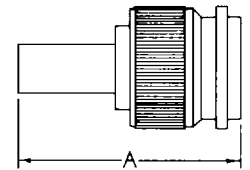

S/C Part No.	Cable RG-/U	Dimension			Crimp Tool	Engr. Data	Assy. Inst.
		A	B	C			
24P103-1	58,141	1-11/64			213 HEX		AI-26
24P103-2	59,62,140	1-11/64			.255 HEX		AI-26
24P103-3	55,142	1-11/64			213 HEX		AI-26
24P142-1	174,316	1-11/64			.178 HEX		
24P167-1	58,303	1-1/8			213 HEX	Crimp Captive Contact	
24P167-2	59	1-1/8			.255 HEX	Crimp Captive Contact	
24P172-1	8,213	1-11/16			429 HEX	Crimp Captive Contact	
24P172-2	9,214	1-11/16			429 HEX	Crimp Captive Contact	

## TNC JACK — RIGHT ANGLE

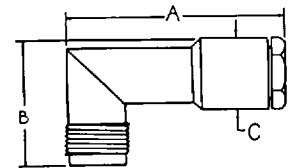
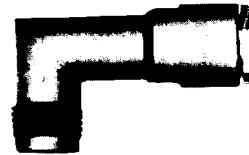

S/C Part No.	Cable RG-/U	Dimension			Engr. Data	Assy. Inst.
		A	B	C		
24J114-1	58	1-15/32	55.64	1/2	Straight Cut Style	AI-12
24J114-3	59,62	1-15/32	55.64	1/2	Straight Cut Style	AI-12

## TNC PLUG — RIGHT ANGLE

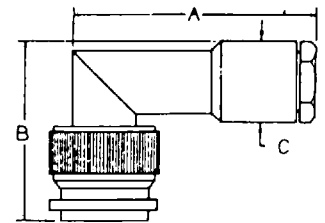
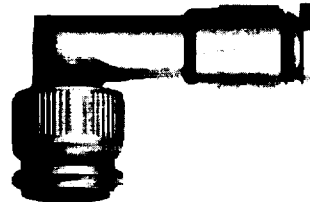

S/C Part No.	Cable RG-/U	Dimension			Crimp Tool	Engr. Data	Assy. Inst.
		A	B	C			
24P112-1	55,58,141 142,223	1-9/16	1-3/32	1/2	Captive Contact Improved Hdwe.	AI-20	
24P118-1	55,58,141 142,223	1-9/16	1-3/32	1/2	Improved Hdwe.	AI-14	
24P134-1	58	1-9/16	1-3/32	1/2	Straight Cut Style	AI-12	
24P134-2	59	1-9/16	1-3/32	1/2	Straight Cut Style	AI-12	
24P134-3	174,316	1-9/16	1-3/32	1/2	Straight Cut Style	AI-12	
24P134-4	223	1-9/16	1-3/32	1/2	Straight Cut Style	AI-12	
24P155-1	9,214	1-37/64	1-7/32	3/4	Straight Cut Style	AI-81	
24P155-2	8,213	1-37/64	1-7/32	3/4	Straight Cut Style	AI-81	
24P159-1	8,9,213 214	1-53/64	1-7/32	3/4	Captive Contact Improved Hdwe.	AI-33	
24P165-1	.141 S.R.	1-21/32	1-7/32	3/4	Solder on Bushing		
24P165-2	.085 S.R.	1-21/32	1-7/32	3/4	Solder on Bushing		

# TNC SERIES



**SPECIALTY  
CONNECTOR CO., INC.**

## TNC PLUG — RIGHT ANGLE — SHORT CRIMP

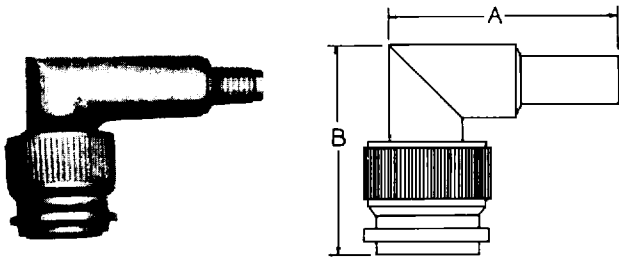

S/C Part No.	Cable RG-U	Dimension		Crimp Tool	Engr. Data	Assy. Inst.
		A	B			
24P120-1	58,141	1-17/32	1-1/32	.213 HEX	Improved	AI-26
24P120-2	59,62,140	1-17/32	1-1/32	.255 HEX	Improved	AI-26
24P120-3	55,142,223	1-17/32	1-1/32	.213 HEX	Improved	AI-26
24P120-4	71	1-17/32	1-1/32	.268 HEX	Improved	AI-26
24P171-2	58	1-5/8	1-1/32	.213 HEX	Crimp Captive Contact	
24P171-3	223	1-5/8	1-1/32	.213 HEX	Crimp Captive Contact	
24P171-4	180,195	1-5/8	1-1/32	.178 HEX	Crimp Captive Contact	
24P173-1	8,213	1-23/32	1-1/8	.429 HEX	Crimp Captive Contact	
24P173-2	9,214	1-23/32	1-1/8	.429 HEX	Crimp Captive Contact	

## TNC PLUG — RIGHT ANGLE — LONG CRIMP

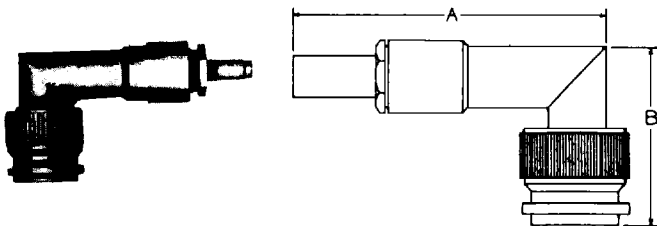

S/C Part No.	Cable RG-U	Dimension		Crimp Tool	Engr. Data	Assy. Inst.
		A	B			
24P119-1	58,141	1-27/32	1-3/32	.213 HEX	Captive Contact-Improved	AI-37
24P119-2	59,62,140	1-27/32	1-3/32	.255 HEX	Captive Contact-Improved	AI-37
24P119-3	55,142,223	1-27/32	1-3/32	.213 HEX	Captive Contact Improved	AI-37
24P119-4	71	1-27/32	1-3/32	.268 HEX	Captive Contact-Improved	AI-37

## TNC PLUG — RIGHT ANGLE

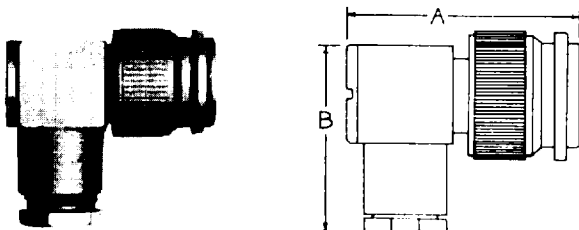

S/C Part No.	Cable RG-U	Dimension		Engr. Data
		A	B	
24P108-1	55,58	1-3/16	1	Improved Hardware

## TNC PLUG TERMINATION

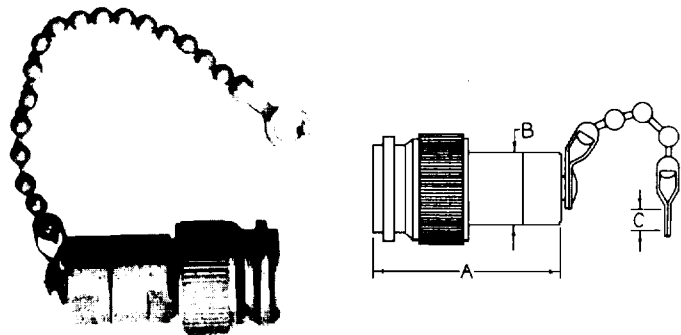

S/C Part No.	Resistor 5%		Dimension			Engr. Data
	Ohm	Watt	A	B	C	
24PO100-1	100	1/2	1-3/16	1/2	.144	With 3-1/2" Bead Chain
24PO100-2	51	1/2	1-3/16	1/2	.144	With 3-1/2" Bead Chain
24PO100-3	75	1/2	1-3/16	1/2	.144	With 3-1/2" Bead Chain
24PO100-4	91	1/2	1-3/16	1/2	.144	With 3-1/2" Bead Chain
24PO100-5	510	1/2	1-3/16	1/2	.144	With 3-1/2" Bead Chain
24PO100-6	1000	1/2	1-3/16	1/2	.144	With 3-1/2" Bead Chain
24PO103-2	75	1/2	1-3/16	1/2		No Chain

## TNC PLUG RECEPTACLE — FLANGE MOUNT

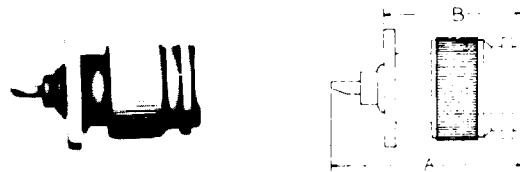

S/C Part No.	Dimension		Mtg. Plate	Engr. Data
	A	B		
24PR104-1	1-3/16	55/64	2C	Improved .062 ID Solder Pot
24PR105-1	1-3/16	27/32	1A	Improved .062 ID Solder Pot
24PR106-1	1-3/16	27/32	2B	Improved .062 ID Solder Pot

## TNC PLUG CAP

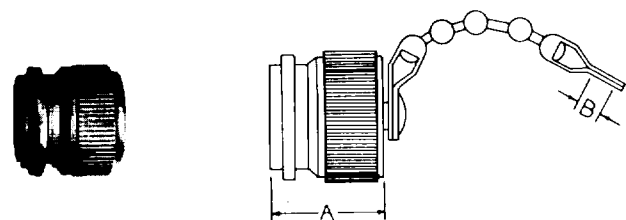

S/C Part No.	Dimension		Engr. Data
	A	B	
24PC100-1	19/32		No Chain
24PC101-1	19/32	.144	2-1/2" Bead Chain
24PC106-1	37/64		Shorting Cap - No Chain
24PC107-1	37/64	.144	Shorting Cap with 2-1/2" Chain

# TNC SERIES



**SPECIALTY  
CONNECTOR CO., INC.**

## TNC JACK — SINGLE HOLE REVERSE MOUNT

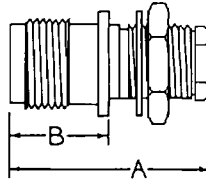

S/C Part No.	Cable RG-U	Dimension		Mtg. Hole	Engr. Data	Assy. Inst.
		A	B			
24JS141-1	.085 DIA	29.32	9.16	D8	Solder Bushing - Plug in Contact	AI-65
24JS141-2	.141 DIA	29.32	9.16	D8	Solder Bushing - Plug in Contact	AI-65

## TNC JACK — SHORT CRIMP

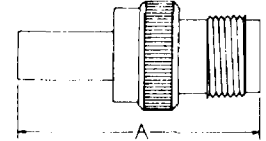

S/C Part No.	Cable RG-U	Dimension		Crimp Tool	Engr. Data	Assy. Inst.
		A				
24J107-1	58,141	1-15/64		.213 HEX	Improved	AI-26
24J107-2	59,62,140	1-15/64		.255 HEX	Improved	AI-26
24J107-3	55,142,223	1-15/64		.213 HEX	Improved	AI-26
24J118-2	58	1-3/16		.213 HEX	Crimp Captive Contact	
24J118-3	223	1-3/16		.213 HEX	Crimp Captive Contact	
24J118-4	180	1-3/16		.178 HEX	Crimp Captive Contact	
24J118-5	122	1-3/16		.178 HEX	Crimp Captive Contact	

## TNC JACK

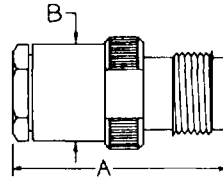

S/C Part No.	Cable RG-U	Dimension		Engr. Data	Assy. Inst.
		A	B		
24J102-1	58	1-1/8	1/2	Straight Cut Hdwe.	AI-12
24J102-2	59	1-1/8	1/2	Straight Cut Hdwe.	AI-12
24J102-5	223	1-1/8	1/2	Straight Cut Hdwe.	AI-12
24J102-7	180,195	1-1/8	1/2	Straight Cut Hdwe.	AI-12
24J102-9	303	1-1/8	1/2	Straight Cut Hdwe.	AI-12
24J104-1	55,58,223	1-1/8	1/2	Improved	AI-14
24J105-1	59,62,71	1-1/8	1/2	Improved	AI-14
24J112-1	5,212	1-7/16	3/4	Straight Cut Hdwe.	AI-81
24J112-4	9,214	1-7/16	3/4	Straight Cut Hdwe.	AI-81
24J120-1	58,223	1-1/8	1/2	Improved Captive Contact	AI-20

## TNC JACK — SINGLE HOLE MOUNT

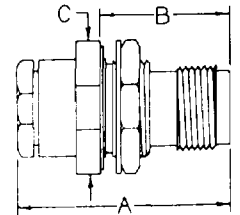

S/C Part No.	Cable RG-U	Dimension			Mtg. Hole	Engr. Data	Assy. Inst.
		A	B	C			
24JS100-1	55,58	1-1/8	43/64	11/16	D4	Std. Hdwe.	AI-14
24JS101-1	58	1-7/16	3/4	5/8	D4	Str. Cut, Isolated Grnd.	AI-12
24JS101-2	59,62	1-7/16	3/4	5/8	D4	Str. Cut, Isolated Grnd.	AI-12
24JS106-1	187,188	1-1/8	53/64	11/16	D4	Std. Hdwe.	AI-14
24JS106-2	178,196	1-1/8	53/64	11/16	D4	Std. Hdwe.	AI-14
24JS109-1	59,62,71	1-1/8	43/64	11/16	D4	Std. Hdwe.	AI-14
24JS113-1	58	1-15/32	3/4	5/8 dia	D4	Iso. Grnd., Std. Hdwe.	AI-14
24JS113-2	59	1-15/32	3/4	5/8 dia	D4	Iso. Grnd., Std. Hdwe.	AI-14
24JS113-3	187,316	1-15/32	3/4	5/8 dia	D4	Iso. Grnd., Std. Hdwe.	AI-14
24JS113-4	180,195	1-15/32	3/4	5/8 dia	D4	Iso. Grnd., Std. Hdwe.	AI-14
24JS115-1	174,316	1-1/8	13/16	11/16	D4	Captive Contact	
24JS117-1	.141 dia SR	1-1/8	13/16	11/16	D4	Plug-in Style	AI-21
24JS117-2	.085 dia SR	1-1/8	13/16	11/16	D4	Plug-in Style	AI-21
24JS117-3	.250 dia SR	1-1/8	13/16	11/16	D4	Plug-in Style	AI-21
24JS121-1	58	1-1/8	43/64	11/16	D4	Straight Cut Style	AI-12
24JS121-2	59	1-1/8	43/64	11/16	D4	Straight Cut Style	AI-12
24JS121-3	174,316	1-1/8	43/64	11/16	D4	Straight Cut Style	AI-12
24JS121-4	223	1-1/8	43/64	11/16	D4	Straight Cut Style	AI-12
24JS121-8	180,195	1-1/8	43/64	11/16	D4	Straight Cut Style	AI-12
24JS121-10	303	1-1/8	43/64	11/16	D4	Straight Cut Style	AI-12
24JS128-1	58,223	1-1/8	43/64	11/16	D4	Captive Contact	AI-20
24JS132-1	9,214	1-1/2	13/16	3/4	D4	Straight Cut Style	AI-81
24JS132-2	8,213	1-1/2	13/16	3/4	D4	Straight Cut Style	AI-81
24JS137-1	.141 S.R.	1-1/8	43/64	11/16	D4	Solder on Bushing	
24JS137-2	.085 S.R.	1-1/8	43/64	11/16	D4	Solder on Bushing	

## TNC JACK — LONG CRIMP

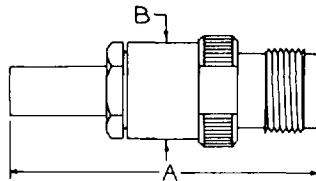

S/C Part No.	Cable RG-U	Dimension		Crimp Tool	Engr. Data	Assy. Inst.
		A	B			
24J106-1	58,141	1-15/32	7/16	.213 HEX	Improved	AI-37
24J106-2	59,62,140	1-15/32	7/16	.255 HEX	Improved	AI-37
24J106-3	55,142,223	1-15/32	7/16	.213 HEX	Improved	AI-37
24J106-4	71	1-15/32	7/16	.268 HEX	Improved	AI-37

# TNC SERIES



**SPECIALTY  
CONNECTOR CO., INC.**

## TNC JACK — SINGLE HOLE MOUNT — LONG CRIMP

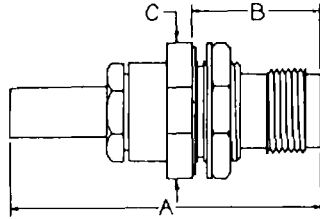

S/C Part No.	Cable RG-U	Dimension			Mtg. Hole	Crimp Tool	Engr. Data	Assy. Inst.
		A	B	C				
24JS102-1	58	1-25/32	3/4	5/8 dia	D4	.213 HEX	Isolated Grnd.	AI-37
24JS102-2	59.62	1-25/32	3/4	5/8 dia	D4	.255 HEX	Isolated Grnd.	AI-37
24JS102-3	187.316	1-25/32	3/4	5/8 dia	D4	.128 HEX	Isolated Grnd.	AI-37
24JS110-1	58.141	1-1/2	43/64	11/16	D4	.213 HEX	Improved	AI-37
24JS110-2	59.62.140	1-1/2	43/64	11/16	D4	.255 HEX	Improved	AI-37

## TNC JACK — SINGLE HOLE MOUNT — SHORT CRIMP

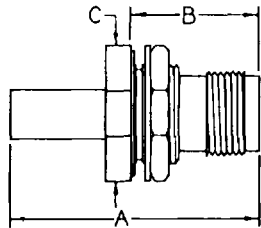

S/C Part No.	Cable RG-U	Dimension			Mtg. Hole	Crimp Tool	Engr. Data	Assy. Inst.
		A	B	C				
24JS111-1	58.141	1-5/16	43/64	11/16	D4	.213 HEX	Improved	AI-26
24JS111-2	59.62.140	1-5/16	43/64	11/16	D4	.255 HEX	Improved	AI-26
24JS142-1	58	1-3/8	13/16	11/16	D4	.213 HEX	Crimp Captive Contact	
24JS142-2	59.62	1-3/8	13/16	11/16	D4	.255 HEX	Crimp Captive Contact	
24JS145-1	9.214	1-17/32	13/16	11/16	D4	.429 HEX	Crimp Captive Contact	
24JS145-2	8.213	1-17/32	13/16	11/16	D4	.429 HEX	Crimp Captive Contact	

## TNC JACK — FLANGE MOUNT

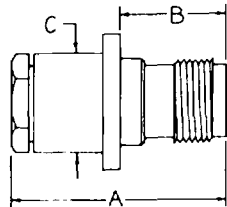

S/C Part No.	Cable RG-U	Dimension			Mtg. Plate	Engr. Data	Assy. Inst.
		A	B	C			
24JF101-1	55.58.141 142.223	1-1/8	35/64	1/2	2B	Improved	AI-14
24JF102-1	55.58.141 142.223	1-1/8	35/64	1/2	3A	Improved	AI-14
24JF103-1	58	1-1/8	35/64	1/2	3A	Straight Cut Style	AI-12
24JF103-2	59	1-1/8	35/64	1/2	3A	Straight Cut Style	AI-12
24JF103-3	174.316	1-1/8	35/64	1/2	3A	Straight Cut Style	AI-12
24JF103-4	223	1-1/8	35/64	1/2	3A	Straight Cut Style	AI-12
24JF106-1	141 S.R.	1-1/8	35/64	1/2	3A	Plug in Style	AI-21
24JF106-2	085 S.R.	1-1/8	35/64	1/2	3A	Plug in Style	AI-21

## TNC JACK RECEPTACLE — RIGHT ANGLE — FLANGE MOUNT

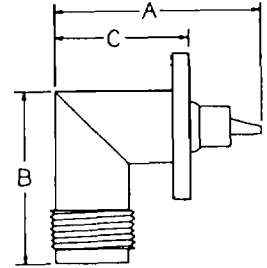

S/C Part No.	Dimension			Mtg. Plate	Engr. Data
	A	B	C		
24JR119-1	29/32	29/32	39/64	2B	.059 ID Solder Pot
24JR173-1	29/32	29/32	39/64	3B	.059 ID Solder Pot

## TNC JACK CAP & CHAIN

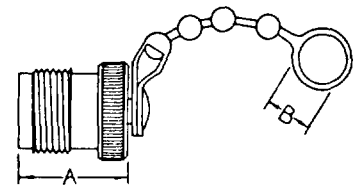

S/C Part No.	Dimension		Engr. Data
	A	B	
24JC100-1	37/64	9/32	3" Bead Chain
24JC102-1	21/32		Shorting Cap - No Chain

## TNC JACK RECEPTACLE — SINGLE HOLE MOUNT

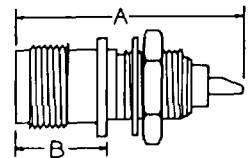

S/C Part No.	Dimension		Mtg. Hole	Engr. Data
	A	B		
24JR104-1	1-1/16	31/64	D4	Isolated Ground
24JR105-1	1-1/16	3/4	D4	Isolated Ground-Reverse Mount
24JR113-1	1-1/16	15/32	D8	Improved .062 ID Solder Pot
24JR118-1	1-3/16	15/32	D8	Improved .062 ID Solder Pot
24JR120-1	1-1/16	31/64	D6	Improved .062 ID Solder Pot
24JR161-1	1-3/64	33/64	D7	Herm. Sealed
24JR170-1	1-1/16	15/32	D5	M39012/31-0001
24JR170-2	1-3/16	15/32	D8	M39012/31-0002

# TNC SERIES



**SPECIALTY  
CONNECTOR CO., INC.**

## TNC JACK RECEPTACLE — FLANGE MOUNT

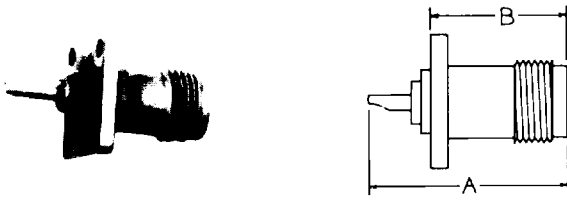

S/C Part No.	Dimension		Mtg. Plate	Engr. Data
	A	B		
24JR112-1	1-1/16	43/64	2B	Improved .062 ID Solder Pot
24JR122-1	1-5/32	23/32	3C	Improved .062 ID Solder Pot
24JR124-1	1-1/16	23/32	3A	Improved .062 ID Solder Pot
24JR144-1	1-1/16	45/64	1A	Improved .062 ID Solder Pot
24JR160-1	7/8	17/32	3A	Improved .062 ID Solder Pot

## TNC JACK RECEPTACLE — RIGHT ANGLE — SINGLE HOLE MOUNT

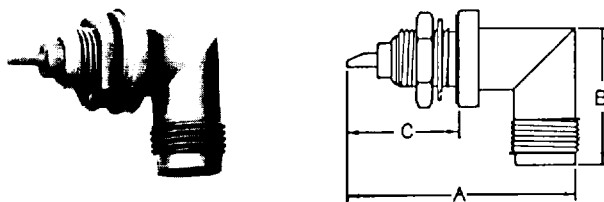

S/C Part No.	Dimension			Mtg. Hole	Engr. Data
	A	B	C		
24JR125-1	1-11/32	13/16	3/4	D7	Improved .062 ID Solder Pot

## TNC ADAPTER

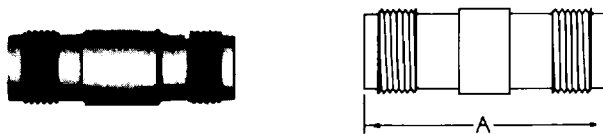

S/C Part No.	Adapter Ends	Dimension	Engr. Data
		A	
24A100-1	Jack-Jack	1-9/32	Improved

## TNC ADAPTER



S/C Part No.	Adapter Ends	Dimension	Engr. Data
		A	
24A101-1	Plug-Plug	1-15/64	Improved

## TNC ADAPTER — RIGHT ANGLE

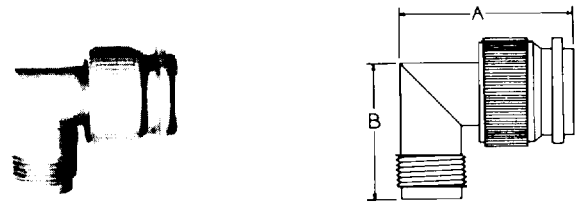

S/C Part No.	Adapter Ends	Dimension		Engr. Data
		A	B	
24AR100-1	Plug-Jack	1-1/32	51/64	Improved

## TNC ADAPTER — STRAIGHT — SINGLE HOLE MOUNT

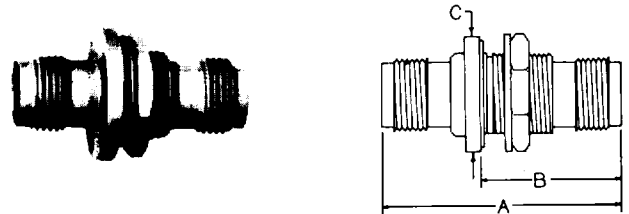

S/C Part No.	Adapter Ends	Dimension			Mtg. Hole	Engr. Data
		A	B	C		
24AS101-1	Jack-Jack	1-25/64	47/64	11/16	D4	Herm. Sealed
24AS101-2	Jack-Jack	1-17/32	55/64	3/4	D4	Herm. Sealed
24AS102-1	Jack-Jack	1-9/32	51/64	5/8	D4	Isolated Ground
24AS104-1	Jack-Jack	1-9/32	47/64	3/4	D4	

## TNC ADAPTER — TEE

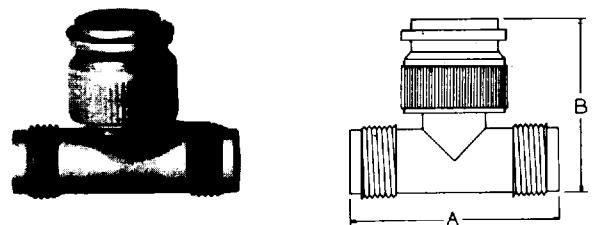

S/C Part No.	Adapter Ends	Dimension		Engr. Data
		A	B	
24AT100-1	Jack-Plug-Jack	1-9/32	1-1/32	Improved
24AT102-1	Jack-Jack-Jack	1-9/32	57/64	

## TNC PLUG — BINDING POST

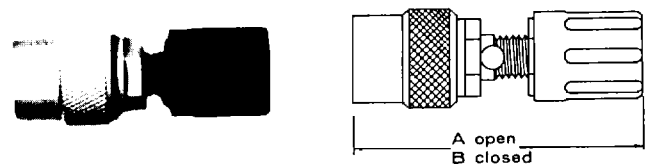

S/C Part No.	Dimension		Engr. Data
	A	B	
24PB100-1	1-9/16	1-5/16	Accepts Banana Plug