

## MS27474

### Jam Nut Mount Environment Resisting Receptacle

## MIL-DTL-38999

### Series II Receptacles

SHELL SIZE	ØQ ±.016 [±0.41]	S ±.016 [±0.41]	VV Thd CLASS 2A UNEF
8	1.375 [34.93]	1.250 [31.75]	.4375-28
10	1.500 [38.10]	1.375 [34.93]	.5625-24
12	1.625 [41.28]	1.500 [38.10]	.6875-24
14	1.750 [44.45]	1.625 [41.28]	.8125-20
16	1.938 [49.23]	1.781 [45.24]	.9375-20
18	2.016 [51.21]	1.890 [48.00]	1.0625-18
20	2.140 [54.36]	2.016 [51.21]	1.1875-18
22	2.265 [57.53]	2.140 [54.36]	1.3125-18
24	2.390 [60.71]	2.265 [57.53]	1.4375-18

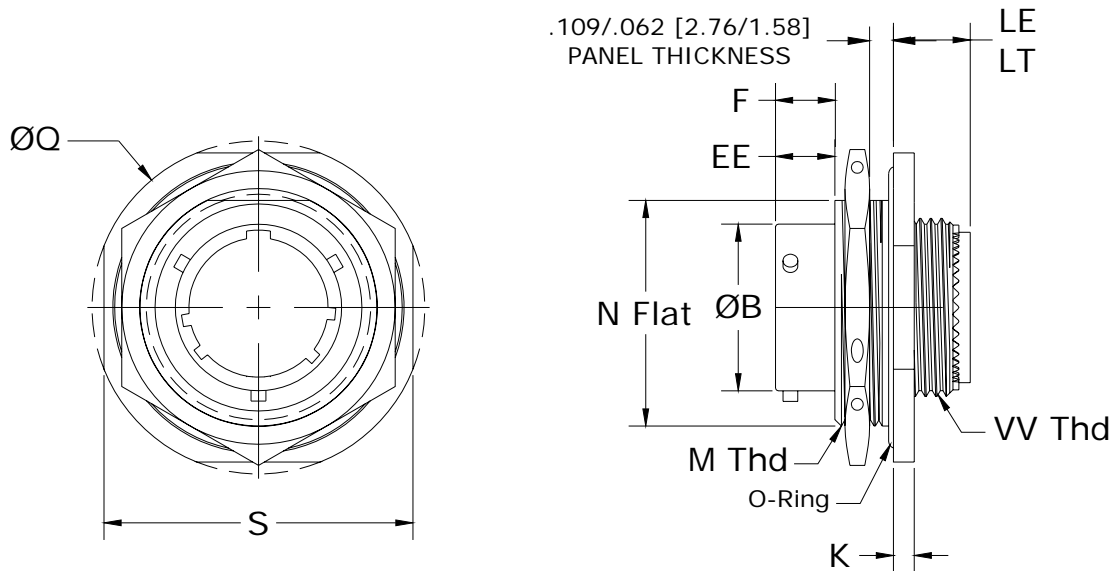

SHELL SIZE	ØB +.001/-0.005 [+0.03/-0.13]	EE +.005/-0.000 [+0.13/-0.00]	F ±.005 [±0.13]	K +.011/-0.010 [+0.28/-0.25]	LE MAX (CLASS E)	LT MAX (CLASS T)	M Thd CLASS 2A	N Flat +.001/-0.006 [+0.03/-0.15]
8	.473 [12.01]	.140 [3.56]	.438 [11.13]	.094 [2.39]	.516 [13.11]	.344 [8.74]	.875-20 UNEF	.817 [20.75]
10	.590 [14.99]	.140 [3.56]	.438 [11.13]	.094 [2.39]	.516 [13.11]	.344 [8.74]	1.000-20 UNEF	.941 [23.90]
12	.750 [19.05]	.140 [3.56]	.438 [11.13]	.094 [2.39]	.516 [13.11]	.344 [8.74]	1.125-18 UNEF	1.065 [27.05]
14	.875 [22.23]	.140 [3.56]	.438 [11.13]	.094 [2.39]	.516 [13.11]	.344 [8.74]	1.250-18 UNEF	1.190 [30.23]
16	1.000 [25.40]	.140 [3.56]	.438 [11.13]	.094 [2.39]	.516 [13.11]	.344 [8.74]	1.375-18 UNEF	1.320 [33.63]
18	1.125 [25.58]	.140 [3.56]	.438 [11.13]	.094 [2.39]	.516 [13.11]	.344 [8.74]	1.500-18 UNEF	1.440 [36.58]
20	1.250 [31.75]	.166 [4.22]	.464 [11.79]	.094 [2.39]	.484 [12.29]	.312 [7.92]	1.625-18 UNEF	1.565 [39.75]
22	1.375 [34.93]	.166 [4.22]	.464 [11.79]	.094 [2.39]	.484 [12.29]	.312 [7.92]	1.750-18 UNS	1.690 [42.93]
24	1.500 [38.10]	.166 [4.22]	.464 [11.79]	.094 [2.39]	.484 [12.29]	.375 [9.53]	1.875-16 UN	1.815 [46.10]

DIMENSIONS ARE IN INCHES [MILLIMETERS]