

**PCB Sockets  
PCB Mount, 2.0mm Pitch**

**Product Specification:**

**Materials and Finish**

**Insulator:** Glass-reinforce thermoplastic, UL-94V-0 rated, color-black, resist to short term temperature in infra-red reflow phase - 260°C for 20 seconds. (See page 9 "Reflow Conditions" for detailed information)

**Contact:** Phosphor Bronze per QQ-B-750, plated full flash gold, full 100µ" tin/lead or selected gold in mating area; 100µ" min. tin-lead on termination area, with entire contact under-plated 50µ" min. nickel

**Electrical**

**Contact Resistance:** 30 milliohms max. at 1 ampere DC

**Insulation Resistance:** 1000 megohms at 500 VDC

**Dielectric Withstanding Voltage:** 500 VAC/rms 60Hz for one minute

**Current Rating:** 1 ampere per contact

**Voltage Rating:** 250 VAC/rms 60Hz

**Mechanical**

**Insertion Force:** 150 grams maximum per contact

**Withdrawal Force:** 50 grams minimum per contact

**Contact Retention:** 2.0 kgs minimum per contact

**Durability:** See page 9

**Related Product Data**

**PC Board Layout:** See page 77

**Ordering Information:**

**G827 XX X X X X X X**

**PCB Sockets  
PCB Mount  
2.0mm Pitch**

**Number of Positions**

Single Row: 04 to 40 positions  
Dual Rows: 06 to 80 positions

**Mounting Style**

1: Single row  
2: Dual rows

**Connector Style**

0: Straight type  
1: Right angle type

**Contact Finish**

0: Full flash gold  
1: Flash gold  
2: 10µ" gold  
3: 30µ" gold  
4: Tin

**Height of Insulator**

0: 4.0 mm (for dual row only)  
1: 4.3 mm

**Length of PC Tail**

0: 1.2 mm  
1: 2.4 mm (standard)  
2: 3.2 mm

**Variation Code**

Blank: Standard

**PCB Sockets**  
**PCB Mount, Single Row, 2.0mm Pitch**

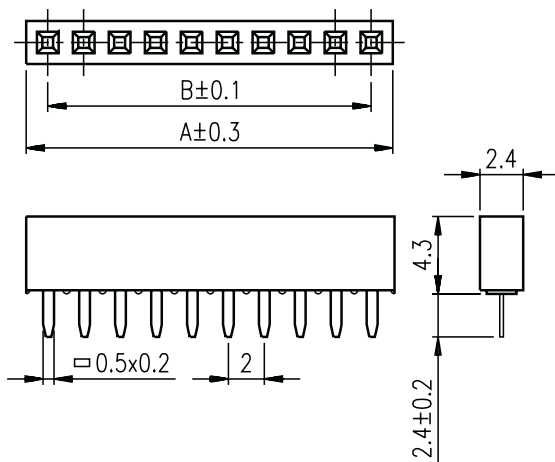

**Straight PCB Mount**

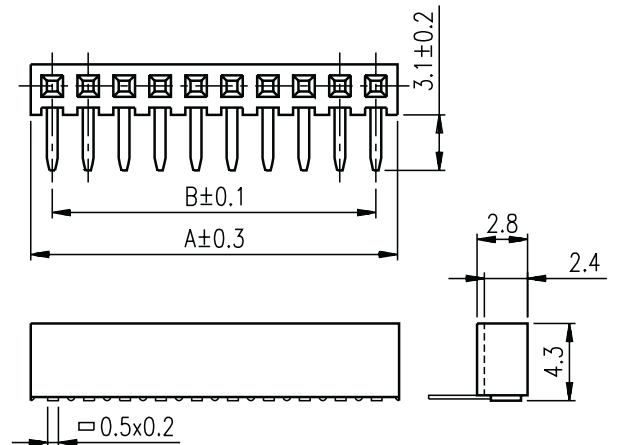

**Right Angle PCB Mount**

No. of Positions	Dimensions (mm)		No. of Positions	Dimensions (mm)		No. of Positions	Dimensions (mm)	
	A	B		A	B		A	B
4	8.5	6	17	34.5	32	30	60.5	58
5	10.5	8	18	36.5	34	31	62.5	60
6	12.5	10	19	38.5	36	32	64.5	62
7	14.5	12	20	40.5	38	33	66.5	64
8	16.5	14	21	42.5	40	34	68.5	66
9	18.5	16	22	44.5	42	35	70.5	68
10	20.5	18	23	46.5	44	36	72.5	70
11	22.5	20	24	48.5	46	37	74.5	72
12	24.5	22	25	50.5	48	38	76.5	74
13	26.5	24	26	52.5	50	39	78.5	76
14	28.5	26	27	54.5	52	40	80.5	78
15	30.5	28	28	56.5	54			
16	32.5	30	29	58.5	56			

**PCB Sockets**  
**PCB Mount, Dual Rows, 2.0mm Pitch**

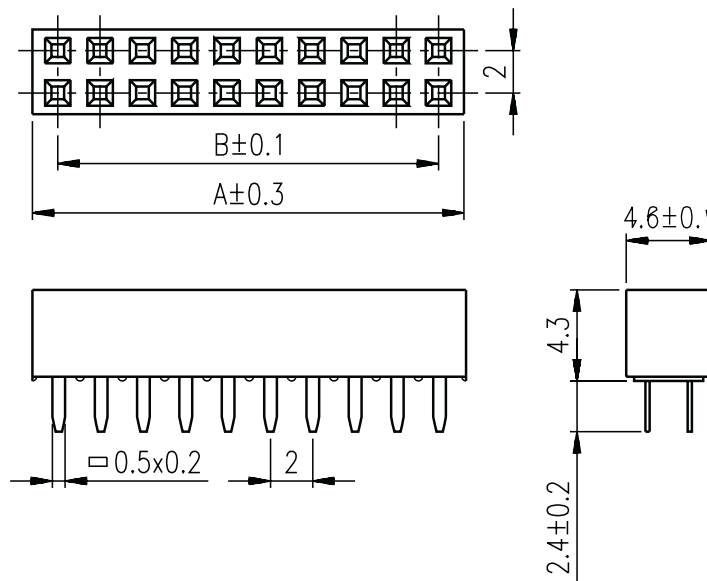

No. of Positions	Dimensions (mm)		No. of Positions	Dimensions (mm)		No. of Positions	Dimensions (mm)	
	A	B		A	B		A	B
6	6.5	4	32	32.5	30	58	58.5	56
8	8.5	6	34	34.5	32	60	60.5	58
10	10.5	8	36	36.5	34	62	62.5	60
12	12.5	10	38	38.5	36	64	64.5	62
14	14.5	12	40	40.5	38	66	66.5	64
16	16.5	14	42	42.5	40	68	68.5	66
18	18.5	16	44	44.5	42	70	70.5	68
20	20.5	18	46	46.5	44	72	72.5	70
22	22.5	20	48	48.5	46	74	74.5	72
24	24.5	22	50	50.5	48	76	76.5	74
26	26.5	24	52	52.5	50	78	78.5	76
28	28.5	26	54	54.5	52	80	80.5	78
30	30.5	28	56	56.5	54			

**Recommended PCB Layouts**  
**PCB Sockets, 2.0mm Pitch**

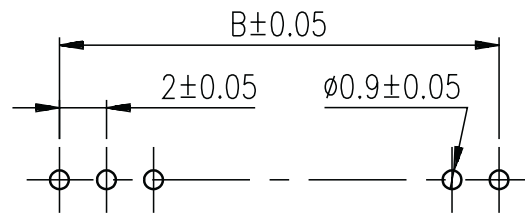

**Recommended PCB Layout**  
**(Single Row)**

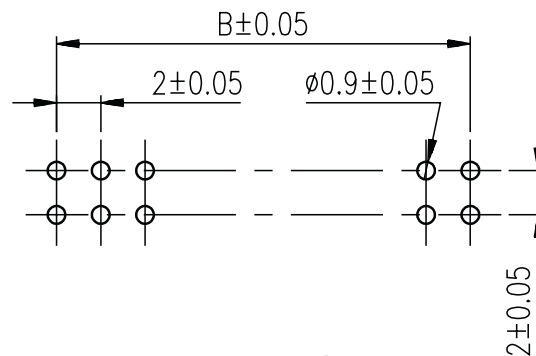

**Recommended PCB Layout**  
**(Dual Rows)**