

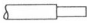

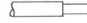

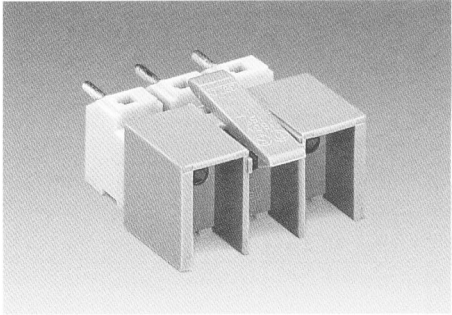
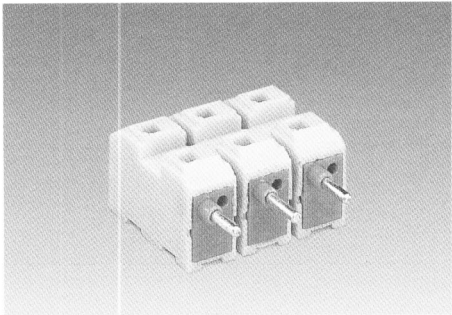

Fully Polarized Connectors for Lighting Fixtures in Dropped Ceilings

	<b>2 x 0.5 – 2.5 mm<sup>2</sup> "s"</b>   <b>2 x AWG 20 – 14 sol.</b> <b>200 V/4 kV/3 ①</b> <b>400 V/4 kV/2 ①</b> <b>16 A</b>  <b>8 – 9 mm / 0.33 in</b> <small>* VDE Kitemark ② ③</small>	<b>1 x 0.5/0.75 mm<sup>2</sup> "s"</b>   <b>1 x AWG 20 – 18 sol.</b> <b>200 V/4 kV/3 ①</b> <b>400 V/4 kV/2 ①</b> <b>16 A (through connection),</b> <b>6 A (connection to the lighting fixture)</b>  <b>8 – 9 mm / 0.33 in</b> <small>* VDE</small>
--	--	---

- ① In grounded (earthed) supply systems  
200/400 V = rated voltage  
4 kV = rated surge voltage  
2/3 = pollution degree  
(see also section 10)
- ② Suitable for assembly without tool
- ③ or of a cable NYM 3 x 2.5 mm<sup>2</sup>/5 x 2.5 mm<sup>2</sup>  
(AWG 14)



Description	No. of poles	Item-No.	Pack.-unit pcs	No. of poles	Item-No.	Pack.-unit pcs
<b>Fully polarized connectors for lighting fixtures in dropped ceilings</b> , for screw or screwless fixing (WAGO pins), with standard printing, push-in type strain relief devices, coding mask of center receptacle and female connectors with integrated locking device.	<b>Male connector</b> , with preceding earth contact, white			<b>Center receptacle</b> , with coding mask, white / grey		
	3	<b>272-453/272-485</b>	500	3	<b>272-413/272-489</b>	500
	<b>Ditto</b> , with additional coding pins (poles ② and 1), white			<b>Ditto</b> , with additional coding pins and holes (poles ② and 1), white / grey		
	3	<b>272-453/272-469</b>	500	3	<b>272-413/272-419</b>	500
	5	<b>272-455/272-485</b>	250	5	<b>272-415/272-491</b>	250
<b>Accessories</b>						
	<b>Strain relief support</b> , with clamp for 2 cables NYM max.	3-pole	3 x 1.5 mm <sup>2</sup> ③	<b>272-492</b>	500	
		5-pole	5 x 1.5 mm <sup>2</sup> ③	<b>272-493</b>	250	
	<b>Strain relief housing</b> , for 2 cables NYM max.	3-pole	3 x 1.5 mm <sup>2</sup> ③	<b>272-497</b>	500	
		5-pole	5 x 1.5 mm <sup>2</sup> ③	<b>272-498</b>	250	
	<b>Pins</b> , for plate thickness			1 mm / 0.039 in	<b>271-702</b>	1000
				1 mm / 0.039 in	<b>271-711 ②</b>	1000
				1.5 mm / 0.059 in	<b>271-712 ②</b>	1000
	<b>Pin terminals</b> , 0.5/0.75 mm <sup>2</sup>	I <sub>N</sub> 6/8 A, green	<b>209-151</b>	100		
	1/1.5 mm <sup>2</sup>	I <sub>N</sub> 10/16 A, beige	<b>209-164</b>	100		
	2.5 mm <sup>2</sup>	I <sub>N</sub> 20 A, blue	<b>209-157</b>	100		
	<b>Crimping tool</b> , for pin terminals, crimping range 0.5-2.5 mm <sup>2</sup> /AWG 20 – 14		<b>210-176</b>	1		

A fully polarized 3-pole connector for lighting fixtures in dropped ceilings is consisting of the following element:

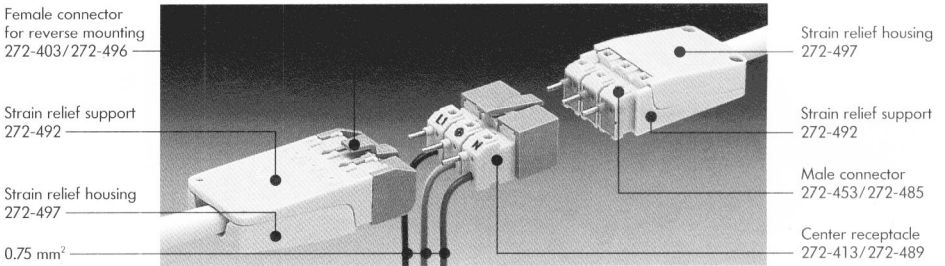

Dimensions (in mm)

No. of poles	Male connector	Center receptacle	Female connector
3	28.5	33	33
5	48.5	53	53

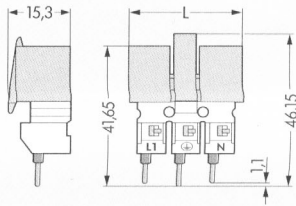
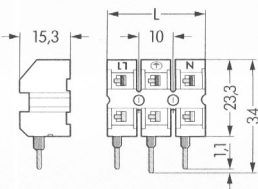

Overall length of the connectors in mated condition:  
142 mm / 5.591 in (incl. strain relief device)

\* For further approvals with corresponding ratings see pages 10.3 ff.

\*   VDE KEMA

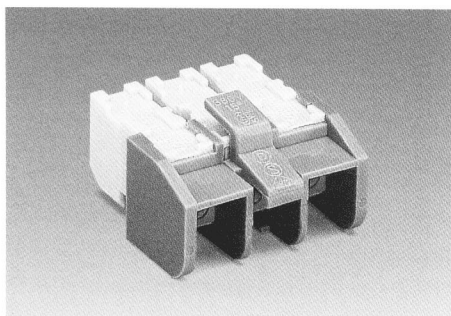

No. of poles	Item-No.	Pack.-unit pcs
<b>Female connector for reverse mounting,</b>		
with coding mask, white /grey		
3	<b>272-403/272-496</b>	500
<b>Ditto</b> , with additional coding holes (poles ⊕ and 1)		
3	<b>272-403/272-486</b>	500
5	<b>272-405/272-514</b>	250
3 x 1.5 mm² Ⓢ	<b>272-492</b>	500
5 x 1.5 mm² Ⓢ	<b>272-493</b>	250
3 x 1.5 mm² Ⓢ	<b>272-497</b>	500
5 x 1.5 mm² Ⓢ	<b>272-498</b>	250
I <sub>N</sub> 6/8 A, green	<b>209-151</b>	100
I <sub>N</sub> 10/16 A, beige	<b>209-164</b>	100
I <sub>N</sub> 20 A, blue	<b>209-157</b>	100
	<b>210-176</b>	1

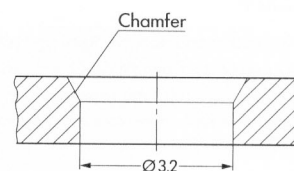

### Dimensions of fixing holes for pins

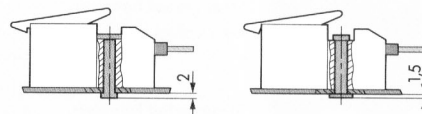

Fixing pin from top

Fixing pin from below

Screwless fixing with pins 271-702

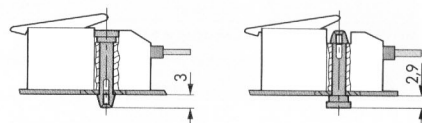

Fixing pin from top

Fixing pin from below

Screwless fixing with pins 271-711 or 271-712

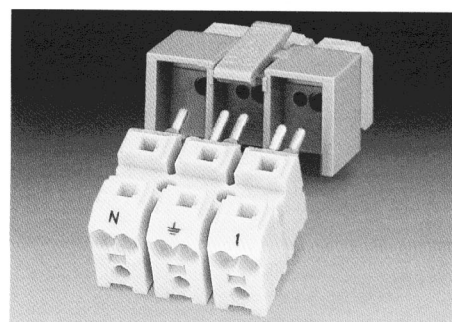
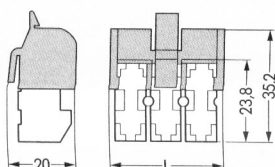

Connector with additional coding pins/holes