

**QUALITY
TECHNOLOGIES**

OPTOELECTRONICS

T-1 3/4 (5mm) bilevel

PART NO.	COLOR	VF	mcd	mA	PKG FIG
MV60539.MP90	RED/RED	1.7	3.2	20	9
MV63539.MP93	YLW/YLW	2.1	20.0	20	9
MV64539.MP94	GRN/GRN	2.2	28.0	20	9
MV67539.MP97	HER/HER	2.1	15.0	20	9

LOW CURRENT (2mA)

HLMP-47009.MP97	HER/HER	1.8	2.0	2	9
HLMP-47199.MP93	YLW/YLW	1.9	2.0	2	9
HLMP-47409.MP94	GRN/GRN	1.9	3.0	2	9

ULTRA BRIGHT

MV33509.MP93	YLW/YLW*	2.2	150.0	20	9
MV34509.MP94	GRN/GRN*	2.2	150.0	20	9
MV37509.MP97	HER/HER*	2.2	150.0	20	9

INTEGRAL RESISTOR

MR30509.MP90	RED/RED	5.0	2.0	13	9
MR33509.MP93	YLW/YLW	5.0	4.0	10	9
MR34509.MP94	GRN/GRN	5.0	4.0	12	9
MR37509.MP97	HER/HER	5.0	4.0	10	9

BICOLOR

MV54919.MP91	R/G/R/G	2.3	6.0	20	9
--------------	---------	-----	-----	----	---

NOTE: Custom color combinations are available.

T-1 3/4 (5mm) vertical standoff

PART NO.	COLOR	VF	mcd	mA	PKG FIG
MV60539.MP10	RED	1.7	3.2	20	10
MV63539.MP10	YLW	2.1	20.0	20	10
MV64539.MP10	GRN	2.2	28.0	20	10
MV67539.MP10	HER	2.1	15.0	20	10

LOW CURRENT (2mA)

HLMP-47009.MP10	HER	1.8	2.0	2	10
HLMP-47199.MP10	YLW	1.9	2.0	2	10
HLMP-47409.MP10	GRN	1.9	3.0	2	10

ULTRA BRIGHT

MV33509.MP10	YLW*	2.2	150.0	20	10
MV34539.MP10	GRN*	2.2	150.0	20	10
MV37509.MP10	HER*	2.2	150.0	20	10

All electrical values are typical.
*Clear lens.

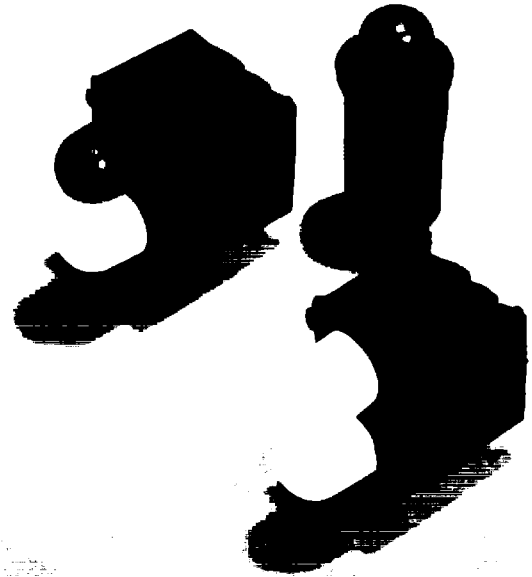
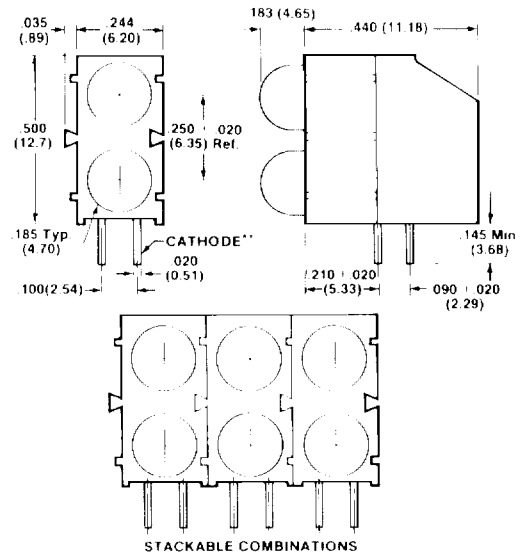
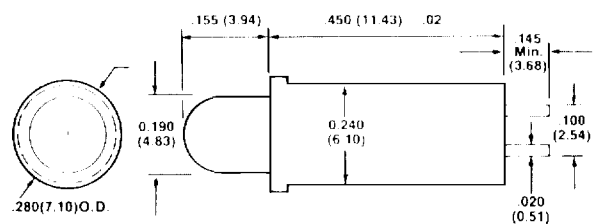

Figure 9



** THE CATHODE, AS INDICATED, IS THE RED CATHODE FOR THE RED/GREEN BICOLOR LED
DECIMALS - 0.015 (- 0.38)

Figure 10



DECIMALS - 0.015 (- 0.38)