

DC BLOCKING ATTENUATOR

Type F, 10 MHz - 2 GHz, 200 Volts

SPECIFICATIONS:

Models: 8528A-XX

RoHS
Compliant

AEROFLEX
A passion for performance.

Electrical:

Frequency Range _____ 10 MHz - 2 GHz
Standard dB Values* _____ 0 - 10, 12, 15 & 20 dB
Accuracy of Attenuation: _____ In 1 dB Increments
1 - 6 dB _____ ± 0.3 dB
7 - 20 dB _____ ± 0.5 dB
VSWR: _____ 1.35:1 Max.
Impedance: _____ 75 Ohms
DC Block Type _____ Inner Only
Voltage Rating _____ 200 Volts
Input Power _____ 2 Watts Average
Operating Temp. Range _____ -65°C to +125°C

Mechanical:

Type F Connectors: _____ Bright Acid Tin and Nickel Plated Brass
Conductors: _____ Nickel and Gold Plated Brass
Bodies: _____ Passivated Stainless Steel

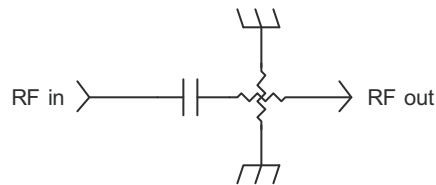

Schematic Diagram

Unit is a unidirectional device. Input shall be at male port unless otherwise specified.

Model Number: **8528A-XX**

Male/Female Connectors

Length: $1.50 \pm .05$ [38.1 \pm 1.3]

As Pictured

Model Number: **8528A-XXM**

Male/Male Connectors

Length: $1.22 \pm .05$ [31.0 \pm 1.3]

Model Number: **8528A-XXF**

Female/Female Connectors

Length: $1.79 \pm .05$ [45.5 \pm 1.3]

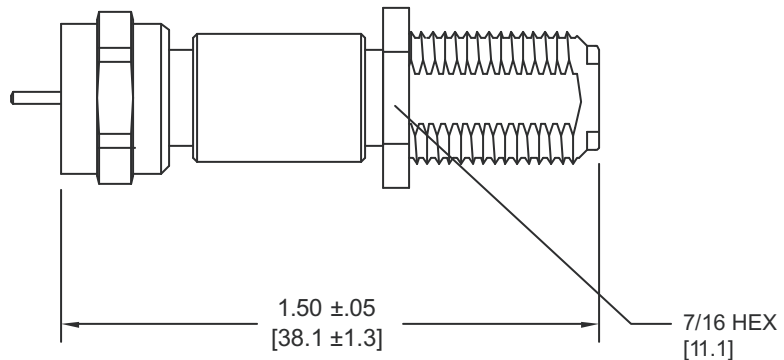

HOW TO ORDER:

Model Number: **8528A-XXY**

Connector Configuration
= Male/Female
F = Fem/Fem
M = Male/Male

dB Value

Ordering Examples:

Model Number: **8528A-20**
20 dB; F - Male/Fem

Model Number: **8528A-10M**
10 dB; F - Male/Male

Note: Dimensions in Brackets are Expressed in Millimeters and are for Reference Only.

*Other dB values, connectors and/or DC Block configurations are also available.

8528A: REV E

AEROFLEX
INMET

Aeroflex / Inmet, Inc. • 300 Dino Drive, Ann Arbor, MI 48103 • U.S.A.
888-244-6638 or 734-426-5553 • FAX: 734-426-5557
www.aeroflex-inmet.com • inmet-sales@eroflex.com