

Tous droits strictement reserves. Reproduction ou communication a des tiers interdite sous quelque forme que ce soit sans autorisation ecrite du proprietaire. Propriete de c FCI. Droits de reproduction FCI.

All rights strictly reserved. Reproduction or issue to third parties in any form whatever is not permitted without written authority from the proprietor. Property of FCI. Copyright FCI.

PRODUCT NO
SEE TABLE

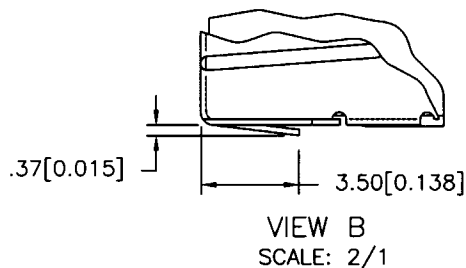
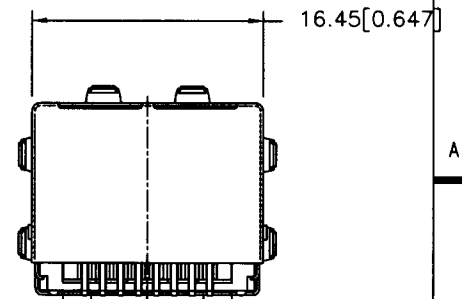
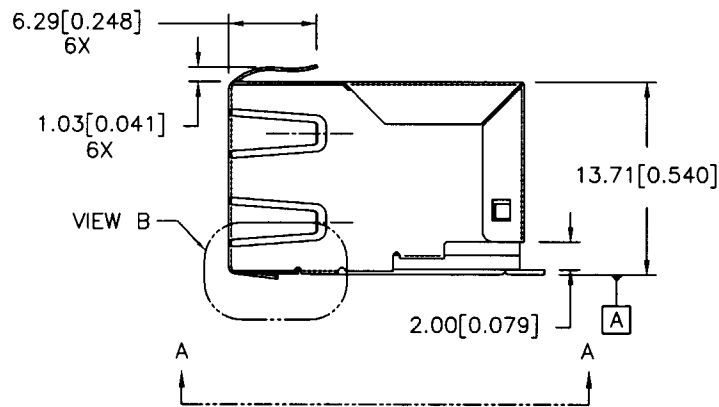
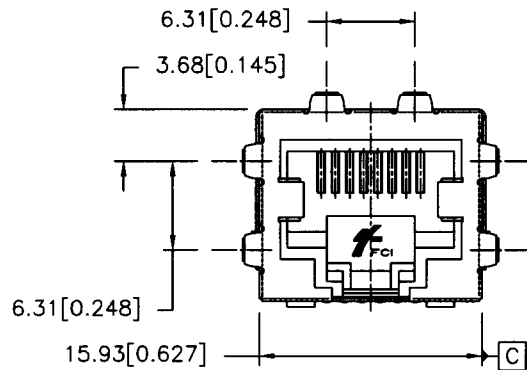
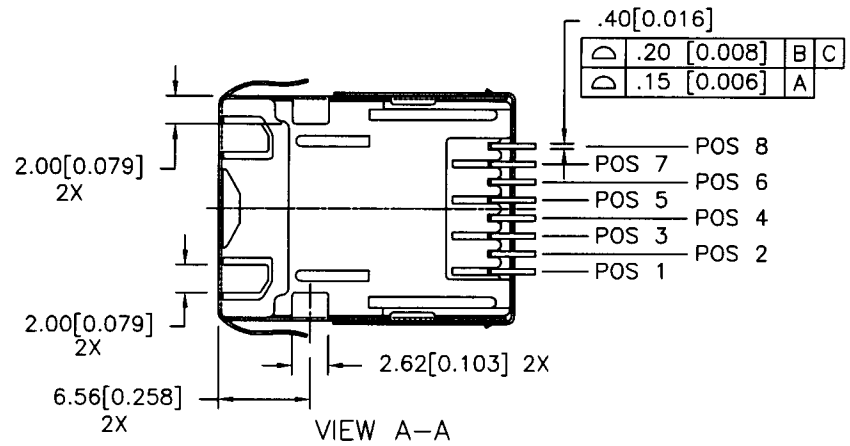
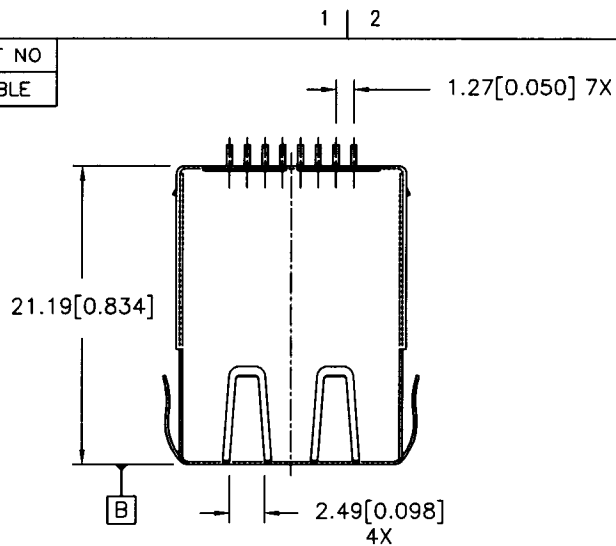

PRELIMINARY

mat'l. code				tolerances unless otherwise specified		CUSTOMER COPY	Electronics www.fciconnect.com
ltr	ecn no	dr	date	.X±.3/.XX.01			
A	V80716	GAH	4/23/98	linear	.XX±.13/.XXX.005		SPS SERIES, RJ45, SMT
B	V81335	GAH	7/22/98		.XXX±.051/.XXXX.0020		
C	V91281	LP	6/9/99	angles	0° ±2°	mm/INCH	product family MOD JACK
D	V92057	LP	10/20/99	dr	G.HULL 4/23/98	scale	code
E	V92147	CGC	12/6/99	enr	B. MARSHALL 4/23/98	1:1	size
F	V00648	CSP	6/13/00	chr	B. MARSHALL 4/23/98		A4
				appd	B. MARSHALL 4/23/98		74829
sheet index	revision sheet	F 1	F 2	F 3			sheet 1 of 3

cage code
22526

ACAD

Tous droits strictement reserves. Reproduction ou communication a des tiers interdite sous quelque forme que ce soit sans autorisation écrite du propriétaire. Propriete de c FCI. Droits de reproduction FCI.

All rights strictly reserved. Reproduction or issue to third parties in any form whatever is not permitted without written authority from the proprietor. Property of FCI. Copyright FCI.

PRODUCT NO	74829-XZ1Y	
SPRING OPTION Y	DESCRIPTION (SEE SHEET 3 FOR OPTION VIEWS)	
1	SPRINGS ON TOP, BOTTOM, AND BOTH SIDES	
2	NO SPRINGS	
3	SPRINGS ON TOP AND BOTTOM	
4	SPRINGS ON TOP, BOTTOM, AND 1 PER SIDE (STAGGERED)	
5	SAME AS OPTION 4, EXCEPT OPPOSITE STAGGER	

PACKAGING OPTION Z	DESCRIPTION
0	TRAY
1	TAPE AND REEL

PLATING CODE X	PLATING
0	.76µM/30µ" G.X.T.
3	.76µM/30µ" GOLD
5	1.27µM/50µ" GOLD

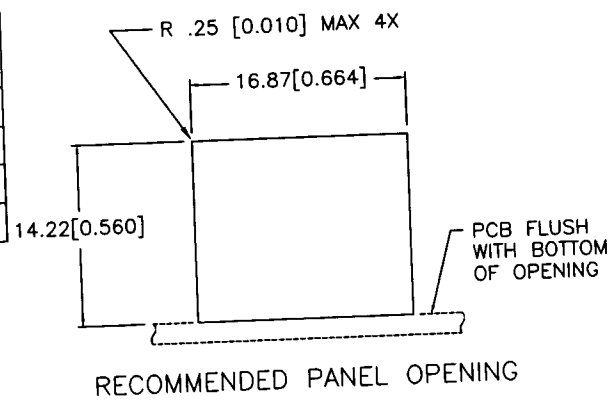

- NOTES :
- HOUSING MATL: HIGH TEMP. THERMOPLASTIC, COLOR BLACK, UL94V-0.
 - CONTACT MATL: COPPER ALLOY
MATING AREA PLATING: Au OVER Ni., (SEE TABLE).
SOLDER AREA PLATING: 2.54µM/100u" MIN TIN LEAD OVER Ni.
 - SHIELDING MAT'L: TIN PLATED COPPER ALLOY.
 - ALL DIMENSIONS IN MILLIMETERS AND INCHES.
 - UNLESS OTHERWISE SPECIFIED:
DIMENSIONS AND TOLERANCES ARE IN ACCORDANCE WITH ASME Y14.5M 1994.

Δ .25 [0.010] A B C

ALL UNTOLERANCED DIMENSIONS ARE BASIC.

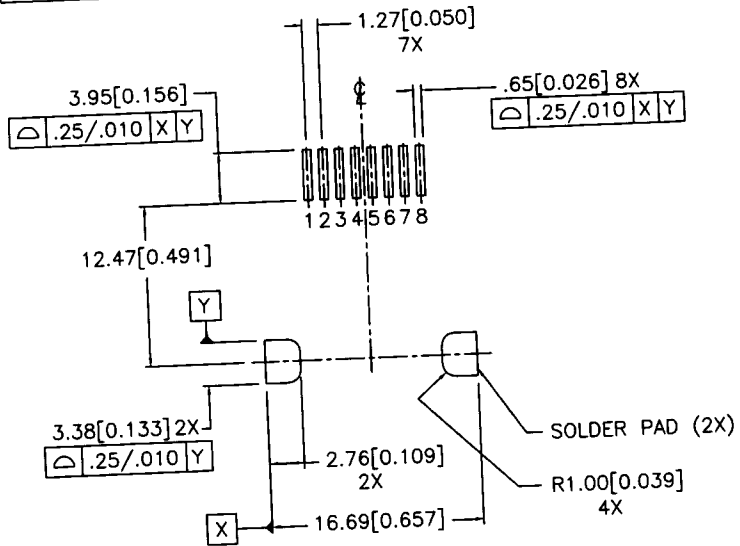

RECOMMENDED P.C.B. LAYOUT AS VIEWED FROM TOP SIDE (COMPONENT SIDE)

PRELIMINARY

mat'l. code				tolerances unless otherwise specified		CUSTOMER COPY		Electronics www.fciconnect.com					
ltr	ecn no	dr	date	linear	.X±.3/.XX.01	projection		title					
F					.XX±.13/.XXX.005			SPS SERIES, RJ45, SMT					
					.XXX±.051/.XXX.0020								
				angles	0° ±2'	mm/INCH		product family	MOD JACK	code			
				dr	G.HULL 4/23/98			A4	74829	-			
				engr	B. MARSHALL 4/23/98					size	2 of		
				chr	B. MARSHALL 4/23/98								
				appd	B. MARSHALL 4/23/98	scale	1:1						
sheet index	revision sheet							cage code	22526				

Tous droits strictement reserves. Reproduction ou communication a des tiers interdite sous quelque forme que ce soit sans autorisation écrite du propriétaire. Propriete de c FCI. Droits de reproduction FCI.

All rights strictly reserved. Reproduction or issue to third parties in any form whatever is not permitted without written authority from the proprietor. Property of FCI. Copyright FCI.



PRODUCT NO
SEE TABLE

SPRING OPTION Y CONFIGURATIONS

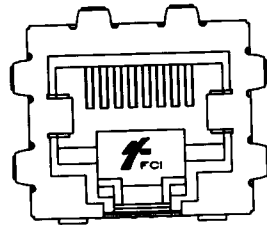

OPTION 1

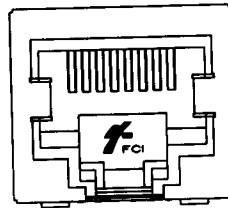

OPTION 2

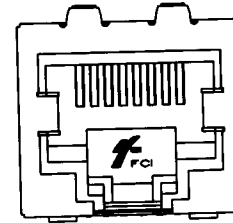

OPTION 3

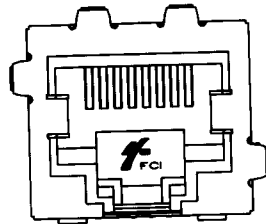

OPTION 4

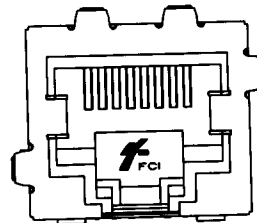

OPTION 5

PRELIMINARY

mat'l. code				tolerances unless otherwise specified				CUSTOMER COPY		Electronics www.fciconnect.com			
ltr	ecn no	dr	date	linear	.X±.3/.XX.01		projection		title				
F					.XX±.13/.XXX.005				SPS SERIES, RJ45, SMT				
					.XXX±.051/.XXXX.0020								
				angles	0° ±2'		mm/INCH		product family MOD JACK		code		
				dr	G.HULL	4/23/98			size		A4	74829	sheet 3 of
				engr	B. MARSHALL	4/23/98			dwg no				
				chr	B. MARSHALL	4/23/98			scale				
				appd	B. MARSHALL	4/23/98			1:1				
sheet index	revision sheet										cage code		
											22526		

ACAD