

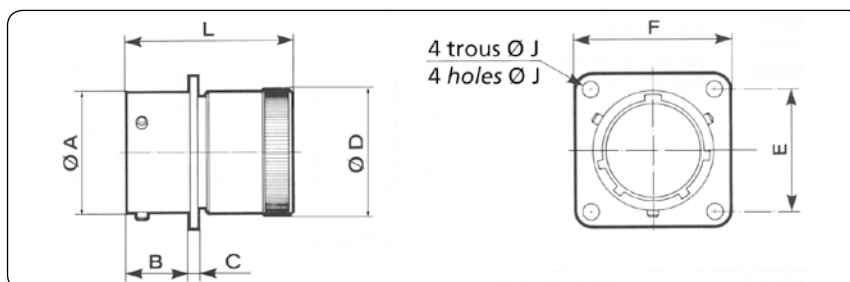

Encombremments / Dimensions

Embase à collerette carrée avec raccord simple Square flange receptacle with backnut

00 E	HE 301 B 00 E
	MS 3110 E
00 R	HE 301 B 00 R
	MS 3120 E
	VG 95328 A



Taille de boîtier Shell size	Références / Part numbers		L max		A	B max	C max	D max	E	F max	J
	contacts à souder solder contacts	contacts à sertir crimp contacts	souder solder	sertir crimp							
8	851 00 E 8.. $\frac{P}{S}$. 50..	851 00 R 8.. $\frac{P}{S}$. 50..	32.70	32.00	12.03	11.70	1.32	13.50	15.09	20.99	3.13
10	851 00 E 10.. $\frac{P}{S}$. 50..	851 00 R 10.. $\frac{P}{S}$. 50..	32.70	32.00	15.01	11.70	1.32	16.70	18.26	24.19	3.13
12	851 00 E 12.. $\frac{P}{S}$. 50..	851 00 R 12.. $\frac{P}{S}$. 50..	32.70	32.00	19.07	11.70	1.32	19.90	20.62	26.54	3.13
14	851 00 E 14.. $\frac{P}{S}$. 50..	851 00 R 14.. $\frac{P}{S}$. 50..	32.70	32.00	22.25	11.70	1.32	23.40	23.00	28.89	3.13
16	851 00 E 16.. $\frac{P}{S}$. 50..	851 00 R 16.. $\frac{P}{S}$. 50..	32.70	32.00	25.42	11.70	1.32	26.60	24.61	31.29	3.13
18	851 00 E 18.. $\frac{P}{S}$. 50..	851 00 R 18.. $\frac{P}{S}$. 50..	32.70	32.00	28.60	11.70	1.32	29.50	26.97	33.69	3.13
20	851 00 E 20.. $\frac{P}{S}$. 50..	851 00 R 20.. $\frac{P}{S}$. 50..	34.50	33.40	31.77	14.35	2.15	32.70	29.36	36.89	3.13
22	851 00 E 22.. $\frac{P}{S}$. 50..	851 00 R 22.. $\frac{P}{S}$. 50..	34.50	33.40	34.95	14.35	2.15	36.00	31.75	39.99	3.13
24	851 00 E 24.. $\frac{P}{S}$. 50..	851 00 R 24.. $\frac{P}{S}$. 50..	34.50	33.40	38.12	15.20	2.15	39.10	34.92	43.15	3.81

Embase à collerette carrée avec raccord droit à serre-câbles Square flange receptacle with straight cable clamp

00 EC	HE 301 B 00 EC
	MS 3110 F
00 AC	HE 301 B 00 AC
00 RC	HE 301 B 00 RC
	MS 3120 F
	VG 95328 B

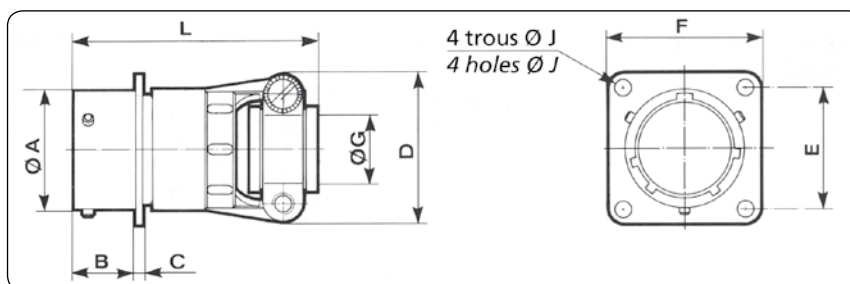

Taille de boîtier Shell size	Références / Part numbers		L max		A	B max	C max	D max	E	F max	G	J
	contacts à souder solder contacts	contacts à sertir crimp contacts	souder solder	sertir crimp								
8	851 00 $\frac{EC}{AC}$ 8.. $\frac{P}{S}$. 50..	851 00 RC 8.. $\frac{P}{S}$. 50..	48.00	47.30	12.03	11.70	1.32	19.90	15.09	20.99	3.50	3.13
10	851 00 $\frac{EC}{AC}$ 10.. $\frac{P}{S}$. 50..	851 00 RC 10.. $\frac{P}{S}$. 50..	48.00	47.30	15.01	11.70	1.32	21.50	18.26	24.19	5.00	3.13
12	851 00 $\frac{EC}{AC}$ 12.. $\frac{P}{S}$. 50..	851 00 RC 12.. $\frac{P}{S}$. 50..	48.00	47.30	19.07	11.70	1.32	25.00	20.62	26.54	8.20	3.13
14	851 00 $\frac{EC}{AC}$ 14.. $\frac{P}{S}$. 50..	851 00 RC 14.. $\frac{P}{S}$. 50..	48.00	47.30	22.25	11.70	1.32	27.80	23.00	28.89	10.00	3.13
16	851 00 $\frac{EC}{AC}$ 16.. $\frac{P}{S}$. 50..	851 00 RC 16.. $\frac{P}{S}$. 50..	51.00	50.50	25.42	11.70	1.32	29.40	24.61	31.29	13.00	3.13
18	851 00 $\frac{EC}{AC}$ 18.. $\frac{P}{S}$. 50..	851 00 RC 18.. $\frac{P}{S}$. 50..	51.00	50.50	28.60	11.70	1.32	35.30	26.97	33.69	16.00	3.13
20	851 00 $\frac{EC}{AC}$ 20.. $\frac{P}{S}$. 50..	851 00 RC 20.. $\frac{P}{S}$. 50..	53.00	51.50	31.77	14.35	2.15	35.30	29.36	36.89	16.00	3.13
22	851 00 $\frac{EC}{AC}$ 22.. $\frac{P}{S}$. 50..	851 00 RC 22.. $\frac{P}{S}$. 50..	53.00	51.50	34.95	14.35	2.15	41.10	31.75	39.99	19.30	3.13
24	851 00 $\frac{EC}{AC}$ 24.. $\frac{P}{S}$. 50..	851 00 RC 24.. $\frac{P}{S}$. 50..	53.00	51.50	38.12	15.20	2.15	42.40	34.92	43.15	20.60	3.81