

NOTES:
 Rated Current:0.5AMP
 Rated Voltage:50V AC/DC
 Contact Resistance:30mΩ max
 Insulation Resistance:100MΩ min
 Operation Temperature:-20? to +105?

Contact Material:Phosphor bronze
 Contact Plating:Au or Sn Over Ni
 Insulator Material:Polyester UL94V-0
 Standard: LCP+30%.F

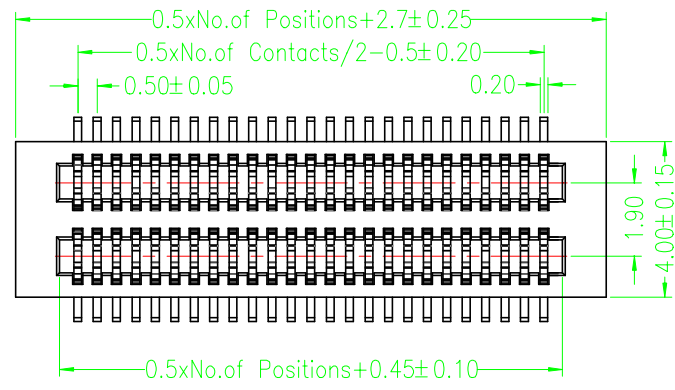

Recommended P.C.B Layout(Top Side)
 (PCB BOARD TOLERANCE± 0.05)

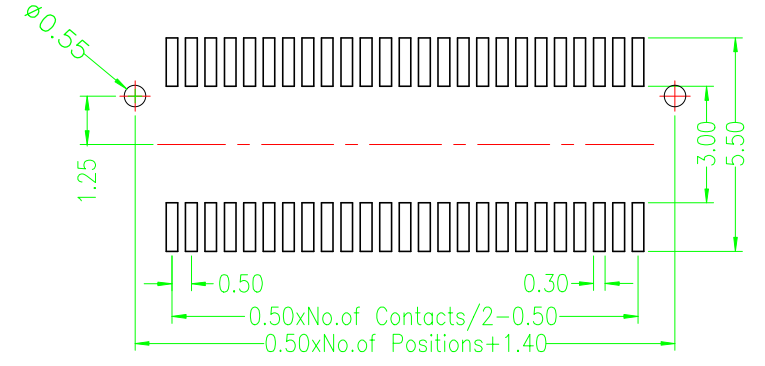

Ordering Information
W3620 - S XX XX XX 01

High No.of Pins Per Contact Plating
 Plug=H1 05~25P G0=Gold Flash
 Socket=H2 30P S0=Gold Flash/Tin
 40P
 50P

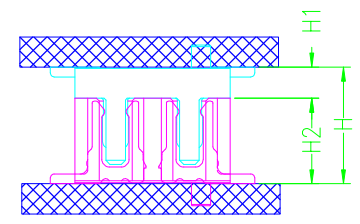
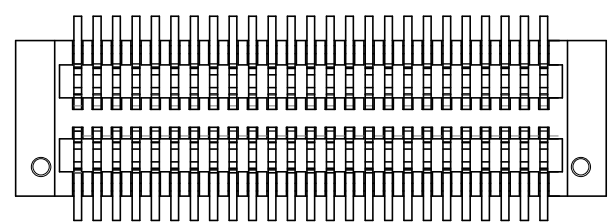
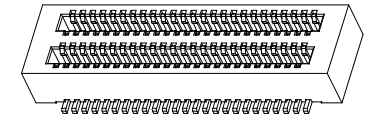
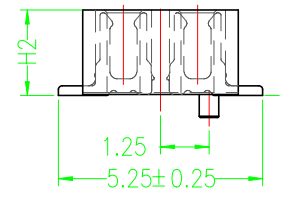
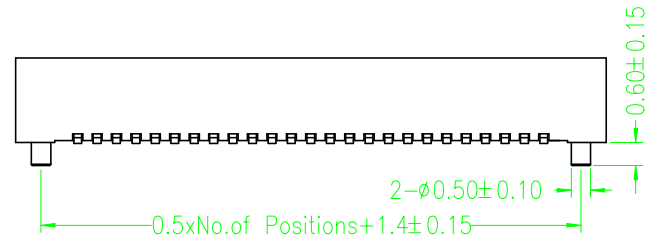

ASSEMBLY

ASS'Y HIGH(H)	PLUG(H1)	SOCKET(H2)
3.00	1.00	2.00
3.50	1.50	2.00
4.00	2.00	2.00
4.50	1.50	3.00
5.00	2.00	3.00
5.50	2.50	3.00
6.00	3.00	3.00

					OPERATION	DRAW	William Chen	09.02.14	SCALE	1:1		
					X.X ±0.20	DESIGN			UNIT	mm		
					X.XX ±0.10				SIZE	A4	PART NO.	W3620-SXXXXXXX01
A0	09/02/14	NEW			X.XXX ±0.05	CHECK			SHEET	1/1	TITLE:	0.50mm BO TO BO SOCKET
REV	DATE	MODIFICATION DESCRIPTION	CHANGE	APPROVE	Angle ± 3° DIM TOL	APPROVE			PROJ.	Customer NO.		