

# Amphenol

## HDM Series

### Hermaphroditic Duplex Miniature



The Fibre Optic Hermaphroditic range has now developed an additional product, the Hermaphroditic Duplex. This product has been specially designed to facilitate the interconnection of Fibre Optic Cable Assemblies, thus eliminating the need for polarising the assemblies and the use of in-line adaptors.

- Lightweight, small design, outer diameter of coupling ring measures less than 22.00mm.
- Low loss ceramic PC technology in multimode and singlemode.
- Connector and monobloc environmentally sealed.
- Fully hermaphroditic wipe clean bayonet mating mechanism.
- Fully removable front receptacle shell, for cleaning whilst in situ.
- Plug backshell allows for the removal of the ferrule monobloc for ease of cleaning.
- Choice of materials and plating.
- High tension cable load capability.

Technical Information

HDM PLUG ASSEMBLY  
HDM-062-RX-XXX

SPANNER FLATS 5/8

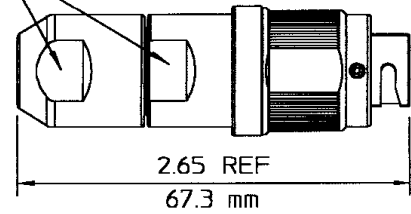

Ø0.850  
21.6 mm

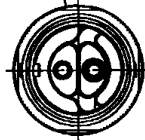

HDM MONOBLOC SUB ASSEMBLY  
HDM49-06-014

Ø0.487 MAX  
12.36mm

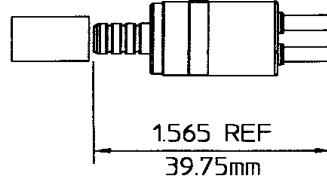

HDM IN-LINE FREE JAM NUT  
RECEPTACLE ASSEMBLY  
HDM-072-RX-014

SPANNER FLATS 5/8

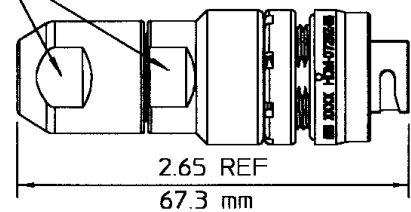

Ø0.880  
22.35mm



TO SUIT HDM-062RX-014  
AND HDM-072RX-014

HDM LOOP BACK PLUG  
HDM-062-RX-018

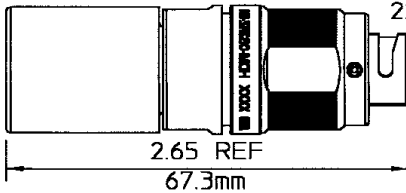

Ø0.880  
22.35mm



HDM PANEL MOUNTED JAM NUT  
RECEPTACLE ASSEMBLY  
HDM-072-RX-011

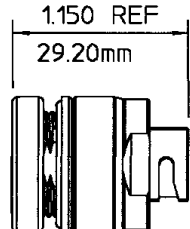

Ø0.850 TYP  
21.5 mm



HDM DUST CAP ASSEMBLY  
960-635

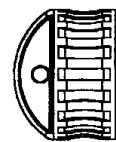

RECOMMENDED PANEL PIERCING  
FOR HDM-072-XX-XXX SCALE 1:2

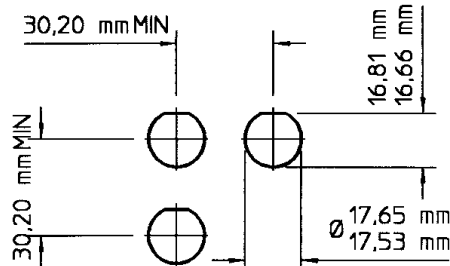

**Performance**

Optical	
Insertion loss	Typically 0.3dB using 62.5/125
Repeatability	<0.15dB
Fibre types	50/125          62.5/125
Termination method	Epoxy/polish

Environmental	
Temperature range	-55°C / +85°C cable dependant

Mechanical	
Durability	500 matings
Materials	Shell:                  Aluminium
	Ferrule:                Zirconia
	Alignment sleeve:    Ceramic
	Seals:                  Silicone

Termination Tooling	
Basic kit	927 - 100 - 3000
HDM add on	927 - 100 - 4200
Consumable pack	927 - 100 - 6000 Approximately 50 terminations

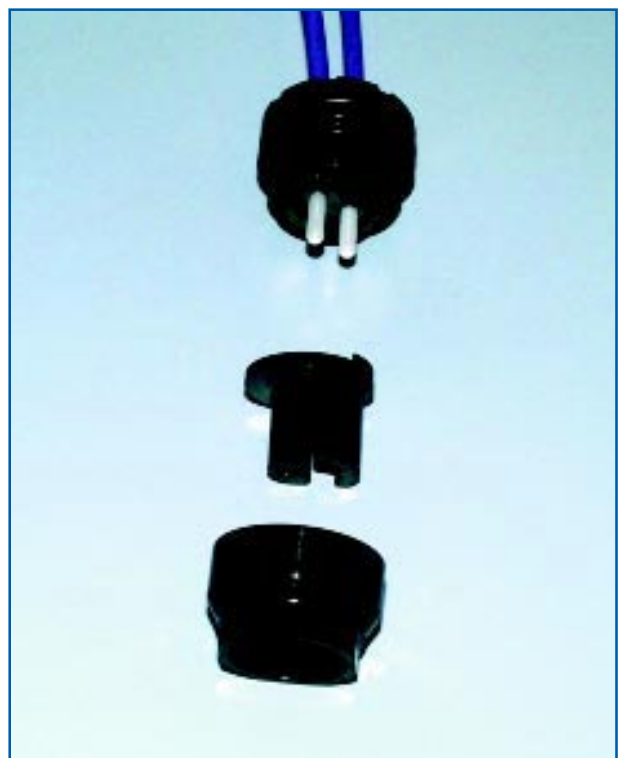
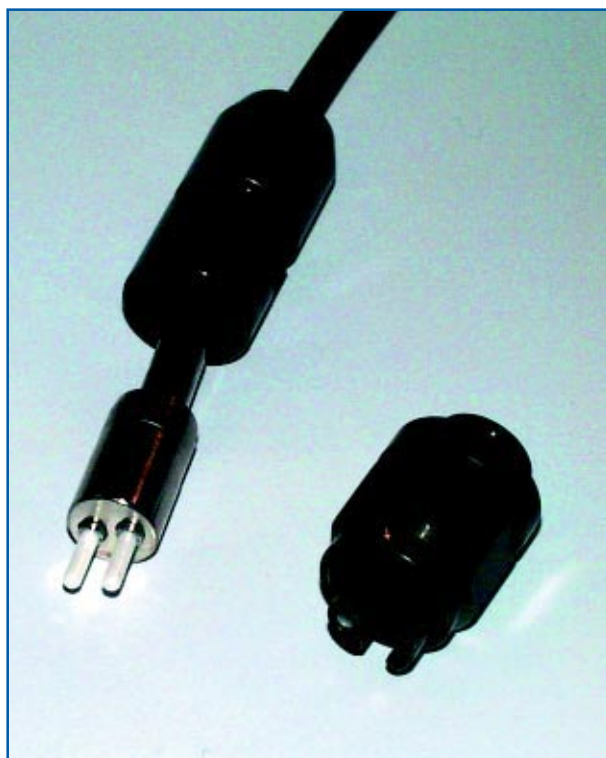

**Part Number Information**

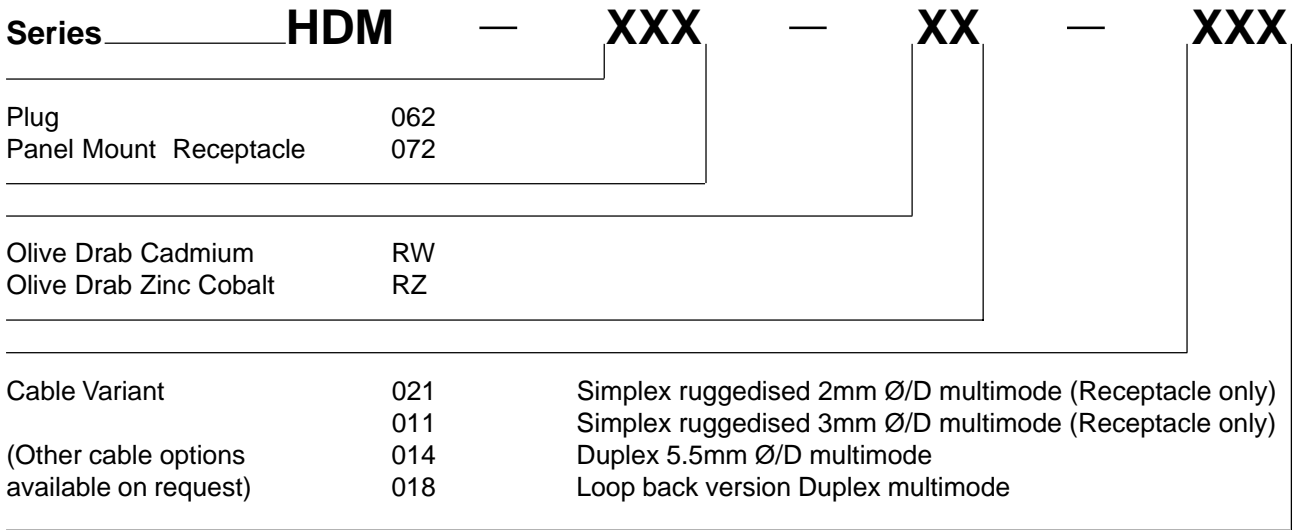

**Sub Assembly**

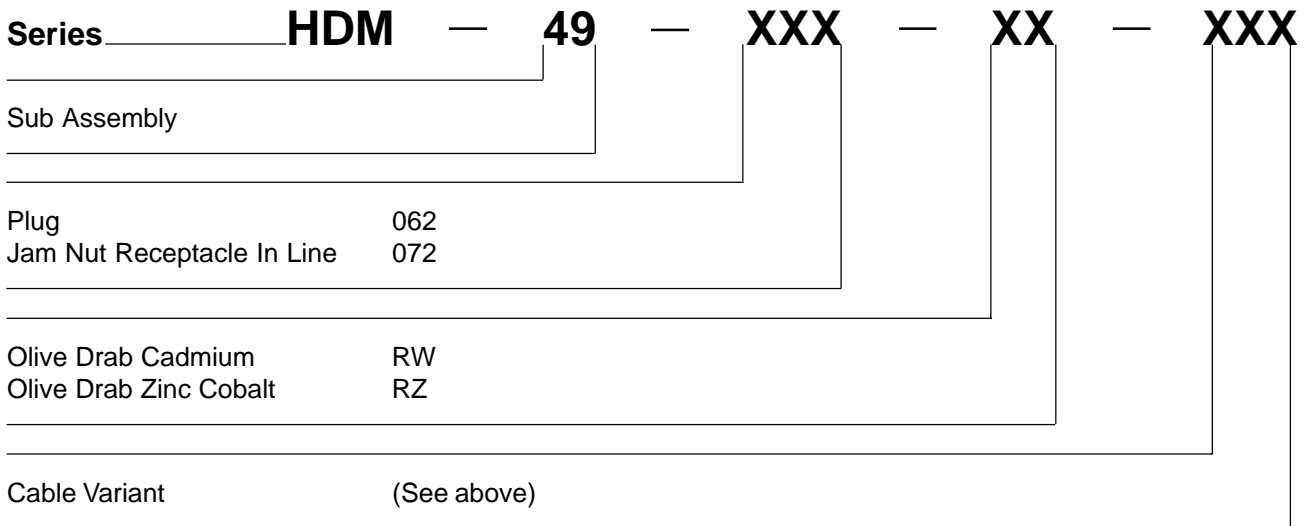

**Front Shell Sub Assembly**

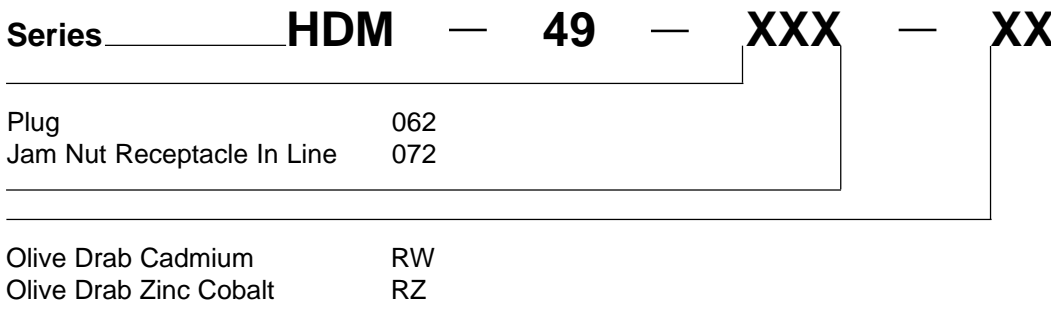

**Dust Cap** 960-635

For further information on cables, connectors and assemblies please consult your local office.  
 Product specifications and performance characteristics are typical only, and subject to change.

**Notice:** Products are sold subject to Amphenol's conditions of sale ("the standard conditions"). All specifications and statements contained herein are believed to be correct at the time of printing, but no representation or warranty, express or implied, is given as to any specification or statement contained herein. Product specifications including performance characteristics are typical only and subject to deviation. Specifications are also subject to change without notice. Users should not assume that all safety measures are indicated or that other measures may not be required. No representation or warranty, express or implied, is given that any use of products (including any stated or suggested use) does not infringe any patent, registered design or other third party rights and no stated or suggested use of products can be taken to recommend any such infringement.