

Micro Military Connectors (MMC)

With the increasing demand for data networks within confined areas, such as combat vehicles and aircraft the Micro Military Connector (MMC) range has been specifically designed to address space and weight issues, while retaining performance levels for harsh environments

Based on a bayonet coupling method these connectors can be supplied in a 3, 5 or 9 way configuration which meets most cabling requirements.



FEATURES

- Compact design
- Positive locking coupling mechanism
- Scoop proof interface
- 3, 5 and 9 contact options
- Crimp contacts (standard)
- PCB contacts (optional)

BENEFITS

- Minimum space envelope
- Suitable for sensor applications
- Assured reliability
- Weight saving
- Ease of use
- Standard tooling

QUALITY APPROVALS

- Civil Aviation Authority A8-1
- BS EN ISO 9001
- Military Spec Approvals 38999
- BS9000 and CECC
- Underwriters Laboratories

With 30 years experience in designing and manufacturing at its own facilities, Deutsch Ltd can provide interconnection solutions for the most demanding of environments

Castleham Industrial Estate
4 Stanier Road, St Leonard-On-Sea
East Sussex TN38 9RF England

Telephone +44 (0) 1424 852721
Fax +44 (0) 1424 857142

Email milaero@deutsch.co.uk
www.deutschltd.com

GENERAL SPECIFICATION

Material:	
Shell/coupling ring:	High Strength Aluminium Alloy
Plating finishes:	Olive Drab cadmium (standard) Nickel (RoSH compliant) (optional) Zinc Cobalt (optional)
Contact material:	Gold plated Copper Alloy
Contact size:	
3 contact option	Size 22 contacts
5 contact option	Size 24 contacts
9 contact option	Size 24 contacts
Contact rating:	
Size 22	5 amps max.
Size 24	3 amps max.
Cable sizes:	
Size 22	22-28 AWG
Size 24	24-30 AWG
Insulators:	Thermoplastic
Interface Seal:	Fluorinated Silicone
Temperature:	-55°C to +175°C
Sealing:	IP67
Durability:	No electrical or mechanical defects after 500 cycles of engagement or disengagement
Fluid resistance:	Connectors show no damage when exposed to most fluids used in military applications
Wire sealing:	Connector rear sealing grommet options for common size wire gauges



DEUTSCH
MILITARY & AEROSPACE LTD

INSERT ARRANGEMENTS

Shell Size 03



03-03
3#22

Shell Size 06

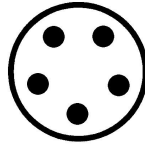

06-05
5#24

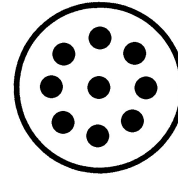

06-09
9#24

DIMENSIONAL INFORMATION

Please refer to the Deutsch Ltd MMC Dimensional Information datasheet

CONTACT AND TOOLING INFORMATION

Connector	Size	Crimp Pin	Crimp Socket	PCB Pin	Filler Plug	Insert/Extract Tool	Crimp Tool	Socket Positioner	Pin Positioner
3 Way	22	604946-31	604984	605679-31	600300-22	M81969/14-1	M22520/2-01	M22520/2-09	M22520/2-07
5 Way	24	604927-31	604935	604990-31	600300-24	M81969/14-1	M22520/2-01	605840	605839
9 Way	24	605705-31	605704	610006-31	600300-24	605837	M22520/2-01	605840	605839

CONTACT DETAIL

Contact Size	Current Rating	Cable Size AWG	Wire Sealing Range		Max Wire Conductor
			Min Ømm	Max Ømm	
22	5 Amps	22-28	0.76	1.37	0.4mm ²
24	3 Amps	24-30	0.60	0.83	0.2mm ²

PRO-CAP ORDERING INFORMATION

Connector	Receptacle Pro-cap	Plug Pro-cap
3 Way	605684-12	605687-12
5 Way	604029-12	604027-12
9 Way	604029-12	604027-12

ORDERING INFORMATION

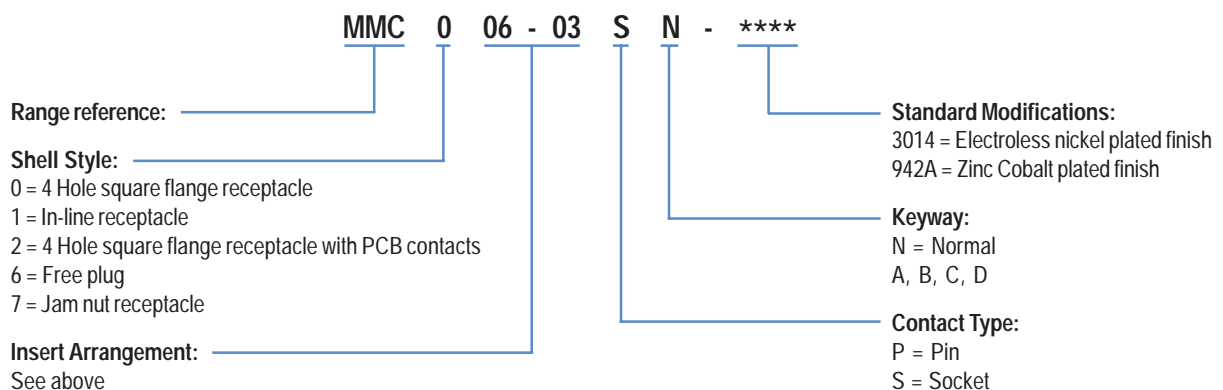

DIMENSIONAL INFORMATION - MMC

SQUARE FLANGE RECEPTACLE - SHELL SYTLE 0 & 2

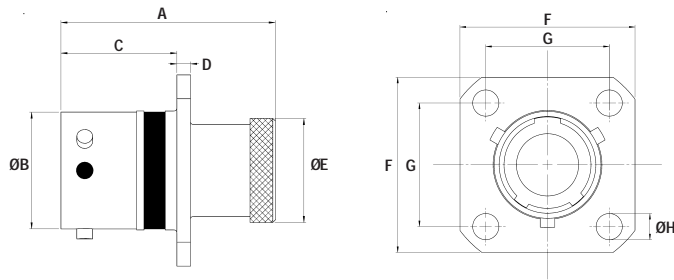

Connector	A	B	C	D	E	F	G	H
3 Way	18.0	9.0	9.0	1.3	8.0	16.2	11.5	2.7
5 Way	20.3	11.0	11.0	1.3	9.8	18.0	12.7	2.7
9 Way	20.3	11.0	11.0	1.3	9.8	18.0	12.7	2.7

Dimensions: mm

INLINE RECEPTACLE - SHELL SYTLE 1

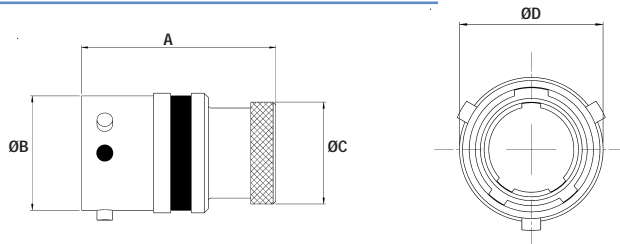

Connector	A	B	C	D
3 Way	18.0	9.0	8.0	9.0
5 Way	18.8	11.0	9.8	11.5
9 Way	20.3	11.0	9.8	11.5

Dimensions: mm

FREE PLUG - SHELL SYTLE 6

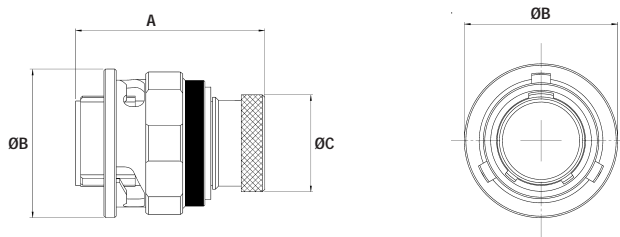

Connector	A	B	C
3 Way	17.6	12.4	8.0
5 Way	19.2	15.0	9.8
9 Way	19.4	15.0	9.8

Dimensions: mm

JAM NUT RECEPTACLE - SHELL SYTLE 7

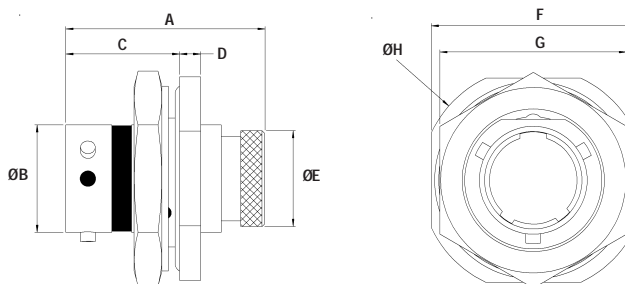

Connector	A	B	C	D	E	F	G	H
3 Way	18.0	9.0	11.5	2.2	8.0	18.8	17.0	21.0
5 Way	20.3	11.0	11.6	2.2	9.8	20.8	19.05	23.0
9 Way	20.3	11.0	11.6	2.2	9.8	20.8	19.05	23.0

Dimensions: mm

RECEPTACLE PRO-CAP

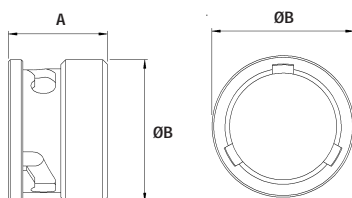

Connector	A	B
3 Way	8.6	12.4
5 Way	9.6	15.0
9 Way	9.6	15.0

Dimensions: mm

PLUG PRO-CAP

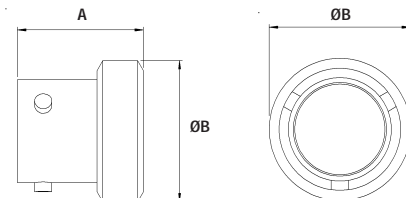

Connector	A	B
3 Way	11.0	12.4
5 Way	11.0	15.0
9 Way	11.0	15.0

Dimensions: mm