

10 9 8 7 6 5 4 3 2 1

PART NUMBER	CKT SIZE	KINK PIN LOCATION	DIM 'A'	DIM 'B'
			MM	MM
87760-0649	6	I & 5	4.00	6.00
87760-1249	I2	I & II	10.00	12.00

- NOTES:
- 1) 6 CKT SIZE SHOWN FOR ILLUSTRATION ONLY.
 - 2) PLATING --
0.38um/15u" MIN. GOLD PLATE AT CONTACT AREA AND 1.90um/75u" MIN. TIN IN SOLDER TAIL, BOTH OVER OVER 1.27um/50u" MIN. NICKEL UNDERPLATE.
 - 3) CKT I.D NUMBERS ARE SHOWN FOR KINKED LOCATION AND ARE NOT PRESENT ON MOLDED PARTS.
 - 4) PRODUCT SPECIFICATION PS-87049 APPLIES.
 - 5) MATERIAL:
HOUSING: 30% G.F PCT, 94V-0
COLOR BLACK
PIN: 0.50mm SQ. PHOSPHOR BRONZE 510

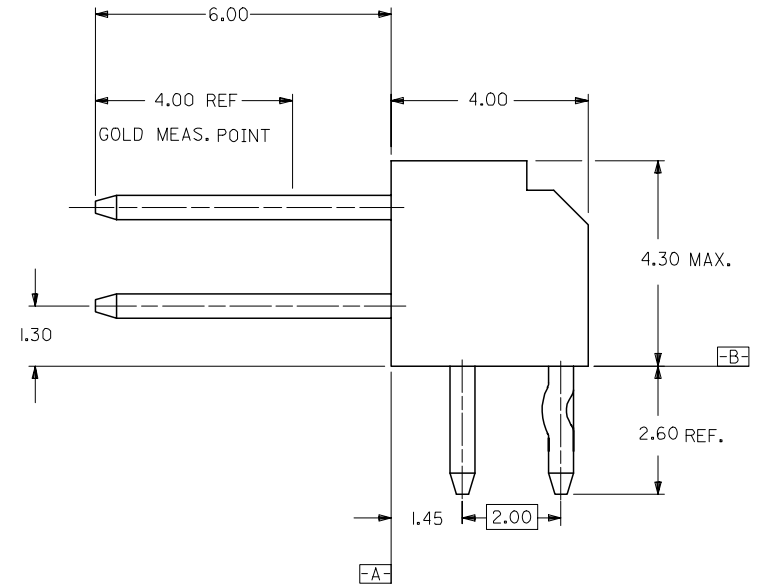
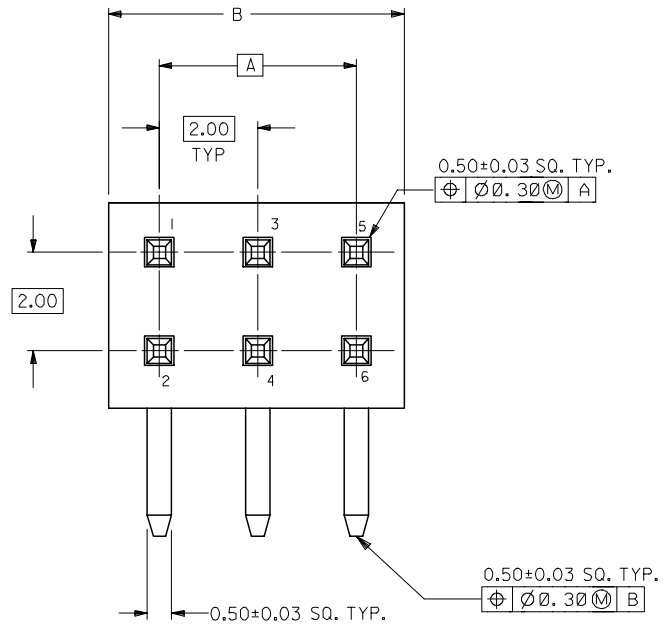
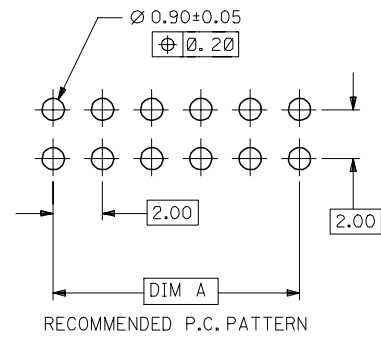

LEAD FREE CONVERSION EC NO: S2005-0183 DRAWN: KSEE CHKD: KCLING APPR: SKTOH	2004/09/07	QUALITY SYMBOLS ▽=0 ▽C=0
	2004/09/07	
	2004/09/07	
	2004/09/07	
	2004/09/07	

	GENERAL TOLERANCES (UNLESS SPECIFIED)	
	mm	INCH
4 PLACES	±---	±---
3 PLACES	±---	±---
2 PLACES	±0.20	±---
1 PLACE	±---	±---
ANGULAR ± 3°		

DIMENSION STYLE		SCALE	DESIGN UNITS	THIRD ANGLE PROJECTION
MM ONLY		NTS	METRIC	
DRAWN BY	DATE	TITLE		
KSEE	2004/08/25	SALES DRAWING		
CHECKED BY	DATE	MGRID, 2MM DUAL ROW		
KCLING	2004/09/07	HEADER WITH KINK, R/A		
APPROVED BY	DATE	MOLEX INCORPORATED		
SKTOH	2004/09/07	MOLEX INCORPORATED		
MATERIAL NO.	DOCUMENT NO.	SHEET NO.		
	SD-87760-108	1 OF 1		

DRAWN BY		DATE	TITLE	
KSEE		2004/08/25	SALES DRAWING	
CHECKED BY		DATE	MGRID, 2MM DUAL ROW	
KCLING		2004/09/07	HEADER WITH KINK, R/A	
APPROVED BY		DATE	MOLEX INCORPORATED	
SKTOH		2004/09/07	MOLEX INCORPORATED	
MATERIAL NO.	DOCUMENT NO.	SHEET NO.		
	SD-87760-108	1 OF 1		

DRAFT WHERE APPLICABLE MUST REMAIN WITHIN DIMENSIONS

SIZE A3

THIS DRAWING CONTAINS INFORMATION THAT IS PROPRIETARY TO MOLEX INCORPORATED AND SHOULD NOT BE USED WITHOUT WRITTEN PERMISSION

9 8 7 6 5 4 3 2 1