

PC card drilling dimensions (after plating)
[thickness 1.60±0.20mm]

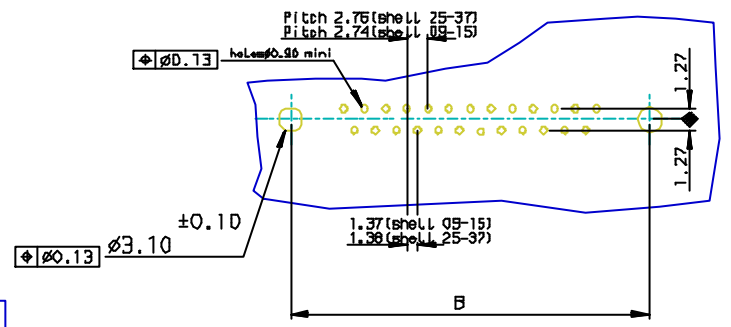

		PART NUMBER					Plating: 0.76µ AU	Plating: Flash AU
SHELL	A±0.38	B±0.12	C±0.10	D±0.25				
09	30.81	24.99	16.96	16.21	D09S13B6G*00**	D09S13B4G*00**		
15	39.14	33.32	25.18	24.54	D15S13B6G*00**	D15S13B4G*00**		
25	53.03	47.04	39.12	38.25	D25S13B6G*00**	D25S13B4G*00**		
37	69.32	63.50	55.68	54.71	D37S13B6G*00**	D37S13B4G*00**		

Threaded ØT M3 = L
Threaded ØT 4.40 = X
LF FOR LEAD FREE

REQUIREMENTS

Technical characteristics
Shell: steel tin/Zinc Cr3 plated
Insulators: self-extinguishing black polyester, UL Class 94V0
Contacts size 20: brass, gold 0.76µ on mating end, bright tin on termination end and over nickel on entire contact
Cycles: 200 for plating 4
500 for plating 6

Harpoons: phosphor bronze, tin plated
Metal plate for electrical continuity: brass, tin/Zinc Cr3 plated
Nuts: brass, tin/Zinc Cr3 plated

Electrical characteristics
max. current rating: 5A
Test voltage: 1000V
Rated voltage: 300V
Contact resistance: <15mΩ
Shell resistance: <5mΩ
Insulation resistance: >5000MΩ

Climatic characteristics
Operating temperature range: -55°C +125°C
Dimensions
In accordance with MIL-C-24308

FOR ROHS DETAILS REFER DWG. NO: C01-8646-0000

European Views

www.fciconnect.com			surface ISO 1302 ✓	tolerance std ISO 406 ISO 1101	projection mm	mm
			TOLERANCES UNLESS OTHERWISE SPECIFIED			
Dr	JOHN SLEEBA	1994/08/01	ANGULAR	L LINEAR	0.X ±0.1	size A3 Scale 1:1
Eng	GEORGE VJ	1994/08/01			0.XX ±0.1	
Chr	GEORGE VJ	2005/07/27	0.XX ±1*		0.XXX ±0.1	ECN -
Appr	KVSD	2005/07/27	Product family		D-SUB	Spec ref -
FCi			title SOCKET CONNECT. DELTA D RIGHT ANGLED WITH NUT, HARPOON & METAL PLATE		cat no C01-8646-0295	Rev. E
			DELTA-D		CUSTOMER	sheet 1 of 1



Copyright FCI.