



# SW12145W(12V33Ah)



### Specifications

Nominal Voltage	12V	
CAPACITY(15 minutes rate to 1.67V/cell)	145W	
Rated capacity (10 hour rate)	33Ah	
Dimensions	Total Height	169 mm (6.66 inches)
	Height	163 mm (6.42 inches)
	Length	196 mm (7.70 inches)
	Width	130mm (5.12 inches)
Weight Approx	12Kg (26.4lbs)	

### Characteristics

Capacity 25°C(77°F)	30min rate	524W
	15min rate	870W
	5min rate	1535W
Internal Resistance	Full charged Battery at 25°C(77°F)	5.5 mΩ
Capacity affected by Temperature (20hour rate)	40°C(104°F)	102%
	25°C(77°F)	100%
	0°C(32°F)	85%
	-15°C(5°F)	65%
Self-Discharge at 25°C(77°F)	Capacity after 3 month storage	91%
	Capacity after 6 month storage	82%
	Capacity after 12 month storage	64%
Terminal	T9、T16	
Charge (constant Voltage)	Cycle	Initial Charging Current less than 6.6A Voltage 14.10-14.40V
	Float	Voltage 13.50-13.80V

### Constant power discharge :watts(25°C, 77 °F)

	5min	10min	15min	20min	30min	45min	60min	90min
9.60V	1535	1148	890	733	547	403	316	235
10.02V	1470	1111	870	721	534	388	308	227
10.2V	1404	1069	850	703	524	383	301	219
10.5V	1340	1044	828	691	515	370	288	209
10.8V	1274	935	733	641	457	331	261	200
11.1V	1135	835	666	592	425	311	245	190

### Outer dimensions (mm)

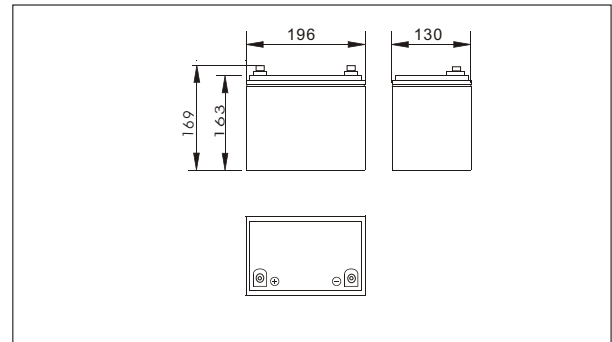

### Terminal Type (mm)

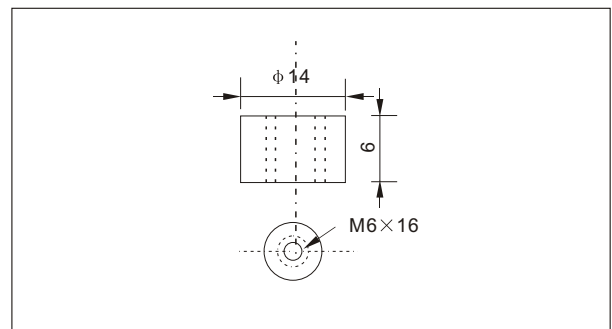

### Discharge Curves 25°C(77°F)

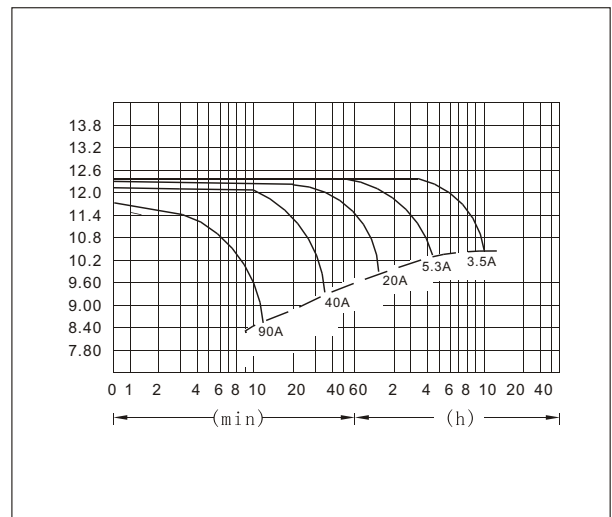

### Constant current discharge unit:A(25°C, 77 °F)

	5min	15min	30min	45min	60min	90min	5h	10h
9.60V	121.4	70.0	42.9	31.3	24.5	18.2	5.4	3.5
10.02V	115.0	67.3	41.1	29.7	23.4	17.2	5.3	3.5
10.2V	107.0	64.8	39.7	29.1	22.6	16.5	5.3	3.4
10.5V	98.9	60.6	36.9	26.7	20.6	15.5	5.2	3.3
10.8V	94.3	53.7	33.4	24.1	19.0	14.5	5.2	3.2
11.1V	82.8	49.1	31.2	22.6	17.8	13.8	5.1	3.1