

REV	DESCRIPTION	BY DATE	APPD
G	ER14665	PSM 04/01/99	Docm

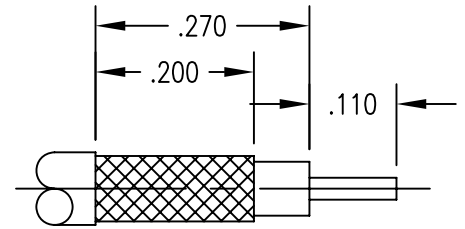
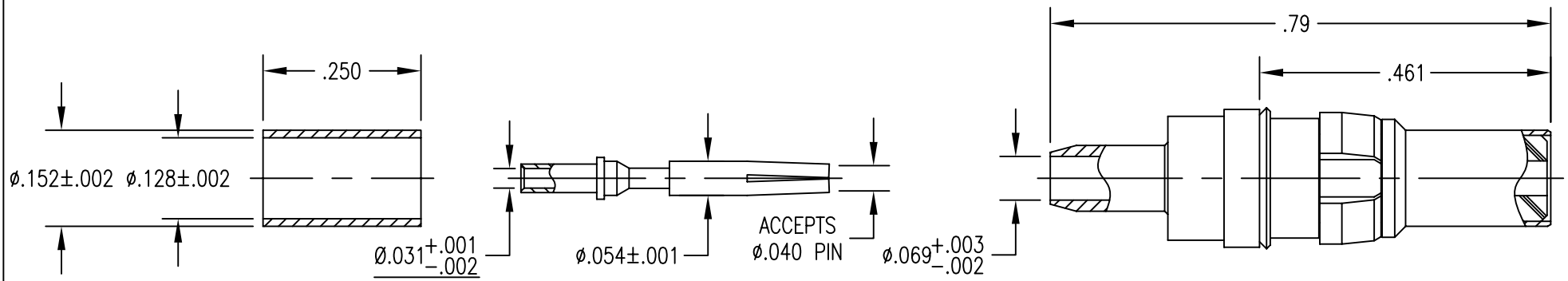

TRIMMING DIMENSIONS

NOTES:

- MATERIALS:
 BODY AND FERRULE: BRASS PER ASTM B16
 CONTACT: BERYLLIUM COPPER PER ASTM B196
 INSULATOR: TEFLON PER ASTM D1710
 SPRING WASHER: PHOSPHOR BRONZE PER ASTM B103
- FINISH:
 BODY AND FERRULE: .000030 MIN. GOLD PER MIL-G-45204
 OVER .000050 MIN. NICKEL PER QQ-N-290
 FERRULE AND SPRING WASHER: .000005 MIN. GOLD PER MIL-G-45204
 OVER .000050 MIN. NICKEL PER QQ-N-290
 CLIP RING: .000100 MIN. NICKEL PER QQ-N-290 OVER COPPER FLASH
- FOR ASSEMBLY USE CAP 9-07 WITH ABOVE TRIM DIMENSIONS.
- DESIGNED FOR USE WITH RG 316/U, 174, 188, WHITMOR W-2033-1882 AND EQUIVALENT CABLES.

PER ASME Y14.5M-1994 UNLESS OTHERWISE SPECIFIED: DIMENSIONS ARE IN INCHES OR INCHES/MILLIMETER TOLERANCES: DECIMALS .XX ± .01/0.254 .XXX ± .005/0.127 ANGLES ± 2° SCALE: 4:1		Winchester Electronics 62 Barnes Industrial Road North Wallingford, CT 06492	
CUSTOMER DRAWING		TITLE 50 OHM RDM CRIMP/CRIMP PLUG WITH CAPTIVE CENTER CONTACT	
DRAWN KJT	DATE 7/10/97	CHECKED JMC	DATE 7/10/97
APPROVED AT	DATE 7/10/97	APPROVED AT	DATE 7/10/97
A		260-910-0630G	SHT. 1 OF 1 REV. G