

IEC Appliance Connector C14 with Fuseholder 2-pole

Plug removal necessary for fuse replacement



C14



70° C

**Description**

- Panel Mount:
- Screw-on from front or rear-side
- 2 Functions:
- Inlet Protection class I, fuse-links 5 x 20 mm 1- or 2-pole
- Solder terminals 3.8 x 0.8 mm or quick connect terminals 6.3 x 0.8 mm

Characteristics

- All single elements are already wired
- With slotted screw type fuseholder
- Fuse drawer meets requirements of medical standard IEC/EN 60601-1
- The fuse drawer can only be opened with the aid of a tool
- The fuseholder is accessible from the equipment front
- IP40 (fuseholder IP65)
- Qualified for use in equipment according IEC/EN 60950

Other versions on request

- For protection class II

WeblinksApprovals: <http://www.schurter.com/approvals>RoHS: <http://www.schurter.com/rohs>**Technical Data**

Ratings IEC	10 A / 250 VAC; 50 Hz
Ratings UL/CSA	10 A / 250 VAC; 60 Hz
Dielectric Strength	> 2 kVAC between L-N > 3 kVAC between L/N-PE (1 min/50 Hz)
Allowable Operation Temp.	-25 °C to 70 °C
Degree of Protection	from front side IP 40 acc. to IEC 60529
Protection Class	Suitable for appliances with protection class I acc. to IEC 61140
Terminal	Solder terminals or quick connect terminals
Panel Thickness s	Screw-on: max 6 mm Mounting screw torque max 0.5 Nm
Material: Housing	Thermoplastic, black, UL 94V-0

Appliance-Inlet /-Outlet	C14 acc. to IEC/EN 60320-1, UL 498, CSA C22.2 no. 42 (for cold condition) pin-temperature 70 °C, 10 A, Protection class I
Fuseholder	1 or 2 pole, Shocksafe category PC2 acc. to IEC 60127-6, for fuse-links 5 x 20 mm
Rated Power Acceptance @ Ta 23 °C	5 x 20: 1.6 W (1 pole)/ 1.6 W (2-pole) per pole
Power Acceptance @ Ta > 23°C	Admissible power acceptance at higher ambient temperature see derating curves

Dimensions

Length |-----| 44 mm

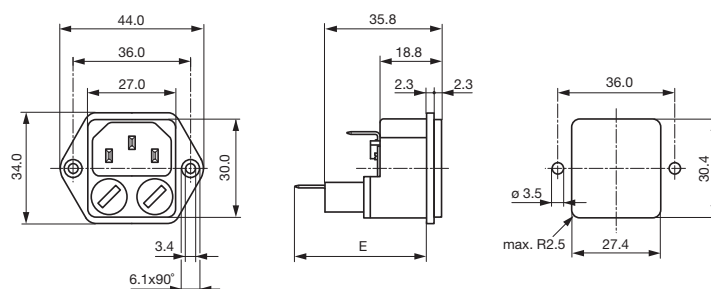

E: solder terminals = 37.6 mm

E: quick-connect terminals = 41.0 mm

Diagrams

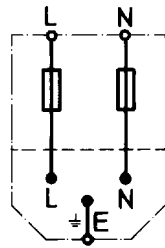
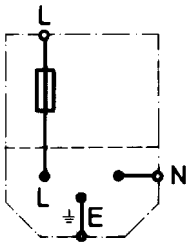

Derating curves

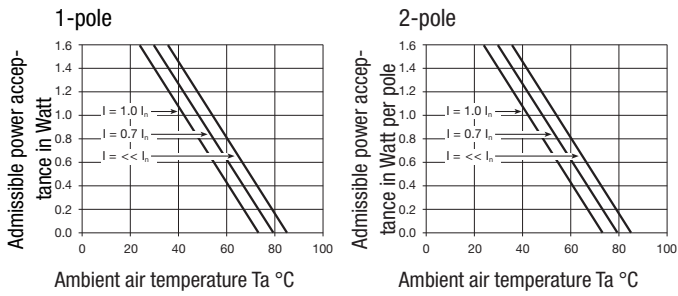

Variants

Socket and fuse-carrier

Terminal	Fuseholder	Order Number
Quick connect terminals 6.3 x 0.8 mm	1 pole	4707.1000
Solder terminals	1 pole	4707.1300
Quick connect terminals 6.3 x 0.8 mm	2-pole	4707.2000
Quick-connect terminals 4.8 x 0.8 mm	2-pole	4707.2100
Solder terminals	2-pole	4707.2300
Solder terminals or quick connect terminals	1 or 2 pole	4707.2000.03.1
Solder terminals or quick connect terminals	1 or 2 pole	4707.2000.03.2
Solder terminals or quick connect terminals	1 or 2 pole	4707.4100
Solder terminals or quick connect terminals	1 or 2 pole	4707.9100

Packaging unit 100 Pcs

Accessory

Description



Assorted Covers



Cord retaining kits