

*New Jersey Semi-Conductor Products, Inc.*

20 STERN AVE.  
 SPRINGFIELD, NEW JERSEY 07081  
 U.S.A.

TELEPHONE: (201) 376-2922  
 (212) 227-6005  
 FAX: (201) 376-8960

PARAMETERS

1N725A

REF/REG DIODE, 0W < P(D) ≤ 250MW

Description: Ref/Reg Diode, 0W < P(D) ≤ 250mW

Manufacturer.....	
Mil/High-Rel? (Y/N).....	
Nom. Ref. Volt.....	30
Test Current.....	4.0m
Tol. (%).....	5.0
PD Max. (W).....	250m
Dyn. Zmax (j).....	42
Temp Coef pp/10k.....	8.9
Oper. Temp (°C) Max.....	175
Pkg Style.....	D0-35
Surface Mounted (Y/N).....	N

2 It(rms)

D0-35

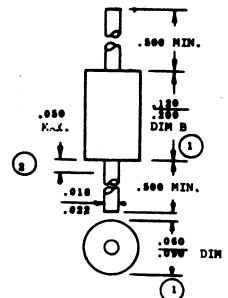

1. PACKAGE CONTOUR OPTIONAL WITHIN DIMENSIONS A & B. SLUGS, IF ANY, SHALL BE INCLUDED WITHIN THIS CYLINDER BUT SHALL NOT BE SUBJECT TO THE MINIMUM LIMIT OF DIM. 'A'.
2. LEAD DIAMETER NOT CONTROLLED IN THIS ZONE TO ALLOW FOR FLASH, LEAD FINISH BUILD-UP, AND MINOR IRREGULARITIES OTHER THAN SLUGS.



Quality Semi-Conductors