

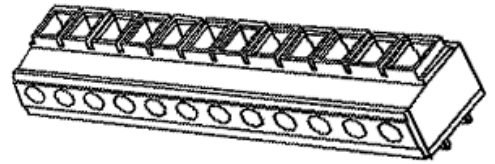

8.0 mm (.315") Pitch Beau Eurostyle® Fixed Blocks

39960
High Power



FEATURES AND SPECIFICATIONS

Features and Benefits

- Sizes 3 to 14 circuits
- High voltage
- Rising cage pressure clamp
- 130°C operating rating
- High flammability rating
- Molded to length

Electrical

Voltage: 300V
Maximum Current: 30 Amp
Insulation Resistance: >5000 Gigaohms

Mechanical

Max. Tightening Torque: 12 in. lbs, 1.36 Nm
Operating Temperature: 130°C
Wire Strip Length: 9/32" or 7mm

Physical

Insulator: Polyimide UL94V-0, Black
Screws: Steel
Screw Plating: Zinc chromate
Pressure Clamp: Brass
Pressure Clamp Plating: Nickel
Contacts: Copper Alloy
Contact Plating: Bright Tin Dip
Wire Range: 10 to 22 AWG, 4 TO 0.5mm²

Reference Information

UL : File No. E48521
Guide No. XCFR2
CSA: File No. 025562

CATALOG DRAWING (FOR REFERENCE ONLY)

RECOMMENDED PTH PATTERN

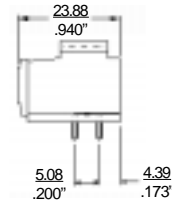
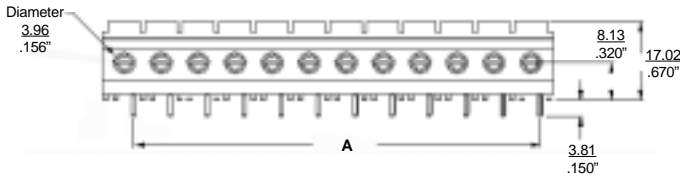
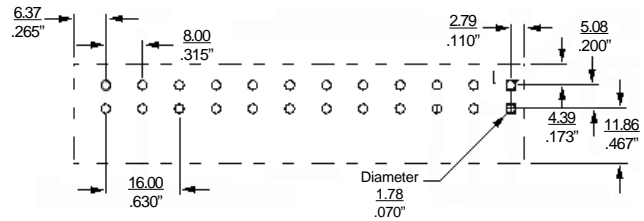
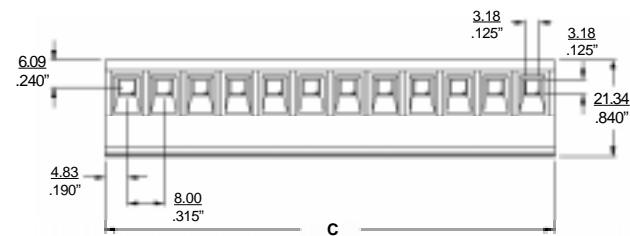

ORDERING INFORMATION AND DIMENSIONS

Part Number*		# of Circuits	A		B	
Order #	Engineering #		in	mm	in	mm
39960-0203	960803	3	.63	16.0	1.01	25.6
39960-0204	960804	4	.94	24.0	1.32	33.5
39960-0205	960805	5	1.26	32.0	1.64	41.6
39960-0206	960806	6	1.58	40.0	1.95	49.5
39960-0207	960807	7	1.89	48.0	2.27	57.6
39960-0208	960808	8	2.20	56.0	2.58	65.5
39960-0209	960809	9	2.52	64.0	2.90	73.6
39960-0210	960810	10	2.84	72.0	3.21	81.5
39960-0211	960811	11	3.15	80.0	3.53	89.6
39960-0212	960812	12	3.46	88.0	3.87	97.5
39960-0213	960813	13	3.78	96.0	4.16	105.6
39960-0214	960814	14	4.10	104.0	4.47	113.5

* Consult factory for sequential numbering and special marking