

- NOTES:
- HOUSING MATERIAL: NYLON, UL 94V-2
 - FINISH:
 - (909) OVERALL HOT TIN DIP: .000100/0.00254 MIN.
 - (122) OVERALL TIN: .000150/0.00281 MIN.
 - OVERALL NICKEL UNDERPLATE: .000030/0.00076 MIN.
 - (558) SELECT GOLD: .000030/0.00076 MIN.
 - WITH OVERALL GOLD FLASH .000002/0.00005 MIN.
 - OVERALL NICKEL UNDERPLATE: .000050/0.00127 MIN.
 - (102) OVERALL TIN: .000200/0.00508 MIN.
 - OVERALL COPPER UNDERPLATE .000100/0.00254 MIN.
 - (208) SELECT GOLD: .000015/0.00038 MIN.
 - SELECT TIN: .000100/0.00254 MIN.
 - OVERALL NICKEL UNDERPLATE: .000050/0.00127 MIN.
 - PRODUCT SPECIFICATION: PS-08-50
 - PACKAGING INFO: SEE CHARTS.
 - SOLDERABILITY SPECIFICATION: SMES-152.
 - TOP ENTRY OPTIONS: SEE DRAWING SDA-2145-002.
 - BOTTOM ENTRY OPTIONS: SEE DRAWING SDA-2145-003
 - .183/4.64 DIMENSION IS BOTTOM OF HOUSING TO CENTER OF MATING PIN AND DOES NOT REFLECT CENTER OF THE CONNECTOR HOUSING WINDOW DIMENSION.
 - THIS PART CONFORMS TO CLASS B REQUIREMENTS OF COSMETIC SPECIFICATION.

| CKT | A | B |
|-----|----------------|--------------------------|
| 02 | .308 7.82 | .156±.005 3.96±0.13 |
| 03 | .464 11.79 | .312±.005 7.92±0.13 |
| 04 | .620 15.75 | .468±.005 11.89±0.13 |
| 05 | .776 19.71 | .624±.005 15.85±0.13 |
| 06 | .932 23.67 | .780±.005 19.81±0.13 |
| 07 | 1.088 27.64 | .936±.010 23.77±0.25 |
| 08 | 1.244 31.60 | 1.092±.010 27.74±0.25 |
| 09 | 1.400 35.56 | 1.248±.010 31.70±0.25 |
| 10 | 1.556 39.52 | 1.404±.010 35.66±0.25 |
| 11 | 1.712 43.48 | 1.560±.010 39.62±0.25 |
| 12 | 1.868 47.45 | 1.716±.010 43.59±0.25 |
| 13 | 2.024 51.41 | 1.872±.010 47.55±0.25 |
| 14 | 2.180 55.37 | 2.028±.014 51.51±0.36 |
| 15 | 2.336 59.33 | 2.184±.014 55.47±0.36 |

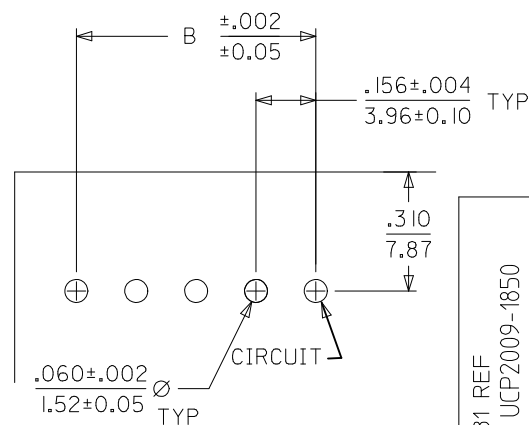

PCB LAYOUT: COMPONENT SIDE
RECOMMENDED PCB THICKNESS: .062/1.57

| | |
|--------------------------|-------------|
| ADD .31 REF | DESCRIPTION |
| EC NO: UCP2009-1850 | |
| DRWN:KSAMIEC 2009/01/27 | |
| CHKD: 2009/01/27 | |
| APPR:JCOMERCI 2009/01/27 | |
| Z | REV |

| GENERAL TOLERANCES (UNLESS SPECIFIED) | | DIMENSION STYLE | | SCALE | DESIGN UNITS | THIRD ANGLE PROJECTION | |
|---------------------------------------|--------|-----------------|------|---|--------------|------------------------|--|
| | | IN/MM | | | INCH | | |
| 4 PLACES | ± --- | mm | INCH | DRAWN BY | DATE | TITLE | |
| 3 PLACES | ± --- | | | SAMIEC | | KK 156 PCB ASSY | |
| 2 PLACES | ± 0.25 | | | CHECKED BY | DATE | RIGHT ANGLE ENTRY | |
| 1 PLACE | ± 0.38 | | | SAMIEC | | MOLEX INCORPORATED | |
| ANGULAR ±1/2° | | | | APPROVED BY | DATE | DOCUMENT NO. | |
| DRAFT WHERE APPLICABLE | | SEE CHART | | MARGULIS | | SDA-2145-001 | |
| MUST REMAIN WITHIN DIMENSIONS | | SIZE A | | THIS DRAWING CONTAINS INFORMATION THAT IS PROPRIETARY TO MOLEX INCORPORATED AND SHOULD NOT BE USED WITHOUT WRITTEN PERMISSION | | SHEET NO. 1 OF * | |



KK 156 PCB ASSY

2145 RIGHT ANGLE SERIES

OPTIONS

| | |
|--------------|---------------------|
| RAMPS | YES |
| HOOKS: | YES |
| COLOR: | WHITE |
| MOLD VOID: | NONE |
| TERM MATL: | PHOS BRONZE |
| CONTACT: | STANDARD |
| PC TAIL (C): | .145 / 3.68 |
| PLATING: | 102 - TIN |
| TERM VOID: | NONE |
| PACKAGING: | TRAY PK-2145-001 |

| | |
|--------------|---------------------|
| RAMPS | YES |
| HOOKS: | YES |
| COLOR: | WHITE |
| MOLD VOID: | NONE |
| TERM MATL: | PHOS BRONZE |
| CONTACT: | STANDARD |
| PC TAIL (C): | .145 / 3.68 |
| PLATING: | 208 - GOLD |
| TERM VOID: | NONE |
| PACKAGING: | TRAY PK-2145-001 |

| Ckts | Material No |
|------|-------------|
| 2 | 09-52-1026 |
| 3 | 09-52-1036 |
| 4 | 09-52-1046 |
| 5 | 09-52-1056 |
| 6 | 09-52-1066 |
| 7 | 09-52-1076 |
| 8 | 09-52-1086 |
| 9 | 09-52-1096 |
| 10 | 09-52-1106 |
| 11 | 09-52-1116 |
| 12 | 09-52-1126 |
| 13 | 09-52-1136 |
| 14 | 09-52-1146 |
| 15 | 09-52-1156 |

| Ckts | Material No |
|------|-------------|
| 2 | 09-62-4027 |
| 3 | 09-62-4037 |
| 4 | 09-62-4047 |
| 5 | 09-62-4057 |
| 6 | 09-62-4067 |
| 7 | 09-62-4077 |
| 8 | 09-62-4087 |
| 9 | 09-62-4097 |
| 10 | 09-62-4107 |
| 11 | 09-62-4117 |
| 12 | 09-62-4127 |
| 13 | 09-62-4137 |
| 14 | 09-62-4147 |
| 15 | 09-62-4157 |

| | | | | |
|----------------------|--------------------|------------------------|---------------|-----------------|
| REV: | 3/9/2005 SAMIEC | TITLE: | | SHEET No. |
| Y₂ | | KK 156 PCB ASSY | | - 2 - |
| DOCUMENT NUMBER: | | CREATED / REVISED BY: | CHECKED BY: | APPROVED BY: |
| SDA-2145-001 | | SAMIEC | SAMIEC | MARGULIS |



KK 156 PCB ASSY

2145 RIGHT ANGLE SERIES

| OPTIONS | RAMPS | YES | RAMPS | YES | RAMPS | YES | RAMPS | YES |
|---------|--------------|---------------------|--------------|---------------------|--------------|---------------------|--------------|---------------------|
| | HOOKS: | YES | HOOKS: | YES | HOOKS: | YES | HOOKS: | YES |
| | COLOR: | WHITE | COLOR: | WHITE | COLOR: | WHITE | COLOR: | WHITE |
| | MOLD VOID: | NONE | MOLD VOID: | NONE | MOLD VOID: | NONE | MOLD VOID: | NONE |
| | TERM MATL: | BRASS | TERM MATL: | BRASS | TERM MATL: | PHOS BRONZE | TERM MATL: | BRASS |
| | CONTACT: | STANDARD | CONTACT: | STANDARD | CONTACT: | STANDARD | CONTACT: | STANDARD |
| | PC TAIL (C): | .145 / 3.68 | PC TAIL (C): | .145 / 3.68 | PC TAIL (C): | .145 / 3.68 | PC TAIL (C): | .145 / 3.68 |
| | PLT CODE: | 102 - TIN | PLT CODE: | 122 - TIN | PLT CODE: | 558 - 30 GOLD | PLT CODE: | P909 - TIN |
| | TERM VOID: | NONE | TERM VOID: | NONE | TERM VOID: | NONE | TERM VOID: | NONE |
| | PACKAGING: | TRAY PK-2145-001 | PACKAGING: | TRAY PK-2145-001 | PACKAGING: | TRAY PK-2145-001 | PACKAGING: | TRAY PK-2145-001 |
| Ckt | Material No | | Material No | | Material No | | Material No | |
| 2 | 09-52-1021 | | 09-86-3021 | | 09-62-3025 | | 09-52-3021 | |
| 3 | 09-52-1031 | | 09-86-3031 | | 09-62-3035 | | 09-52-3031 | |
| 4 | 09-52-1041 | | 09-86-3041 | | 09-62-3045 | | 09-52-3041 | |
| 5 | 09-52-1051 | | 09-86-3051 | | 09-62-3055 | | 09-52-3051 | |
| 6 | 09-52-1061 | | 09-86-3061 | | 09-62-3065 | | 09-52-3061 | |
| 7 | 09-52-1071 | | 09-86-3071 | | 09-62-3075 | | 09-52-3071 | |
| 8 | 09-52-1081 | | 09-86-3081 | | 09-62-3085 | | 09-52-3081 | |
| 9 | 09-52-1091 | | 09-86-3091 | | 09-62-3095 | | 09-52-3091 | |
| 10 | 09-52-1101 | | 09-86-3101 | | 09-62-3105 | | 09-52-3101 | |
| 11 | 09-52-1111 | | 09-86-3111 | | 09-62-3115 | | 09-52-3111 | |
| 12 | 09-52-1121 | | 09-86-3121 | | 09-62-3125 | | 09-52-3121 | |
| 13 | 09-52-1131 | | 09-86-3131 | | 09-62-3135 | | 09-52-3131 | |
| 14 | 09-52-1141 | | 09-86-3141 | | 09-62-3145 | | 09-52-3141 | |
| 15 | 09-52-1151 | | 09-86-3151 | | 09-62-3155 | | 09-52-3151 | |

| | | | | | | | | |
|---|-------|-----|-------|-----|-------|----|-------|-----|
| <input type="checkbox"/> - <input type="checkbox"/> | RAMPS | YES | RAMPS | YES | RAMPS | NO | RAMPS | YES |
|---|-------|-----|-------|-----|-------|----|-------|-----|

| | | | |
|----------------|----------|--|------------------|
| REV: | 3/9/2005 | <u>TITLE:</u> | <u>SHEET No.</u> |
| Y ₂ | SAMIEC | KK 156 PCB ASSY 2145 RIGHT ANGLE SERIES | - 3 - |

| | | | |
|-------------------------|------------------------------|--------------------|---------------------|
| <u>DOCUMENT NUMBER:</u> | <u>CREATED / REVISED BY:</u> | <u>CHECKED BY:</u> | <u>APPROVED BY:</u> |
| SDA-2145-001 | SAMIEC | SAMIEC | MARGULIS |



KK 156 PCB ASSY

2145 RIGHT ANGLE SERIES

| | HOOKS: | YES | HOOKS: | YES | HOOKS: | YES | HOOKS: | YES |
|-----|--------------|---------------------|--------------|---------------------|--------------|---------------------|--------------|---------------------|
| | COLOR: | BLACK | COLOR: | WHITE | COLOR: | WHITE | COLOR: | WHITE |
| | MOLD VOID: | NONE | MOLD VOID: | NONE | MOLD VOID: | NONE | MOLD VOID: | NONE |
| | TERM MATL: | BRASS | TERM MATL: | BRASS | TERM MATL: | BRASS | TERM MATL: | BRASS |
| | CONTACT: | STANDARD | CONTACT: | STANDARD | CONTACT: | STANDARD | CONTACT: | LOW INSERTION |
| | PC TAIL (C): | .145 / 3.68 | PC TAIL (C): | .145 / 3.68 | PC TAIL (C): | .145 / 3.68 | PC TAIL (C): | .145 / 3.68 |
| | PLT CODE: | P909 – TIN | PLT CODE: | 208 – 15 GOLD | PLT CODE: | P909 – TIN | PLT CODE: | P909 – TIN |
| | TERM VOID: | NONE | TERM VOID: | NONE | TERM VOID: | NONE | TERM VOID: | NONE |
| | PACKAGING: | TRAY PK-2145-001 | PACKAGING: | TRAY PK-2145-001 | PACKAGING: | TRAY PK-2145-001 | PACKAGING: | TRAY PK-2145-001 |
| Ckt | Material No | | Material No | | Material No | | Material No | |
| 2 | 09-53-3021 | | 09-62-3021 | | | | | |
| 3 | 09-53-3031 | | 09-62-3031 | | | | 09-52-3035 | |
| 4 | 09-53-3041 | | 09-62-3041 | | | | 09-52-3045 | |
| 5 | 09-53-3051 | | 09-62-3051 | | | | 09-52-3055 | |
| 6 | 09-53-3061 | | 09-62-3061 | | | | 09-52-3065 | |
| 7 | 09-53-3071 | | 09-62-3071 | | | | | |
| 8 | 09-53-3081 | | 09-62-3081 | | | | 09-52-3085 | |
| 9 | 09-53-3091 | | 09-62-3091 | | 09-52-2097 | | 09-52-3095 | |
| 10 | 09-53-3101 | | 09-62-3101 | | | | 09-52-3105 | |
| 11 | 09-53-3111 | | 09-62-3111 | | | | | |
| 12 | 09-53-3121 | | 09-62-3121 | | | | 09-52-3125 | |
| 13 | 09-53-3131 | | 09-62-3131 | | | | | |
| 14 | 09-53-3141 | | 09-62-3141 | | | | | |
| 15 | 09-53-3151 | | 09-62-3151 | | | | 09-52-3155 | |

| | | | |
|-------------------------|------------------------------|--|---------------------|
| REV: | 3/9/2005 | <u>TITLE:</u> | <u>SHEET No.</u> |
| Y₂ | SAMIEC | KK 156 PCB ASSY 2145 RIGHT ANGLE SERIES | - 4 - |
| <u>DOCUMENT NUMBER:</u> | <u>CREATED / REVISED BY:</u> | <u>CHECKED BY:</u> | <u>APPROVED BY:</u> |
| SDA-2145-001 | SAMIEC | SAMIEC | MARGULIS |



KK 156 PCB ASSY

2145 RIGHT ANGLE SERIES

| OPTIONS | RAMPS: | YES | RAMPS: | YES | RAMPS: | YES | RAMPS: | |
|---------|--------------|---------------------|--------------|---------------------|--------------------------|---------------------|--------------|--|
| | HOOKS: | YES | HOOKS: | YES | HOOKS: | YES | HOOKS: | |
| | COLOR: | WHITE | COLOR: | WHITE | COLOR: | WHITE | COLOR: | |
| | MOLD VOID: | NONE | MOLD VOID: | NONE | MOLD VOID: | NONE | MOLD VOID: | |
| | TERM MATL: | PHOS BRONZE | TERM MATL: | PHOS BRONZE | TERM MATL: | PHOS BRONZE | TERM MATL: | |
| | CONTACT: | STANDARD | CONTACT: | STANDARD | CONTACT: | LOW FORCE | CONTACT: | |
| | PC TAIL (C): | .145 / 3.68 | PC TAIL (C): | .145 / 3.68 | PC TAIL (C): | .145 / 3.68 | PC TAIL (C): | |
| | PLT CODE: | 122 – TIN | PLT CODE: | P909 – TIN | PLT CODE: | 102 – TIN | PLT CODE: | |
| | TERM VOID: | NONE | TERM VOID: | NONE | TERM VOID: | NONE | TERM VOID: | |
| | PACKAGING: | TRAY PK-2145-001 | PACKAGING: | TRAY PK-2145-001 | PACKAGING: | TRAY PK-2145-001 | PACKAGING: | |
| Ckt | Material No | | Material No | | Material No | | Material No | |
| 2 | | | 09-52-3028 | | 50-29-0036 | | | |
| 3 | | | 09-52-3038 | | 50-29-0037 09-52-1030 | | | |
| 4 | 09-86-3044 | | 09-52-3048 | | 50-29-0038 | | | |
| 5 | 09-86-3054 | | 09-52-3058 | | 50-29-0039 | | | |
| 6 | 09-86-3064 | | 09-52-3068 | | 09-52-1060 | | | |
| 7 | | | 09-52-3078 | | 50-29-0040 | | | |
| 8 | 09-86-3084 | | 09-52-3088 | | 09-52-1080 | | | |
| 9 | | | 09-52-3098 | | 50-29-0041 | | | |
| 10 | 09-86-3104 | | 09-52-3108 | | 09-52-1100 | | | |
| 11 | | | 09-52-3118 | | 50-29-0042 | | | |
| 12 | 09-86-3124 | | 09-52-3128 | | 09-52-1120 | | | |
| 13 | | | 09-52-3138 | | 50-29-0043 | | | |
| 14 | | | 09-52-3148 | | 09-52-1140 | | | |
| 15 | | | 09-52-3158 | | 50-29-0044 | | | |

| | | | |
|-------------------------|------------------------------|--|---------------------|
| REV: | 3/9/2005 | <u>TITLE:</u> | <u>SHEET No.</u> |
| Y₂ | SAMIEC | KK 156 PCB ASSY 2145 RIGHT ANGLE SERIES | - 5 - |
| <u>DOCUMENT NUMBER:</u> | <u>CREATED / REVISED BY:</u> | <u>CHECKED BY:</u> | <u>APPROVED BY:</u> |
| SDA-2145-001 | SAMIEC | SAMIEC | MARGULIS |

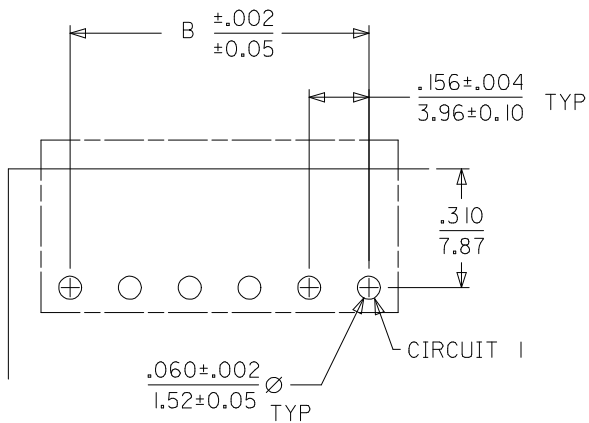
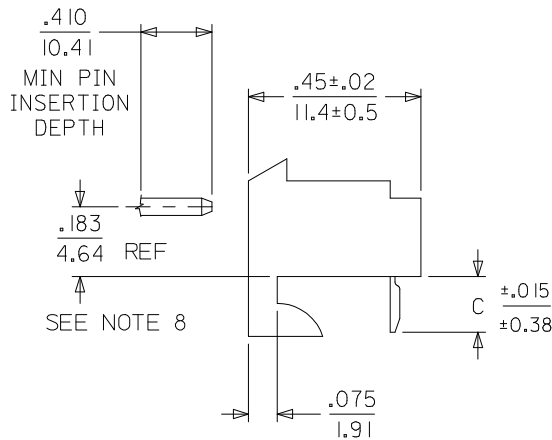
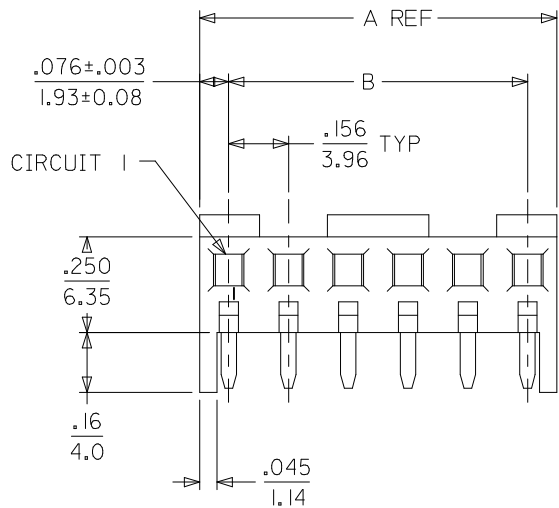

PCB LAYOUT: COMPONENT SIDE
RECOMMENDED PCB THICKNESS: .062/157

NOTES:

- HOUSING MATERIAL: NYLON, UL 94V-2
- FINISH:
(909) = OVERALL HOT TIN DIP: .000100/0.00254 MIN.
- PRODUCT SPECIFICATION: PS-08-50
- PACKAGING INFO: SEE CHARTS.
- SOLDERABILITY SPECIFICATION: SMES-152.
- TOP ENTRY OPTIONS: SEE DRAWING SDA-2145-002.
- BOTTOM ENTRY OPTIONS: SEE DRAWING SDA-2145-003
- .183/4.64 DIMENSION IS BOTTOM OF HOUSING TO CENTER OF MATING PIN AND DOES NOT REFLECT CENTER OF THE CONNECTOR HOUSING WINDOW DIMENSION.

| CKT | A | B |
|-----|----------------|--------------------------|
| 02 | .308 7.82 | .156±.005 3.96±0.13 |
| 03 | .464 11.79 | .312±.005 7.92±0.13 |
| 04 | .620 15.75 | .468±.005 11.89±0.13 |
| 05 | .776 19.71 | .624±.005 15.85±0.13 |
| 06 | .932 23.67 | .780±.005 19.81±0.13 |
| 07 | 1.088 27.64 | .936±.010 23.77±0.25 |
| 08 | 1.244 31.60 | 1.092±.010 27.74±0.25 |
| 09 | 1.400 35.56 | 1.248±.010 31.70±0.25 |
| 10 | 1.556 39.52 | 1.404±.010 35.66±0.25 |
| 11 | 1.712 43.48 | 1.560±.010 39.62±0.25 |
| 12 | 1.868 47.45 | 1.716±.010 43.59±0.25 |
| 13 | 2.024 51.41 | 1.872±.010 47.55±0.25 |
| 14 | 2.180 55.37 | 2.028±.014 51.51±0.36 |
| 15 | 2.336 59.33 | 2.184±.014 55.47±0.36 |

| | | | | | | | | | |
|---|-----------------|--|--------------|--------------------------|--|--|----------------------|------------------------|--|
| ADD NOTE 8 EC NO: UCP2006-2932 DRWN:PRIDDER 2006/06/08 CHKD:ADERR 2006/06/13 APPR:FSM:TH 2006/06/14 | QUALITY SYMBOLS | GENERAL TOLERANCES (UNLESS SPECIFIED) | | DIMENSION STYLE IN/MM | | SCALE --- | DESIGN UNITS INCH | THIRD ANGLE PROJECTION | |
| | ▼=0 | mm | INCH | DRAWN BY | DATE | TITLE KK 156 HOUSING ASSY PC TAIL RIGHT ANGLE ENTRY | | | |
| | ∇=0 | 4 PLACES ± --- | ± --- | DRATNOL | 2004/12/09 | | | | |
| | | 3 PLACES ± --- | ± .010 | CHECKED BY | DATE | MOLEX INCORPORATED | | | |
| | | 2 PLACES ± 0.25 | ± .014 | SAMIEC | 2004/12/09 | | | | |
| | 1 PLACE ± 0.36 | ± --- | APPROVED BY | DATE | DOCUMENT NO. | | SHEET NO. | | |
| | | ANGULAR ±1/2° | MATERIAL NO. | 50-29-1880 | SDA-2145-004 | | 1 OF 2 | | |
| A1 | REV | DRAFT WHERE APPLICABLE MUST REMAIN WITHIN DIMENSIONS | | SIZE A | THIS DRAWING CONTAINS INFORMATION THAT IS PROPRIETARY TO MOLEX INCORPORATED AND SHOULD NOT BE USED WITHOUT WRITTEN PERMISSION | | | | |



KK 156 PCB ASSY

2145 RIGHT ANGLE SERIES

CUSTOM PRODUCTS

| | | | | | | | | |
|---------|--------------|---------------------|--------------|-----------------|--------------|-----------------|--------------|-----------------|
| OPTIONS | RAMPS | YES | RAMPS | | RAMPS | | RAMPS | |
| | HOOKS: | YES | HOOKS: | | HOOKS: | | HOOKS: | |
| | COLOR: | WHITE | COLOR: | | COLOR: | | COLOR: | |
| | MOLD VOID: | NONE | MOLD VOID: | | MOLD VOID: | | MOLD VOID: | |
| | TERM MATL: | BRASS | TERM MATL: | | TERM MATL: | | TERM MATL: | |
| | CONTACT: | STANDARD | CONTACT: | | CONTACT: | | CONTACT: | |
| | PC TAIL (C): | .145 / 3.68 | PC TAIL (C): | | PC TAIL (C): | | PC TAIL (C): | |
| | PLT CODE: | P909 – TIN | PLT CODE: | | PLT CODE: | | PLT CODE: | |
| | TERM VOID: | NONE | TERM VOID: | | TERM VOID: | | TERM VOID: | |
| | PACKAGING: | TRAY PK-2145-001 | PACKAGING: | | PACKAGING: | | PACKAGING: | |
| Ckt | Material No. | Engineering No. | Material No. | Engineering No. | Material No. | Engineering No. | Material No. | Engineering No. |
| 2 | | | | | | | | |
| 3 | | | | | | | | |
| 4 | | | | | | | | |
| 5 | | | | | | | | |
| 6 | | | | | | | | |
| 7 | | | | | | | | |
| 8 | | | | | | | | |
| 9 | | | | | | | | |
| 10 | | | | | | | | |
| 11 | | | | | | | | |
| 12 | 50-29-1880 | A-2145-AA12A-P909 | | | | | | |
| 13 | | | | | | | | |
| 14 | | | | | | | | |
| 15 | | | | | | | | |

| | | | |
|-------------------------|---------------------|--|---|
| REV: | | <u>TITLE:</u> <h2 style="margin: 0;">KK 156 PCB ASSY</h2> <h3 style="margin: 0;">2145 RIGHT ANGLE SERIES</h3> | <u>SHEET No.</u> <h2 style="margin: 0;">- 2 -</h2> |
| <u>DOCUMENT NUMBER:</u> | SDA-2145-004 | <u>CREATED / REVISED BY:</u> | DRATNOL 12/09/2004 |
| | | <u>CHECKED BY:</u> | SAMIEC 12/09/2004 |
| | | <u>APPROVED BY:</u> | MARGULIS 12/09/2004 |