

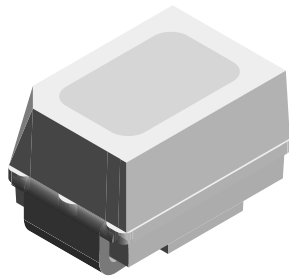

Low Current Mini SMD LED



19226

FEATURES

- SMD LEDs with exceptional brightness
- Luminous intensity categorized
- Compatible with automatic placement equipment
- Available in 8 mm tape
- Low profile package
- Non-diffused lens: excellent for coupling to light pipes and backlighting
- Low power consumption
- IR reflow soldering according to J-STD-020
- Luminous intensity ratio in one packing unit $I_{Vmax}/I_{Vmin} \leq 2.0$, optional ≤ 1.6
- Preconditioning: acc. to JEDEC level 2a
- ESD-withstand voltage: up to 2 kV according to JESD22-A114-B
- Compliant to RoHS directive 2002/95/EC and in accordance to WEEE 2002/96/EC
- AEC-Q101 qualified
- Find out more about Vishay's Automotive Grade Product requirements at: www.vishay.com/applications



DESCRIPTION

The new low current MiniLED Series have been designed in a small white SMT package. The feature of the device is the very small package 2.3 mm x 1.3 mm x 1.4 mm and the low forward current. The MiniLED is an obvious solution for small-scale, high-power products that are expected to work reliability in an arduous environment. This is often the case in automotive and industrial application.

PRODUCT GROUP AND PACKAGE DATA

- Product group: LED
- Package: SMD MiniLED
- Product series: low current
- Angle of half intensity: $\pm 60^\circ$

APPLICATIONS

- Automotive: backlighting in dashboards and switches
- Telecommunication: indicator and backlighting in telephone and fax
- Indicator and backlight for audio and video equipment
- Indicator and backlight in office equipment
- Flat backlight for LCDs, switches and symbols

** Please see document "Vishay Material Category Policy": www.vishay.com/doc?99902

PARTS TABLE		
PART	COLOR, LUMINOUS INTENSITY	TECHNOLOGY
VLMS2000-GS08	Super red, $I_V > 2.24$ mcd	AllnGaP on GaAs
VLMS20H2K1-GS08	Super red, $I_V = (3.55 \text{ to } 9)$ mcd	AllnGaP on GaAs
VLMS20J2L1-GS08	Super red, $I_V = (5.6 \text{ to } 14)$ mcd	AllnGaP on GaAs
VLMS20H2L1-GS08	Super red, $I_V = (3.55 \text{ to } 14)$ mcd	AllnGaP on GaAs
VLMO2000-GS08	Soft orange, $I_V > 4.5$ mcd	AllnGaP on GaAs
VLMO20K2L2-35-GS08	Soft orange, $I_V = (9 \text{ to } 18)$ mcd	AllnGaP on GaAs
VLMO20K2M1-GS08	Soft orange, $I_V = (9 \text{ to } 22.4)$ mcd	AllnGaP on GaAs
VLMO20J2M1-GS08	Soft orange, $I_V = (5.6 \text{ to } 22.4)$ mcd	AllnGaP on GaAs
VLMY2000-GS08	Yellow, $I_V > 3.55$ mcd	AllnGaP on GaAs
VLMY20K1L2-GS08	Yellow, $I_V = (7.1 \text{ to } 18)$ mcd	AllnGaP on GaAs
VLMY20J1L2-GS08	Yellow, $I_V = (4.5 \text{ to } 18)$ mcd	AllnGaP on GaAs
VLMK2000-GS08	Amber, $I_V > 7.1$ mcd	AllnGaP on GaAs
VLMK20J2L1-GS08	Amber, $I_V = (5.6 \text{ to } 14)$ mcd	AllnGaP on GaAs
VLMK20K1L2-GS08	Amber, $I_V = (7.1 \text{ to } 18)$ mcd	AllnGaP on GaAs
VLMK20J2L2-GS08	Amber, $I_V = (5.6 \text{ to } 18)$ mcd	AllnGaP on GaAs
VLMP20D2G1-GS08	Pure green, $I_V = (0.56 \text{ to } 2.24)$ mcd	AllnGaP on GaAs
VLMP20E2G1-GS08	Pure green, $I_V = (0.9 \text{ to } 2.24)$ mcd	AllnGaP on GaAs

ABSOLUTE MAXIMUM RATINGS ($T_{amb} = 25$ °C, unless otherwise specified) VLMS20.., VLMO20.., VLMY20., VLMK20..				
PARAMETER	TEST CONDITION	SYMBOL	VALUE	UNIT
Reverse voltage ¹⁾		V_R	5	V
DC Forward current	$T_{amb} \leq 100$ °C	I_F	15	mA
Surge forward current	$t_p \leq 10$ μ s	I_{FSM}	0.1	A
Power dissipation		P_V	40	mW
Junction temperature		T_j	125	°C
Operating temperature range		T_{amb}	- 40 to + 100	°C
Storage temperature range		T_{stg}	- 40 to + 100	°C
Thermal resistance junction/ambient	Mounted on PC board, (pad size > 5 mm ²)	R_{thJA}	580	K/W

Note:

¹⁾ Driving the LED in reverse direction is suitable for a short term application

OPTICAL AND ELECTRICAL CHARACTERISTICS ($T_{amb} = 25$ °C, unless otherwise specified) VLMS20..., SUPER RED							
PARAMETER	TEST CONDITION	PART	SYMBOL	MIN.	TYP.	MAX.	UNIT
Luminous intensity ¹⁾	$I_F = 2$ mA	VLMS2000	I_V	2.24	4.5		mcd
		VLMS20H2K1	I_V	3.55		9	mcd
		VLMS20J2L1	I_V	5.6		14	mcd
		VLMS20H2L1	I_V	3.55		14	mcd
Dominant wavelength	$I_F = 2$ mA		λ_d		630		nm
Peak wavelength	$I_F = 2$ mA		λ_p		643		nm
Angle of half intensity	$I_F = 2$ mA		ϕ		± 60		deg
Forward voltage	$I_F = 2$ mA		V_F		1.8	2.2	V
Reverse voltage	$I_R = 10$ μ A		V_R	5			V
Junction capacitance	$V_R = 0, f = 1$ MHz		C_j		15		pF

Note:

¹⁾ In one packing unit $I_{Vmax}/I_{Vmin} \leq 2.0$



OPTICAL AND ELECTRICAL CHARACTERISTICS ($T_{amb} = 25\text{ }^{\circ}\text{C}$, unless otherwise specified)							
VLMO20..., SOFT ORANGE							
PARAMETER	TEST CONDITION	PART	SYMBOL	MIN.	TYP.	MAX.	UNIT
Luminous intensity ¹⁾	$I_F = 2\text{ mA}$	VLMO2000	I_V	4.5	9		mcd
		VLMO20K2L2-35	I_V	9		18	mcd
		VLMO20K2M1	I_V	9		22.4	mcd
		VLMO20J2M1	I_V	5.6		22.4	mcd
Dominant wavelength	$I_F = 2\text{ mA}$		λ_d	598	605	611	nm
Peak wavelength	$I_F = 2\text{ mA}$		λ_p		610		nm
Angle of half intensity	$I_F = 2\text{ mA}$		ϕ		± 60		deg
Forward voltage	$I_F = 2\text{ mA}$		V_F		1.8	2.2	V
Reverse voltage	$I_R = 10\text{ }\mu\text{A}$		V_R	5			V
Junction capacitance	$V_R = 0, f = 1\text{ MHz}$		C_j		15		pF

Note:

¹⁾ In one packing unit $I_{Vmax}/I_{Vmin} \leq 2.0$

OPTICAL AND ELECTRICAL CHARACTERISTICS ($T_{amb} = 25\text{ }^{\circ}\text{C}$, unless otherwise specified)							
VLMY20..., YELLOW							
PARAMETER	TEST CONDITION	SYMBOL	SYMBOL	MIN.	TYP.	MAX.	UNIT
Luminous intensity ¹⁾	$I_F = 2\text{ mA}$	VLMY2000	I_V	3.55	7.1		mcd
		VLMY20K1L2	I_V	7.1		18	mcd
		VLMY20J1L2	I_V	4.5		18	mcd
Dominant wavelength	$I_F = 2\text{ mA}$		λ_d	581	588	594	nm
Peak wavelength	$I_F = 2\text{ mA}$		λ_p		590		nm
Angle of half intensity	$I_F = 2\text{ mA}$		ϕ		± 60		deg
Forward voltage	$I_F = 2\text{ mA}$		V_F		1.8	2.2	V
Reverse voltage	$I_R = 10\text{ }\mu\text{A}$		V_R	5			V
Junction capacitance	$V_R = 0, f = 1\text{ MHz}$		C_j		15		pF

Note:

¹⁾ In one packing unit $I_{Vmax}/I_{Vmin} \leq 2.0$

OPTICAL AND ELECTRICAL CHARACTERISTICS ($T_{amb} = 25\text{ }^{\circ}\text{C}$, unless otherwise specified)							
VLMK20..., AMBER							
PARAMETER	TEST CONDITION		SYMBOL	MIN.	TYP.	MAX.	UNIT
Luminous intensity ¹⁾	$I_F = 2\text{ mA}$	VLMK2000	I_V	7.1	16		mcd
		VLMK20J2L1	I_V	5.6		14	mcd
		VLMK20K1L2	I_V	7.1		18	mcd
		VLMK20J2L2	I_V	5.6		18	mcd
Dominant wavelength	$I_F = 2\text{ mA}$		λ_d	612	622	624	nm
Peak wavelength	$I_F = 2\text{ mA}$		λ_p		615		nm
Angle of half intensity	$I_F = 2\text{ mA}$		ϕ		± 60		deg
Forward voltage	$I_F = 2\text{ mA}$		V_F		1.8	2.2	V
Reverse voltage	$I_R = 10\text{ }\mu\text{A}$		V_R	5			V
Junction capacitance	$V_R = 0, f = 1\text{ MHz}$		C_j		15		pF

Note:

¹⁾ In one packing unit $I_{Vmax}/I_{Vmin} \leq 2.0$



OPTICAL AND ELECTRICAL CHARACTERISTICS (T _{amb} = 25 °C, unless otherwise specified)							
VLMP20..., PURE GREEN							
PARAMETER	TEST CONDITION		SYMBOL	MIN.	TYP.	MAX.	UNIT
Luminous intensity ¹⁾	I _F = 2 mA	VLMP20D2G1	I _V	0.56		2.24	mcd
		VLMP20E2G1	I _V	0.9		2.24	mcd
Dominant wavelength	I _F = 2 mA		λ _d	555		565	nm
Peak wavelength	I _F = 2 mA		λ _p		565		nm
Angle of half intensity	I _F = 2 mA		φ		± 60		deg
Forward voltage	I _F = 2 mA		V _F		1.8	2.2	V
Reverse voltage	I _R = 10 μA		V _R	5			V
Junction capacitance	V _R = 0, f = 1 MHz		C _j		15		pF

Note:

¹⁾ In one packing unit I_{Vmax}/I_{Vmin} ≤ 2.0

COLOR CLASSIFICATION								
GROUP	DOMINANT WAVELENGTH (nm)							
	SOFT ORANGE		YELLOW		AMBER		PURE GREEN	
	MIN.	MAX.	MIN.	MAX.	MIN.	MAX.	MIN.	MAX.
0							555	559
1	598	601	581	584			558	561
2	600	603	583	586			560	563
3	602	605	585	588			562	565
4	604	607	587	590				
5	606	609	589	592				
6	608	611	591	594				
7					610	613		
8					612	616		
9					615	620		
10					619	624		

Note:

Wavelengths are tested at a current pulse duration of 25 ms.

LUMINOUS INTENSITY CLASSIFICATION			
GROUP	LUMINOUS INTENSITY (mcd)		
STANDARD	OPTIONAL	MIN.	MAX.
D	2	0.56	0.71
E	1	0.71	0.9
	2	0.9	1.12
F	1	1.12	1.4
	2	1.4	1.8
G	1	1.8	2.24
	2	2.24	2.8
H	1	2.8	3.55
	2	3.55	4.5
J	1	4.5	5.6
	2	5.6	7.1
K	1	7.1	9
	2	9	11.2
L	1	11.2	14
	2	14	18
M	1	18	22.4
	2	22.4	35.5
N	1	35.5	45
	2	45	56

Note:

Luminous intensity is tested at a current pulse duration of 25 ms and an accuracy of ± 11 %. The above type numbers represent the order groups which include only a few brightness groups. Only one group will be shipped on each reel (there will be no mixing of two groups on each reel). In order to ensure availability, single brightness groups will not be orderable. In a similar manner for colors where wavelength groups are measured and binned, single wavelength groups will be shipped on any one reel. In order to ensure availability, single wavelength groups will not be orderable.

CROSSING TABLE	
VISHAY	OSRAM
VLMS20H2K1	LSM67K-H2K1
VLMS20J2L1	LSM67K-J2L1
VLMS20H2L1	LSM67K-H2L1
VLMO20J2L1	LOM67K-J2L1
VLMO20K2M1	LOM67K-K2M1
VLMO20J2M1	LOM67K-J2M1
VLMY20J1K2	LYM67K-J1K2
VLMY20K1L2	LYM67K-K1L2
VLMY20J1L2	LYM67K-J1L2
VLMP20D2G1	LPM67K-D2G1
VLMP20E2G1	LPM67K-E2G1



TYPICAL CHARACTERISTICS ($T_{amb} = 25\text{ }^{\circ}\text{C}$, unless otherwise specified)

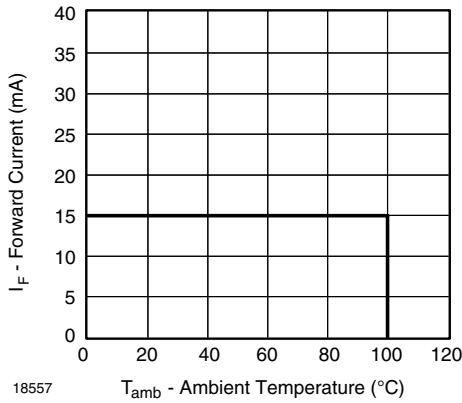

Figure 1. Forward Current vs. Ambient Temperature

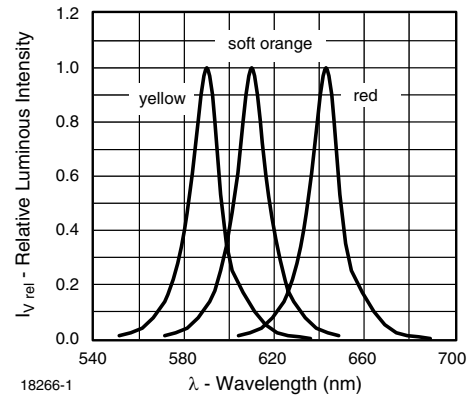

Figure 4. Relative Intensity vs. Wavelength

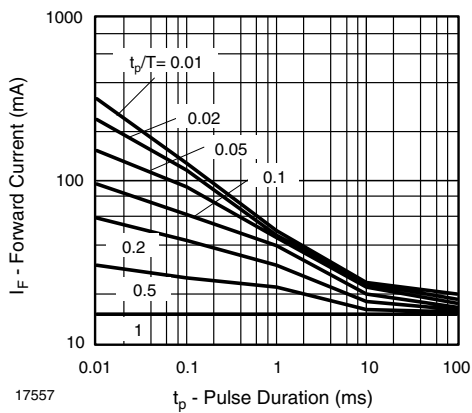

Figure 2. Forward Current vs. Pulse Length

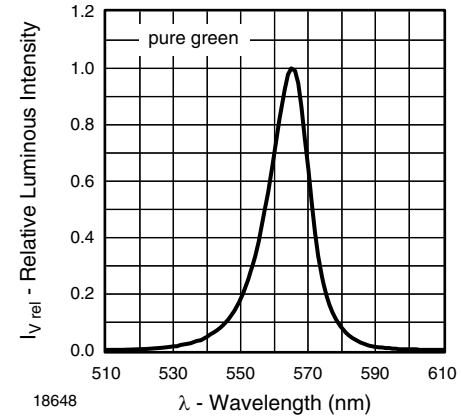

Figure 5. Relative Luminous Intensity vs. Wavelength

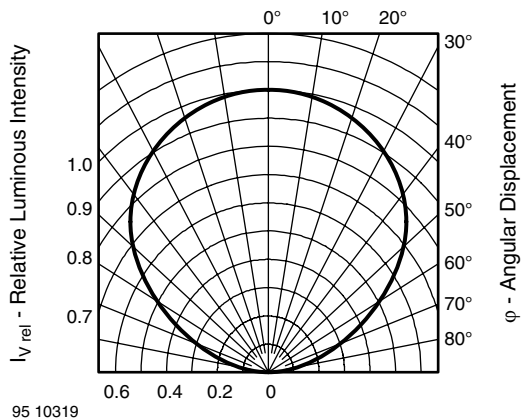

Figure 3. Rel. Luminous Intensity vs. Angular Displacement

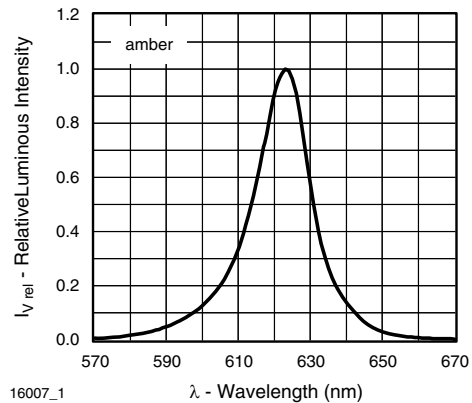

Figure 6. Relative Luminous Intensity vs. Wavelength

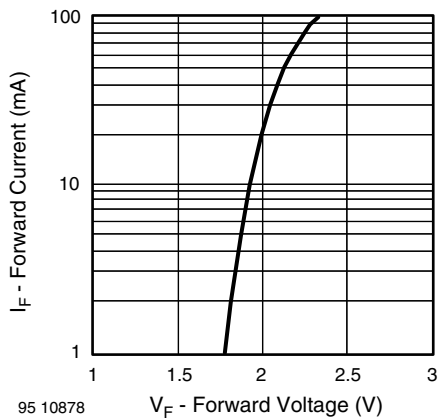

Figure 7. Forward Current vs. Forward Voltage

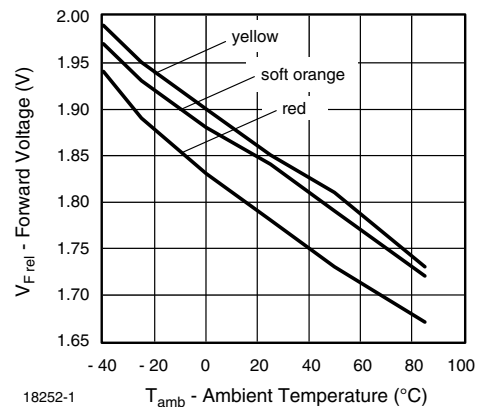

Figure 10. Forward Voltage vs. Ambient Temperature

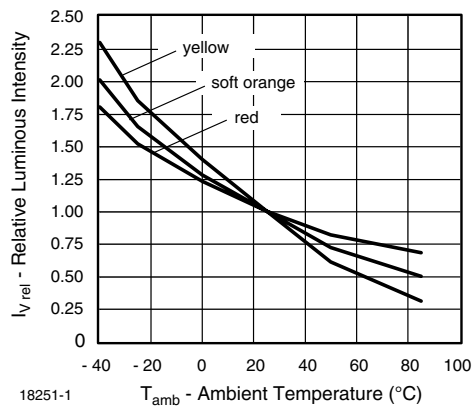

Figure 8. Rel. Luminous Intensity vs. Ambient Temperature

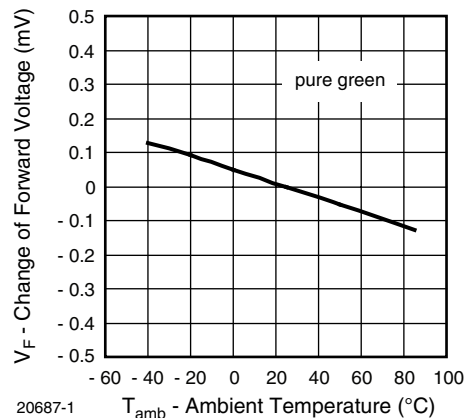

Figure 11. Change of Forward Voltage vs. Ambient Temperature

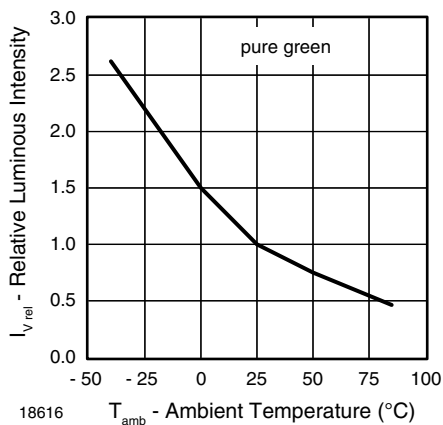

Figure 9. Rel. Luminous Intensity vs. Ambient Temperature



VLMO20.., VLMS20.., VLMY20.., VLKM20.., VLMP20..

Vishay Semiconductors

PACKAGE DIMENSIONS in millimeters

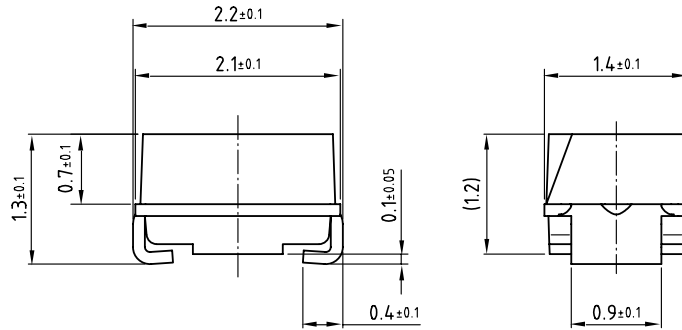

Cathode mark

Not indicated tolerances ±0.2

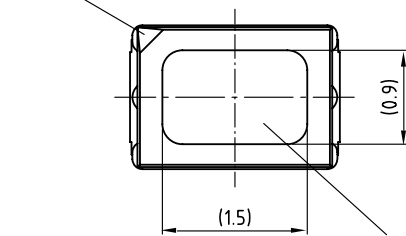

Area not flat

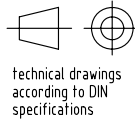
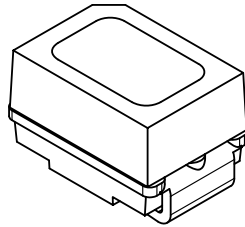

technical drawings according to DIN specifications



Solder resist

Proposed pad layout
(for reference only)

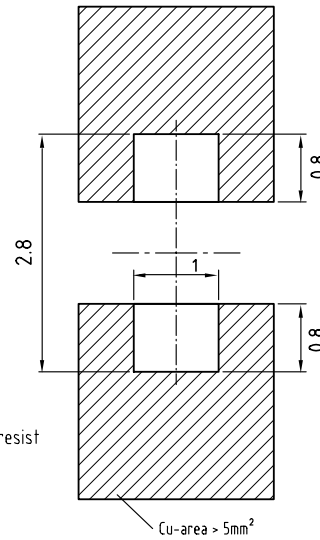

Drawing-No.: 6.541-5052.01-4
Issue: 3; 22.04.03
16892

REEL DIMENSIONS in millimeters

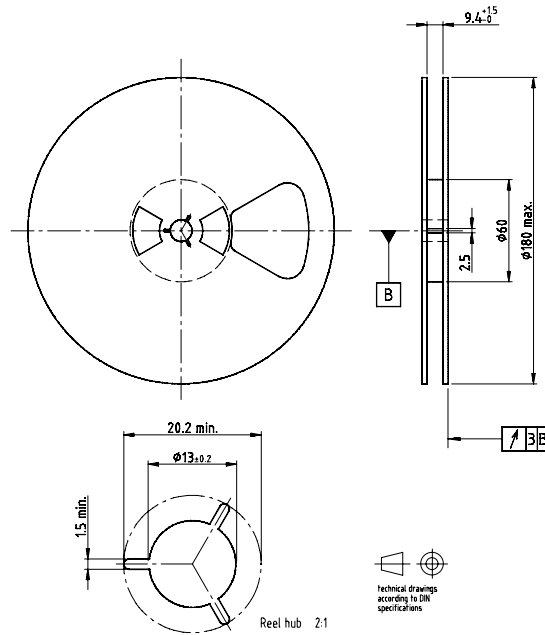

Drawing-No: 9.800-5051.VS-4
Issue: 1; 25.07.02

TAPE DIMENSIONS in millimeters

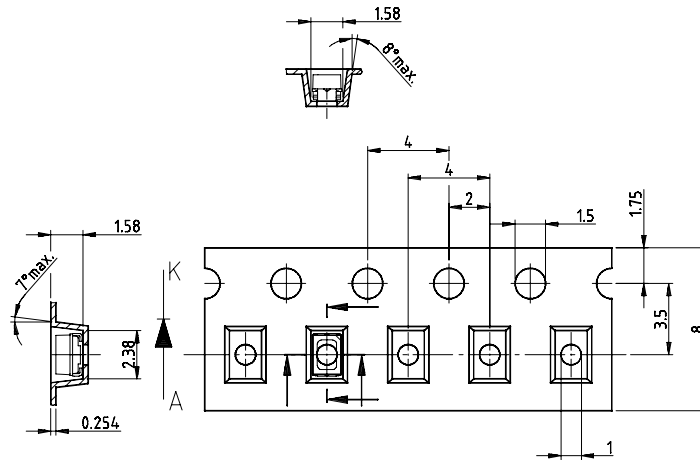

Drawing-No: 9.700-5266.01-4
Issue: 1; 05.06.02

LEADER AND TRAILER DIMENSIONS in millimeters

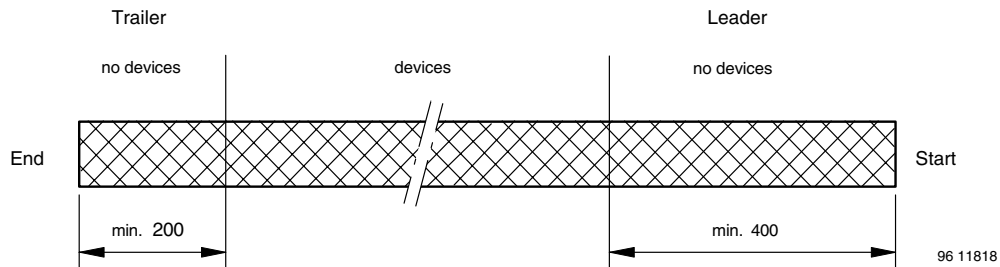

GS08 = 3000 pcs



COVER TAPE PEEL STRENGTH

According to DIN EN 60286-3
 0.1 N to 1.3 N
 300 ± 10 mm/min
 165° to 180° peel angle

LABEL

Standard bar code labels for finished goods

The standard bar code labels are product labels and used for identification of goods. The finished goods are packed in final packing area. The standard packing units are labeled with standard bar code labels before transported as finished goods to warehouses. The labels are on each packing unit and contain Vishay Semiconductor GmbH specific data.

VISHAY SEMICONDUCTOR GMBH STANDARD BAR CODE PRODUCT LABEL (finished goods)		
PLAIN WRITING	ABBREVIATION	LENGTH
Item-description	-	18
Item-number	INO	8
Selection-code	SEL	3
LOT-/serial-number	BATCH	10
Data-code	COD	3 (YWW)
Plant-code	PTC	2
Quantity	QTY	8
Accepted by:	ACC	-
Packed by:	PCK	-
Mixed code indicator	MIXED CODE	-
Origin	xxxxxxx [†]	Company Logo
LONG BAR CODE TOP	TYPE	LENGTH
Item-number	N	8
Plant-code	N	2
Sequence-number	X	3
Quantity	N	8
Total length	-	21
SHORT BAR CODE BOTTOM	TYPE	LENGTH
Selection-code	X	3
Data-code	N	3
Batch-number	X	10
Filter	-	1
Total length	-	17

SOLDERING PROFILE

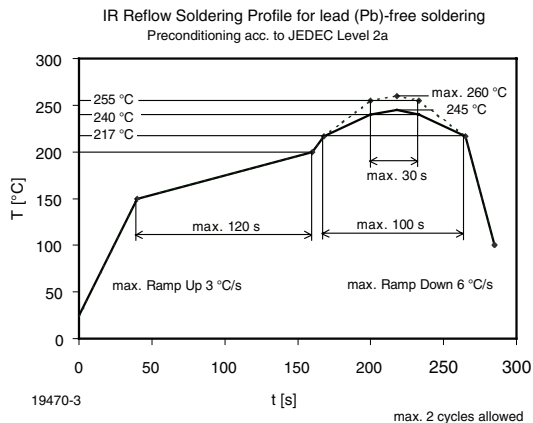
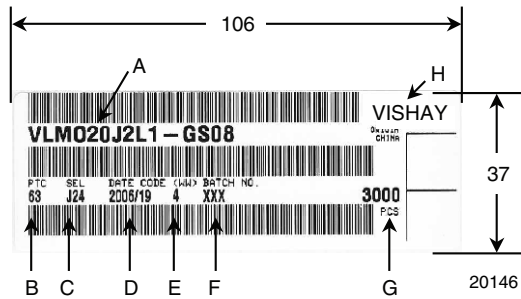

Figure 12. Vishay Lead (Pb)-free Reflow Soldering Profile (acc. to J-STD-020)

**BAR CODE PRODUCT LABEL
EXAMPLE:**



- A) Type of component
- B) Manufacturing plant
- C) SEL - selection code (bin):
e.g.: J2 = code for luminous intensity group
4 = code for color group
- D) Date code year/week
- E) Day code (e.g. 4: Thursday)
- F) Batch no.
- G) Total quantity
- H) Company code

DRY PACKING

The reel is packed in an anti-humidity bag to protect the devices from absorbing moisture during transportation and storage.

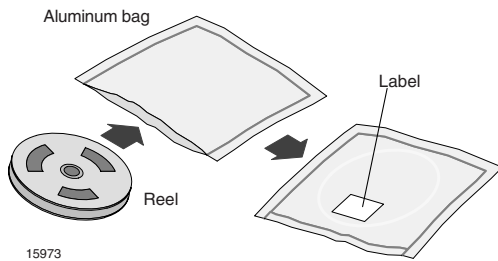

FINAL PACKING

The sealed reel is packed into a cardboard box. A secondary cardboard box is used for shipping purposes.

RECOMMENDED METHOD OF STORAGE

Dry box storage is recommended as soon as the aluminum bag has been opened to prevent moisture absorption. The following conditions should be observed, if dry boxes are not available:

- Storage temperature 10 °C to 30 °C
- Storage humidity ≤ 60 % RH max.

After more than 672 h under these conditions moisture content will be too high for reflow soldering.

In case of moisture absorption, the devices will recover to the former condition by drying under the following condition:

- 192 h at 40 °C + 5 °C/- 0 °C and < 5 % RH (dry air/nitrogen) or
- 96 h at 60 °C + 5 °C and < 5 % RH for all device containers or
- 24 h at 100 °C + 5 °C not suitable for reel or tubes.

An EIA JEDEC standard JESD22-A112 level 2a label is included on all dry bags.

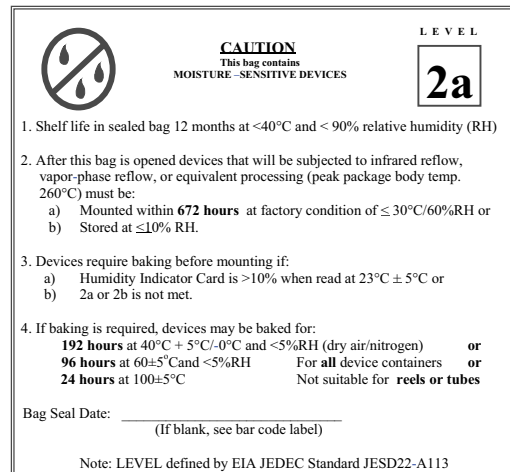

Example of JESD22-A112 level 2a label

ESD PRECAUTION

Proper storage and handling procedures should be followed to prevent ESD damage to the devices especially when they are removed from the antistatic shielding bag. Electro-static sensitive devices warning labels are on the packaging.

**VISHAY SEMICONDUCTORS STANDARD
BAR CODE LABELS**

The Vishay Semiconductors standard bar code labels are printed at final packing areas. The labels are on each packing unit and contain Vishay Semiconductors specific data.



Disclaimer

All product specifications and data are subject to change without notice.

Vishay Intertechnology, Inc., its affiliates, agents, and employees, and all persons acting on its or their behalf (collectively, "Vishay"), disclaim any and all liability for any errors, inaccuracies or incompleteness contained herein or in any other disclosure relating to any product.

Vishay disclaims any and all liability arising out of the use or application of any product described herein or of any information provided herein to the maximum extent permitted by law. The product specifications do not expand or otherwise modify Vishay's terms and conditions of purchase, including but not limited to the warranty expressed therein, which apply to these products.

No license, express or implied, by estoppel or otherwise, to any intellectual property rights is granted by this document or by any conduct of Vishay.

The products shown herein are not designed for use in medical, life-saving, or life-sustaining applications unless otherwise expressly indicated. Customers using or selling Vishay products not expressly indicated for use in such applications do so entirely at their own risk and agree to fully indemnify Vishay for any damages arising or resulting from such use or sale. Please contact authorized Vishay personnel to obtain written terms and conditions regarding products designed for such applications.

Product names and markings noted herein may be trademarks of their respective owners.