

Inside/Outside High Performance

- 0.1 - 12.4 GHz and 0.1 - 18.0 GHz units available
- Greater than 65 dB Isolation at 1KHz
- Low VSWR and Insertion loss
- Rugged Stainless Steel Construction

Midwest Microwave's high performance Inside/Outside DC Blocks pass all frequencies from 100 Mhz to 18 GHz while exhibiting low insertion loss and low VSWR. The units pose a very high insertion loss to frequencies such as 60 Hz, 120 Hz, 400 Hz, and 1 KHz. They are designed for laboratory, production line, or system use and are available in all of the popular connector interfaces. They are manufactured using rugged stainless steel and are 100 % tested to assure dependable high quality performance.

SPECIFICATIONS

Frequency: 0.1 - 12.4 GHz and 0.1 - 18.0 GHz

VSWR: 1.20 max @ 0.01 - 8.0 GHz, 1.25 max @ 8.0 - 12.4 GHz, and 1.35 max @ 12.4 - 18.0 GHz

Impedance: 50 Ohms

Insertion Loss: 0.5 dB max

Isolation: > 65 dB @ 1 KHz

DC Working Voltage: 200 Volts

Operating Temperature Range: -20 °C to +125 °C

Finish: Passivated Stainless Steel



100 MHz - 18.0 GHz	SMA Type	100 MHz - 12.4 GHz
Male / Female		Male / Female
DCB-3538-IO-SMA-02		DCB-3537-IO-SMA-02

100 MHz - 18.0 GHz	7 mm	100 MHz - 12.4 GHz
Male / Female		Male / Female
DCB-3549-IO-7MM-02		DCB-3548-IO-7MM-02

100 MHz - 18.0 GHz	N Type	100 MHz - 12.4 GHz
Male / Female		Male / Female
DCB-3525-IO-NNN-02		DCB-3524-IO-NNN-02

100 MHz - 18.0 GHz	TNC Type	100 MHz - 12.4 GHz
Male / Female		Male / Female
DCB-3535-IO-TNC-02		DCB-3534-IO-TNC-02

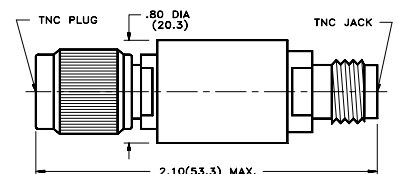
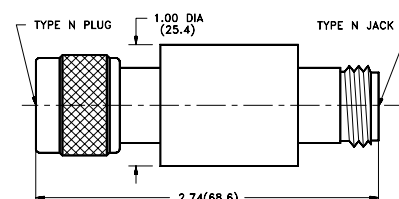
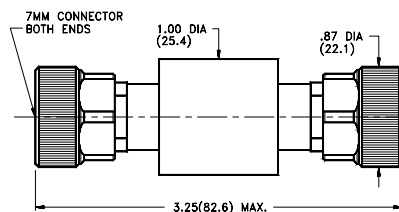
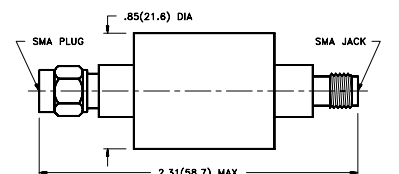

Note: BNC, SC, and HN Types are also available, please consult the factory for Model Numbers.