

Coaxial

Power Splitter/Combiner

ZFSCJ-2-4+
ZFSCJ-2-4

2 Way-180° 50Ω 50 to 1000 MHz



CASE STYLE: K18

Maximum Ratings

| | |
|-----------------------------|----------------|
| Operating Temperature | -55°C to 100°C |
| Storage Temperature | -55°C to 100°C |
| Power Input (as a splitter) | 1W max. |
| Internal Dissipation | 0.125W max. |

Coaxial Connections

| | |
|----------|---|
| SUM PORT | 3 |
| PORT 1 | 1 |
| PORT 2 | 2 |

Outline Drawing

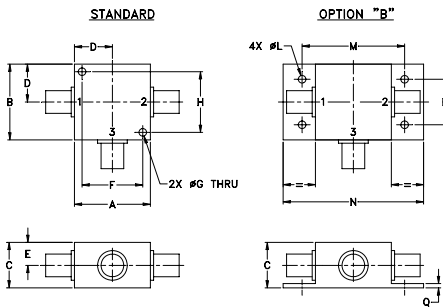

Outline Dimensions (inch/mm)

| A | B | C | D | E | F | G | H | J | K | L | M | N | P | Q | wt |
|-------|-------|-------|-------|------|-------|------|-------|----|----|------|-------|-------|-------|------|-------|
| 1.25 | 1.25 | .75 | .63 | .38 | 1.00 | .125 | 1.000 | -- | -- | .125 | 1.688 | 2.18 | .75 | .07 | grams |
| 31.75 | 31.75 | 19.05 | 16.00 | 9.65 | 25.40 | 3.18 | 25.40 | -- | -- | 3.18 | 42.88 | 55.37 | 19.05 | 1.78 | 70.0 |

Features

- low insertion loss, 1.4 dB typ.
- high isolation, 28 dB typ.
- rugged shielded case

Applications

- VHF/UHF
- cellular
- signal processing

Electrical Specifications

| FREQ. RANGE (MHz) | ISOLATION (dB) | | | | INSERTION LOSS (dB) ABOVE 3.0 dB | | | | PHASE UNBALANCE (Degrees) | | AMPLITUDE UNBALANCE (dB) | |
|--------------------------------|----------------|------|------|------|----------------------------------|------|------|------|---------------------------|------|--------------------------|------|
| | L | | U | | L | | U | | L | U | L | U |
| | Typ. | Min. | Typ. | Min. | Typ. | Max. | Typ. | Max. | Max. | Max. | Max. | Max. |
| f _L -f _U | | | | | | | | | | | | |
| 50-1000 | 30 | 20 | 25 | 18 | 1.2 | 1.9 | 1.6 | 2.4 | 6 | 7 | 0.6 | 0.6 |

L = low range [f_L to 10 f_L] U = upper range [f_U/2 to f_U]

Typical Performance Data

| Frequency (MHz) | Insertion Loss (dB) | | Amplitude Unbalance (dB) | Isolation (dB) | Phase Unbalance (deg.) | VSWR S | VSWR 1 | VSWR 2 |
|-----------------|---------------------|------|--------------------------|----------------|------------------------|--------|--------|--------|
| | S-1 | S-2 | | | | | | |
| 50.00 | 3.69 | 3.71 | 0.02 | 35.02 | 180.77 | 1.22 | 1.20 | 1.27 |
| 140.00 | 3.88 | 3.86 | 0.01 | 31.04 | 179.44 | 1.42 | 1.32 | 1.47 |
| 230.00 | 4.15 | 4.16 | 0.00 | 28.34 | 178.79 | 1.66 | 1.47 | 1.72 |
| 365.00 | 4.46 | 4.43 | 0.03 | 25.57 | 177.86 | 1.95 | 1.66 | 2.07 |
| 500.00 | 4.64 | 4.63 | 0.01 | 23.95 | 177.94 | 2.10 | 1.77 | 2.30 |
| 560.00 | 4.78 | 4.73 | 0.05 | 23.39 | 177.67 | 2.09 | 1.78 | 2.35 |
| 620.00 | 4.78 | 4.70 | 0.08 | 22.87 | 178.11 | 2.04 | 1.78 | 2.36 |
| 680.00 | 4.79 | 4.72 | 0.07 | 22.42 | 178.17 | 1.96 | 1.75 | 2.34 |
| 720.00 | 4.64 | 4.53 | 0.11 | 22.11 | 178.53 | 1.89 | 1.72 | 2.31 |
| 750.00 | 4.55 | 4.42 | 0.13 | 21.69 | 178.68 | 1.83 | 1.70 | 2.28 |
| 780.00 | 4.85 | 4.73 | 0.12 | 21.93 | 178.61 | 1.76 | 1.66 | 2.25 |
| 840.00 | 4.48 | 4.29 | 0.19 | 21.17 | 179.47 | 1.61 | 1.59 | 2.16 |
| 920.00 | 4.47 | 4.30 | 0.17 | 20.99 | 180.61 | 1.42 | 1.49 | 2.05 |
| 960.00 | 4.60 | 4.36 | 0.23 | 21.04 | 180.29 | 1.33 | 1.44 | 1.99 |
| 1000.00 | 4.59 | 4.46 | 0.13 | 21.07 | 178.64 | 1.25 | 1.39 | 1.95 |

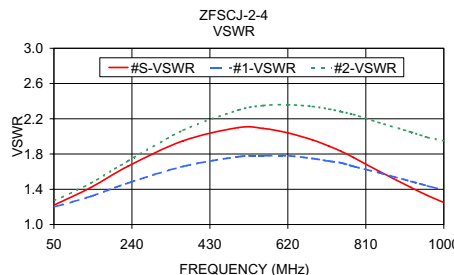
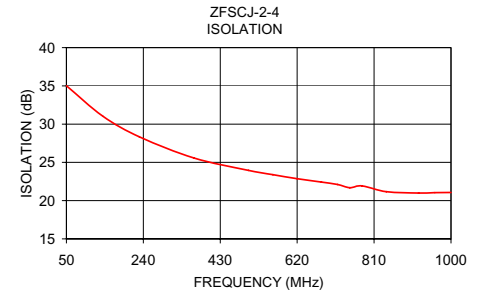
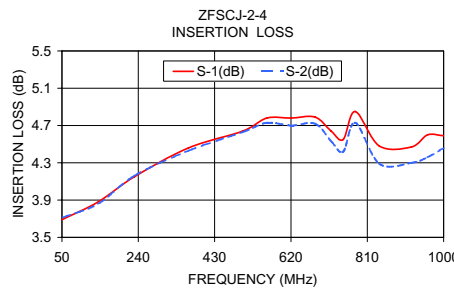

Electrical Schematic



Mini-Circuits®
ISO 9001 ISO 14001 AS9100 CERTIFIED

minicircuits.com

P.O. Box 350166, Brooklyn, New York 11235-0003 (718) 934-4500 Fax (718) 332-4661 For detailed performance specs & shopping online see Mini-Circuits web site



The Design Engineers Search Engine Provides ACTUAL Data Instantly From MINI-CIRCUITS At: www.minicircuits.com

REV. A
M120213
ZFSCJ-2-4
HY/TD/CP/AM
081105

RF/IF MICROWAVE COMPONENTS