

K5A2 Series Snap Action Key Switch



Features/Benefits

- Quiet actuation
- Space Saving
- RoHS compliant

Typical Applications

- Automotive
- Computers and network equipment

Construction

FUNCTION: Momentary action
CONTACT ARRANGEMENT: Normally open
TERMINALS: Gullwing type for SMT

Mechanical

OPERATING FORCE: (6N version) 5,5 + 0,5 -1N
3,7 + 0,8N -0,5N
OPERATING LIFE: 50,000 operations
TOTAL TRAVEL: 0.8 mm +/- 0.2 mm
ELECTRICAL TRAVEL: 0,5 mm +/- 0.1 mm

Packaging

Switches are delivered on continuous tape, in reels of 600 pieces

NOTE: Product to be offered as compatible with the lead free soldering profile on Q3 2006.

Note: Specifications listed above are for switches with standard options.
For information on specific and custom switches, consult Customer Service Center.

Electrical

POWER MIN / MAX: .02 VA / 1.0 VA
VOLTAGE MIN / MAX: 20 mV DC / 30 V DC
CURRENT MIN / MAX DC: 0.1mA / 50 mA
CONTACT RESISTANCE: ≤100m Ω
INSULATION RESISTANCE: ≤1 Ω
BOUNCE TIME: 5ms

Environmental

OPERATING TEMPERATURE: -40° C TO 85° C
STORAGE TEMPERATURE: -50° C TO 85° C

Process

SOLDERING: Lead free reflow compatible in accordance with CEI 60068-2-58

Materials

CONTACTS: Au over Ni
SOLDERING: Au
HOUSING: Thermoplastic UL 94 H-B

How To Order

Our easy build-a-switch concept allows you to mix and match options to create the switch you need. To order, select desired option from each category and place it in the appropriate box.

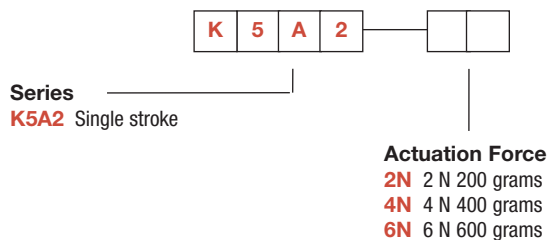

E

Key Switches

K5A2 Series Snap Action Key Switch Switch

K5A2 WITH LED

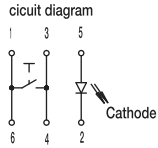
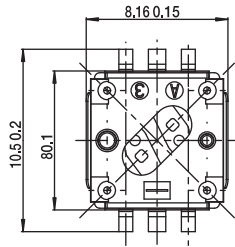

PCB LAYOUT, MOUNTING SIDE

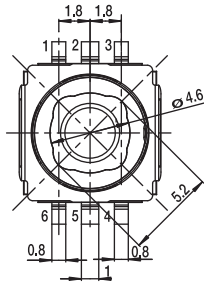
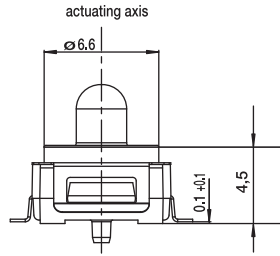
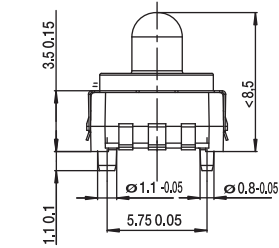
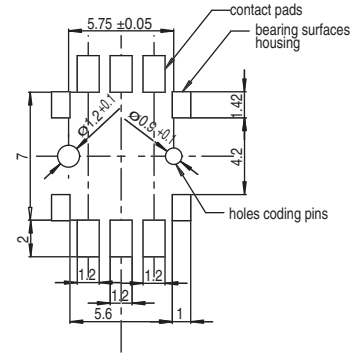

Key Switches



Dimensions are shown: mm (inch)
Specifications and dimensions subject to change

www.ittcannon.com