

FK2 / No. 162

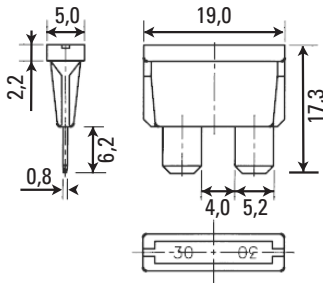

Manufactured by Pudenz 

Dimensions (mm)



UL 275A, 32V² F

Time-Current Characteristic

Quick Acting (F)

Standards

- UL 275A
- SAE J1284
- DIN 72581/3C
- ISO 8820

Approvals

UL Listed: File No. E 180223

Features

- Easy plug-in design
- Visual fault indication
- Internationally standardized
- Low internal resistance
- High temperature casing

WebLinks

Data Sheet

www.wickmann.com/products/162.pdf

Approval Certificates

www.wickmann.com/approvals

Time-Current Curve

Page 77

FaxBack Document # 402

Specifications

Packaging

100: Bulk (2000 pcs.)

Materials

- Body: Color-coded Thermoplastic, UL 94V0
- Element: Wire, visible through cover
- Cover: Transparent Thermoplastic
- Terminals: E-Cu 58 F 30 DIN 1787, gal. Sn 4 µm min., edge protected

Operating Temperature

-40°C to +85°C (consider de-rating)

Stock Conditions

+10°C to +60°C
relative humidity ≤ 75% yearly average, without dew, maximum value for 30 days - 95%

Accelerated Ageing

- 15 cycles each (UL 275A)
- 16 hrs. at 95-99% rel. humidity & 37 ±1°C
- 2 hrs. at -40 ±1°C
- 2 hrs. at 79 ±1°C
- 4 hrs. at room ambient
- Followed by 1.1, 1.35 and 2.0 x I_{Rated} tests

Marking

 , 32V, Current Rating, Date Code

Unit Weight

1.4g (approx.)

Further Details

Refer to www.pudenz.com

Limits for Pre-arcing Time

Rated Current	1.1 x I _{Rated}	1.35 x I _{Rated}	2.0 x I _{Rated}	3.5 x I _{Rated}	6.0 x I _{Rated}
500mA ... 40.00A	> 100h	750ms ... 30 min	150ms ... 5s	40ms ... 500ms	20ms ... 100ms



Permissible continuous operating current is ≤ 80% at ambient temperature of 23°C (73.4°F).

Rated Current	Amp Code	Voltage ² Rating	Breaking Capacity	Voltage Drop 1.0 x I _{Rated} max. (mV)	Melting Integral 10 x I _{Rated} (A ² s)	Color Code	Approvals
500mA ¹	0500	32V		275	0.8	blue	
1.00A	1100	32V		115	1.0	black	•
2.00A	1200	32V		120	4.7	grey	•
3.00A	1300	32V		100	9	violet	•
4.00A	1400	32V		100	19	pink	•
5.00A	1500	32V		90	32	light brown	•
7.50A	1750	32V	1000A / 32VDC	80	60	brown	•
10.00A	2100	32V		85	120	red	•
15.00A	2150	32V		85	300	light blue	•
20.00A	2200	32V		90	900	yellow	•
25.00A	2250	32V		75	900	white	•
30.00A	2300	32V		70	1200	light green	•
35.00A	2350	32V		65	2000	green	•
40.00A	2400	32V		65	3400	orange	•

¹ Not mentioned in the standards.

² Contact WICKMANN for 58V rating; Series 163.

Order Information

Qty.	Order-Number	Series	Amp Code	Packaging
		162		

FK2 / No. 162

