

Rotary Switches

10 x 10 mm Sealed Rotary DIP Switches (THR)

RD82T Series

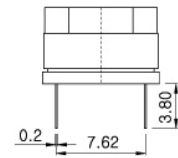
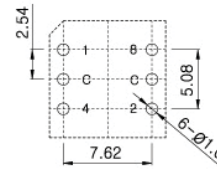
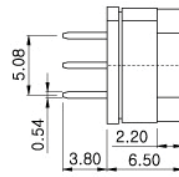
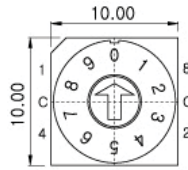

RD82THR

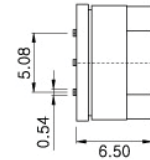
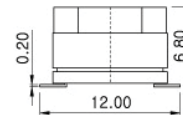
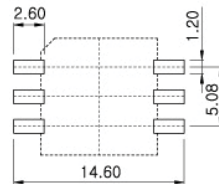
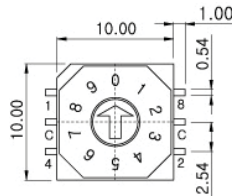

RD82TSO

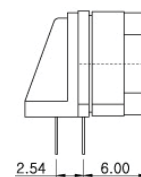
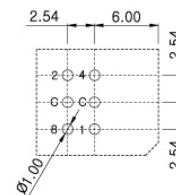
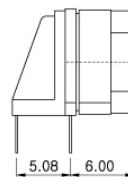
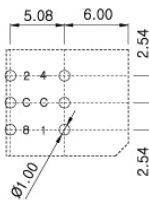
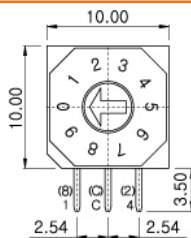

RD82TA20

ROTOR TYPE

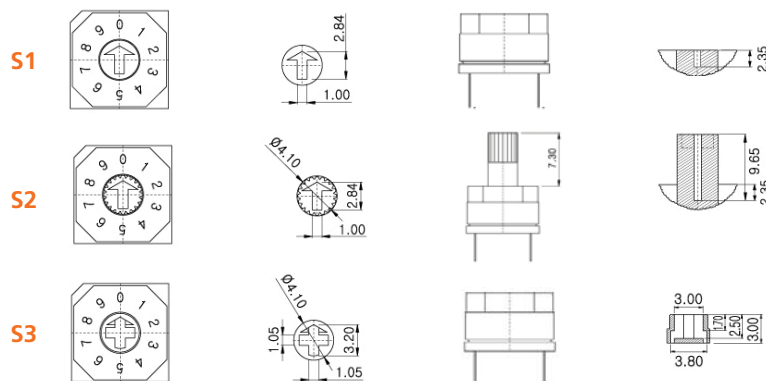

ACCESSORIES

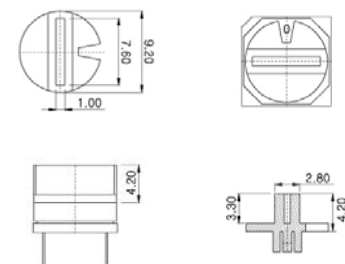

AK - 83 (applicable to only "S3" actuators)

H: Grey C: Red A: Black

How to order:

RD82T

- | | |
|--|--|
| <p>1 TYPE OF TERMINALS:</p> <p>H THT Top Adjust Type</p> <p>A1 THT Right Angle Side Adjust Type with Rows Spacing 2.54 mm</p> <p>A2 THT Right Angle Side Adjust Type with Rows Spacing 5.08 mm</p> <p>S SMT Top Type</p> <p>2 TYPE OF CASE:</p> <p>O Octagon Type</p> <p>R Round Type</p> <p>3 ROTOR TYPE (See Above Drawings):</p> <p>S1 Arrow Type</p> <p>S2 Shaft Type</p> <p>S3 Cross Type</p> | <p>4 NO. OF POSITIONS:</p> <p>04 4 Positions</p> <p>06 6 Positions</p> <p>08 8 Positions</p> <p>10 10 Positions</p> <p>16 16 Positions</p> <p>5 CODE (See Page 2):</p> <p>R Real Code</p> <p>S Complementary Code</p> <p>G Gray Code</p> <p>NR Special Code 1</p> <p>NS Special Code 2</p> <p>ND Special Code 3</p> <p>NE Special Code 4</p> <p>6 PACKAGING TYPE:</p> <p>TB Tube</p> <p>TR Tape & Reel (SMT Only)</p> |
|--|--|

General Specifications:

FEATURES

- » Sealing: IP 67(Dust & Waterproof)
- » THR (Thru Hole Reflow solderable)
- » 3 x 3 Terminal

MECHANICAL

- » Life Cycle: 10,000 steps
- » Operating Force: 700 gf max.

ELECTRICAL

- » Contact Rating: 150mA, 24V DC (Switching)
- » 400mA, 24V DC (None-Switching)
- » Contact Resistance: 80mΩ Max
- » Insulation Resistance: 100MΩ Min

SOLDERING CONDITIONS

- Solder reflow max: 10s./260°C
- Solder iron max: 2s./340°C
- Solder bath max: 5s/280°C

Rotary Switches

10 x 10 mm Sealed Rotary DIP Switches (THR)

RD82T Series

CODE

Real Code

	04 Position	Real Code					
	0	C	1	2			
	1						
	2						

	06 Position	Real Code					
	0	C	1	2	4	8	
	1						
	2						
	3						

	08 Position	Real Code					
	0	C	1	2	4	8	
	1						
	2						
	3						
	4						
	5						

	10 Position	Real Code					
	0	C	1	2	4	8	
	1						
	2						
	3						
	4						
	5						
	6						
	7						

	16 Position	Real Code					
	0	C	1	2	4	8	
	1						
	2						
	3						
	4						
	5						
	6						
	7						
	8						
	9						
	10						A
	11						B
	12						C
	13						D
14						E	
15						F	

Complementary Code

	04 Position	Complement Code			
	0	C	1	2	
	1				

	06 Position	Complement Code				
	0	C	1	2	4	8
	1					
	2					
	3					

	08 Position	Complement Code				
	0	C	1	2	4	8
	1					
	2					
	3					
	4					
	5					

	10 Position	Complement Code				
	0	C	1	2	4	8
	1					
	2					
	3					
	4					
	5					
	6					
	7					

	16 Position	Complement Code					
	0	C	1	2	4	8	
	1						
	2						
	3						
	4						
	5						
	6						
	7						
	8						
	9						
	10						A
	11						B
	12						C
	13						D
14						E	
15						F	

Gray Code

	10 Position	Gray Code				
	0	C	1	2	4	8
	1					
	2					
	3					
	4					
	5					
	6					
	7					

	16 Position	Gray Code					
	0	C	1	2	4	8	
	1						
	2						
	3						
	4						
	5						
	6						
	7						
	8						
	9						
	10						A
	11						B
	12						C
	13						D
14						E	
15						F	

Special Code

	NR	Real Code				
	0	C	1	2	4	8
	1					
	2					
	3					
	4					
	5					
	6					
	7					
	8					

	NS	Complement Code					
	0	C	1	2	4	8	
	1						
	2						
	3						
	4						
	5						
	6						
	7						
	8						
	9						
	10						A
	11						B
	12						C
	13						D
	14						E
15						F	

	ND	Dezimal				
	0	C	1	2	3	4
	1					
	2					

	NE	Real Code				
	0	C	1	2	4	8
	1					
	2					
	3					