

**DR370-2 Series Radial Leaded Inductors**

**Features**

- High Current Rating
- Height: 10.0mm Max
- Non-RoHS Versions are Available (Note 5)



**ELECTRICAL SPECIFICATIONS AT 25°C      OPERATING TEMPERATURE -55°C to +125°C**

Part Number	Inductance (μH) 1V @ 100kHz, 0Adc	DCR (mΩ) Max.	Heating Current Idc (Note 3)	Saturating Current Idc (Note 4)
DR370-2-501	0.5	0.9	35	45

**MECHANICAL SPECIFICATIONS**

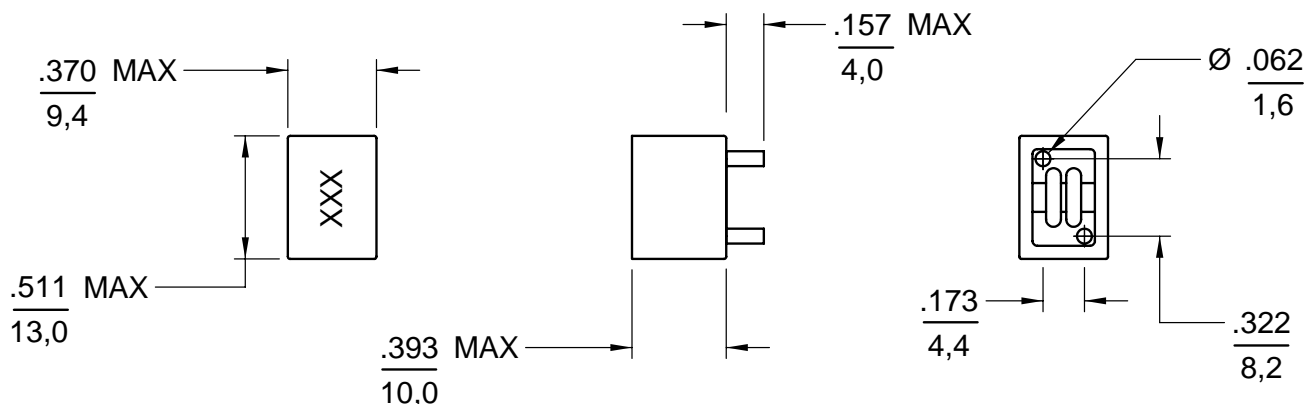

Unless otherwise specified,  
TOLERANCE: 0.020/0.5

**NOTES:**

1. Dimensions are shown in inches/millimeters
2. Inductance tolerance: ± 20%
3. DC current that will cause a rise of 40°C from ambient
4. DC current causing a 30% drop in inductance
5. For non-RoHS parts replace DR prefix with 42- (e.g. DR370-2 becomes 42-370-2)
6. Terminal finish is compliant to RoHS requirements