

This document was generated on 04/12/2010

PLEASE CHECK WWW.MOLEX.COM FOR LATEST PART INFORMATION

Part Number: [0190980024](#)
Status: **Active**
Description: Krimptite™ Snap Spade Terminal, for 18-22 AWG Wire, Stud Size 10 (M5), 17.60mm (.694") Length

Documents:

[Drawing \(PDF\)](#) [RoHS Certificate of Compliance \(PDF\)](#)

Agency Certification

CSA LR18689
 UL E32244

General

Product Family Ring and Spade Terminals
 Series [19098](#)
 Crimp Quality Equipment Yes
 Mil-Spec N/A
 Product Name Krimptite™
 Type Spade Snap

Physical

Barrel Type Closed
 Insulation None
 Material - Plating Mating Tin
 Packaging Type Bag
 Stud Size 10 (M5)
 Wire Size AWG 18, 20, 22
 Wire Size mm² 0.35 - 0.80

Material Info

Old Part Number AA-1715-10

Reference - Drawing Numbers

Sales Drawing AACD10503

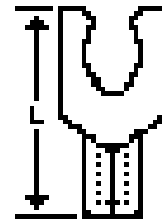

Series
 image - Reference only

EU RoHS

ELV and RoHS Compliant
REACH SVHC Contains SVHC: No
Halogen-Free Status

China RoHS



Halogen-Free

Need more information on product environmental compliance?

Email productcompliance@molex.com
 For a multiple part number RoHS Certificate of Compliance, [click here](#)

Please visit the [Contact Us](#) section for any non-product compliance questions.

Search Parts in this Series

[19098Series](#)

Application Tooling | [FAQ](#)

Tooling specifications and manuals are found by selecting the products below. Crimp Height Specifications are then contained in the Application Tooling Specification document.

Global

Description	Product #
Hand Crimp Tool	0640030100
Crimp Head for the AT-200™ Pneumatic Hand Tool	0640070100

This document was generated on 04/12/2010

PLEASE CHECK WWW.MOLEX.COM FOR LATEST PART INFORMATION

NOTES:

① MAT'L: COPPER, STOCK TKN. .028 ±.001
 PLATING: ELECTRO-TIN (.0003 MIN.) - .000

② "UL" LISTING # E32244
 "CSA" LISTING # 186R9

FILE NO. AA-CD-105-03

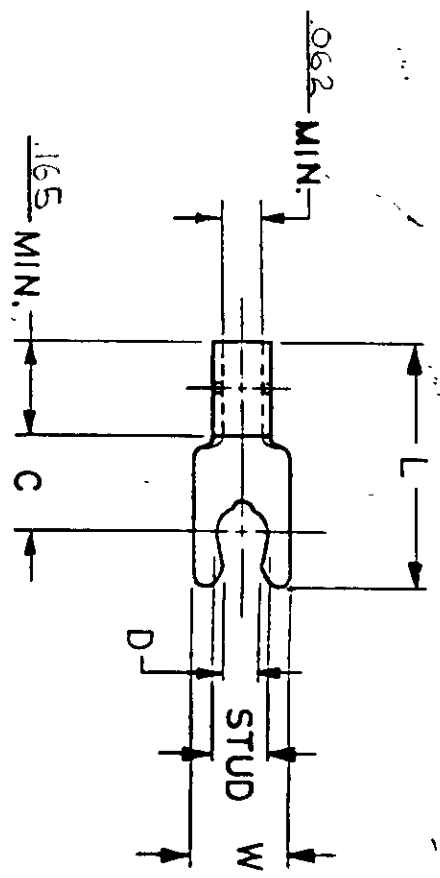

WIRE SIZE: 22-18 AWG.
 .25-1.5 MM²

PART NUMBER	"W" ±.010	"C" MIN.	"L" MAX.	"D" ±.005	AVAILABLE STUD SIZES	DIMENSIONAL TOLERANCES UNLESS OTHERWISE SPECIFIED		SCALE: NTS	DATE	TITLE:	DWG. NO.	CUSTOMER DWG.
						REFERENCE	FRAC.					
AA-1714-	.310	.261	.646	.139	08 (.173 ±.005)	±	ANG.	4.5	4.5.85	SNAP SPADE SHORT TONGUE TERMINAL KRIMP TITE SERIES	A	
AA-1715-	.330	.261	.694	.156	10 (.198 ±.005)	±	ANG.					
						±	ANG.					
						±	ANG.					



DWG. NO. A CUSTOMER DWG.