

PLEASE CHECK WWW.MOLEX.COM FOR LATEST PART INFORMATION

Part Number: [0022031081](#)
Status: **Active**
Description: 2.50mm (.098") Pitch Header, Single Row, 7.50mm (.295") Mating Pin Length, 8 Circuits

Documents:

| | |
|---------------------------------------------------------|-----------------------------------------------------------|
| 3D Model | Product Specification PS-3022-002 (PDF) |
| Drawing (PDF) | Product Specification PS-99020-0088 (PDF) |
| Product Specification PS-3022-001 (PDF) | RoHS Certificate of Compliance (PDF) |

Agency Certification

UL E29179

General

| | |
|----------------|----------------------|
| Product Family | PCB Headers |
| Series | 3022 |
| Application | Wire-to-Board |
| Product Name | N/A |

Physical

| | |
|--------------------------------|-----------------|
| Breakaway | No |
| Circuits (Loaded) | 8 |
| Circuits (maximum) | 8 |
| Color - Resin | Natural (White) |
| Flammability | 94V-0 |
| Glow-Wire Compliant | No |
| Lock to Mating Part | None |
| Material - Metal | Brass |
| Material - Plating Mating | Tin |
| Material - Plating Termination | Tin |
| Material - Resin | Nylon |
| Number of Rows | 1 |
| Orientation | Vertical |
| PC Tail Length (in) | 0.134 In |
| PC Tail Length (mm) | 3.40 mm |
| PCB Locator | No |
| PCB Retention | None |
| PCB Thickness Recommended (in) | 0.062 In |
| PCB Thickness Recommended (mm) | 1.60 mm |
| Packaging Type | Bag |
| Pitch - Mating Interface (in) | 0.098 In |
| Pitch - Mating Interface (mm) | 2.50 mm |
| Plating min: Mating (µin) | 200 |
| Plating min: Mating (µm) | 5 |
| Plating min: Termination (µin) | 200 |
| Plating min: Termination (µm) | 5 |
| Polarized to Mating Part | No |
| Polarized to PCB | No |
| Shrouded | No |
| Stackable | No |
| Temperature Range - Operating | -40°C to +105°C |
| Termination Interface: Style | Through Hole |

Electrical

| | |
|-------------------------------|------|
| Current - Maximum per Contact | 3A |
| Voltage - Maximum | 250V |

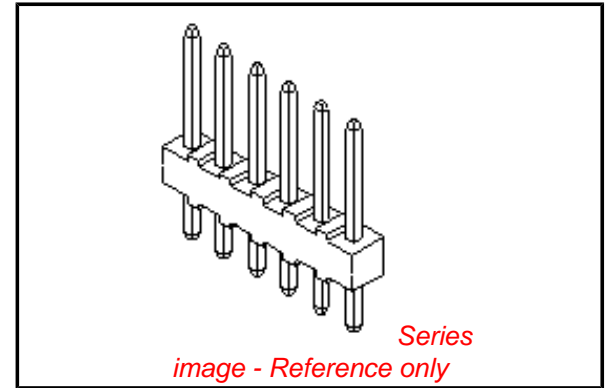

EU RoHS

ELV and RoHS Compliant
REACH SVHC
 Not Reviewed
Halogen-Free Status

China RoHS



Need more information on product environmental compliance?

Email productcompliance@molex.com
 For a multiple part number RoHS Certificate of Compliance, [click here](#)

Please visit the [Contact Us](#) section for any non-product compliance questions.

Search Parts in this Series

[3022Series](#)

Mates With

[3024](#) , [5224](#)

Solder Process Data

| | |
|------------------------------------------------|------------------------|
| Duration at Max. Process Temperature (seconds) | 5 |
| Lead-free Process Capability | Wave Capable (TH only) |
| Max. Cycles at Max. Process Temperature | 1 |
| Process Temperature max. C | 230 |

Material Info

| | |
|-----------------|----------|
| Old Part Number | 3022-08A |
|-----------------|----------|

Reference - Drawing Numbers

| | |
|-----------------------|-----------------------------------------|
| Product Specification | PS-3022-001, PS-3022-002, PS-99020-0088 |
| Sales Drawing | SD-3022-NA, SDAE-3022-NA-* |

This document was generated on 04/15/2010

PLEASE CHECK WWW.MOLEX.COM FOR LATEST PART INFORMATION

EDP NO. 22-03-1**1
 ENG. NO. SD -3022-NA
 DIMENSIONS IN METRIC DO NOT SCALE. DRAWING

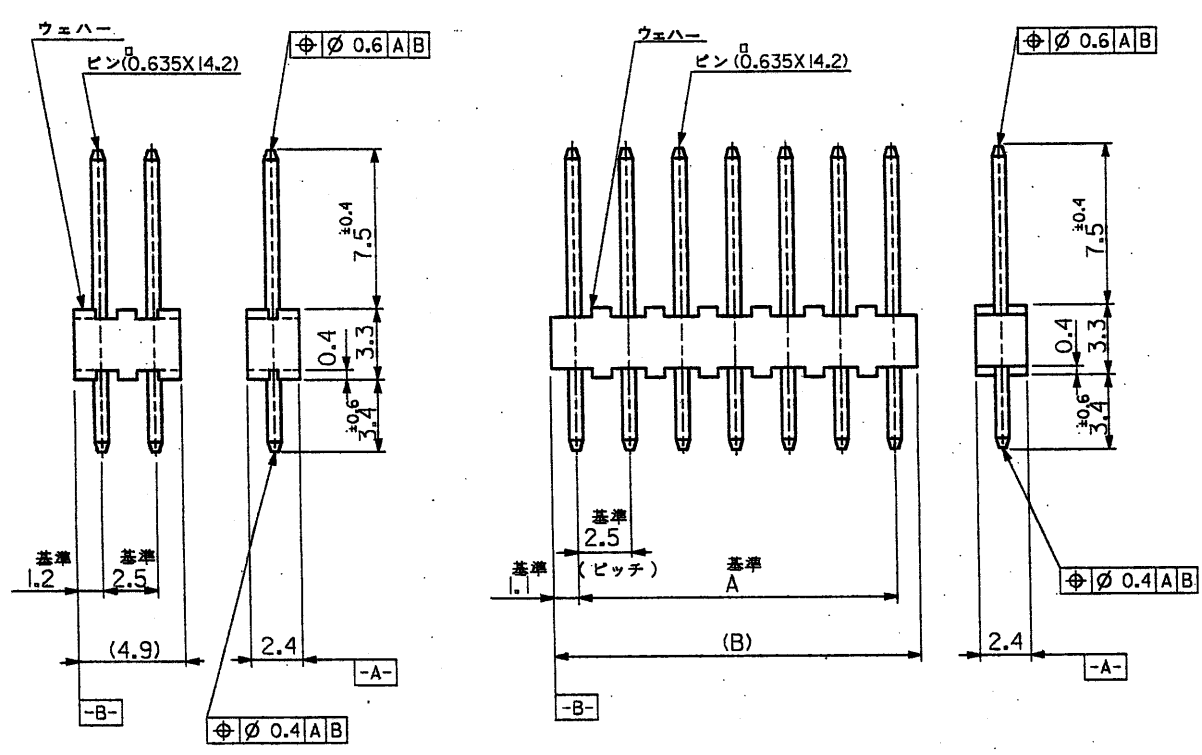

2 極

3 極 ~ 20 極

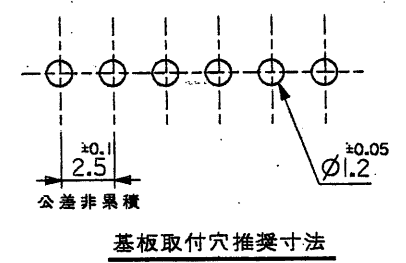

基板取付穴推奨寸法

| | | | | |
|------|------|-------------|----------|----|
| 47.5 | 49.7 | 22-03 -1201 | 3022-20A | 20 |
| 45 | 47.2 | -1191 | -19A | 19 |
| 42.5 | 44.7 | -1181 | -18A | 18 |
| 40 | 42.2 | -1171 | -17A | 17 |
| 37.5 | 39.7 | -1161 | -16A | 16 |
| 35 | 37.2 | -1151 | -15A | 15 |
| 32.5 | 34.7 | -1141 | -14A | 14 |
| 30 | 32.2 | -1131 | -13A | 13 |
| 27.5 | 29.7 | -1121 | -12A | 12 |
| 25 | 27.2 | -1111 | -11A | 11 |
| 22.5 | 24.7 | -1101 | -10A | 10 |
| 20 | 22.2 | -1091 | -09A | 9 |
| 17.5 | 19.7 | -1081 | -08A | 8 |
| 15 | 17.2 | -1071 | -07A | 7 |
| 12.5 | 14.7 | -1061 | -06A | 6 |
| 10 | 12.2 | -1051 | -05A | 5 |
| 7.5 | 9.7 | -1041 | -04A | 4 |
| 5 | 7.2 | -1031 | -03A | 3 |
| 2.5 | 4.9 | 22-03 -1021 | 3022-02A | 2 |
| A | (B) | EDP. NO | ENG. NO. | 極数 |

NOTES:

1. ウェハーのソリは、長さ 25.4 mm に対して 0.2 mm MAX.
2. () 内寸法は参考値。

| | | |
|------------------------------------------------------------|------------------------------------------|--------------------------------|
| 材料 MATERIAL ウェハー: 66ナイロン, UL94V-0 ピン: 黄銅, 銅下付鍍メッキ | MOLEX JAPAN CO., LTD. 日本モレックス株式会社 | EDP. NO. 22-03-1**1 |
| 仕上げ FINISH -- | | ENG. NO. SD-3022-NA |
| 適用電線範囲 WIRE RANGE -- | REV N | TITLE 名称 KK 2.5 WAFER ASS'Y |
| 被覆外径 INS. RANGE -- | DRAWN BY K.KAMATA CHK'D BY DATE | |
| 一般公差 GENERAL TOLERANCES | REVISE ONLY ON CAD SYSTEM SCALE 4-1 | |

THIS DRAWING CONTAINS INFORMATION THAT IS PROPRIETARY TO MOLEX/JAPAN AND SHOULD NOT BE USED WITHOUT WRITTEN PERMISSION
 本図面は日本モレックス(株)の所有する情報を含むもので、当社の許可なく複製を禁止する。

10

9

8

7

6

5

4

3

2

1

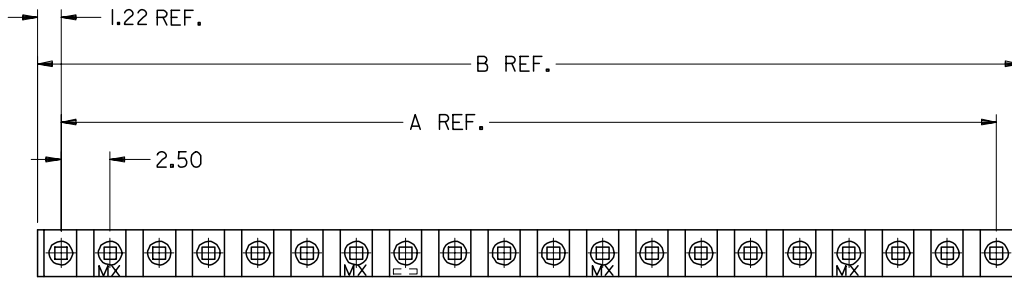

Ø 0.51 C

SEE NOTE #1

NOTE 5

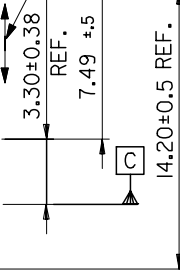

(0.64) SQ PIN, BRASS
.0076/.0051 TIN OVER .0028/.0025

Ø 0.38 C

STACKABLE
ON 2.45 GRID

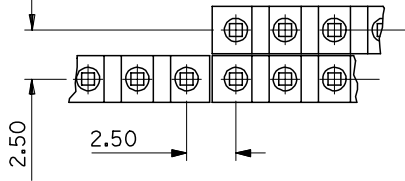

2.50

2.50

2.50 ±0.05 NON-ACCUM.

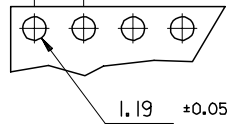

1.19 ±0.05 Ø HOLES TYP.

RECOMMENDED P.C. BOARD
HOLE DIMENSIONS

NOTES :

- PIN PUSH OUT FORCE: 2 LBS. MIN.
- PIN SOLDERABILITY PER MOLEX ENG. STD. No. 152
- DIMENSIONS SHOWN ARE MILLIMETERS.
- CODE LETTER PRECEDING PART No. DESIGNATES MANUFACTURING LOCATION. I = IRELAND
- STEP ON ALL OCT SIZES
MXI: STEP ON 2 CCT SIZE ONLY

MAT'L: NYLON BASFKR4205 PER ES-I28B.

| | | | | |
|------------|-------------|----------------|--------|--------|
| NOT TOOLED | AE-3022-25A | 25 | 60.0 | 62.4 |
| 22-03-1221 | AE-3022-22A | 22 | 52.5 | 54.9 |
| 22-03-1211 | 21A | 21 | 50.0 | 52.4 |
| 22-03-1201 | 20A | 20 | 47.5 | 49.9 |
| -1191 | 19A | 19 | 45.0 | 47.4 |
| -1181 | 18A | 18 | 42.5 | 44.9 |
| -1171 | 17A | 17 | 40.0 | 42.4 |
| -1161 | 16A | 16 | 37.5 | 39.9 |
| -1151 | 15A | 15 | 35.0 | 37.4 |
| -1141 | 14A | 14 | 32.5 | 34.9 |
| -1131 | 13A | 13 | 30.0 | 32.4 |
| -1121 | 12A | 12 | 27.5 | 29.9 |
| -1111 | 11A | 11 | 25.0 | 27.4 |
| -1101 | 10A | 10 | 22.5 | 24.9 |
| -1091 | 9A | 9 | 20.0 | 22.4 |
| -1081 | 8A | 8 | 17.5 | 19.9 |
| -1071 | 7A | 7 | 15.0 | 17.4 |
| -1061 | 6A | 6 | 12.5 | 14.9 |
| -1051 | 5A | 5 | 10.0 | 12.4 |
| -1041 | 4A | 4 | 7.5 | 9.9 |
| -1031 | 3A | 3 | 5.0 | 7.4 |
| 22-03-1021 | AE-3022 -2A | 2 | 2.5 | 4.9 |
| PART No. | ENG. No. | No OF Ckts. | DIM. A | DIM. B |

| | | | | | | | | | | |
|-----------------------------------------------------------------------------------------------------------------|-------------------------------|------------------------------------------------------|--|----------------------------|--|-------------------------|------------------------|--------------------------------------|--|--|
| ADD NOTE 5 EC NO: E2007-0275 DRWN:DCARTON 2006/10/13 CHKD: 2006/10/16 APPR:EOHANY 2006/10/17 | QUALITY SYMBOLS ▽=0 ▽=0 | GENERAL TOLERANCES (UNLESS SPECIFIED) | | DIMENSION STYLE MM ONLY | | SCALE 4:1 | DESIGN UNITS METRIC | THIRD ANGLE PROJECTION | | |
| | | | | | | DRAWN BY PMOORE | | TITLE MINI-KON WAFER 2.5 CEN ASSY | | |
| | | | | | | CHECKED BY OCOSTEL | | DATE 1998/01/10 | | |
| | | | | | | APPROVED BY MWILHITE | | DATE 1998/04/08 | | |
| | | DRAFT WHERE APPLICABLE MUST REMAIN WITHIN DIMENSIONS | | SEE CHART | | MATERIAL NO. | | DOCUMENT NO. SDAE-3022-NA-* | | |
| | | | | SIZE A3 | | SHEET NO. 1 OF 3 | | | | |